

PROJ. REFERENCE NO.	SHEET NO.
R - 5703	TMP - 5EDET

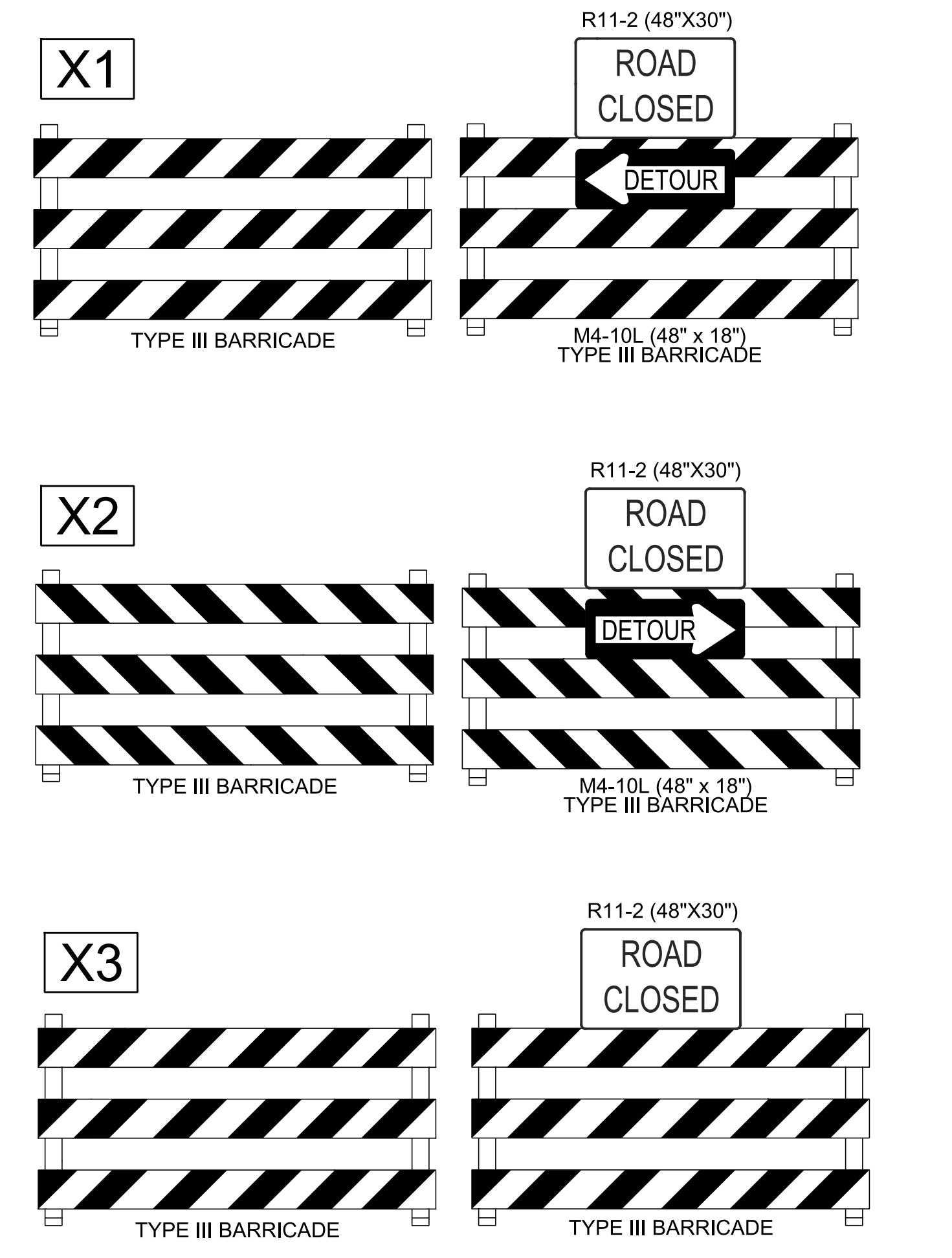
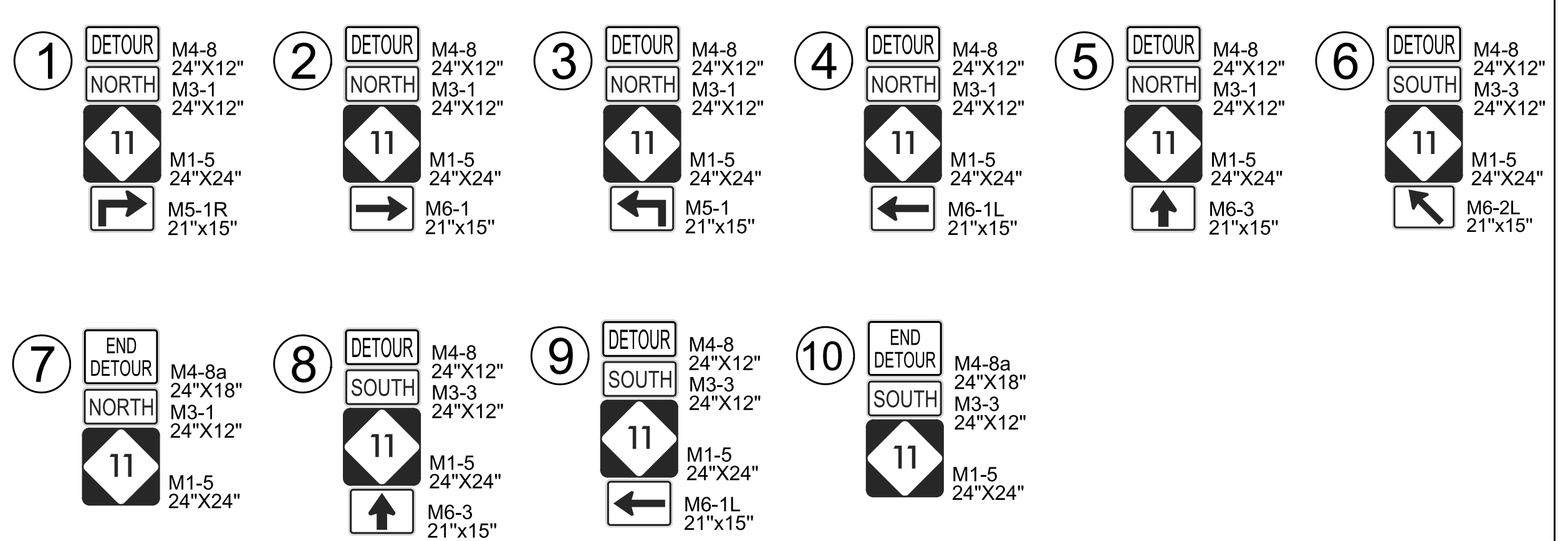
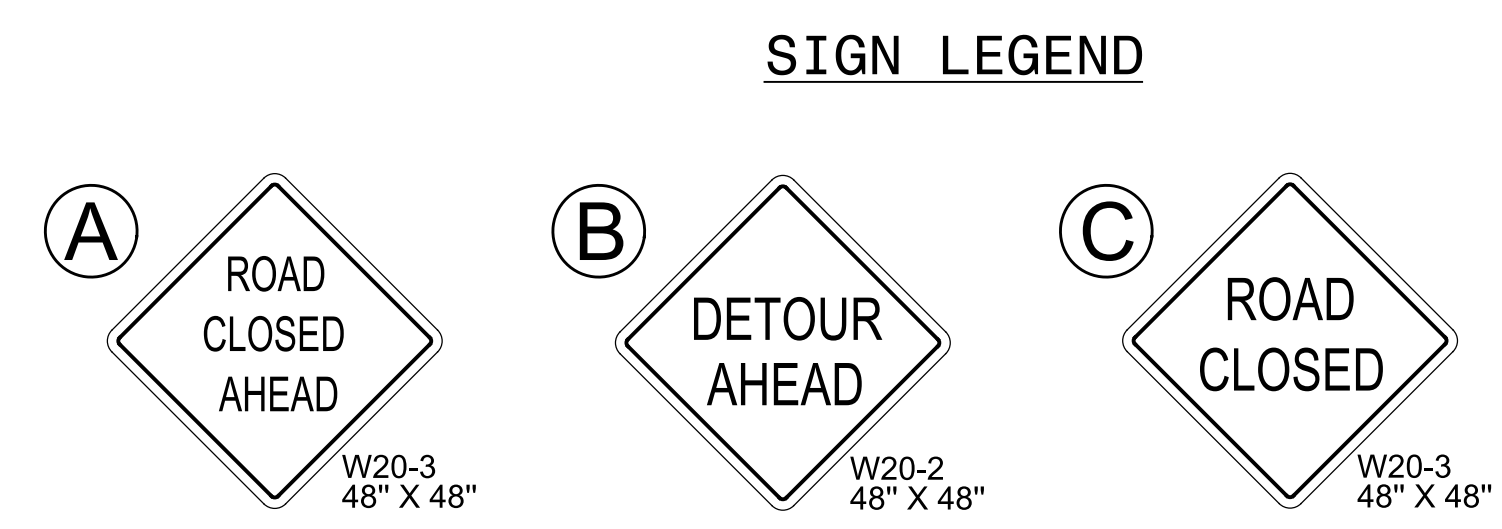
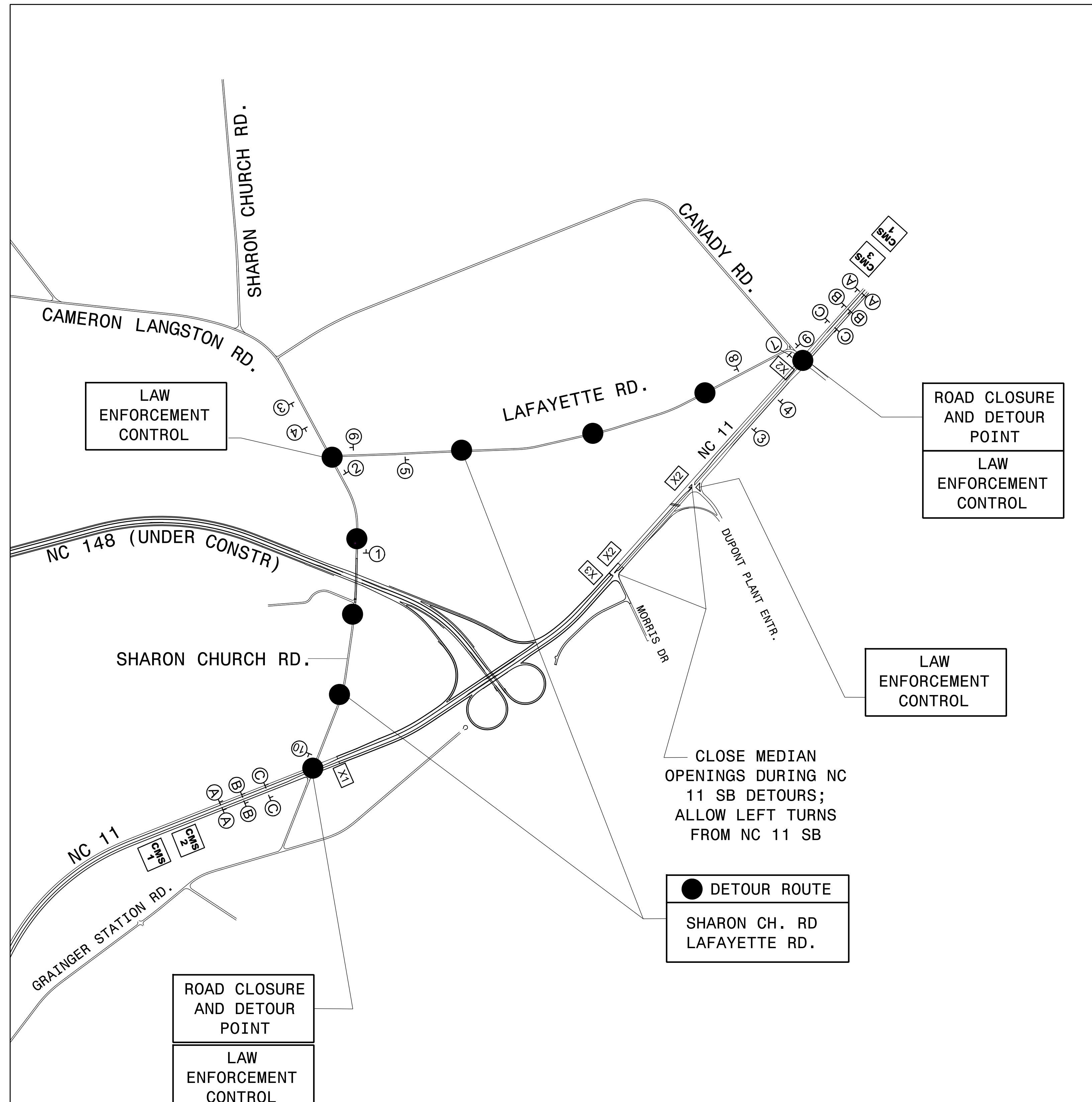

#### CMS MESSAGES DURING ROAD CLOSURE

<b>CMS 1</b>	CHANGEABLE MESSAGE SIGN	ROAD CLOSED AHEAD	PREPARE TO STOP
<b>CMS 2</b>	CHANGEABLE MESSAGE SIGN	ROAD CLOSED AHEAD	DETOUR NEXT LEFT
<b>CMS 3</b>	CHANGEABLE MESSAGE SIGN	ROAD CLOSED AHEAD	DETOUR NEXT RIGHT

#### CMS MESSAGES PRIOR TO ROAD CLOSURE

CHANGEABLE MESSAGE SIGN	NC 11 CLOSING	MM/DD TO MM/DD
-------------------------	---------------	----------------

DETOUR ALLOWED ONLY FOR OVERHEAD BRIDGE GIRDER ERECTION. REFER TO PROJECT SPECIAL PROVISIONS - INTERMEDIATE CONTRACT TIMES.

- NOTES:**
- AS AN OPTION LANE CLOSURES MAY BE USED IN CONJUNCTION WITH THE ROAD CLOSURE SIGNS ON NC 11 TO REDUCE TRAFFIC TO ONE LANE IN APPROACH TO ROAD CLOSURE POINTS. REFER TO RDWY. STD. DWG. 1101.02 SHEET 4 OF 15.
  - DO NOT IMPLEMENT THIS ROAD CLOSURE SIMULTANEOUSLY WITH ANY OTHER ROAD CLOSURES.

9/14/2017 R:\Traffic\TrafficControl\TMP PLAN SHEETS\NR-5703 TMP 05EDET DETOUR ROUTE Y8 NC ILDgn bir-git.mackenzie

<p><b>Michael Baker INTERNATIONAL</b> 8000 Regency Parkway, Suite 600, Cary, NC 27518 Phone: (919) 463-5488 MBAKERINTL.COM</p>	<p>DOCUMENT NOT CONSIDERED FINAL UNLESS ALL SIGNATURES COMPLETED</p> <p>SEAL</p>		<p><b>NC 11. -Y8- ROAD CLOSURE AND DETOUR FOR GIRDER INSTALLATION</b></p>
--	--	--	---