

TEMPORARY BARRIER APPROACH END TREATMENT

PLAN VIEW

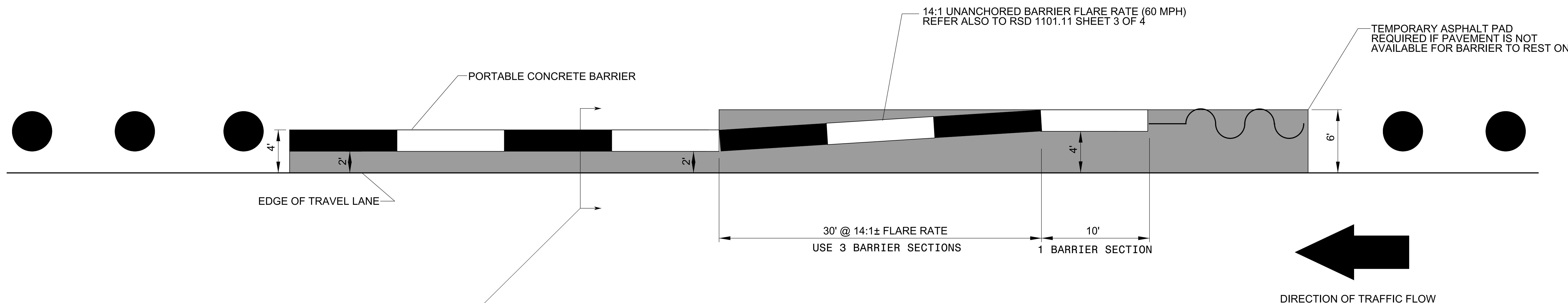

SECTION VIEW

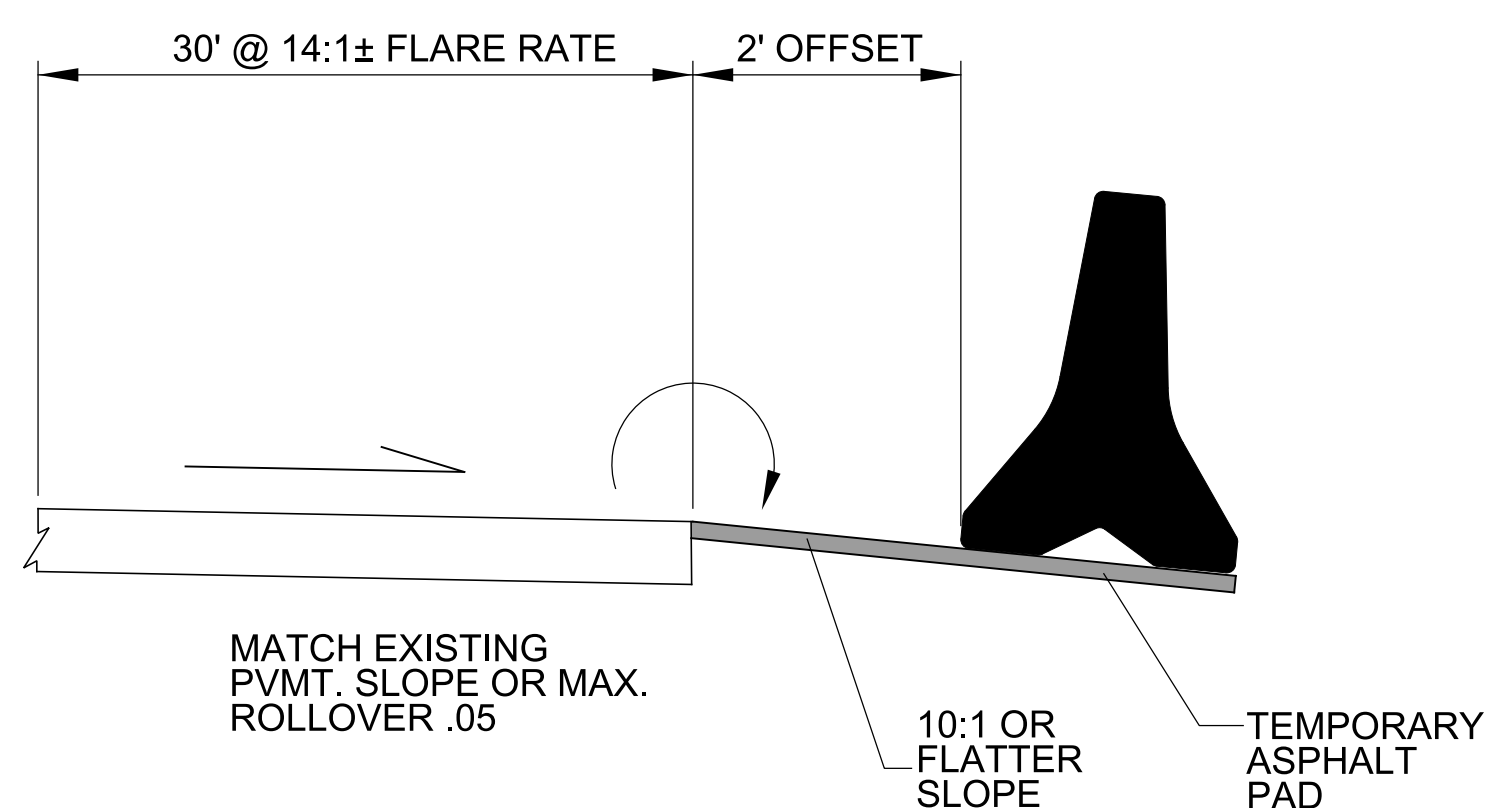

NOTES:

1. INSTALL TEMPORARY BARRIER AT AN OFFSET OF 2' FROM THE ADJACENT EDGELINE OF A TRAVEL LANE. OFFSET THE APPROACH END AND CRASH CUSHION 4' (PREFERRED) FROM THE EDGE OF A TRAVEL LANE. IN THE EVENT A 4' OFFSET CANNOT BE ACHIEVED A LESSER OFFSET MAY BE USED BUT NOT LESS THAN 2'.
2. TEMPORARY BARRIER MUST REST ON AN ASPHALT OR CONCRETE SURFACE.
3. FURNISH MATERIAL AND INSTALL TEMPORARY ASPHALT PAD FOR BARRIER TO REST ON. ASPHALT PAD SHALL BE PAVED AT A MINIMUM OF A 1" LAYER OF SURFACE COURSE OR AS APPROVED BY THE ENGINEER.
4. CONSTRUCT TEMPORARY ASPHALT PAD AS TO MATCH THE CROSS-SLOPE OF THE PAVEMENT THE PAD IS BEING PAVED UP TO, OR PROVIDE FOR A MAXIMUM ROLL-OVER OF .05. PAVE SUFFICIENT ASPHALT SUCH THAT THE ENTIRE BASE OF THE TEMPORARY BARRIER RESTS ON ASPHALT.
5. DO NOT PLACE TEMPORARY BARRIER ON A SURFACE WITH A SLOPE STEEPER THAN 10:1.
6. THE COST OF THE TEMPORARY ASPHALT PAD WILL BE CONSIDERED INCIDENTAL TO THE COST OF BARRIER. NO SEPARATE PAYMENT WILL BE MADE FOR THE TEMPORARY ASPHALT PAD.

9/14/2017 R:\Traffic\TrafficControl\TMP PLAN SHEETS\NR-5703 TMP 02 TEMPORARY BARRIER END TREATMENT.dgn bir-git.mackenzie

<p>Michael Baker INTERNATIONAL 8000 Regency Parkway, Suite 600, Cary, NC 27518 Phone: (919) 463-5488 MBAKERINTL.COM</p>	<p>DOCUMENT NOT CONSIDERED FINAL UNLESS ALL SIGNATURES COMPLETED</p> <p>SEAL</p>		<p>TEMPORARY BARRIER APPROACH END TREATMENT TYPICAL DRAWING</p>
--	--	--	---