

SURVEY CONTROL SHEET R-5703

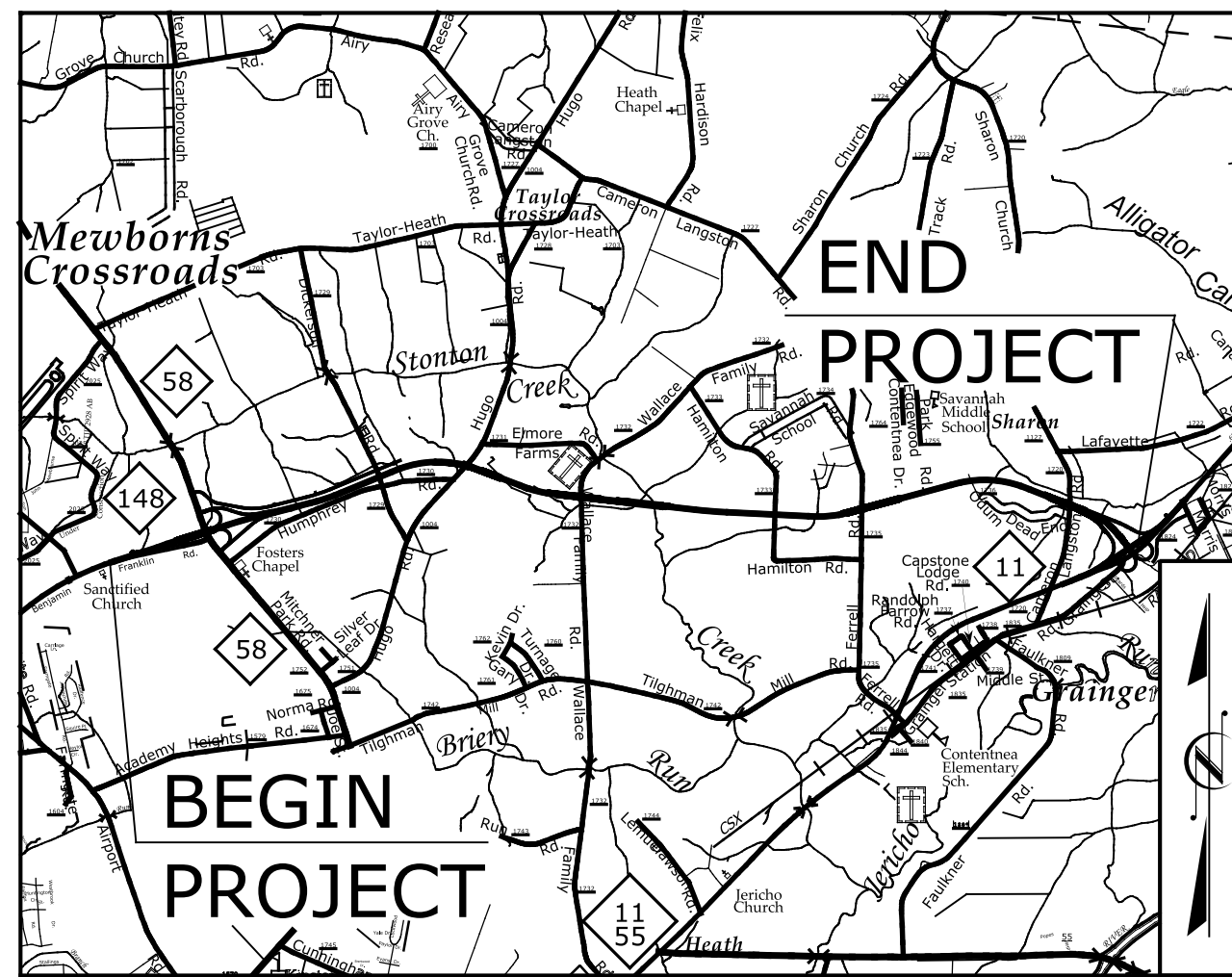

VICINITY MAP

CONTROL DATA

BL2 POINT	DESC.	NORTH	EAST	ELEVATION	L STATION	OFFSET
BL30	BL-30	580079.8910	2430436.5550	64.13	167+30.29	83.54 LT
BL31	BL-31	579845.3620	2431667.9070	68.73	179+57.27	289.80 LT
BL32	BL-32	579631.8160	2432372.5940	64.81	187+21.11	329.73 LT
BL33	BL-33	579420.2110	2433620.6920	61.79	200+41.67	297.45 LT
BL34	BL-34	579353.1570	2434353.7970	54.89	207+77.69	312.20 LT
BL35	BL-35	579295.2240	2434965.1260	42.39	213+91.67	322.49 LT
BL36	BL-36	579233.3530	2435682.7750	42.66	221+11.75	340.67 LT
BL37	BL-37	579193.6020	2436039.1090	62.45	224+70.29	340.72 LT
BL38	BL-38	579086.6910	2437179.5260	62.56	236+22.00	358.79 LT
BL39	BL-39	578906.2420	2438369.1210	62.09	248+35.17	250.48 LT
R57035	GPS MON	578621.8430	2439142.4890	59.07	256+21.46	4.03 LT
BL40	BL-40	578799.9820	2439900.0290	66.83	263+69.44	218.80 LT

BY3 POINT	DESC.	NORTH	EAST	ELEVATION	Y3 STATION	OFFSET
EQR57033		578467.5970	2428973.6940	67.60	OUTSIDE PROJECT LIMITS	
R57034	GPS MON	579337.2810	2429761.3620	64.82	OUTSIDE PROJECT LIMITS	
EQBL30		580079.8910	2430436.5550	64.13	12+87.15	14.32 RT

BY5 POINT	DESC.	NORTH	EAST	ELEVATION	Y5 STATION	OFFSET
R57036	GPS MON	577536.3870	2439106.2180	67.85	OUTSIDE PROJECT LIMITS	
EQR57035		578621.8430	2439142.4890	59.07	12+50.87	13.91 LT

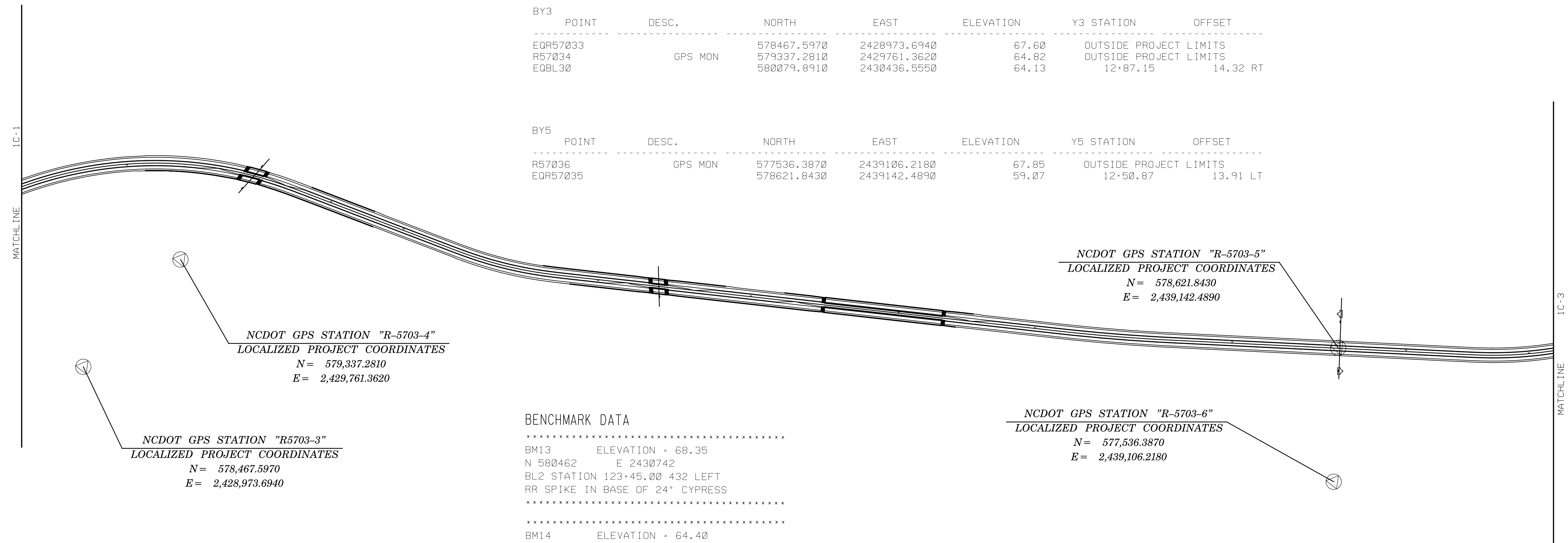

BENCHMARK DATA

```

*****
BM13  ELEVATION = 68.35
N 580462  E 2430742
BL2 STATION 123+45.00 432 LEFT
RR SPIKE IN BASE OF 24' CYPRESS
*****
BM14  ELEVATION = 64.40
N 579195  E 2436021
BL2 STATION 177+83.00 0 RIGHT
RR SPIKE IN BASE OF 12' PINE
*****
BM15  ELEVATION = 58.69
N 578374  E 2439008
BL2 STATION 209+33.00 279 RIGHT
RR SPIKE IN BASE OF 16' GUM
*****

```

NOTES:

THE CONTROL DATA FOR THIS PROJECT CAN BE FOUND ELECTRONICALLY BY SELECTING PROJECT CONTROL DATA AT:
[HTTP://WWW.NCDOT.GOV/DOH/RECONSTRUCTHIGHWAY/LOCATION/PROJECT/](http://www.ncdot.gov/DOH/RECONSTRUCTHIGHWAY/LOCATION/PROJECT/)

THE FILES TO BE FOUND ARE AS FOLLOWS:
 TIP R5703_LS_CONTROL.TXT

SITE CALIBRATION INFORMATION HAS NOT BEEN PROVIDED FOR THIS PROJECT. IF FURTHER INFORMATION IS NEEDED, PLEASE CONTACT THE LOCATION AND SURVEYS UNIT.

⊗ INDICATES GEODETIC CONTROL MONUMENTS USED OR SET FOR HORIZONTAL PROJECT CONTROL BY THE NCDOT LOCATION AND SURVEYS UNIT.
 PROJECT CONTROL ESTABLISHED USING GLOBAL POSITIONING SYSTEM.

DATUM DESCRIPTION

THE LOCALIZED COORDINATE SYSTEM DEVELOPED FOR THIS PROJECT IS BASED ON THE STATE PLANE COORDINATES ESTABLISHED BY NCGS FOR MONUMENT "P60"

WITH NAD 83/NA 2011 STATE PLANE GRID COORDINATES OF
 NORTHING: 574939.107(ft) EASTING: 2435346.9420(ft)
 ELEVATION: 53.49(ft)

THE AVERAGE COMBINED GRID FACTOR USED ON THIS PROJECT (GROUND TO GRID) IS: 0.999876417
 THE N.C. LAMBERT GRID BEARING AND LOCALIZED HORIZONTAL GROUND DISTANCE FROM "P60" TO -L- STATION 60+56.32 IS
 N 81° 20' 04.17" W 15,314.40'

ALL LINEAR DIMENSIONS ARE LOCALIZED HORIZONTAL DISTANCES
 VERTICAL DATUM USED IS NAVD 88

NOTE: DRAWING NOT TO SCALE