

**CLOSE I-95 BUSINESS
NORTHBOUND USING RSD
1101.03, SHEET 7 OF 9**

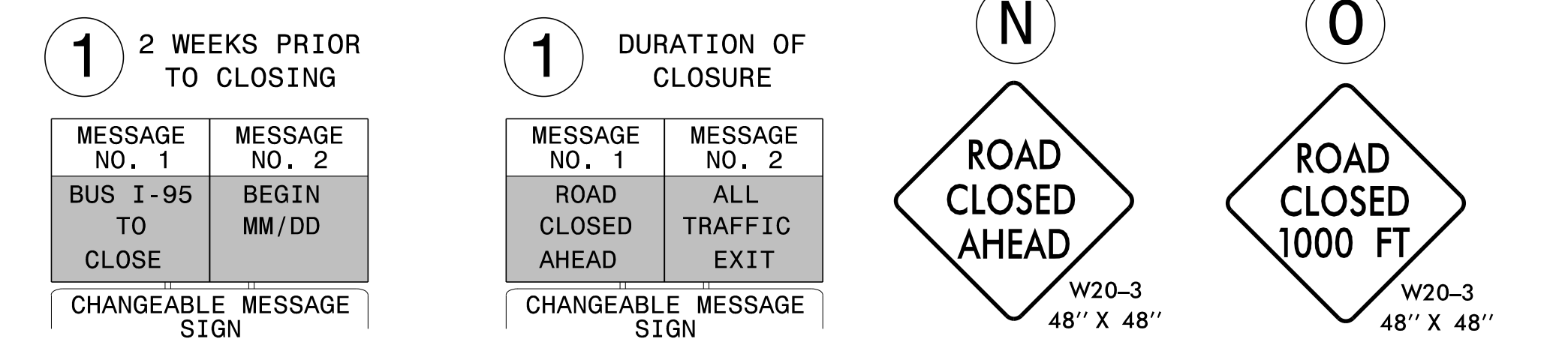
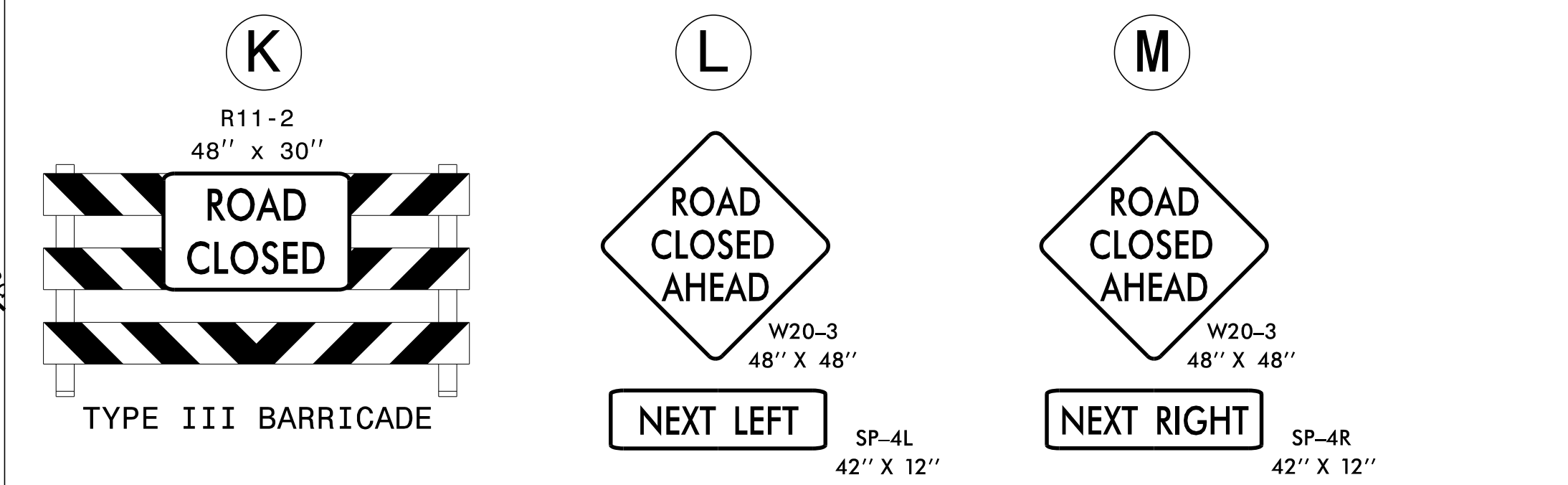
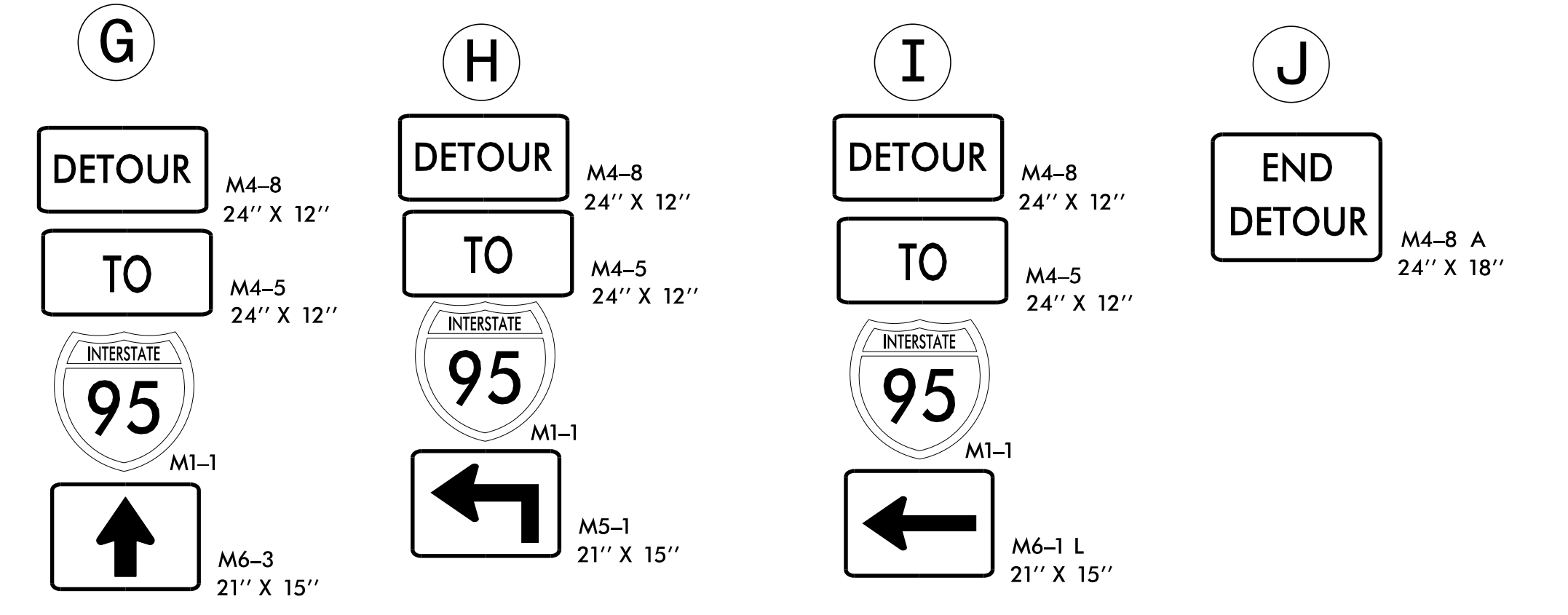
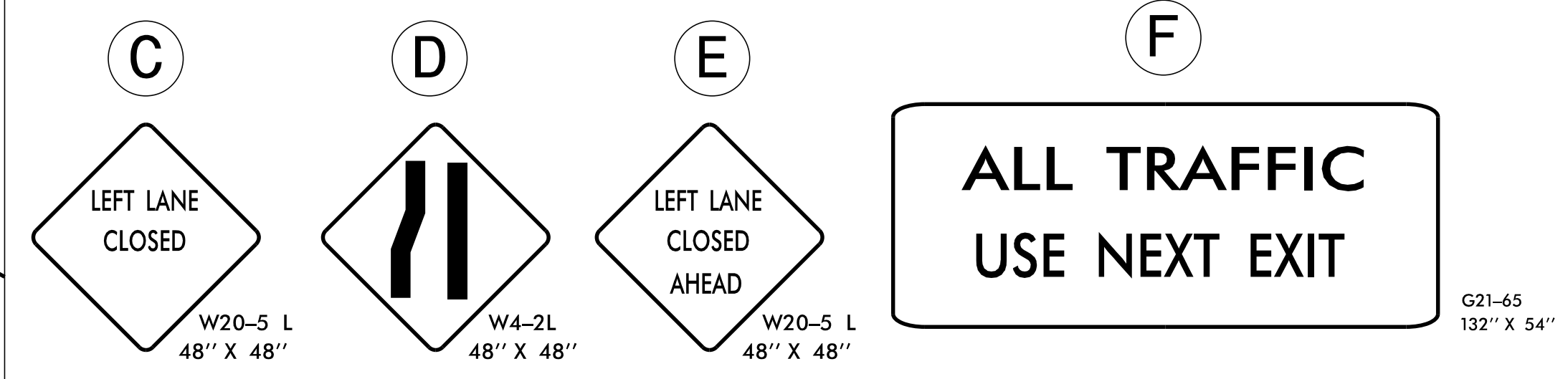
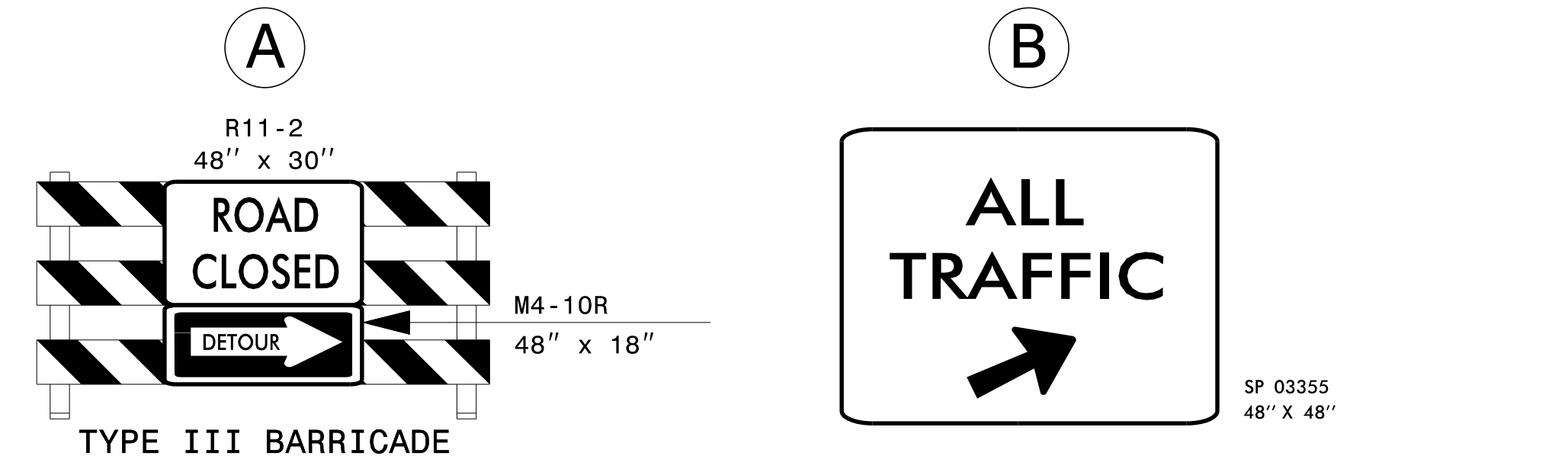

APPROVED: _____ DATE: _____			BRIDGE 129 & 130 DETOUR SIGNING
SEAL			

11/2/2017
 \\vhs\pro\raleigh\38564.08 NCDOT 41665.7A\Cumberland\NCDOT\129 and 130\TrafficControl\TCP\TC-English_seed4.dgn
 User: mthigpen