

6/2/99

SURVEY CONTROL SHEET 250129

W/EXISTING ALIGNMENTS PRIOR TO CONSTRUCTION

L			
TYPE	STATION	NORTH	EAST
POT	100+00.00	486769.0776	2062035.6790
EQB	112+00.00	487050.5034	2063202.2121
EOA	114+11.29	487050.5034	2063202.2121

L1			
TYPE	STATION	NORTH	EAST
POT	0+00.00	487332.5390	2062932.0230
EQB	0+47.37	487292.0760	2062907.3840
EOA	0+00.00	487292.0760	2062907.3840

L2			
TYPE	STATION	NORTH	EAST
POT	0+00.00	487014.8660	2062733.3120
EQB	0+06.80	487008.8130	2062730.2060
EOA	0+00.00	487008.8130	2062730.2060

Y			
TYPE	STATION	NORTH	EAST
POT	10+00.00	487282.3094	2062915.9905
POT	18+00.04	486596.2652	2062504.4031

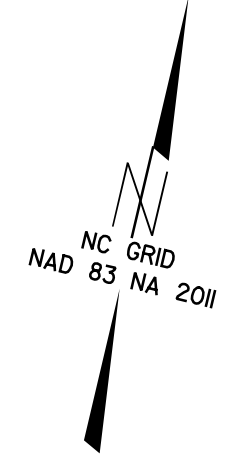

BL	POINT	DESC.	NORTH	EAST	ELEVATION	L STATION	OFFSET
1		BL-1	486642.5100	2061835.6300	119.58	OUTSIDE PROJECT LIMITS	
2		BL-2	486888.5900	2062296.6400	136.06	102+81.71	54.98 LT
3		BL-3	486951.5100	2062834.0800	139.92	108+18.92	9.90 RT
4		BL-4	487113.4300	2063494.9500	126.72	OUTSIDE PROJECT LIMITS	
101		GPS-101	487346.6200	2064050.2900	119.60	OUTSIDE PROJECT LIMITS	
102		GPS-102	487761.0300	2064804.5700	122.51	OUTSIDE PROJECT LIMITS	

BY	POINT	DESC.	NORTH	EAST	ELEVATION	EY STATION	OFFSET
Y1		BY-1	487488.5400	2063086.4000	125.80	OUTSIDE PROJECT LIMITS	
Y2		BY-2	486477.5800	2062458.9600	120.92	OUTSIDE PROJECT LIMITS	

.....
 BM1 ELEVATION = 140.48
 N 486954 E 2062810
 L STATION 107+96.00 2 RIGHT
 CHISELED SQUARE IN CONC HW

◆ NCDOT BASELINE STATION 250129 Y1
 LOCALIZED PROJECT COORDINATES
 N-487488.5400
 E-2063086.4000
 ELEV-125.80'

◆ NCDOT BASELINE STATION 250129 BL-1
 LOCALIZED PROJECT COORDINATES
 N-486642.5100
 E-2061835.6300
 ELEV-119.58'

◆ NCDOT BASELINE STATION 250129 BL-2
 LOCALIZED PROJECT COORDINATES
 N-486888.5900
 E-2062296.6400
 ELEV-136.06'

◆ BM#1 NCDOT BASELINE STATION 250129 BL-3
 LOCALIZED PROJECT COORDINATES
 N-486951.5100
 E-2062834.0800
 ELEV-139.92'

◆ NCDOT BASELINE STATION 250129 BL-4
 LOCALIZED PROJECT COORDINATES
 N-487113.4300
 E-2063494.9500
 ELEV-126.72'

◆ NCDOT BASELINE STATION 250129 Y2
 LOCALIZED PROJECT COORDINATES
 N-486477.5800
 E-2062458.9600
 ELEV-120.92'

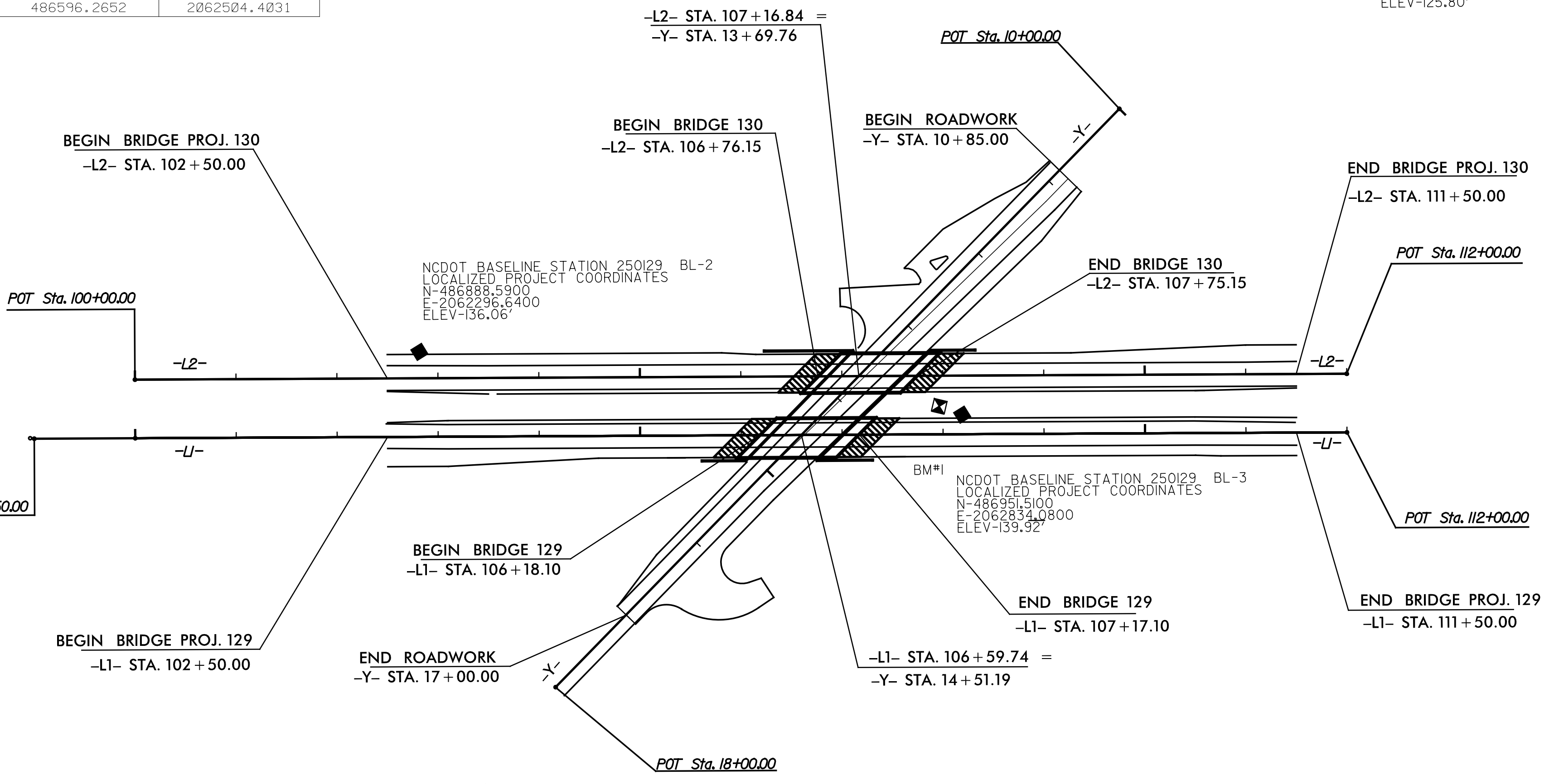

DATUM DESCRIPTION

THE LOCALIZED COORDINATE SYSTEM DEVELOPED FOR THIS PROJECT IS BASED ON THE STATE PLANE COORDINATES ESTABLISHED BY NCDOT FOR MONUMENT "250129-GPS101" WITH NAD 83/NA 2011 STATE PLANE GRID COORDINATES OF NORTHING: 487346.624(ft) EASTING: 2064050.286(ft) ELEVATION: 119.60(ft)

THE AVERAGE COMBINED GRID FACTOR USED ON THIS PROJECT (GROUND TO GRID) IS: 0.9998760753

THE N.C. LAMBERT GRID BEARING AND LOCALIZED HORIZONTAL GROUND DISTANCE FROM "250129-GPS101" TO -L- STATION 10+00.00 IS N57°40'44.93"E 236.73

ALL LINEAR DIMENSIONS ARE LOCALIZED HORIZONTAL DISTANCES VERTICAL DATUM USED IS NAVD 88

NOTES:

○ INDICATES GEODETIC CONTROL MONUMENTS USED OR SET FOR HORIZONTAL AND VERTICAL PROJECT CONTROL BY THE NCDOT LOCATION AND SURVEYS UNIT. PROJECT CONTROL ESTABLISHED USING GNSS (GLOBAL NAVIGATION SATELLITE SYSTEM).

THE CONTROL DATA FOR THIS PROJECT CAN BE FOUND ELECTRONICALLY BY SELECTING PROJECT CONTROL DATA AT:
[HTTPS://CONNECT.NCDOT.GOV/RESOURCES/LOCATION/](https://connect.ncdot.gov/resources/location/)

THE FILES TO BE FOUND ARE AS FOLLOWS:
 250129-LS-CONTROL.TXT

SITE CALIBRATION INFORMATION HAS NOT BEEN PROVIDED FOR THIS PROJECT. IF FURTHER INFORMATION IS NEEDED, PLEASE CONTACT THE LOCATION AND SURVEYS UNIT.

NOTE: DRAWING NOT TO SCALE

9/11/2017 250129_1s_1c-2.dgn