

**This electronic collection of documents is provided  
for the convenience of the user  
and is Not a Certified Document –**

**The documents contained herein were originally issued  
and sealed by the individuals whose names and license  
numbers appear on each page, on the dates appearing  
with their signature on that page.**

**This file or an individual page  
shall not be considered a certified document.**

GEOTECHNICAL ENGINEER

ENGINEER

SEAL 028893

PROFESSIONAL ENGINEER

MICHAEL H. STEPHENS

DATE 11/7/2017

SIGNATURE

DATE

**DOCUMENT NOT CONSIDERED FINAL UNLESS ALL SIGNATURES COMPLETED**

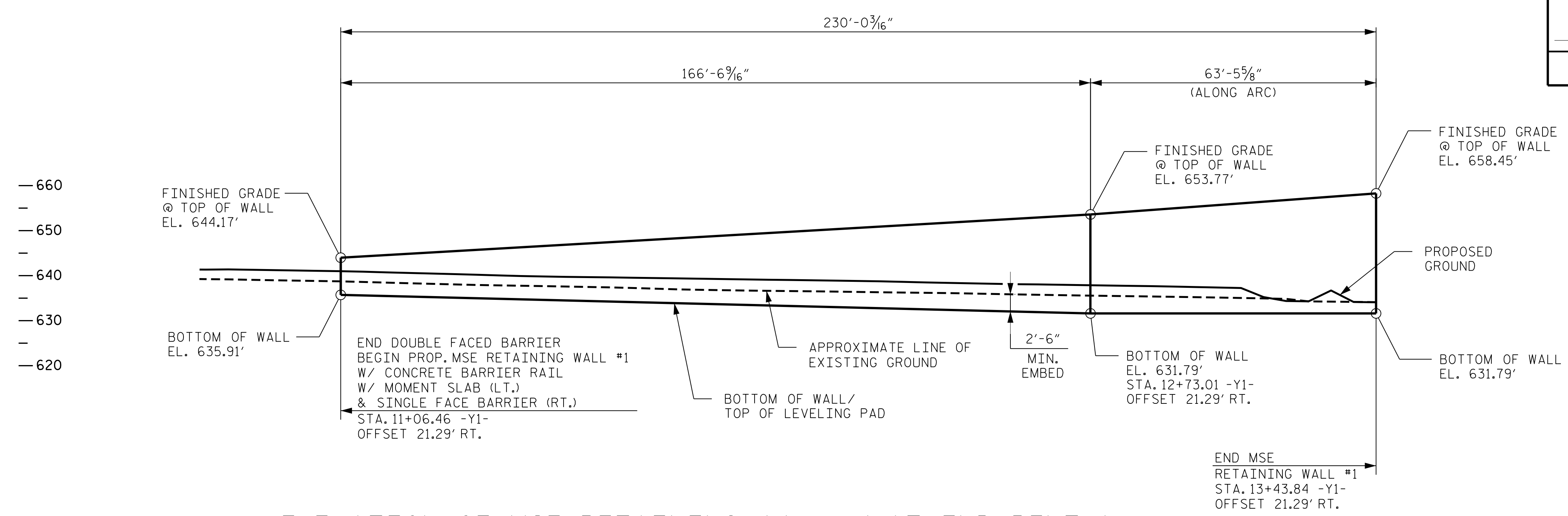

**ELEVATION OF MSE RETAINING WALL #1 AT END BENT 1**  
 ALL DIMENSIONS AND STATIONS ARE ALONG FRONT FACE OF WALL  
 LOOKING AT THE FRONT FACE OF WALL

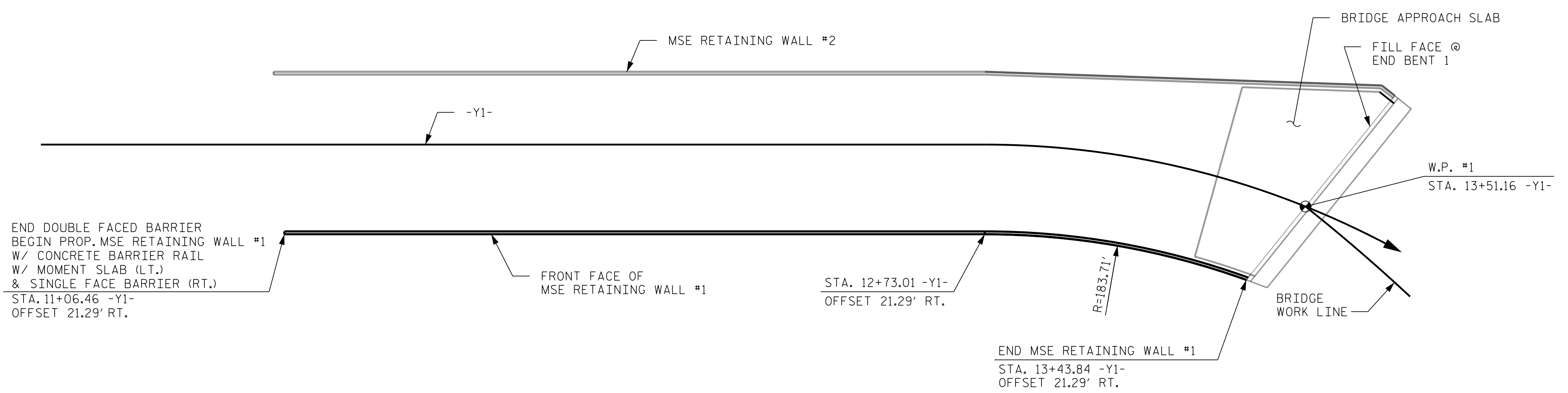

**PLAN OF MSE RETAINING WALL #1 AT END BENT 1**  
 BRIDGE SUPERSTRUCTURE AND MOMENT SLAB NOT SHOWN FOR CLARITY  
 FOR MOMENT SLAB DETAILS, SEE "MOMENT SLAB DETAILS" SHEETS.

ESTIMATED WALL QUANTITY	
RETAINING WALL NO. 1	* 4,055 SQUARE FEET

\* WALL AREA IS MEASURED USING THE DESIGN HEIGHT "H"

PROJECT NO.: 44378.1.D1 (U-5806)  
 CABARRUS COUNTY  
 STATION: RWAL01 - STA. 10+55.07 -Y1- TO 13+43.84 -Y1-  
 SHEET 1 OF 6

NORTH CAROLINA  
 DEPARTMENT OF TRANSPORTATION  
 DIVISION OF HIGHWAYS

GEOTECHNICAL  
 ENGINEERING UNIT

REVISIONS						SHEET NO.
NO.	BY	DATE	NO.	BY	DATE	
1	MHS	11/7/17	3			W-1
2			4			

PREPARED BY: MHS	DATE: 9/28/17
REVIEWED BY: SCC	DATE: 9/28/17

GEOTECHNICAL ENGINEER  
 ENGINEER  
 SEAL 028893  
 MICHAEL H. STEPHENS  
 11/7/2017  
 DOCUMENT NOT CONSIDERED FINAL  
 UNLESS ALL SIGNATURES COMPLETED

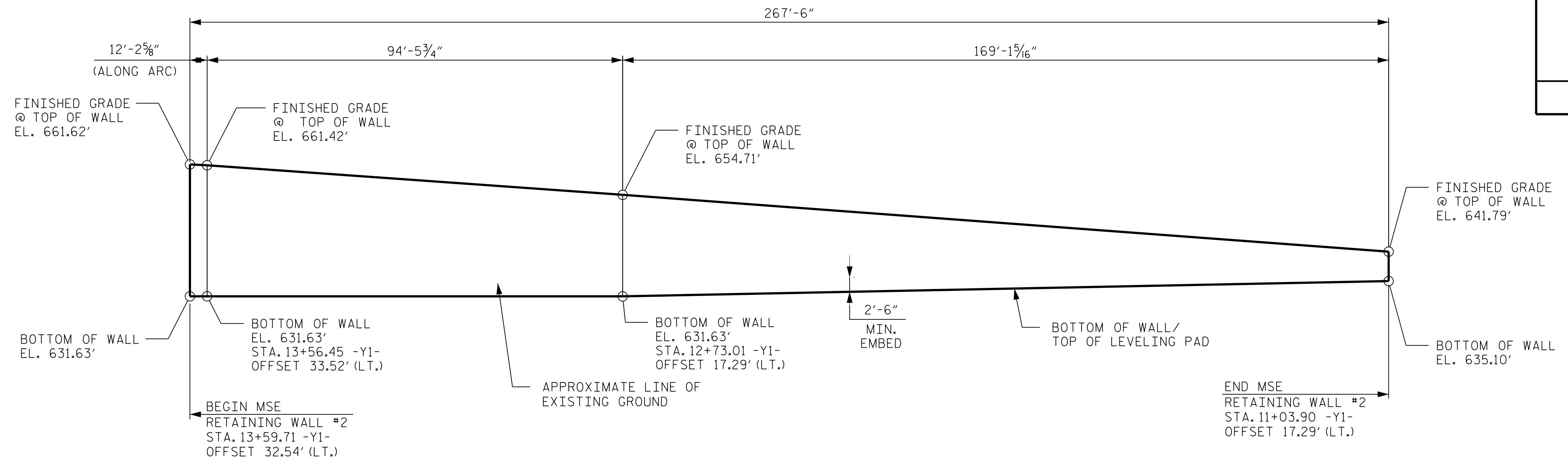

**ELEVATION OF MSE RETAINING WALL #2 AT END BENT 1**  
 ALL DIMENSIONS AND STATIONS ARE ALONG FRONT FACE OF WALL  
 LOOKING AT THE FRONT FACE OF WALL

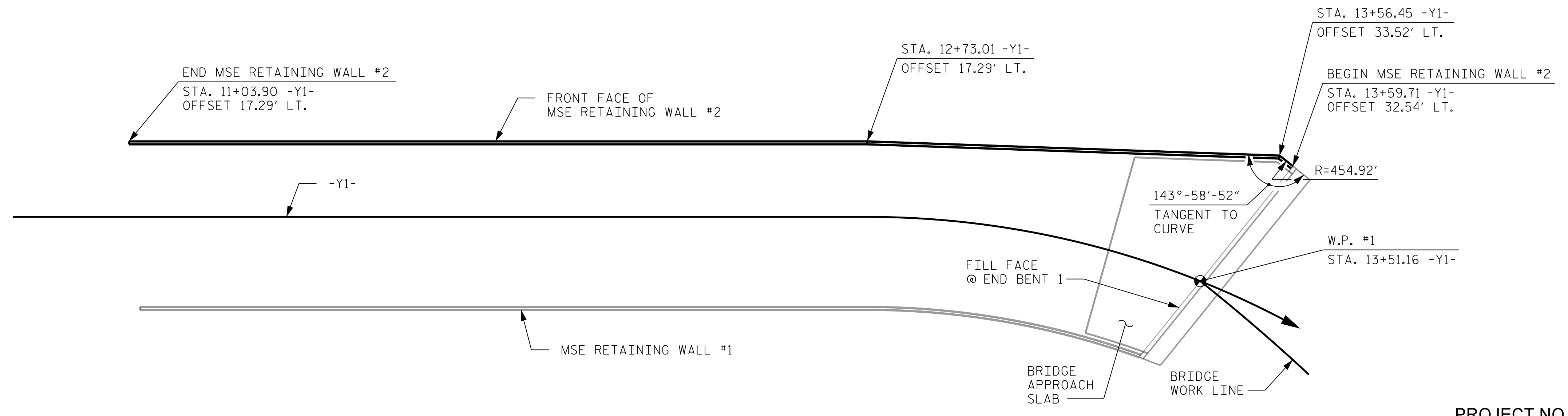

**PLAN OF MSE RETAINING WALL #2 AT END BENT 1**  
 BRIDGE SUPERSTRUCTURE AND MOMENT SLAB NOT SHOWN FOR CLARITY  
 FOR MOMENT SLAB DETAILS, SEE "MOMENT SLAB DETAILS" SHEETS.

ESTIMATED WALL QUANTITY	
RETAINING WALL NO. 2	* 5,195 SQUARE FEET
* WALL AREA IS MEASURED USING THE DESIGN HEIGHT "H"	

PROJECT NO.: 44378.1.D1 (U-5806)  
 CABARRUS COUNTY  
 STATION: RWAL02 - STA. 10+69.01 -Y1- TO 13+59.71 -Y1-  
 SHEET 2 OF 6

NORTH CAROLINA  
 DEPARTMENT OF TRANSPORTATION  
 DIVISION OF HIGHWAYS  
 GEOTECHNICAL ENGINEERING UNIT

REVISIONS					
NO.	BY	DATE	NO.	BY	DATE
1	MHS	11/7/17	3	-	-
2	-	-	4	-	-

RETAINING WALL NO. 2  
 MSE WALL

PREPARED BY: MHS	DATE: 9/28/17
REVIEWED BY: SCC	DATE: 9/28/17

SHEET NO. W-2

GEOTECHNICAL ENGINEER

ENGINEER

SEAL  
028893  
ENGINEER  
MICHAEL H. STEPHENS

SIGNATURE: *Michael H. Stephens* DATE: 11/7/2017

**DOCUMENT NOT CONSIDERED FINAL  
UNLESS ALL SIGNATURES COMPLETED**

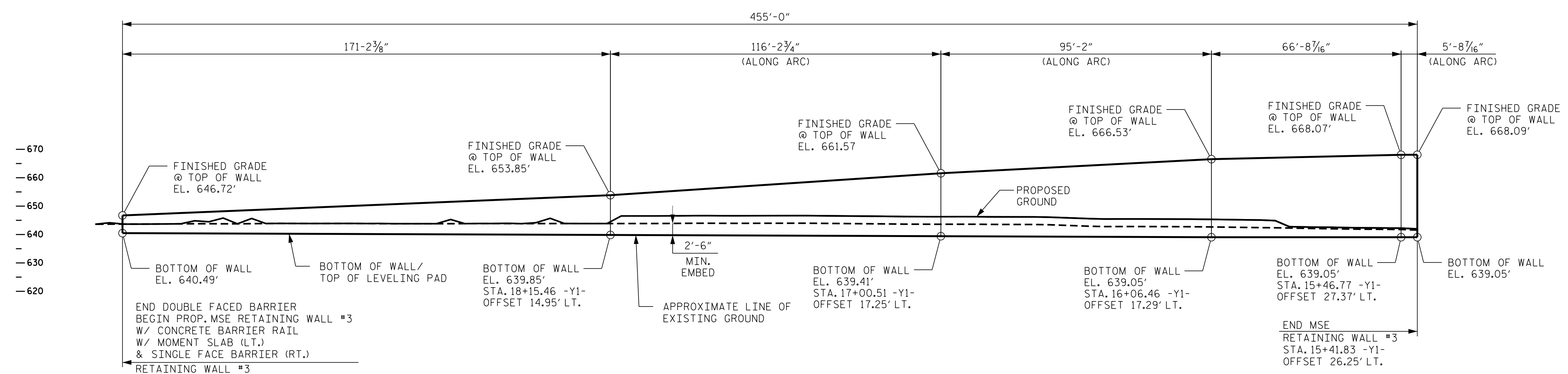

**ELEVATION OF MSE RETAINING WALL #3 AT END BENT 2**  
ALL DIMENSIONS AND STATIONS ARE ALONG FRONT FACE OF WALL  
LOOKING AT THE FRONT FACE OF WALL

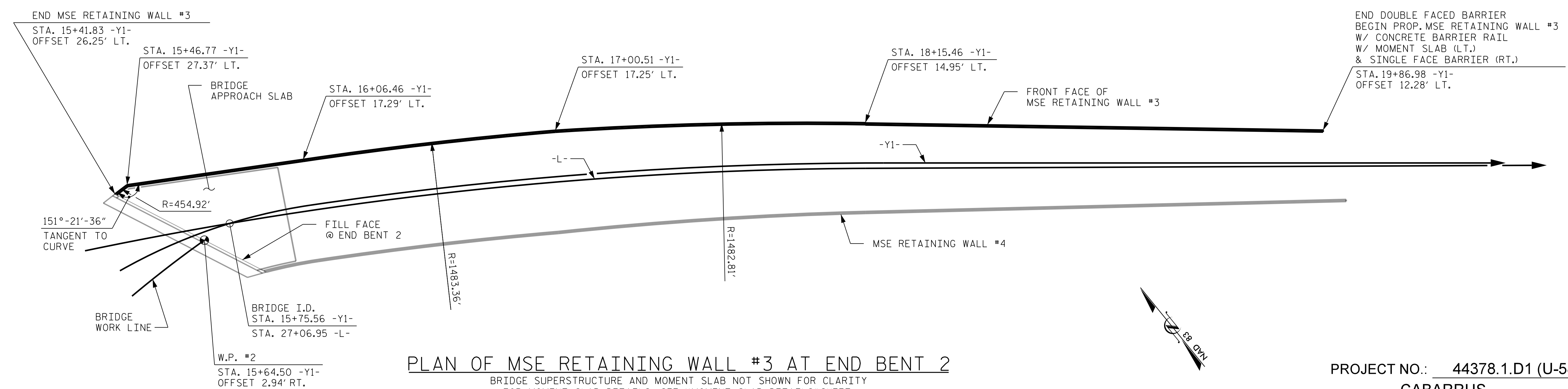

**PLAN OF MSE RETAINING WALL #3 AT END BENT 2**  
BRIDGE SUPERSTRUCTURE AND MOMENT SLAB NOT SHOWN FOR CLARITY  
FOR MOMENT SLAB DETAILS, SEE "MOMENT SLAB DETAILS" SHEET.

ESTIMATED WALL QUANTITY	
RETAINING WALL NO. 3	* 8,220 SQUARE FEET
* WALL AREA IS MEASURED USING THE DESIGN HEIGHT "H"	

PREPARED BY: MHS	DATE: 9/28/17
REVIEWED BY: SCC	DATE: 9/28/17

**NORTH CAROLINA  
DEPARTMENT OF TRANSPORTATION  
DIVISION OF HIGHWAYS**

**GEOTECHNICAL  
ENGINEERING UNIT**

PROJECT NO.: 44378.1.D1 (U-5806)  
CABARRUS COUNTY  
STATION: RWAL03 - STA. 15+41.83 -Y1-  
SHEET 3 OF 6 TO 21+00.51 -Y1-

REVISIONS						SHEET NO. W-3
NO.	BY	DATE	NO.	BY	DATE	
1	MHS	11/7/17	3	-	-	
2	-	-	4	-	-	

GEOTECHNICAL ENGINEER

ENGINEER

SEAL 028893

MICHAEL H. STEPHENS

11/7/2017

DOCUMENT NOT CONSIDERED FINAL UNLESS ALL SIGNATURES COMPLETED

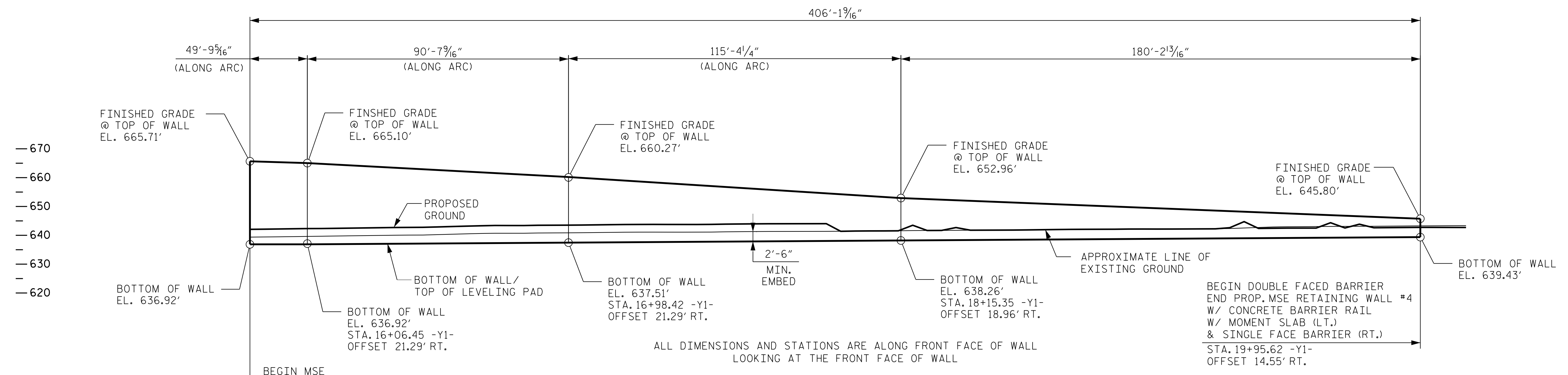

ELEVATION OF MSE RETAINING WALL #4 AT END BENT 2

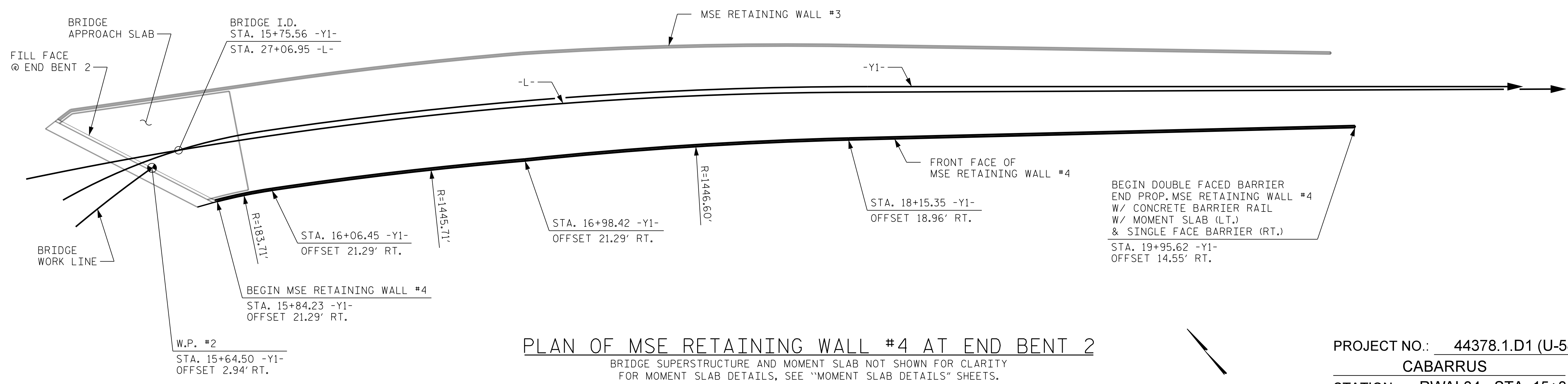

PLAN OF MSE RETAINING WALL #4 AT END BENT 2

BRIDGE SUPERSTRUCTURE AND MOMENT SLAB NOT SHOWN FOR CLARITY FOR MOMENT SLAB DETAILS, SEE "MOMENT SLAB DETAILS" SHEETS.

PROJECT NO.: 44378.1.D1 (U-5806)  
 CABARRUS COUNTY  
 STATION: RWAL04 - STA. 15+84.23 -Y1- TO 20+25.98 -Y1-  
 SHEET 4 OF 6

ESTIMATED WALL QUANTITY	
RETAINING WALL NO. 4	* 4,425 SQUARE FEET

\* WALL AREA IS MEASURED USING THE DESIGN HEIGHT "H"

PREPARED BY: MHS	DATE: 9/28/17
REVIEWED BY: SCC	DATE: 9/28/17

NORTH CAROLINA DEPARTMENT OF TRANSPORTATION DIVISION OF HIGHWAYS

GEOTECHNICAL ENGINEERING UNIT

REVISIONS						SHEET NO.
NO.	BY	DATE	NO.	BY	DATE	
1	MHS	11/7/17	3			W-4
2			4			

GEOTECHNICAL ENGINEER

SEAL  
028893  
ENGINEER  
MICHAEL H. STEPHENS  
1/7/2017

ENGINEER

\_\_\_\_\_  
SIGNATURE      DATE

**DOCUMENT NOT CONSIDERED FINAL  
UNLESS ALL SIGNATURES COMPLETED**

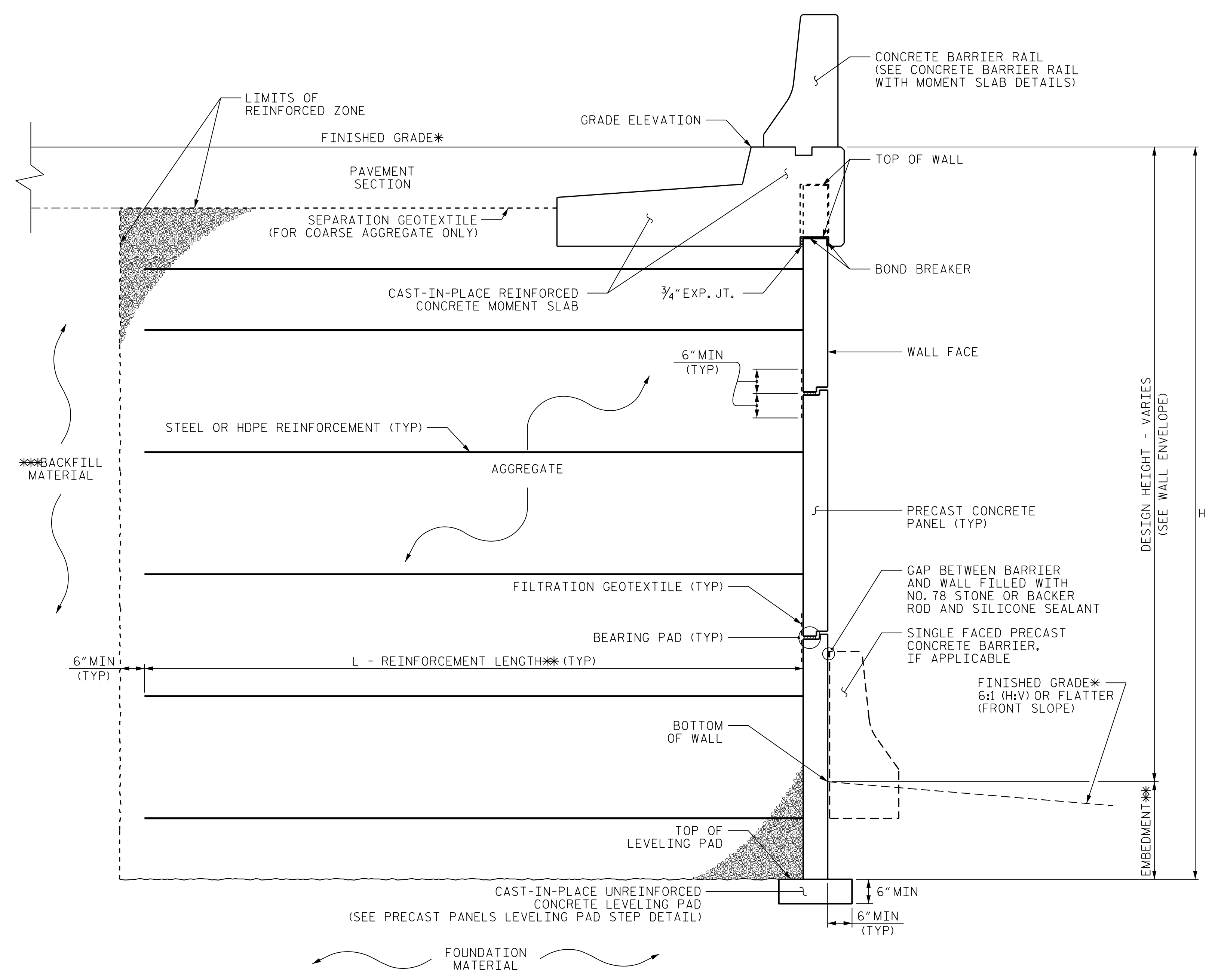

**MSE WALL WITH PRECAST PANELS - TYPICAL SECTION**

\*SEE ROADWAY PLANS FOR FINISHED GRADE DETAILS.  
 \*\*SEE MSE RETAINING WALLS PROVISION AND IF APPLICABLE, MSE WALL NOTES FOR EMBEDMENT AND REINFORCEMENT LENGTH REQUIREMENTS.  
 \*\*\*BACKFILL MATERIAL IS THE SAME AS COARSE OR FINE AGGREGATE USED IN REINFORCED ZONE.

PROJECT NO.: 44378.1.D1 (U-5806)  
CABARRUS COUNTY  
 STATION: RWAL01 - RWAL04  
 SHEET 5 OF 6

PREPARED BY: MHS      DATE: 9/28/17  
 REVIEWED BY: SCC      DATE: 9/28/17

**NORTH CAROLINA**  
**DEPARTMENT OF TRANSPORTATION**  
**DIVISION OF HIGHWAYS**  
  
**GEOTECHNICAL**  
**ENGINEERING UNIT**

REVISIONS						SHEET NO. W-5
NO.	BY	DATE	NO.	BY	DATE	
1	-	-	3	-	-	
2	-	-	4	-	-	

GEOTECHNICAL ENGINEER

ENGINEER

SIGNATURE: *Michael H. Stephens*      DATE: 11/7/2017

---

**DOCUMENT NOT CONSIDERED FINAL  
UNLESS ALL SIGNATURES COMPLETED**

**NOTES:**

FOR MECHANICALLY STABILIZED EARTH (MSE) RETAINING WALLS, SEE MECHANICALLY STABILIZED EARTH RETAINING WALLS SPECIAL PROVISION.

FOR SINGLE FACED PRECAST CONCRETE BARRIER, SEE ROADWAY PLANS AND SECTION 857 OF THE STANDARD SPECIFICATIONS.

A CONCRETE BARRIER RAIL WITH MOMENT SLAB IS REQUIRED FOR RETAINING WALLS 1, 2, 3, AND 4. SEE PLANS FOR CONCRETE BARRIER RAIL WITH MOMENT SLAB DETAILS.

A SIMULATED BRICK FORM LINER FINISH IS REQUIRED FOR PRECAST CONCRETE PANELS FOR RETAINING WALLS 1, 2, 3, AND 4. SEE SPECIAL PROVISION.

AT THE CONTRACTOR'S OPTION, USE FINE AGGREGATE IN THE REINFORCED ZONE OF RETAINING WALLS 1, 2, 3, AND 4.

A SEPARATION GEOTEXTILE IS NOT REQUIRED AT THE BACK OF THE REINFORCED ZONE FOR RETAINING WALLS 1, 2, 3, AND 4.

A DRAIN IS NOT REQUIRED FOR RETAINING WALLS 1, 2, 3, AND 4.

BEFORE BEGINNING MSE WALL DESIGN FOR RETAINING WALLS 1, 2, 3, AND 4, SURVEY WALL LOCATION AND SUBMIT A REVISED WALL PROFILE VIEW (WALL ENVELOPE) FOR REVIEW. DO NOT START WALL DESIGN OR CONSTRUCTION UNTIL THE REVISED WALL ENVELOPE IS ACCEPTED.

DESIGN RETAINING WALL NOS. 1, 2, 3, AND 4 FOR THE FOLLOWING:

- 1) H = DESIGN HEIGHT + EMBEDMENT
- 2) DESIGN LIFE = 100 YEARS
- 3) MINIMUM REINFORCEMENT LENGTH (L) = 0.7H OR 6 FT, WHICHEVER IS LONGER
- 4) MINIMUM EMBEDMENT ELEVATION = 2.5 FT OR H/20, WHICHEVER IS GREATER.
- 5) REINFORCED ZONE AGGREGATE PARAMETERS:

AGGREGATE TYPE*	UNIT WEIGHT (g) LB/CF	FRICTION ANGLE (f) DEGREES	COHESION (c) LB/SF
COARSE	110	38	0
FINE	115	34	0

\*SEE MSE RETAINING WALLS PROVISION FOR COARSE AND FINE AGGREGATE MATERIAL REQUIREMENTS.

6) IN-SITU ASSUMED MATERIAL PARAMETERS:

MATERIAL TYPE	UNIT WEIGHT (g) LB/CF	FRICTION ANGLE (f) DEGREES	COHESION (c) LB/SF
BACKFILL (COARSE)	110	38	0
BACKFILL (FINE)	115	34	0
FOUNDATION	120	30	0

7) MAXIMUM FACTORED VERTICAL PRESSURE ON FOUNDATION MATERIAL

RETAINING WALL	MAXIMUM FACTORED VERTICAL PRESSURE, LB/SF		
	WALL HEIGHT <10 FT	WALL HEIGHT 10 FT - 20 FT	WALL HEIGHT >20 FT
RETAINING WALL NOS. 1, 2, 3, AND 4	4,500	9,500	11,600

DESIGN RETAINING WALL NOS. 1, 2, 3, AND 4 FOR A LIVE LOAD (TRAFFIC) SURCHARGE.

FOUNDATIONS FOR SIGNS, LIGHTING, OR SIGNAL MAY BE LOCATED BEHIND RETAINING WALL NOS. 1, 2, 3, AND 4 AND MAY INTERFERE WITH REINFORCEMENT. BEFORE BEGINNING MSE WALL CONSTRUCTION, SUBMIT PROPOSED CONSTRUCTION METHODS FOR THESE FOUNDATIONS FOR APPROVAL.

EXISTING OR FUTURE OBSTRUCTIONS SUCH AS FOUNDATIONS, GUARDRAIL, FENCE OR HANDRAIL POSTS, PAVEMENTS, PIPES, INLETS OR UTILITIES MAY INTERFERE WITH REINFORCEMENT FOR RETAINING WALL NOS. 1, 2, 3, AND 4.

DO NOT PLACE LEVELING PAD CONCRETE, AGGREGATE OR REINFORCEMENT FOR RETAINING WALL NOS. 1, 2, 3, AND 4 UNTIL EXCAVATION DIMENSIONS AND FOUNDATION MATERIAL ARE APPROVED.

FOR RETAINING WALL NOS. 1, 2, 3, AND 4 PROVIDE DETAILS ON THE MSE WALL AND CONCRETE ABUTMENT WALL INTERFACE.

SHOP DRAWINGS FOR RETAINING WALL NOS. 1 AND 2 (END BENT NO. 1) WILL BE SUBMITTED CONCURRENTLY FOR REVIEW PURPOSES.

SHOP DRAWINGS FOR RETAINING WALL NOS. 3 AND 4 (END BENT NO. 2) WILL BE SUBMITTED CONCURRENTLY FOR REVIEW PURPOSES.

BACKFILL AREA BETWEEN PARALLEL MSE WALLS WITH COARSE OR FINE AGGREGATE TO THE TOP OF THE REINFORCED ZONE SEE BACKFILL DETAIL. BACKFILL PAYMENT WILL BE INCIDENTAL TO WALL, SEE MSE WALL SPECIAL PROVISION.

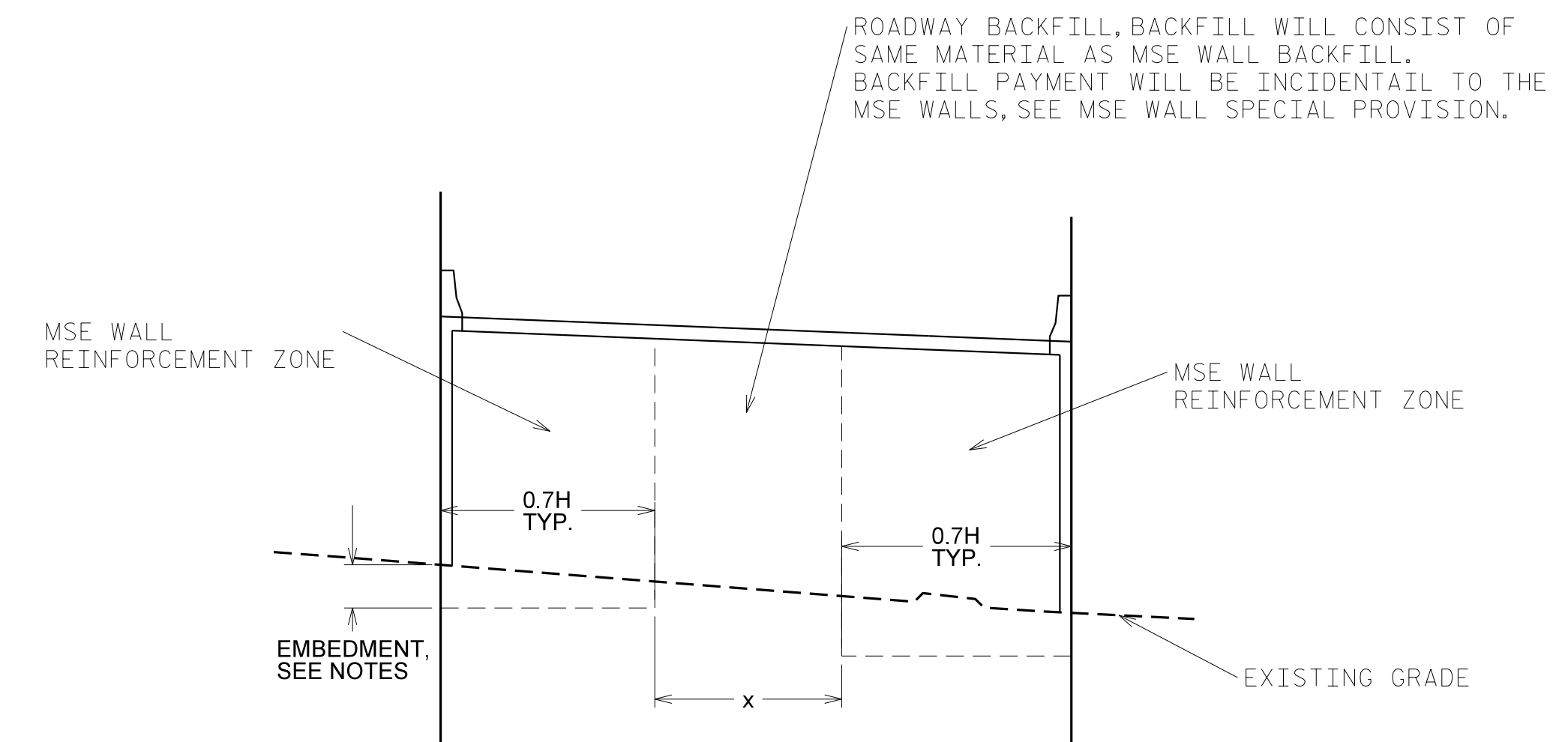

**TYPICAL BACKFILL DETAILS AT  
STA 17+50 -Y1-**

X - VARIES DEPENDING ON REINFORCEMENT LENGTH AND WALL HEIGHT

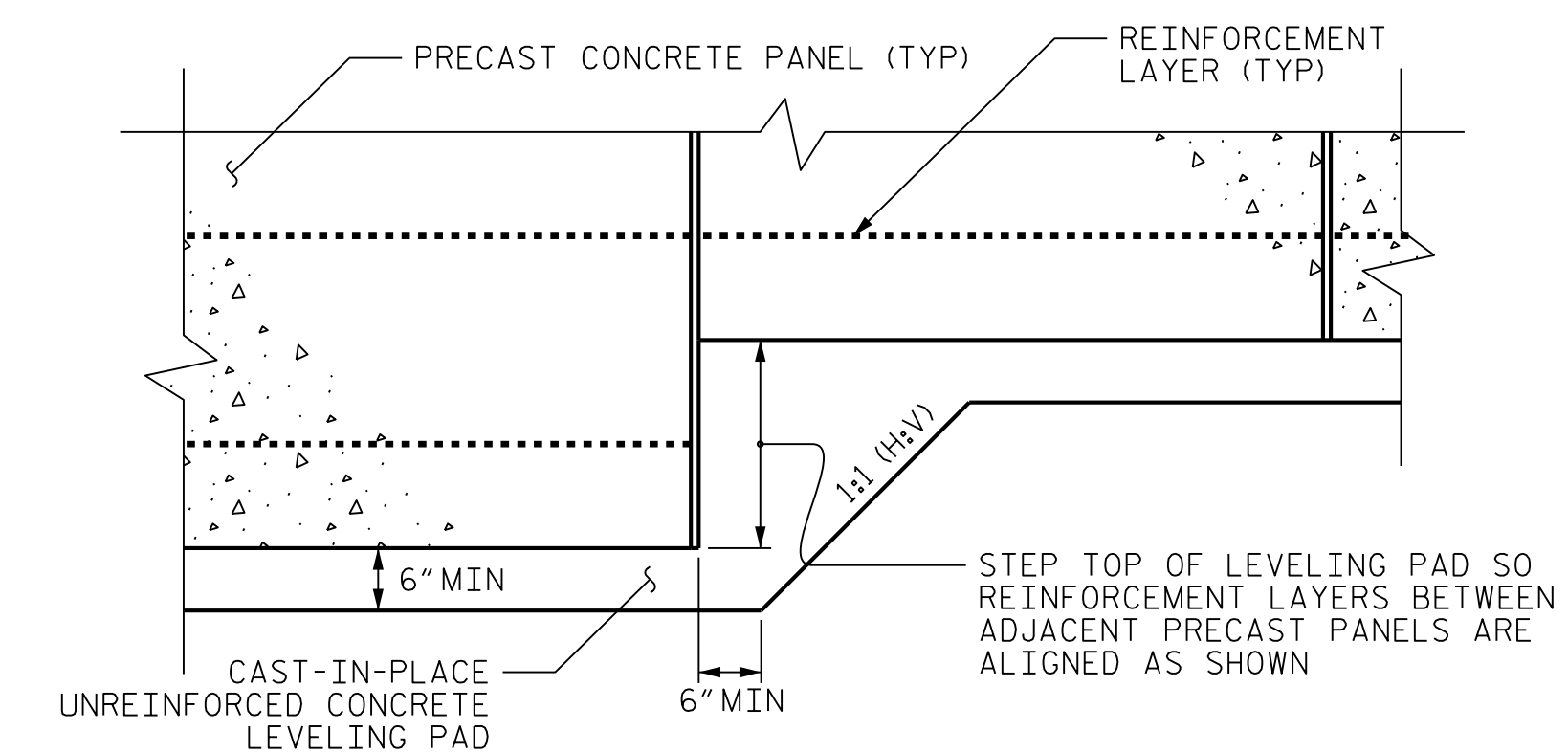

**PRECAST PANELS  
LEVELING PAD STEP DETAIL**

PROJECT NO.: 44378.1.D1 (U-5806)  
CABARRUS COUNTY  
 STATION: RWAL01 - RWAL04  
 SHEET 6 OF 6

**NORTH CAROLINA  
DEPARTMENT OF TRANSPORTATION  
DIVISION OF HIGHWAYS**

**GEOTECHNICAL  
ENGINEERING UNIT**

NOTES AND DETAILS MSE WALL					
REVISIONS					
NO.	BY	DATE	NO.	BY	DATE
1	-	-	3	-	-
2	-	-	4	-	-

SHEET NO. W-6

PREPARED BY: MHS	DATE: 9/28/17
REVIEWED BY: SCC	DATE: 9/28/17