

**NOTES:**

FOR SPACING OF "B" BARS, SEE "MOMENT SLAB DETAILS" SHEET 3 OF 3.  
 FOR SECTION A-A, SEE "MOMENT SLAB DETAILS" SHEET 3 OF 3.

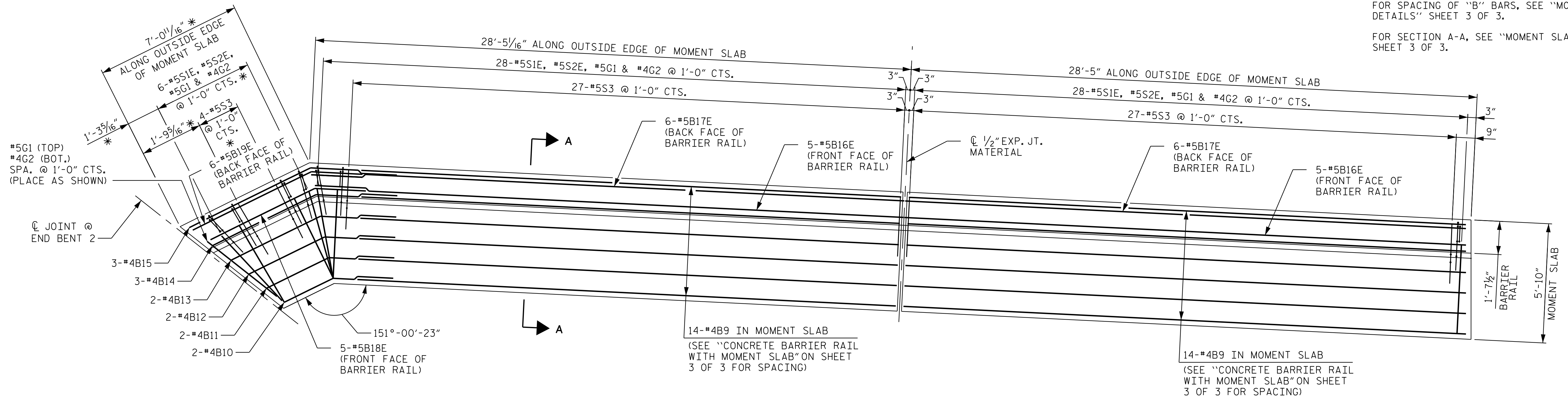

**LEFT SIDE OF STRUCTURE**  
 \* MEASURED ALONG ARC

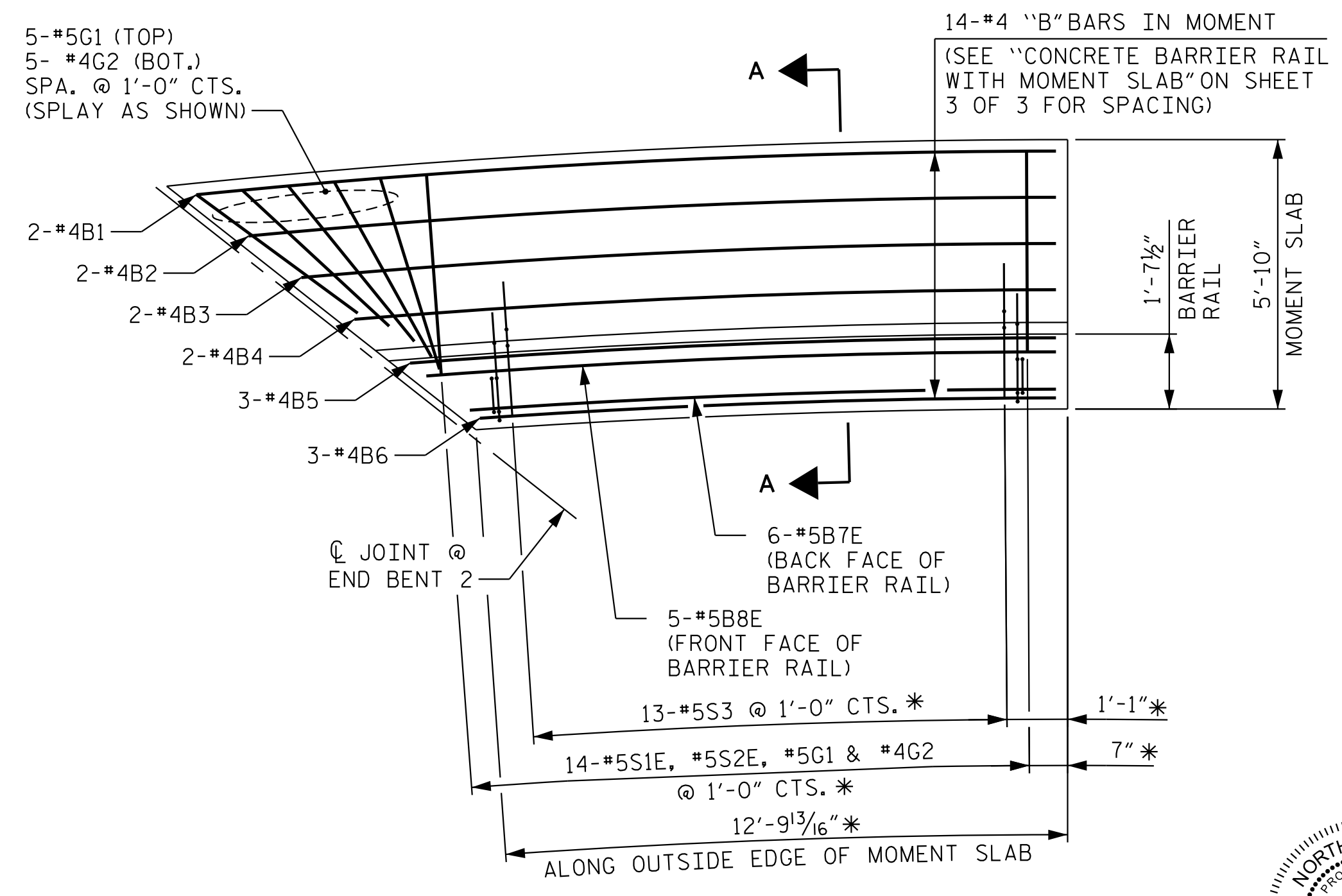

**RIGHT SIDE OF STRUCTURE**  
 \* MEASURED ALONG ARC

**PLAN OF MOMENT SLAB @ END BENT 2**

PROJECT NO. U-5806  
CABARRUS COUNTY  
 STATION: 15+75.56 -Y1-  
27+06.95 -L-  
 SHEET 2 OF 3

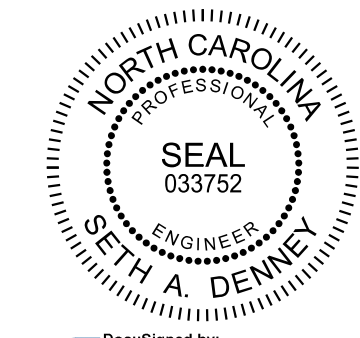

Designed by:  
 Seth A. Denney  
 EREB154CCREDK10  
 10/23/2017

Designed by:  
 Andrew L. Phillips  
 28B9ABAD4DD0D3  
 10/23/2017

STATE OF NORTH CAROLINA  
 DEPARTMENT OF TRANSPORTATION  
 RALEIGH

**MOMENT SLAB DETAILS**

| REVISIONS |     |       |     |     |       | SHEET NO.    |
|-----------|-----|-------|-----|-----|-------|--------------|
| NO.       | BY: | DATE: | NO. | BY: | DATE: | S-49         |
| 1         |     |       | 3   |     |       | TOTAL SHEETS |
| 2         |     |       | 4   |     |       | 50           |

**Kimley»Horn**  
 421 Fayetteville Street, Suite 600  
 Raleigh, NC 27601-1772  
 Phone (919) 677-2000  
 NC LICENSE # F-0102

**DOCUMENT NOT CONSIDERED FINAL  
 UNLESS ALL SIGNATURES COMPLETED**

K:\B01\_Structures\Bridges\NC\011036388 - U-5806 - Final Design\Cad\Drawings\U-5806\_MSD02.dgn  
 10/23/2017

|  |                    |
|--|--------------------|
| DRAWN BY: <u>D. D. LOWERY</u>                  | DATE: <u>10/17</u> |
| CHECKED BY: <u>A. L. PHILLIPS</u>              | DATE: <u>10/17</u> |
| DESIGN ENGINEER OF RECORD: <u>S. A. DENNEY</u> | DATE: <u>10/17</u> |