

TYPICAL SECTION AT END BENT DIAPHRAGMS

NOTES:

PROVIDE 1/4" HIGH BEAM BOLSTERS UPPER AT 5'-0" CTS. ATOP THE METAL STAY-IN-PLACE FORMS TO SUPPORT THE BOTTOM MAT OF "A" BARS. WHEN USING REMOVABLE FORMS, PROVIDE CONTINUOUS HIGH CHAIRS FOR METAL DECK (C.H.C.M.) @ 5'-0" CTS. WITH A HEIGHT TO SUPPORT THE BOTTOM MAT OF "A" BARS A CLEAR DISTANCE OF 2 1/2" ABOVE THE TOP OF THE REMOVABLE FORM.

FOR MORE INFORMATION REGARDING THE DIAPHRAGMS SEE "STRUCTURAL STEEL DETAILS" SHEETS.

BARRIER RAIL SHALL NOT BE CAST UNTIL ALL SLAB CONCRETE HAS BEEN CAST AND REACHED A MINIMUM COMPRESSIVE STRENGTH OF 3,000 PSI. FOR MORE INFORMATION SEE CONSTRUCTION SEQUENCE.

REINFORCING STEEL MAY BE SHIFTED SLIGHTLY, AS NECESSARY, TO CLEAR EXPANSION JOINT COMPONENTS.

THE CONTRACTOR MAY, WHEN NECESSARY, PROPOSE A SCHEME FOR AVOIDING INTERFERENCE BETWEEN METAL STAY-IN-PLACE FORM SUPPORTS OR FORMS AND GIRDER STIFFENERS OR CONNECTOR PLATES. THE PROPOSAL SHALL BE INDICATED, AS APPROPRIATE, ON EITHER THE STEEL WORKING DRAWINGS OR THE METAL STAY-IN-PLACE FORM WORKING DRAWING.

THE CONTRACTOR SHALL ADJUST THE GIRDER BUILD-UPS AS NECESSARY TO INCORPORATE A MAXIMUM PERMISSIBLE VARIATION IN DISC BEARING DEPTH OF 2". SEE SPECIAL PROVISION FOR DISC BEARINGS.

THE CONTRACTOR SHALL ENSURE THE STABILITY OF THE GIRDER WEB DURING CONSTRUCTION BASED ON THE OVERHANG SUPPORT SYSTEM USED.

FOR 4" Ø ELECTRICAL CONDUIT DETAILS, SEE "ELECTRICAL CONDUIT SYSTEM FOR SIGNALS" SHEET.

TYPICAL SECTION

\* RADIAL DIMENSIONS  
 \*\* 10 5/8" (RADIAL DIMENSION) ALONG C/BRG. END BENT 1  
 5'-0 1/16" ALONG C/BRG. END BENT 2

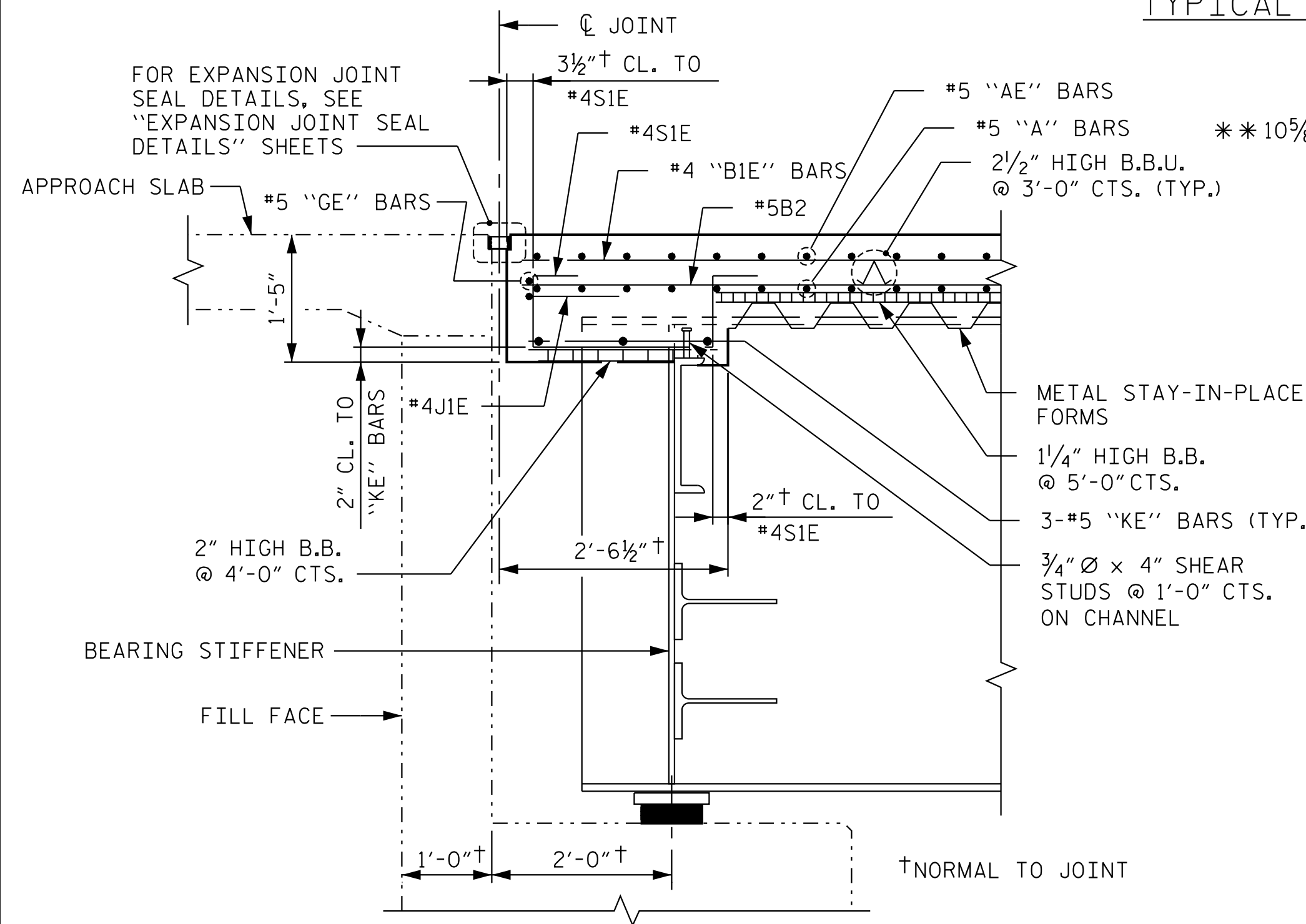

SECTION THRU END BENT DIAPHRAGM

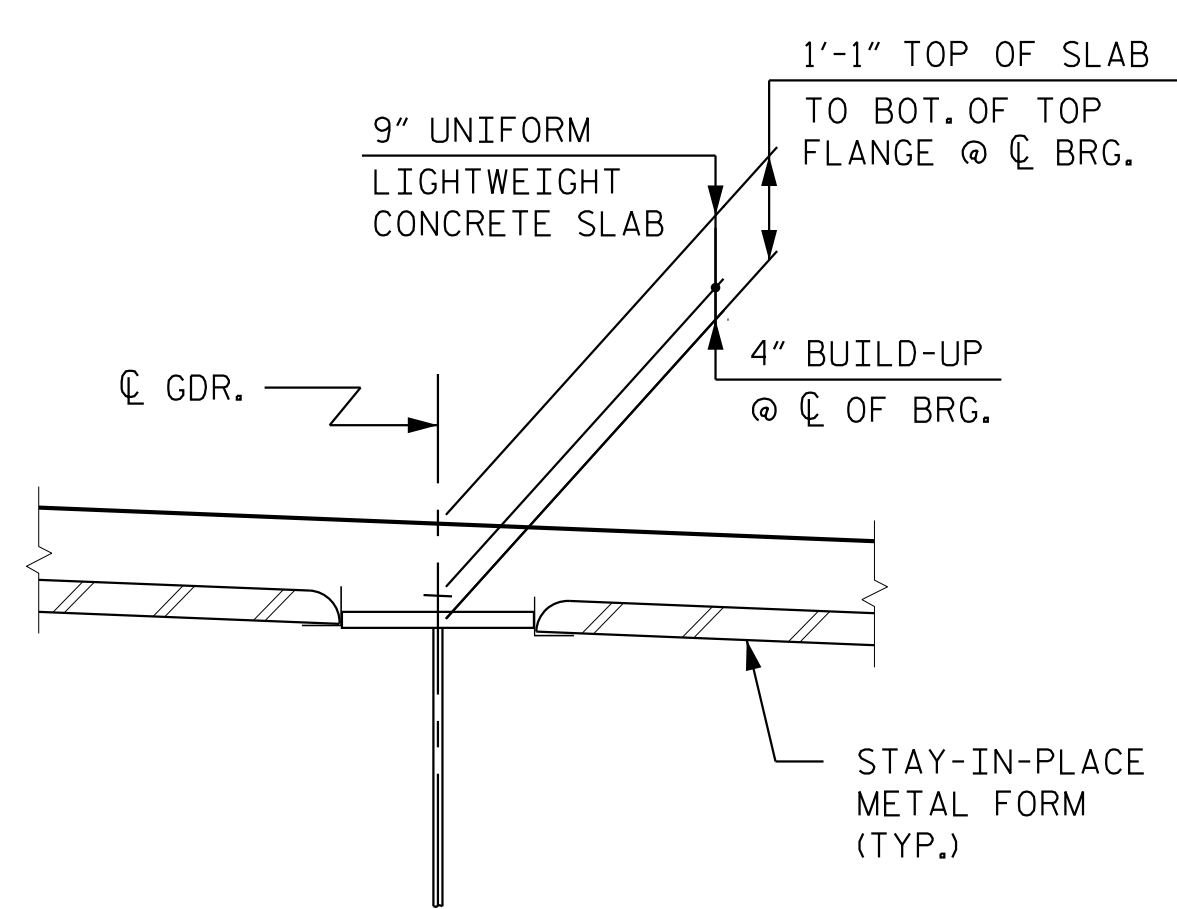

DETAIL "A"  
 (TYP. @ EA. GDR.)

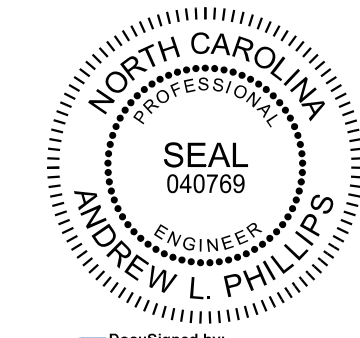
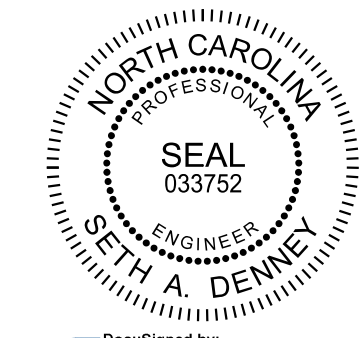

Designed by:  
 Seth A. Denney  
 EREB154CRED410  
 10/23/2017

Designed by:  
 Andrew L. Phillips  
 2869ABAD40DD03  
 10/23/2017

**Kimley»Horn**

421 Fayetteville Street, Suite 600  
 Raleigh, NC 27601-1772  
 Phone (919) 677-2000  
 NC LICENSE # F-0102

PROJECT NO. U-5806  
CABARRUS COUNTY  
 STATION: 15+75.56 -Y1-  
27+06.95 -L-

SHEET 1 OF 2  
 STATE OF NORTH CAROLINA  
 DEPARTMENT OF TRANSPORTATION  
 RALEIGH  
 SUPERSTRUCTURE  
 TYPICAL SECTION

REVISIONS						SHEET NO. S-11
NO.	BY:	DATE:	NO.	BY:	DATE:	
1			3			TOTAL SHEETS 50
2			4			

**DOCUMENT NOT CONSIDERED FINAL  
 UNLESS ALL SIGNATURES COMPLETED**

This document, together with the concepts and designs presented herein, is an integral part of the project. It is not to be used for any other project without written authorization and approval by Kimley-Horn and Associates, Inc. shall be without liability to Kimley-Horn and Associates, Inc.  
 Copyright Kimley-Horn and Associates, Inc. 2017

K:\B01-Structures\Bridges\AK\01036388 - U-5806 Final Design\Cad\Drawn\U-5806-ISO.dgn  
 10/23/2017

DRAWN BY: D. D. LOWERY DATE: 10/17  
 CHECKED BY: A. L. PHILLIPS DATE: 10/17  
 DESIGN ENGINEER OF RECORD: S. A. DENNEY DATE: 10/17