

BENCH MARK: SURVEY POINT BY5-404, 74.39' LT STA. 26+83.69 -L-, EL. 644.32'

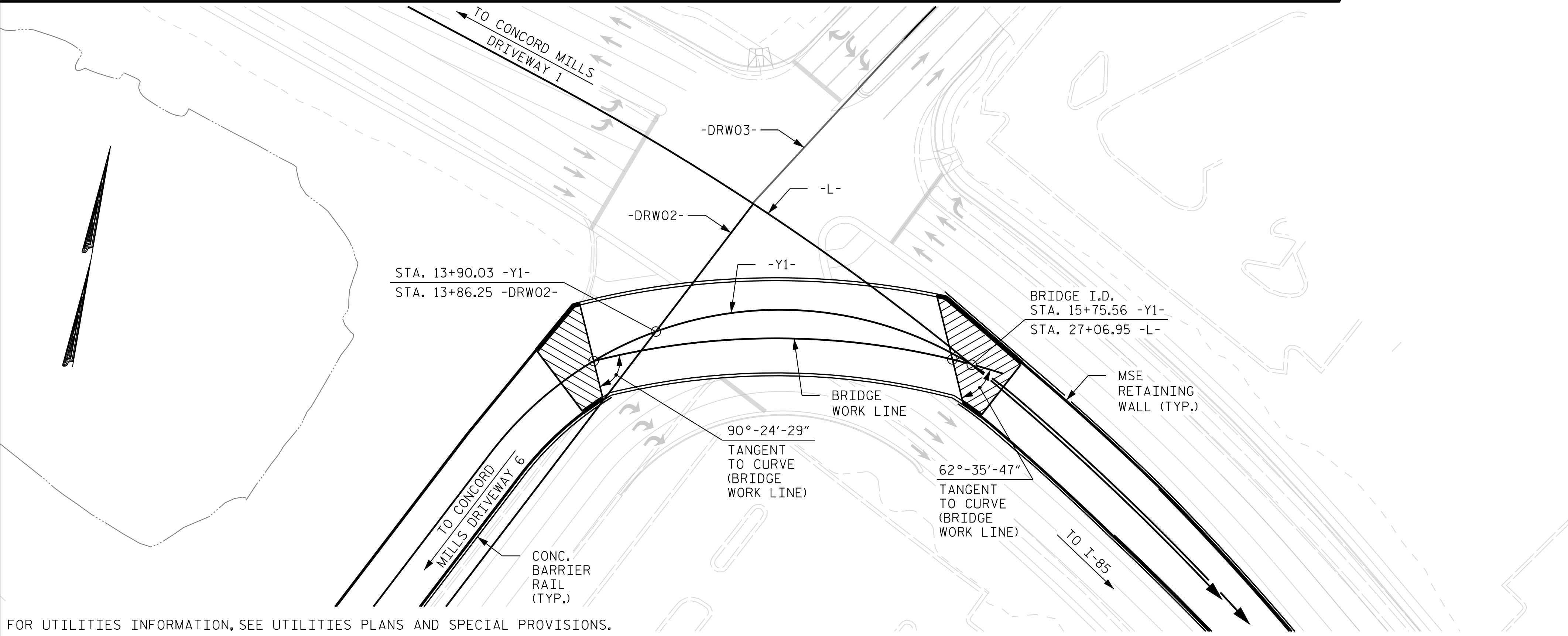

FOR UTILITIES INFORMATION, SEE UTILITIES PLANS AND SPECIAL PROVISIONS.

LOCATION SKETCH

TOTAL BILL OF MATERIAL

	FOUNDATION EXCAVATION FOR END BENT	REINFORCED CONCRETE DECK SLAB (SAND-LIGHT WEIGHT CONC.)	GROOVING BRIDGE FLOORS	CLASS A CONCRETE	BRIDGE APPROACH SLABS	REINFORCING STEEL	APPROX. 1,073,598 LBS. STRUCTURAL STEEL *	CONCRETE BARRIER RAIL	DISC BEARINGS	EXPANSION JOINT SEALS	ELECTRICAL CONDUIT SYSTEM FOR SIGNALS	CONCRETE BARRIER RAIL WITH MOMENT SLAB
	LUMP SUM	SQ. FT.	SQ. FT.	CU. YDS.	LUMP SUM	LBS.	LUMP SUM	LIN. FT.	LUMP SUM	LUMP SUM	LUMP SUM	LIN. FT.
SUPERSTRUCTURE		11,151	12,228		LUMP SUM		LUMP SUM	405.0	LUMP SUM	LUMP SUM	LUMP SUM	
END BENT NO. 1	LUMP SUM			494.7		66,592						616.6
END BENT NO. 2	LUMP SUM			589.1		77,882						971.6
TOTAL	LUMP SUM	11,151	12,228	1083.8	LUMP SUM	144,474	LUMP SUM	405.0	LUMP SUM	LUMP SUM	LUMP SUM	1,588.2

NOTES

- ASSUMED LIVE LOAD = HL-93 OR ALTERNATE LOADING.
- THIS BRIDGE HAS BEEN DESIGNED IN ACCORDANCE WITH THE AASHTO LRFD BRIDGE DESIGN SPECIFICATIONS.
- THIS BRIDGE IS LOCATED IN SEISMIC ZONE 1.
- FOR OTHER DESIGN DATA AND GENERAL NOTES, SEE SHEET SN.
- FOR SUBMITTAL OF WORKING DRAWINGS, SEE SPECIAL PROVISIONS.
- FOR FALSEWORK AND FORMWORK, SEE SPECIAL PROVISIONS.
- FOR CRANE SAFETY, SEE SPECIAL PROVISIONS.
- FOR GROUT FOR STRUCTURES, SEE SPECIAL PROVISIONS.
- FOR MASS CONCRETE AT END BENT NOS. 1 AND 2, SEE SPECIAL PROVISIONS.
- THE ELEVATIONS AND CLEARANCES SHOWN ON THE PLANS AT THE POINTS OF MINIMUM VERTICAL CLEARANCE ARE FROM THE BEST INFORMATION AVAILABLE. PRIOR TO BEGINNING BRIDGE CONSTRUCTION, VERIFY THE ELEVATIONS ON THE EXISTING PAVEMENT AND CHECK THE CLEARANCE. REPORT ANY VARIATIONS TO THE ENGINEER. ANY PLAN REVISIONS TO ACHIEVE THE REQUIRED MINIMUM VERTICAL CLEARANCE WILL BE PROVIDED BY THE DEPARTMENT.
- FOR MAINTENANCE AND PROTECTION OF THE TRAFFIC BENEATH PROPOSED STRUCTURE, SEE SPECIAL PROVISIONS.
- REMOVABLE FORMS MAY BE USED IN LIEU OF METAL STAY-IN-PLACE FORMS IN ACCORDANCE WITH ARTICLE 420-3 OF THE STANDARD SPECIFICATIONS.
- NEEDLE BEAMS WILL NOT BE ALLOWED UNLESS OTHERWISE CALLED FOR ON THE PLANS OR APPROVED BY THE ENGINEER.
- THE TOP AND BOTTOM FLANGES IN THE MIDDLE SECTION (SEGMENT 2) OF SPAN A SHALL BE AASHTO M270 GRADE 70W AND PAINTED IN ACCORDANCE WITH SYSTEM 4 OF ARTICLE 442-8 OF THE STANDARD SPECIFICATIONS.
- ALL OTHER STRUCTURAL STEEL SHALL BE AASHTO M270 GRADE 50W AND PAINTED IN ACCORDANCE WITH SYSTEM 4 OF ARTICLE 442-8 OF THE STANDARD SPECIFICATIONS.
- FOR PLACING LOAD ON STRUCTURE MEMBERS, SEE SPECIAL PROVISIONS.
- THE DECK CONCRETE IN SPAN A AND ALL BARRIER RAILS SHALL BE SAND-LIGHTWEIGHT CONCRETE. FOR SAND-LIGHTWEIGHT CONCRETE, SEE SPECIAL PROVISIONS.
- FOR EROSION CONTROL MEASURES, SEE EROSION CONTROL PLANS.
- THE SAND LIGHTWEIGHT CONCRETE IN THE BRIDGE DECK SHALL CONTAIN FLY ASH OR GROUND GRANULATED BLAST FURNACE SLAG AT THE SUBSTITUTION RATE SPECIFIED IN ARTICLE 1024-1 AND IN ACCORDANCE WITH ARTICLES 1024-5 AND 1024-6 OF THE STANDARD SPECIFICATIONS. NO PAYMENT WILL BE MADE FOR THIS SUBSTITUTION AS IT IS CONSIDERED INCIDENTAL TO THE COST OF THE REINFORCED CONCRETE DECK SLAB.

\* APPROXIMATE STRUCTURAL STEEL WEIGHT PAY ITEM INCLUDES ALL STRUCTURAL STEEL FOR THE SIGNAL SUPPORT BRACKETS.

PROJECT NO. U-5806  
CABARRUS COUNTY  
 STATION: 15+75.56 -Y1-  
27+06.95 -L-

SHEET 4 OF 4

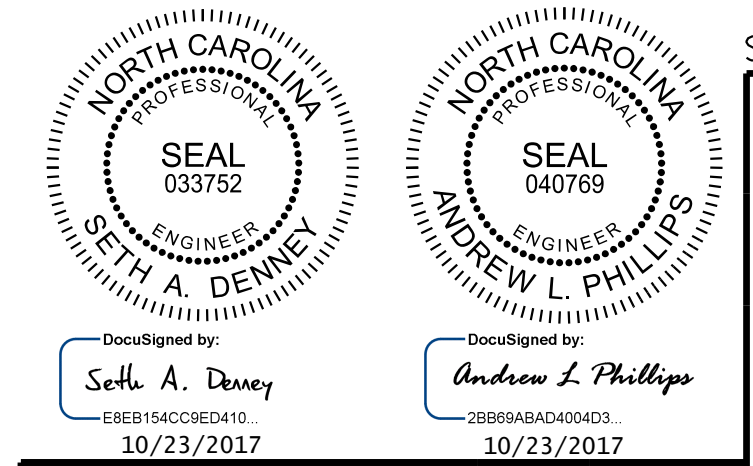

STATE OF NORTH CAROLINA  
 DEPARTMENT OF TRANSPORTATION  
 RALEIGH

GENERAL DRAWING  
 FOR FLYOVER BRIDGE FROM  
 CONCORD MILLS BLVD TO  
 ENTRANCE OF CONCORD MILLS  
 (KINGS GRANT PAVILION)

**Kimley»Horn**  
 421 Fayetteville Street, Suite 600  
 Raleigh, NC 27601-1772  
 Phone (919) 677-2000  
 NC LICENSE # F-0102

REVISIONS						SHEET NO.
NO.	BY:	DATE:	NO.	BY:	DATE:	
1			3			TOTAL SHEETS
2			4			50

**DOCUMENT NOT CONSIDERED FINAL  
 UNLESS ALL SIGNATURES COMPLETED**

DRAWN BY: D. D. LOWERY DATE: 10/17  
 CHECKED BY: A. L. PHILLIPS DATE: 10/17  
 DESIGN ENGINEER OF RECORD: S. A. DENNEY DATE: 10/17

10/23/2017 K:\BID Structures\Bridges\NC\011036388 - U-5806 Final Design\Cad\Drawn\004\_U-5806\_LSD.dgn