

**This electronic collection of documents is provided
for the convenience of the user
and is Not a Certified Document –**

**The documents contained herein were originally issued
and sealed by the individuals whose names and license
numbers appear on each page, on the dates appearing
with their signature on that page.**

**This file or an individual page
shall not be considered a certified document.**

STATE OF NORTH CAROLINA
DIVISION OF HIGHWAYS

TRANSPORTATION MANAGEMENT PLAN

PENDER COUNTY

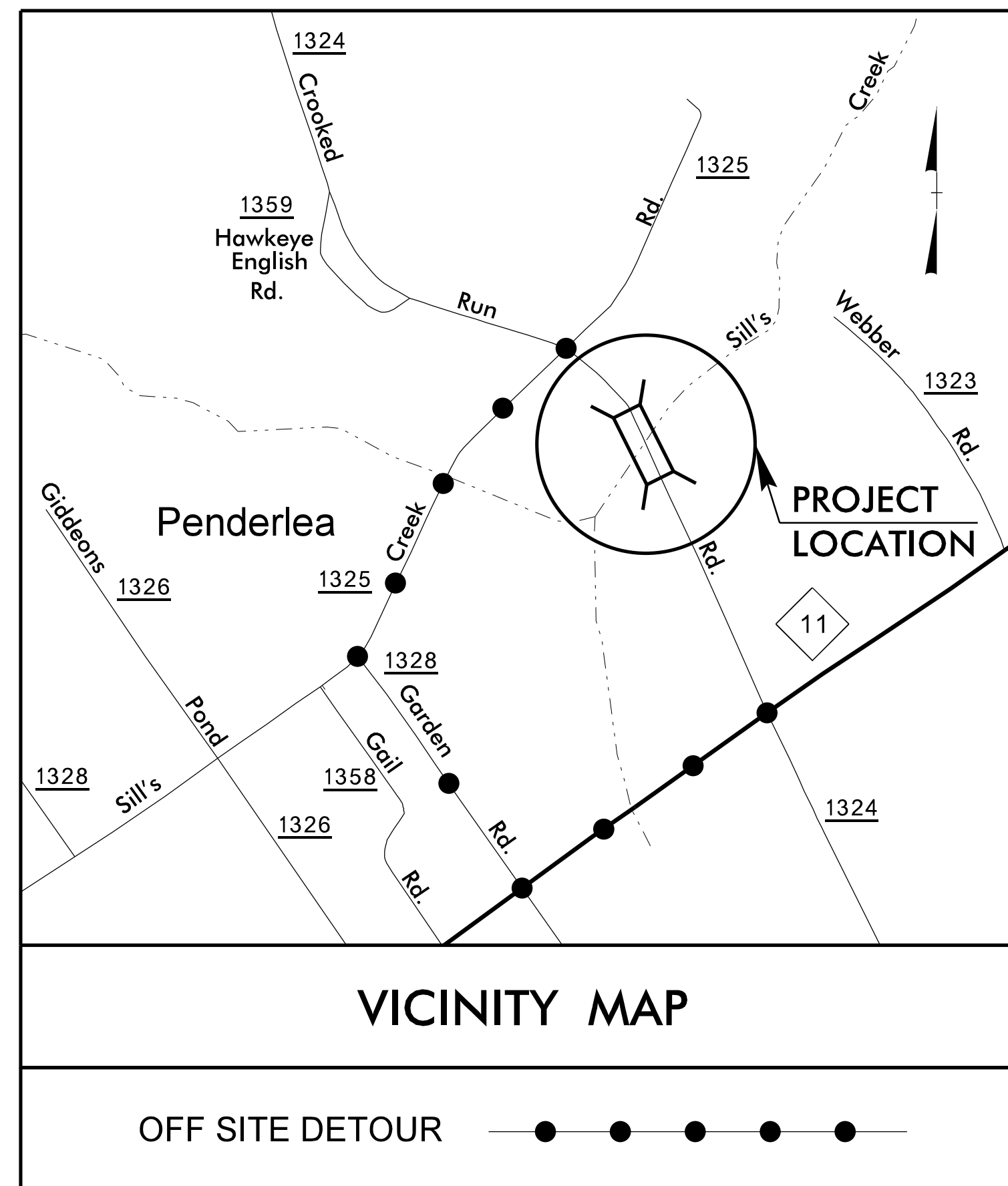
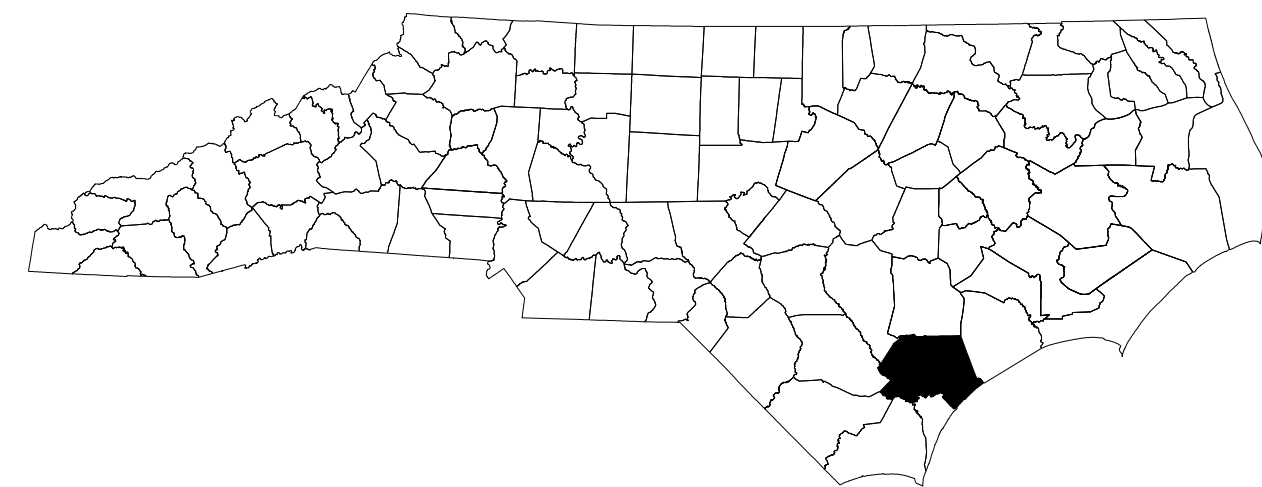

LOCATION: REPLACE BRIDGE NO. 203 OVER SILL'S CREEK ON SR 1324

ATKINS 1616 EAST MILLBROOK ROAD, SUITE 160
RALEIGH, NORTH CAROLINA 27609
(919) 876-6888 NCBEE# #F-0326

INDEX OF SHEETS

SHEET NO.	TITLE
TMP-1	TITLE SHEET, VICINITY MAP, AND INDEX OF SHEETS
TMP-1A	LIST OF APPLICABLE ROADWAY STANDARD DRAWINGS, LEGEND, GENERAL NOTES, AND PHASING
TMP-2	SPECIAL SIGN DESIGN
TMP-3	TEMPORARY TRAFFIC CONTROL - OFF-SITE DETOUR AND DETOUR SIGNS

SHEET NO.
TMP-1

13-JUL-2017 16:06 G:\Transportation\Traffic\NCDOT 10 Bridges\TMP\00053589 - B-5304 TMP Bridge Replace 589\TrafficControl\TCP\B-5304 TCP 01.dgn WLE2054 AT DUS300019

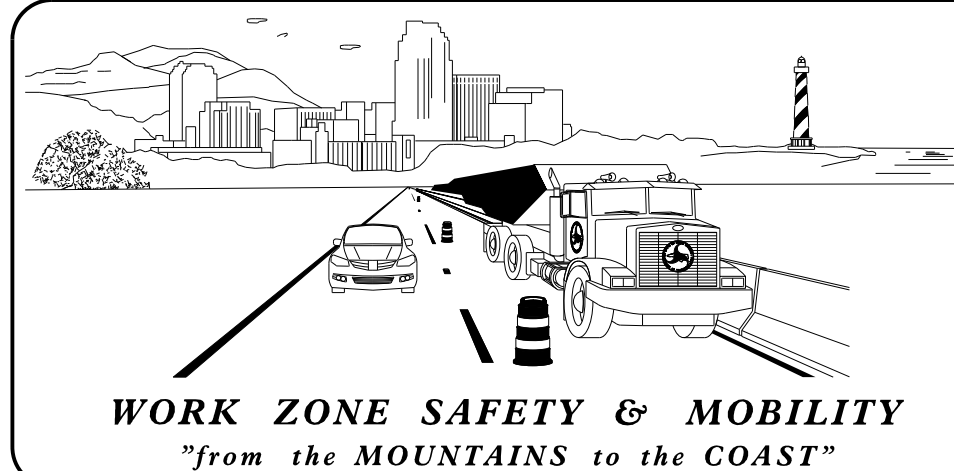

N.C.D.O.T. WORK ZONE TRAFFIC CONTROL
1561 MAIL SERVICE CENTER (MSC) RALEIGH, NC 27699-1561
750 N. GREENFIELD PARKWAY, GARNER, NC 27529 (DELIVERY)
PHONE: (919) 773-2800 FAX: (919) 771-2745

DR. J. HUMMER, P.E. STATE TRAFFIC MANAGEMENT ENGINEER
J. STEVE KITE, P.E. TRAFFIC CONTROL PROJECT ENGINEER
MATT SPRINGER, P.E. TRAFFIC CONTROL PROJECT DESIGN ENGINEER
TRAFFIC CONTROL DESIGN ENGINEER

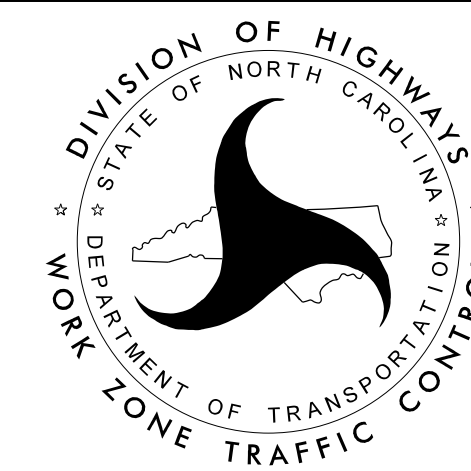

**DOCUMENT NOT CONSIDERED FINAL
UNLESS ALL SIGNATURES COMPLETED**

APPROVED _____
DATE: 7/13/2017

SEAL

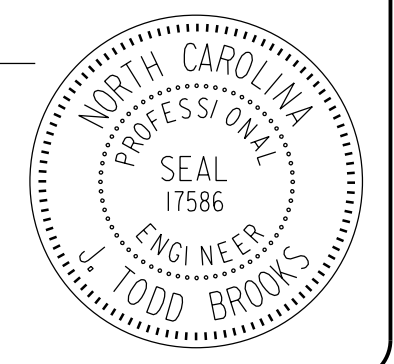

TIP PROJECT: B-5304

ROADWAY STANDARD DRAWINGS

THE FOLLOWING ROADWAY STANDARDS AS SHOWN IN "ROADWAY STANDARD DRAWINGS" - PROJECT SERVICES UNIT - N.C. DEPARTMENT OF TRANSPORTATION - RALEIGH, N.C., DATED JANUARY 2012 ARE APPLICABLE TO THIS PROJECT AND BY REFERENCE HEREBY ARE CONSIDERED A PART OF THESE PLANS:

STD. NO.	TITLE
1101.03	TEMPORARY ROAD CLOSURES
1101.11	TRAFFIC CONTROL DESIGN TABLES
1110.01	STATIONARY WORK ZONE SIGNS
1145.01	BARRICADES
1205.01	PAVEMENT MARKINGS - LINE TYPES AND OFFSETS
1205.01	PAVEMENT MARKINGS - LINE TYPES AND OFFSETS
1205.02	PAVEMENT MARKINGS - TWO-LANE AND MULTILANE ROADWAYS
1205.04	PAVEMENT MARKINGS - INTERSECTIONS
1205.12	PAVEMENT MARKINGS - BRIDGES
1250.01	RAISED PAVEMENT MARKERS - INSTALLATION SPACING
1251.01	RAISED PAVEMENT MARKERS - PERMANENT AND TEMPORARY

LEGEND

GENERAL

- DIRECTION OF TRAFFIC FLOW
- DIRECTION OF PEDESTRIAN TRAFFIC FLOW
- EXIST. PVMT.
- NORTH ARROW
- PROPOSED PVMT.
- TEMP. SHORING (LOCATION PURPOSES ONLY)
- WORK AREA
- REMOVAL

TRAFFIC CONTROL DEVICES

- BARRICADE (TYPE III)
- CONE
- DRUM SKINNY DRUM TUBULAR MARKER
- TEMPORARY CRASH CUSHION
- FLASHING ARROW BOARD
- FLAGGER
- LAW ENFORCEMENT
- TRUCK MOUNTED ATTENUATOR (TMA)
- CHANGEABLE MESSAGE SIGN

TEMPORARY SIGNING

- PORTABLE SIGN
- STATIONARY SIGN
- STATIONARY OR PORTABLE SIGN

GENERAL NOTES

CHANGES MAY BE REQUIRED WHEN PHYSICAL DIMENSIONS IN THE DETAIL DRAWINGS, STANDARD DETAILS AND ROADWAY DETAILS ARE NOT ATTAINABLE TO MEET FIELD CONDITIONS OR RESULT IN DUPLICATE OR UNDESIRED OVERLAPPING OF DEVICES. MODIFICATION MAY INCLUDE: MOVING, SUPPLEMENTING, COVERING, OR REMOVAL OF DEVICES AS DIRECTED BY THE ENGINEER.

THE FOLLOWING GENERAL NOTES APPLY AT ALL TIMES FOR THE DURATION OF THE CONSTRUCTION PROJECT EXCEPT WHEN OTHERWISE NOTED IN THE PLAN OR DIRECTED BY THE ENGINEER.

TRAFFIC PATTERN ALTERATIONS

- A) NOTIFY THE ENGINEER THIRTY-ONE (31) CALENDAR DAYS PRIOR TO ANY TRAFFIC PATTERN ALTERATION.

SIGNING

- B) INSTALL ADVANCED WORK ZONE WARNING SIGNS WHEN WORK IS WITHIN 40 FT FROM THE EDGE OF TRAVEL LANE AND NO MORE THAN THREE (3) DAYS PRIOR TO THE BEGINNING OF CONSTRUCTION.

- C) PROVIDE SIGNING AND DEVICES REQUIRED TO CLOSE THE ROAD ACCORDING TO THE ROADWAY STANDARD DRAWINGS AND TRAFFIC CONTROL PLANS.

PROVIDE SIGNING REQUIRED FOR THE OFF-SITE DETOUR ROUTE AS SHOWN IN THE TRAFFIC CONTROL PLANS.

- D) COVER OR REMOVE ALL SIGNS AND DEVICES REQUIRED TO CLOSE THE ROAD WHEN ROAD CLOSURE IS NOT IN OPERATION.

COVER OR REMOVE ALL SIGNS AND DEVICES REQUIRED FOR THE OFF-SITE DETOUR WHEN THE DETOUR IS NOT IN OPERATION.

- E) ENSURE ALL NECESSARY SIGNING IS IN PLACE PRIOR TO ALTERING ANY TRAFFIC PATTERN.

TRAFFIC CONTROL DEVICES

- F) PLACE TYPE III BARRICADES, WITH "ROAD CLOSED" SIGN R11-2 ATTACHED, OF SUFFICIENT LENGTH TO CLOSE ENTIRE ROAD.

PAVEMENT MARKINGS AND MARKERS

- G) TIE PROPOSED PAVEMENT MARKING LINES TO EXISTING PAVEMENT MARKING LINES.

- H) REMOVE/REPLACE ANY CONFLICTING/DAMAGED PAVEMENT MARKINGS AND MARKERS.

PHASING

STEP 1: INSTALL ALL DETOUR SIGNING KEEPING SIGNS COVERED (SEE SHEET TMP-3)

STEP 2: USING ROADWAY STANDARD DRAWING 1101.03, SHEETS 1 OR 9 AND 2 OF 9, CLOSE CROOKED RUN RD (SR 1324) TO TRAFFIC, PLACE TEMPORARY STOP BAR ON CROOKED RUN RD (SR 1324) AT THE APPROACH OF SILL'S CREEK RD USING ROADWAY STANDARD DRAWINGS 1205.01 AND 1205.04, UNCOVER ALL DETOUR SIGNING AND SHIFT TRAFFIC TO DETOUR (SEE SHEET TMP-3).

STEP 3: DISMANTLE AND REMOVE EXISTING BRIDGE

STEP 4: COMPLETE CONSTRUCTION OF PROPOSED STRUCTURE, APPROACH ROADWAY TIE-INS AND ASSOCIATED ITEMS INCLUDING FINAL PAVEMENT MARKINGS.

STEP 5: REMOVE ALL DETOUR SIGNING, ALL TEMPORARY TRAFFIC CONTROL DEVICES, THE TEMPORARY STOP SIGNS AND STOP BAR ON CROOKED RUN RD (SR 1324) AT THE APPROACH OF SILL'S CREEK RD, AND OPEN CROOKED RUN RD (SR 1324) TO TRAFFIC.

13-JUL-2017 16:06 G:\Transportation\Traffic\Curr\NCDOT 10 Bridges TMP\00053589 - B-5304 TMP Bridge Replace 589\Traffic\TrafficControl\TCP\B-5304 TCP 01A.dgn WILE2054 AT DUS300019

APPROVED: DATE: 7/13/2017 SEAL DOCUMENT NOT CONSIDERED FINAL UNLESS ALL SIGNATURES COMPLETED			ROADWAY STANDARD DRAWINGS, LEGEND, GENERAL NOTES AND PHASING
--	--	--	---

SIGN NUMBER: SP1 TYPE: STATIONARY QUANTITY: SEE PLANS SIGN WIDTH: 3'-0" HEIGHT: 1'-6" TOTAL AREA: 4.5 Sq.Ft. BORDER TYPE: INSET RECESS: 0.38" WIDTH: 0.5" RADII: 1.5" NO. Z BARS: LENGTH:	BACKG COLOR: Fluorescent Orange COPY COLOR: Black <table border="1" style="width: 100%; text-align: center;"> <thead> <tr> <th>SYMBOL</th> <th>X</th> <th>Y</th> <th>WID</th> <th>HT</th> </tr> </thead> <tbody> <tr><td> </td><td> </td><td> </td><td> </td><td> </td></tr> <tr><td> </td><td> </td><td> </td><td> </td><td> </td></tr> <tr><td> </td><td> </td><td> </td><td> </td><td> </td></tr> <tr><td> </td><td> </td><td> </td><td> </td><td> </td></tr> <tr><td> </td><td> </td><td> </td><td> </td><td> </td></tr> <tr><td> </td><td> </td><td> </td><td> </td><td> </td></tr> <tr><td> </td><td> </td><td> </td><td> </td><td> </td></tr> </tbody> </table> MAT'L: 0.080" (2.0 mm) ALUMINUM	SYMBOL	X	Y	WID	HT																																				DESIGN BY: LD STOUCHKO PROJECT ID: B-5304 CHECKED BY: LOCATION: PENDER COUNTY DATE: Mar 23, 2017 DIV: 3
SYMBOL	X	Y	WID	HT																																						

BORDER R=1.5"
 TH=0.5"
 IN=0.38"
 Panel Style: const rect.ssi
 M.U.T.C.D.: 2009 Edition

Spacing Factor is 1 unless specified otherwise

LETTER POSITIONS

Letter locations are panel edge to lower left corner

	C	R	O	O	K	E	D														Series/Size Text Length
	5.6	9.4	13	16.8	20.8	24.4	27.8														C 2000 25.1
	3.5	7.2	11.1	13.9	18.9	22.4	26	29.9													C 2000 29.2

NORTH CAROLINA D.O.T. SIGN DETAIL

13-JUL-2017 16:06
 G:\Transportation\Traffic\NCDOT 10 Bridges\TMP\000053589 - B-5304 TMP Bridge Replace 589\Traffic\TrafficControl\TCP\B-5304 TCP 02.dgn
 WILE2054 AT DUS300019

APPROVED: DATE: 7/13/2017 SEAL			CROOKED RUN ROAD (SR 1324) SPECIAL SIGN DESIGN
DOCUMENT NOT CONSIDERED FINAL UNLESS ALL SIGNATURES COMPLETED			

★ NOTE: DURING CLOSURE OF CROOKED RUN RD, PLACE TEMPORARY STOP BAR ON CROOKED RUN RD AT THE APPROACH OF SILLS CREEK RD. (RSD 1101.03, 1205.01 AND 1205.04) REMOVE TEMPORARY STOP BAR AND TEMPORARY STOP SIGNS ON CROOKED RUN RD AT THE INTERSECTION OF SILLS CREEK RD WHEN THE ROAD IS OPENED TO TRAFFIC. RETAIN EXISTING STOP SIGNS AND STOP BARS ON SILLS CREEK RD AT CROOKED RUN RD.

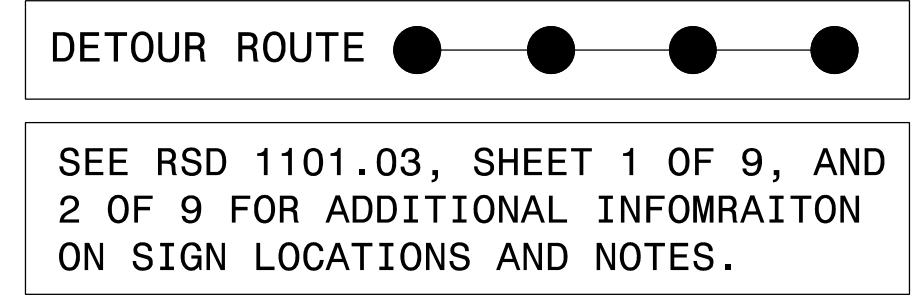
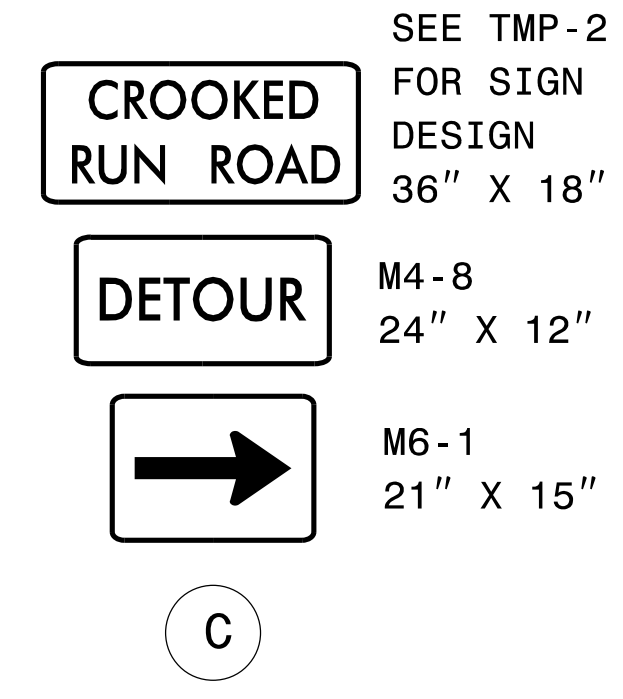
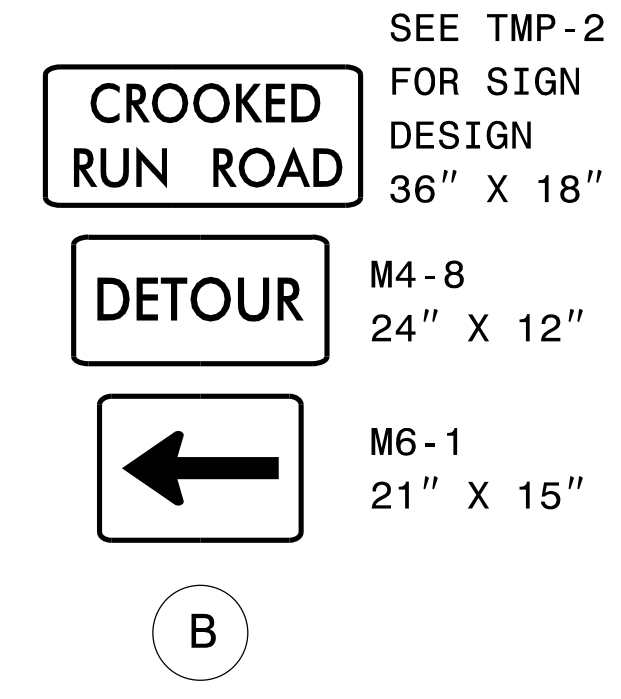
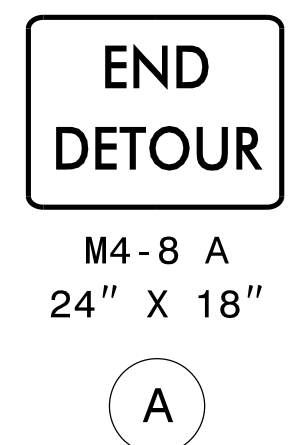
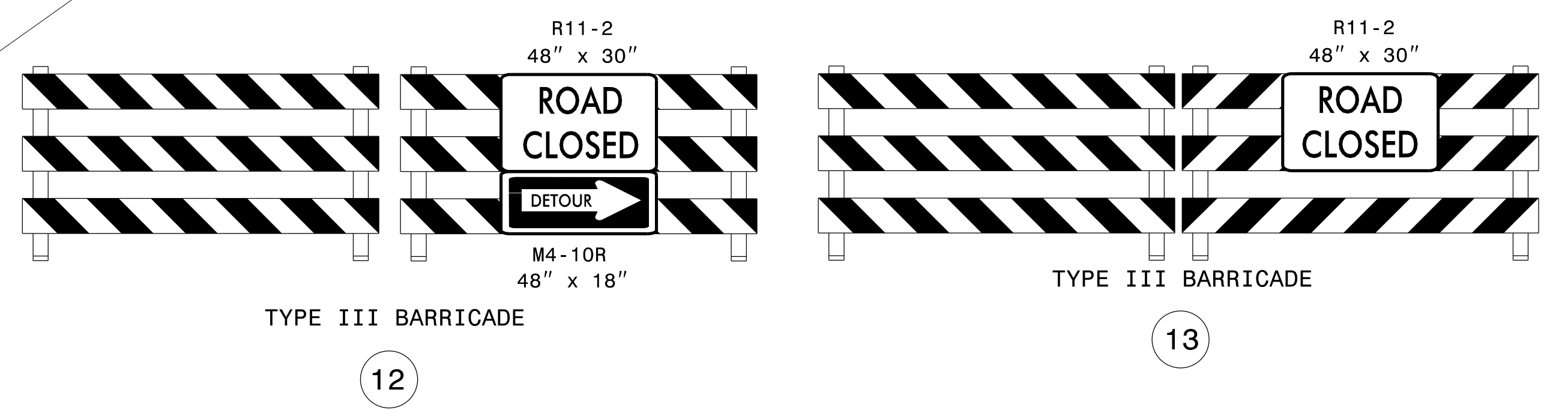
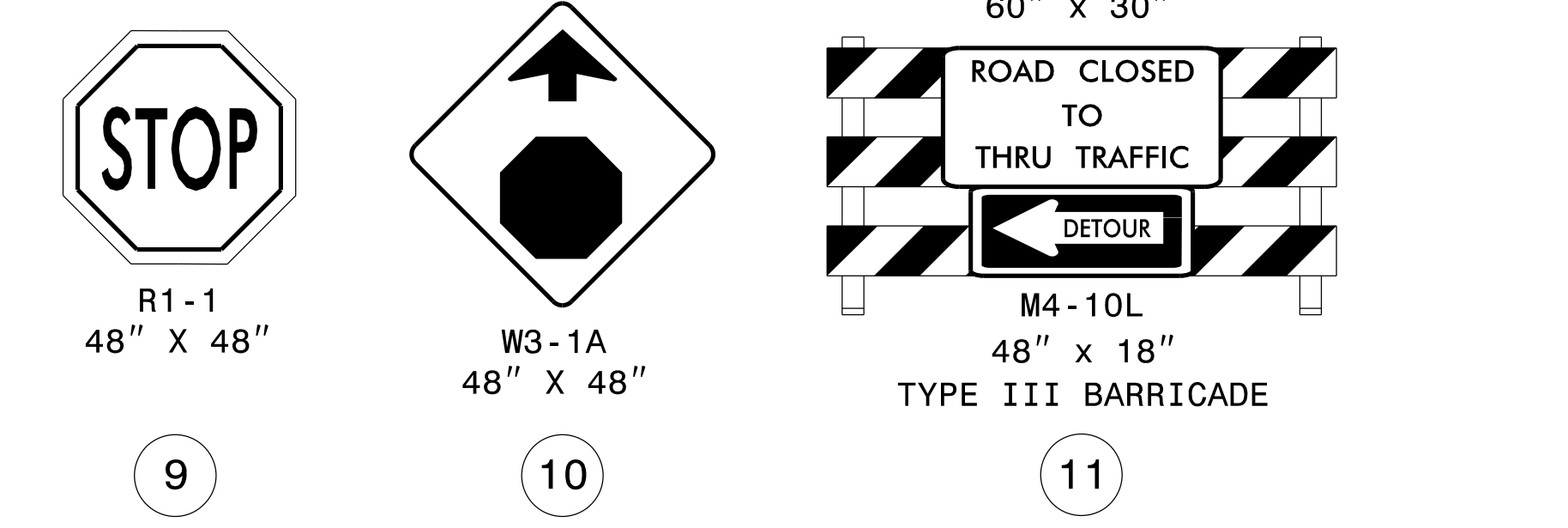
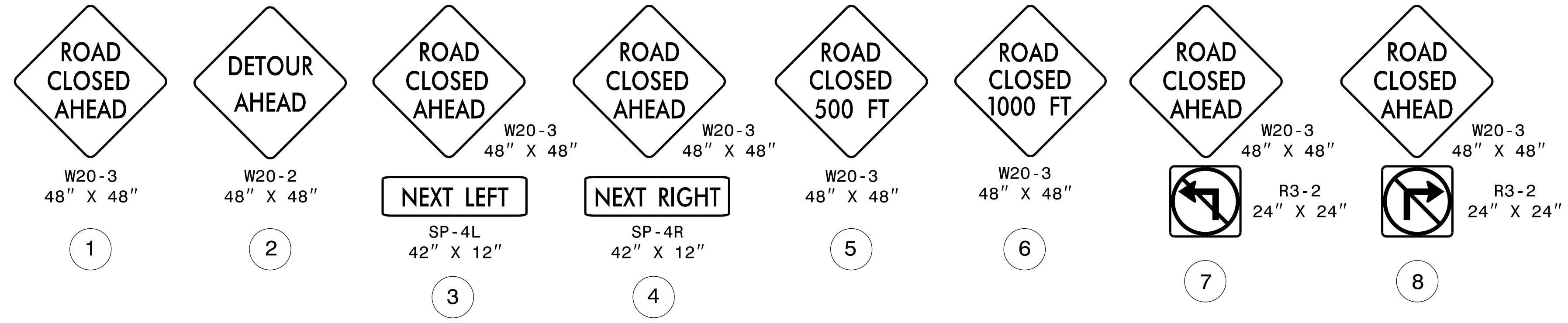
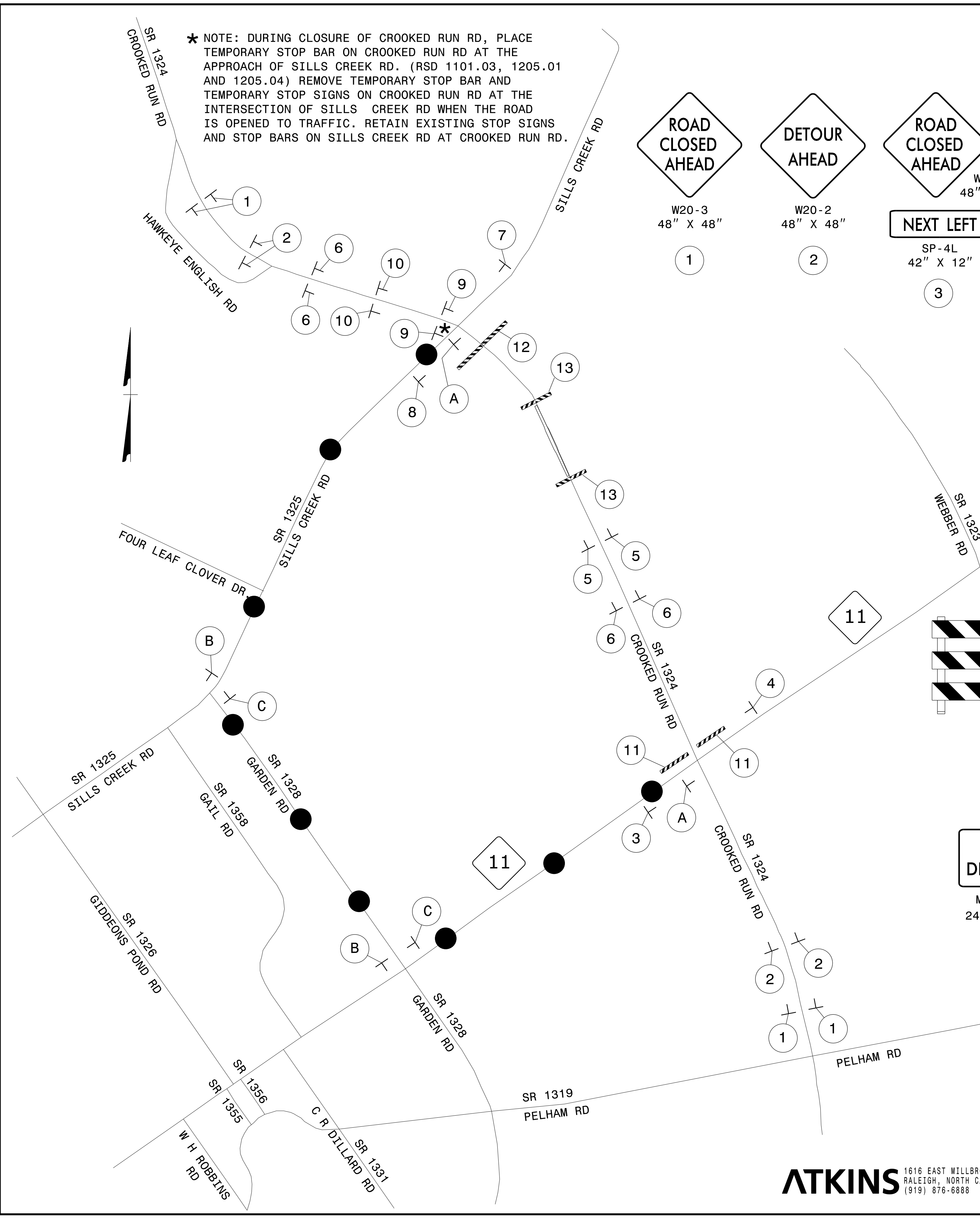

13-JUL-2017 16:06 G:\Transportation\TrafficControl\B-5304 TMP Bridge Replace 589\TrafficControl\B-5304 TCP 03.dgn

ATKINS 1616 EAST MILLBROOK ROAD, SUITE 160
RALEIGH, NORTH CAROLINA 27609
(919) 876-6888 NCBEES #F-0326

APPROVED: DATE: 7/13/2017
SEAL
DOCUMENT NOT CONSIDERED FINAL UNLESS ALL SIGNATURES COMPLETED

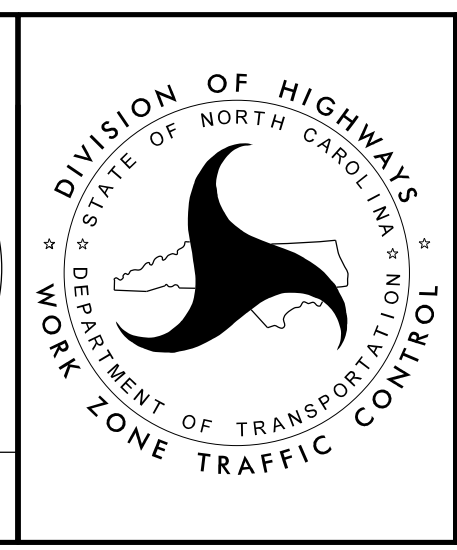

CROOKED RUN ROAD (SR 1324) OFF-SITE DETOUR AND DETOUR SIGNS