

THE ESTIMATED QUANTITY OF DUCTILE IRON WATER PIPE FITTINGS ON THIS PLAN SHEET IS 3330 POUNDS. THE ACTUAL QUANTITY AND TYPE OF FITTINGS WILL VARY BASED ON FIELD CONDITIONS.

STV/Ralph Whitehead Associates, Inc.  
1000 West Morehead St., Ste. 200  
Charlotte, NC 28208  
NC License Number F-0991

PROJECT REFERENCE NO. U-4751 SHEET NO. UC-12



UTILITY CONSTRUCTION PLANS  
DOCUMENT NOT CONSIDERED FINAL  
UNLESS ALL SIGNATURES COMPLETED

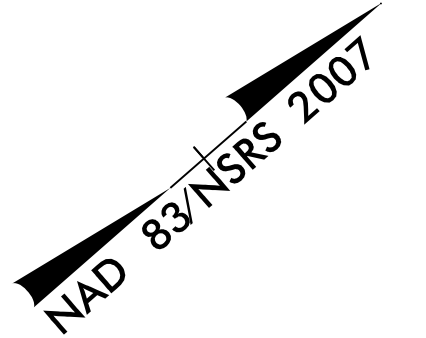

- 114 COURTNEY PINES HOA  
DB 4889 PG 3128  
MB 48 PG 180
- 134 GREG L BRYANT  
DB 5244 PG 1507  
MB 48 PG 180
- 136 AMY R KROEPLIN  
DB 5451 PG 1390  
MB 52 PG 41
- 138 JOHN HOLT  
DB 5587 PG 1094  
MB 48 PG 180
- 139 MARY ANNE MUNTO  
DB 5470 PG 94  
MB 52 PG 41
- 140 GEORGE A SCHMITT  
DB 5462 PG 2757  
MB 52 PG 41
- 141 RROBERT THRONE  
DB 5233 PG 1624  
MB 48 PG 180
- 142 AMANDA ROSE MARIE LABENNE  
DB 5814 PG 2541  
MB 52 PG 41
- 144 BRADLEY R CARTER  
DB 5197 PG 2149  
MB 48 PG 180

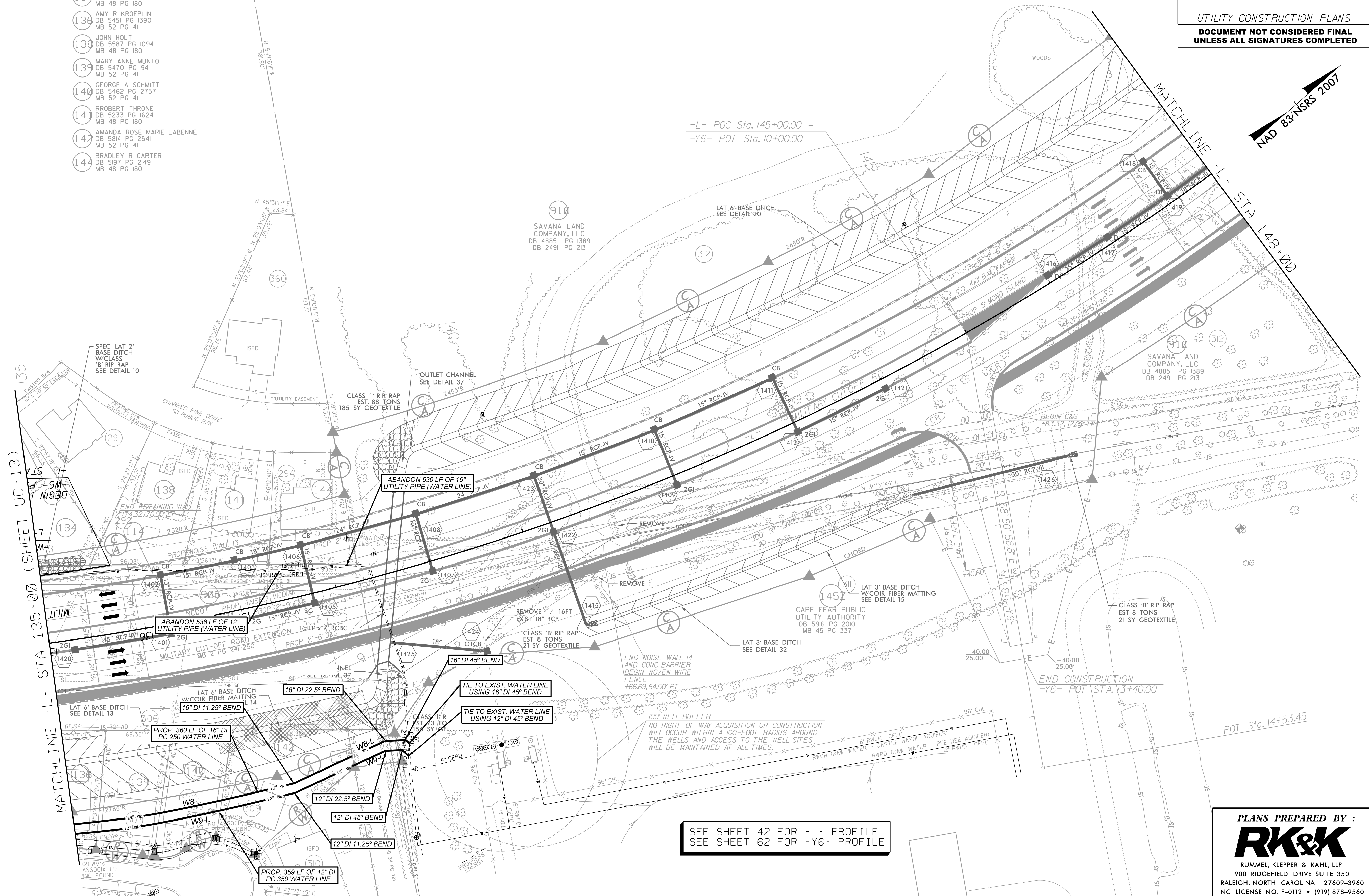

MATCHLINE -L- STA 135+00 (SHEET UC-13)

MATCHLINE -L- STA 148+00

SEE SHEET 42 FOR -L- PROFILE  
SEE SHEET 62 FOR -Y6- PROFILE

PLANS PREPARED BY :  
**RK&K**  
RUMMEL, KLEPPER & KAHL, LLP  
900 RIDGEFIELD DRIVE SUITE 350  
RALEIGH, NORTH CAROLINA 27609-3960  
NC LICENSE NO. F-0112 • (919) 878-9560