

DB 4889 PG 3128
MB 48 PG 180

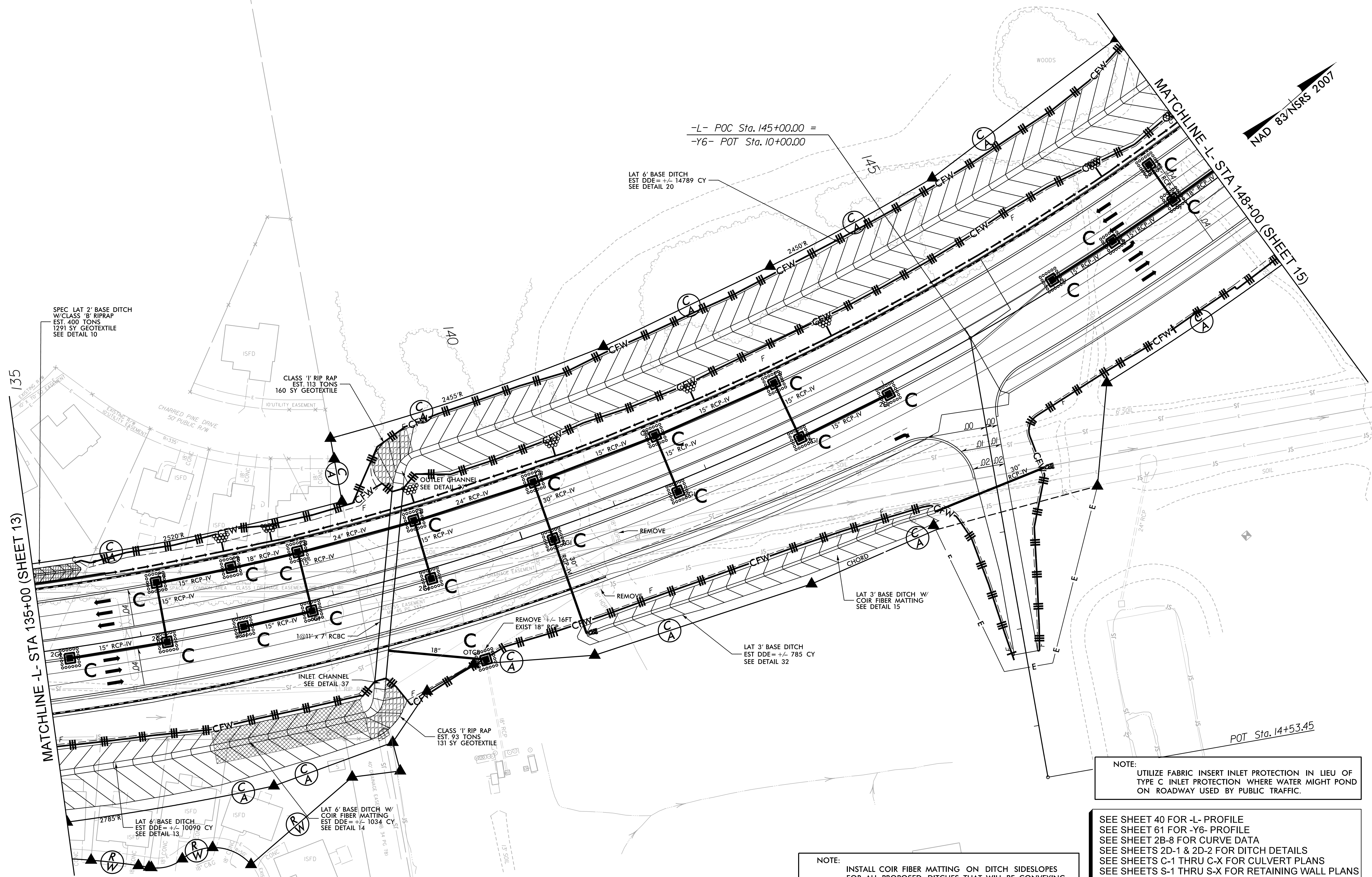
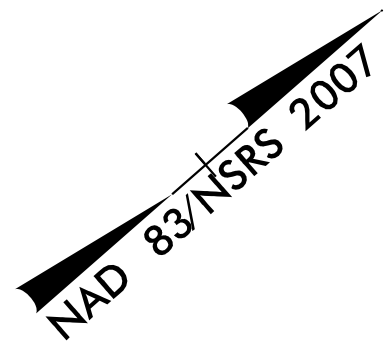

SPEC LAT 2' BASE DITCH
W/CLASS 'B' RIPRAP
EST. 400 TONS
1291 SY GEOTEXTILE
SEE DETAIL 10

CLASS '1' RIP RAP
EST. 113 TONS
160 SY GEOTEXTILE

-L- POC Sta. 145+00.00 =
-Y6- POT Sta. 10+00.00

LAT 6' BASE DITCH
EST DDE = +/- 14789 CY
SEE DETAIL 20

MATCHLINE -L- STA 135+00 (SHEET 13)

NOTE:
UTILIZE FABRIC INSERT INLET PROTECTION IN LIEU OF
TYPE C INLET PROTECTION WHERE WATER MIGHT POND
ON ROADWAY USED BY PUBLIC TRAFFIC.

SEE SHEET 40 FOR -L- PROFILE
SEE SHEET 61 FOR -Y6- PROFILE
SEE SHEET 2B-8 FOR CURVE DATA
SEE SHEETS 2D-1 & 2D-2 FOR DITCH DETAILS
SEE SHEETS C-1 THRU C-X FOR CULVERT PLANS
SEE SHEETS S-1 THRU S-X FOR RETAINING WALL PLANS
SEE SHEETS S-1 THRU S-X FOR NOISE WALL PLANS

NOTE:
INSTALL COIR FIBER MATTING ON DITCH SIDESLOPES
FOR ALL PROPOSED DITCHES THAT WILL BE CONVEYING
JURISDICTIONAL WATERS.

6/2/2017
R:\Environmental\Design\U4751_EC_psh43.dgn
P:\chims