

TIP NO.	SHEET NO.
W-5704A&B	SIGN-8
Approved by: <u>Joseph Kopachik</u> <small>SC08048780ASAF</small>	
DATE: 10/3/2017	
SEAL	
DOCUMENT NOT CONSIDERED FINAL UNLESS ALL SIGNATURES COMPLETED	

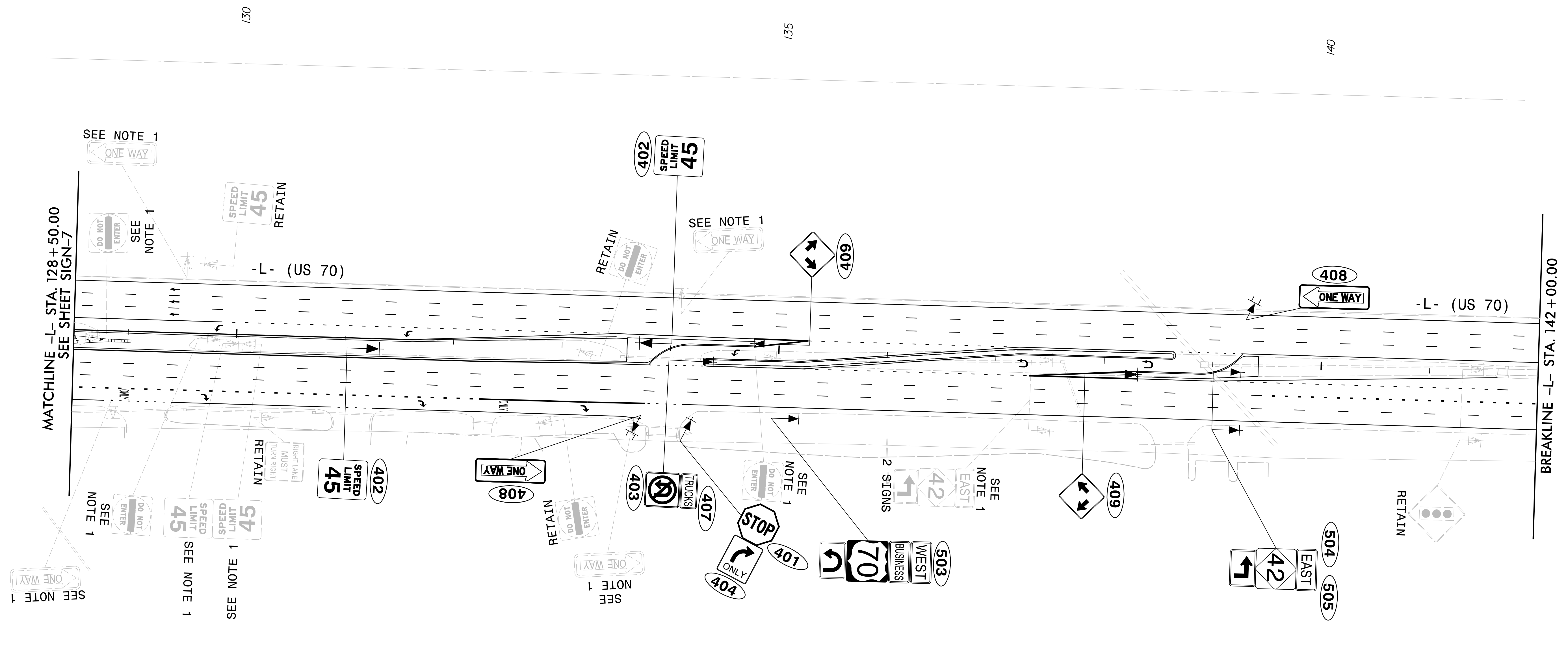
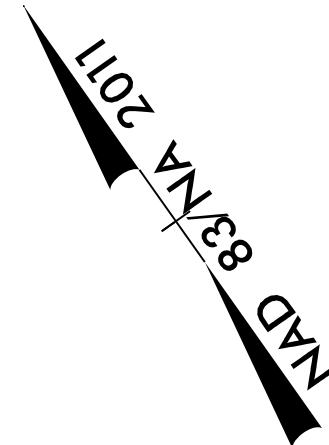

- NOTE:**
- 1. DISPOSAL OF SIGN SYSTEM, U-CHANNEL
 - ★ SIGNALIZED INTERSECTION

SEPI
ENGINEERING & CONSTRUCTION

1025 Wade Avenue
Raleigh, NC 27605
Tel: 919-789-9977
Fax: 919-789-9591
License: C-2197

**EXISTING AND PROPOSED
SIGNING DETAIL**