

8/17/99

SEPI
ENGINEERING & CONSTRUCTION
1025 Wade Avenue
Raleigh, NC 27605
Tel: 919-789-9977
Fax: 919-789-9591
License: C-2197

PROJECT REFERENCE NO. W-5704A&B	SHEET NO. 9
Roadway Design Engineer 10/4/2017	Hydraulics Engineer 10/4/2017
DOCUMENT NOT CONSIDERED FINAL UNLESS ALL SIGNATURES COMPLETED	

MAD 8/31/2011

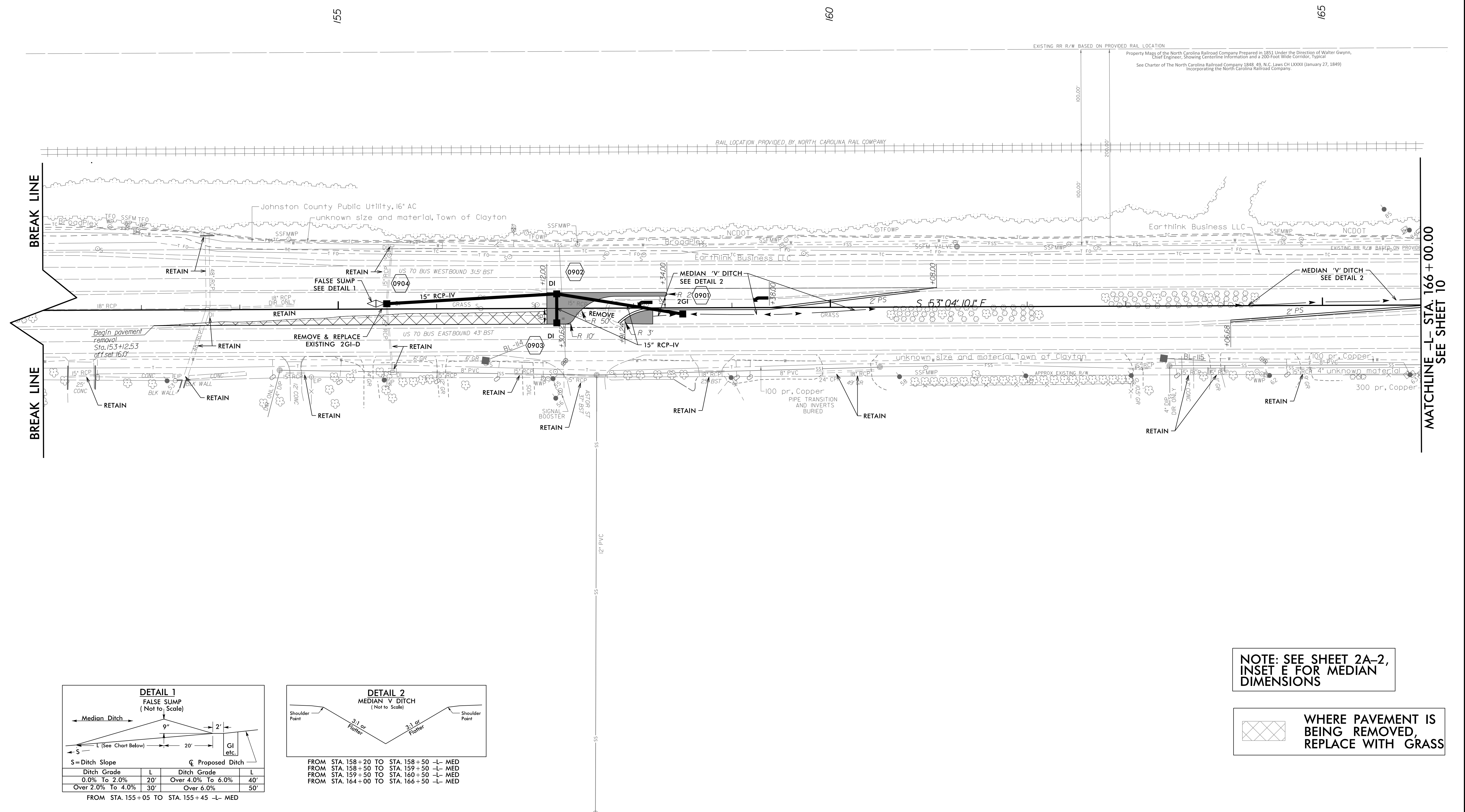

REVISIONS

BREAK LINE

MATCHLINE L- STA. 166 + 00.00
SEE SHEET 10

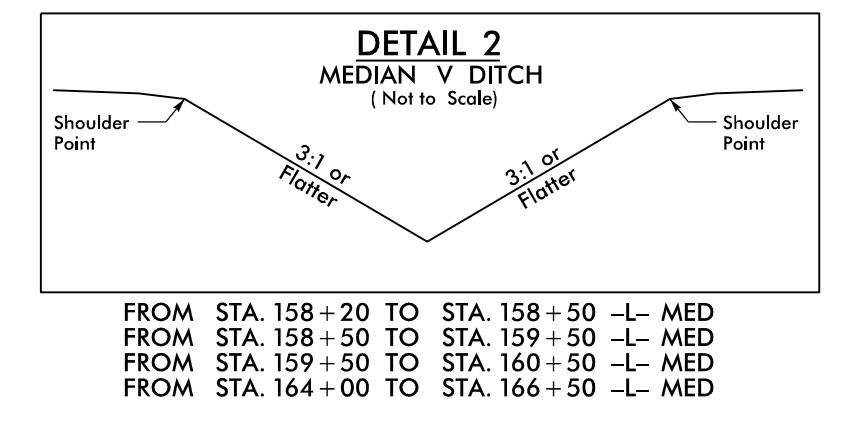
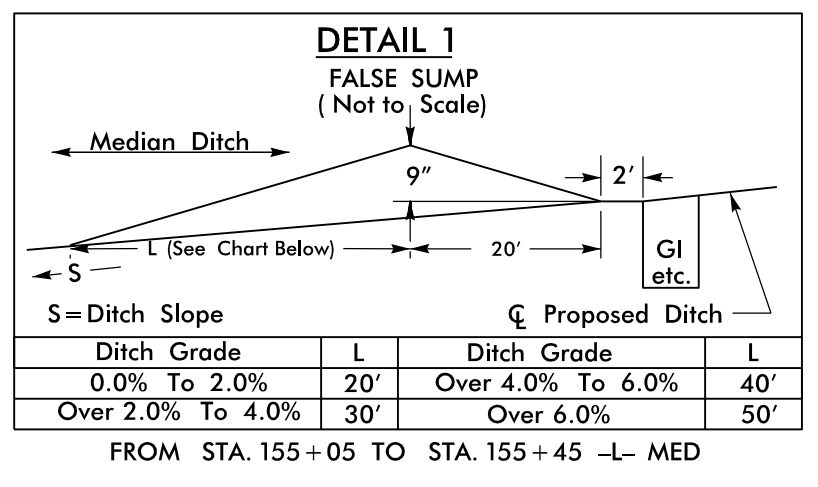

**NOTE: SEE SHEET 2A-2,
INSET E FOR MEDIAN
DIMENSIONS**

WHERE PAVEMENT IS BEING REMOVED, REPLACE WITH GRASS

10/4/2017 10:45:00 AM W-5704A&B_Rdy_psh_9.dgn