

REVISIONS

NOTE: THERE MAY BE POTENTIAL CONFLICT
BETWEEN PROPOSED STORM DRAINAGE
SYSTEM AND EXISTING 8" DUCTILE IRON
WATER LINE NEAR -L- STA 134 +30 +/-

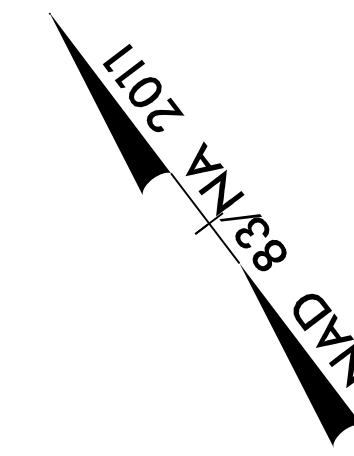

PROJECT REFERENCE NO. W-5704A&B	SHEET NO. 8
ROADWAY DESIGN ENGINEER	HYDRAULICS ENGINEER
DOCUMENT NOT CONSIDERED FINAL UNLESS ALL SIGNATURES COMPLETED	
 SEPI ENGINEERING & CONSTRUCTION 1025 Wade Avenue Raleigh, NC 27605 Tel: 919-789-9977 Fax: 919-789-9591 License: C-2197	

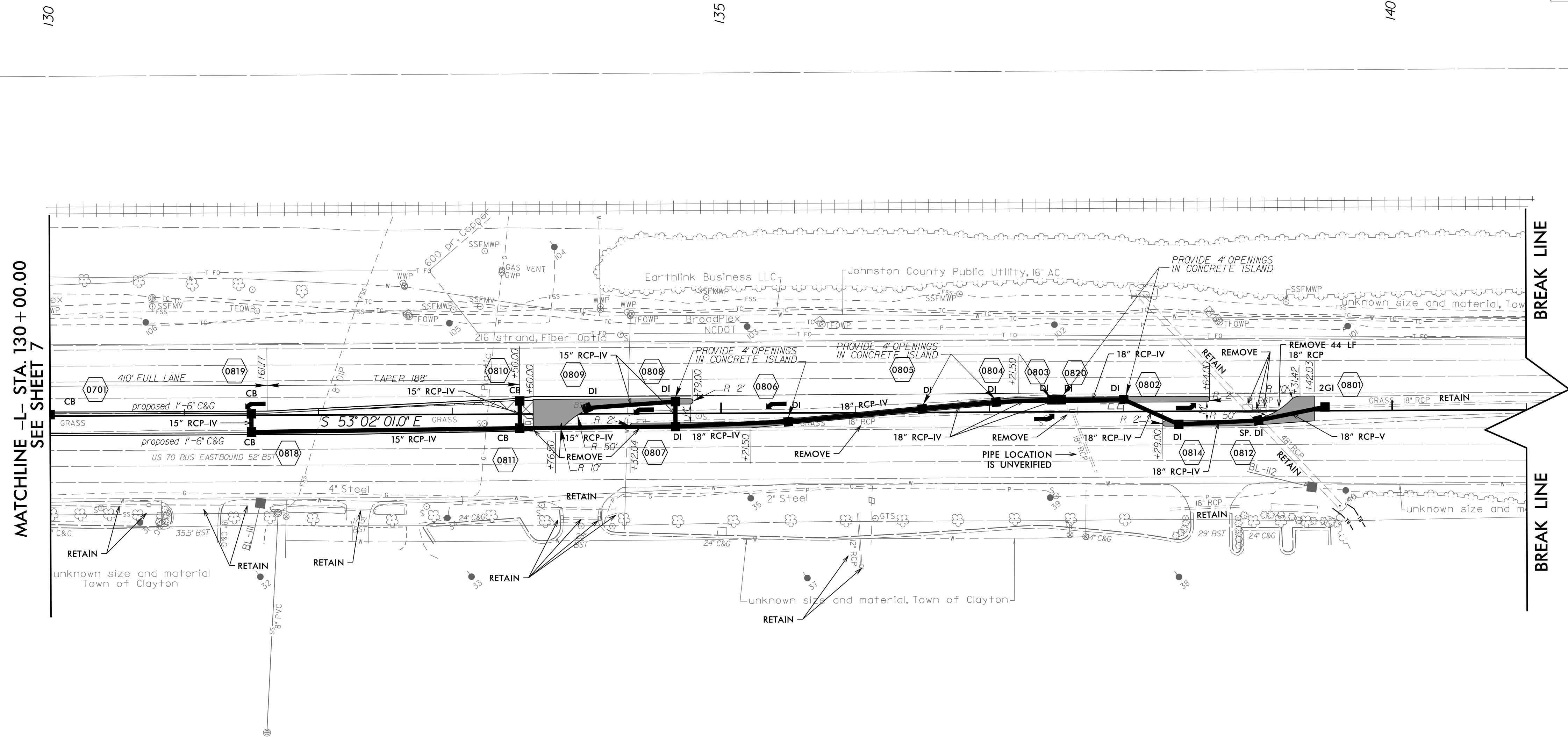

MATCHLINE -L- STA. 130 + 00.00
SEE SHEET 7

BREAK LINE

NOTE: SEE SHEET 2A-2,
INSET B FOR MEDIAN
DIMENSIONS

WHERE PAVEMENT IS
BEING REMOVED,
REPLACE WITH GRASS