

PLAN OF SPAN A

** FOR INTERMEDIATE STEEL DIAPHRAGMS DETAILS, SEE "INTERMEDIATE STEEL DIAPHRAGMS FOR 72" MODIFIED BULB TEE PRESTRESSED CONCRETE GIRDERS" SHEET.
 "A" BARS ARE SPACED ALONG AND PERPENDICULAR TO LONG CHORD.

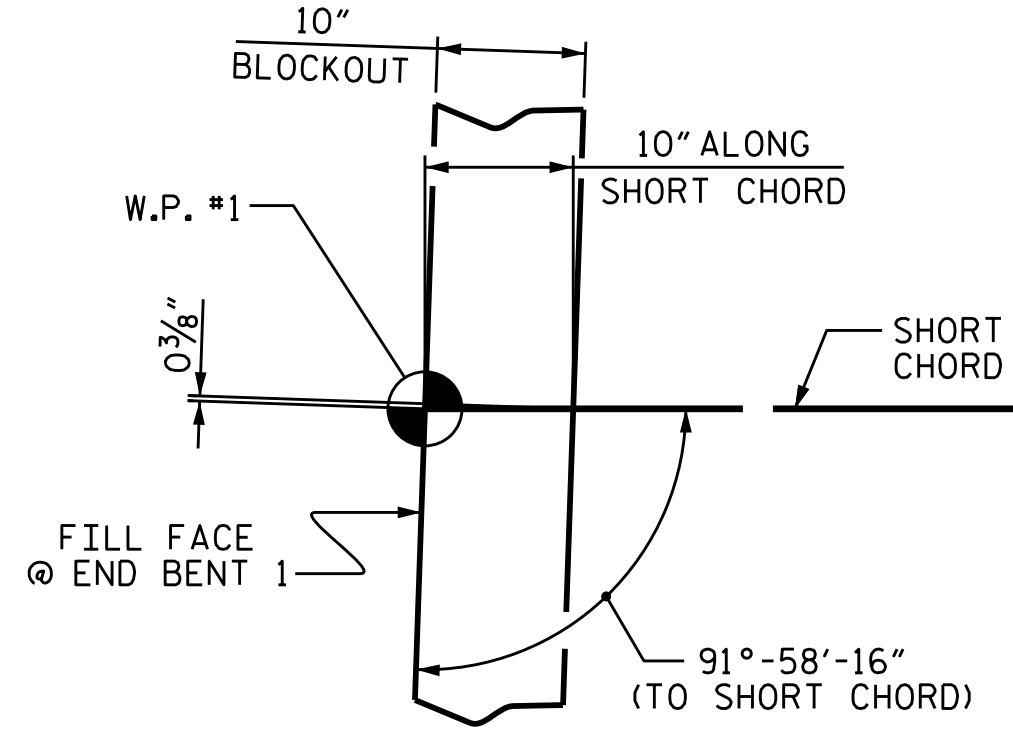

DETAIL "A"

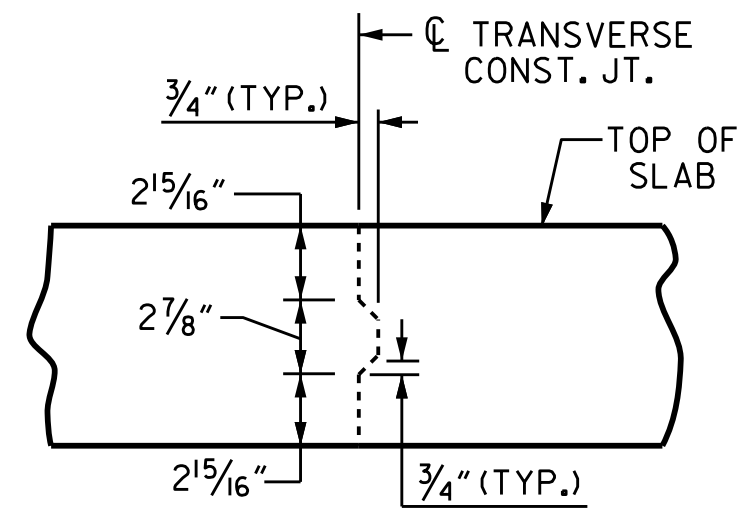

TRANSVERSE CONSTRUCTION JOINT

NOTE: REINFORCING STEEL IN SLAB NOT SHOWN. LONGITUDINAL REINFORCING STEEL SHALL BE CONTINUOUS THROUGH JOINT.

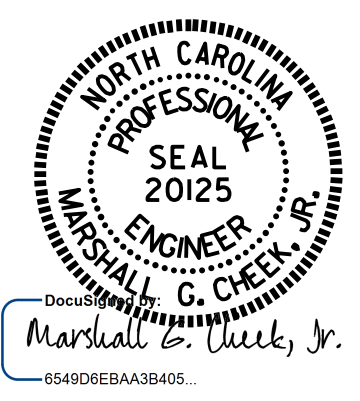

PROJECT NO. U-2579C
 FORSYTH COUNTY
 STATION: 29+24.97 -Y1-

SHEET 1 OF 3

STATE OF NORTH CAROLINA
 DEPARTMENT OF TRANSPORTATION
 RALEIGH
 SUPERSTRUCTURE
 PLAN OF SPAN A

DRAWN BY : J.P. MCCARTHA DATE : 4/26/16
 CHECKED BY : H.A. LOCKLEAR DATE : 8/25/16
 DESIGN ENGINEER OF RECORD : H.A. LOCKLEAR DATE : 6/2017

REVISIONS						SHEET NO.
NO.	BY:	DATE:	NO.	BY:	DATE:	S1-8
1			3			TOTAL SHEETS
2			4			32