

MESSAGES AS SHOWN OR AS DIRECTED BY THE ENGINEER

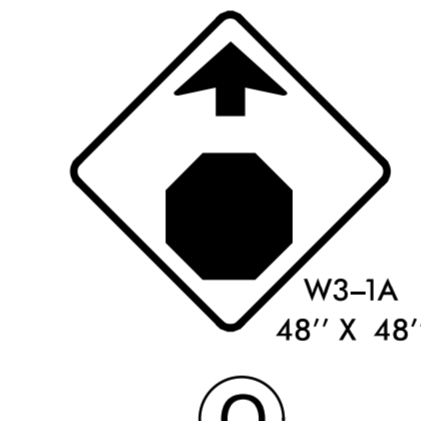
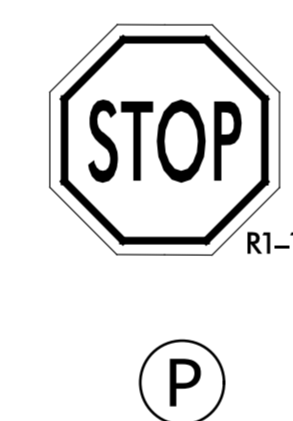
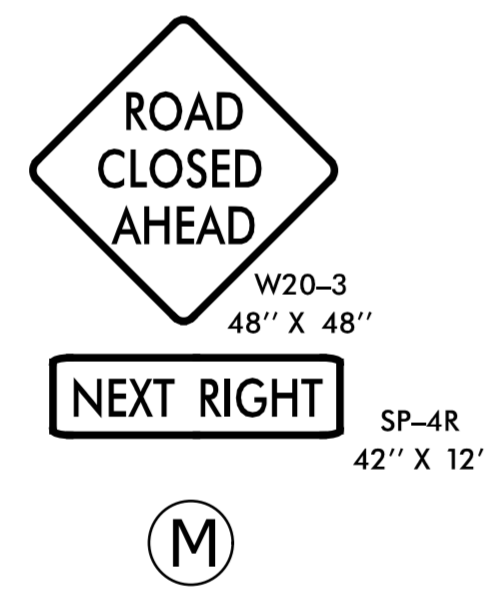

MESSAGE NO. 1	MESSAGE NO. 2
OLD WLKRTOWN TO CLOSE	ON (DATE)
CHANGEABLE MESSAGE SIGN	

V

MESSAGE NO. 1	MESSAGE NO. 2
ACCESS TO OLD WLKRTOWN	TO CLOSE ON (DATE)
CHANGEABLE MESSAGE SIGN	

W

ACTIVATE CMS 7 DAYS PRIOR TO ROAD CLOSURE

REMOVE CMS AFTER ROAD CLOSURE

DELINEATE WITH DRUMS

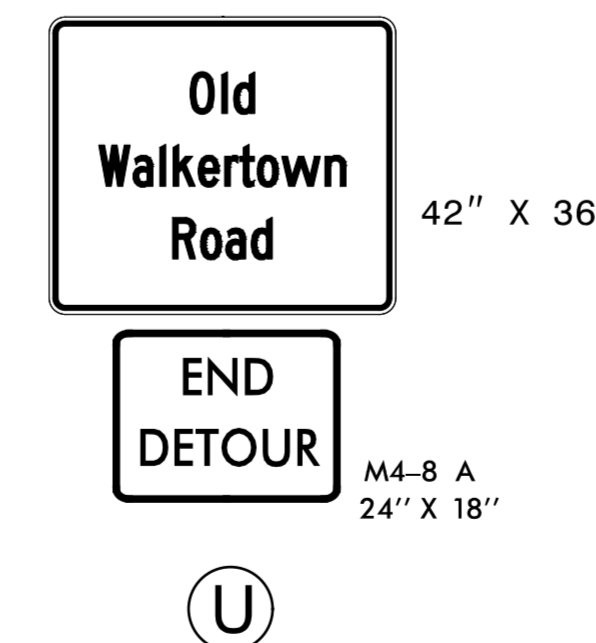
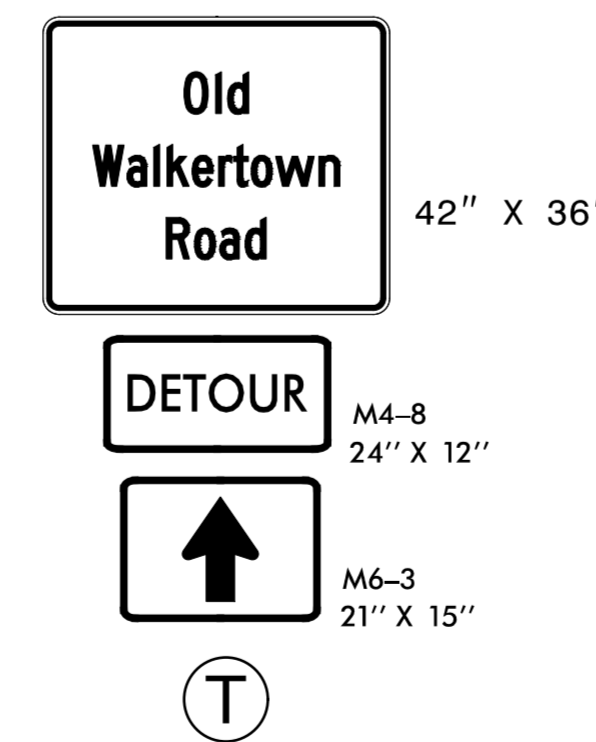
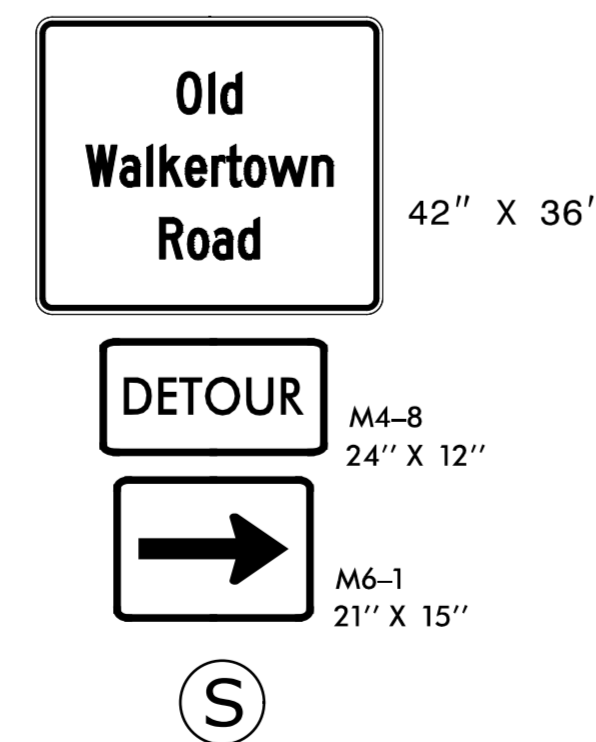
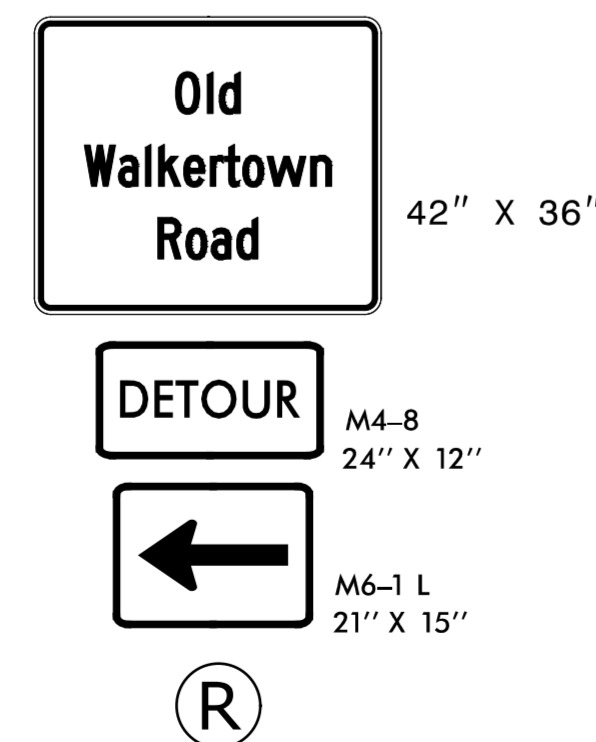

NOTE: SEE SHEET TMP-2D FOR SPECIAL SIGN DESIGN

APPROVED: *Michael T. Ryepha*
DATE: 7/5/2017
SEAL

DOCUMENT NOT CONSIDERED FINAL UNLESS ALL SIGNATURES COMPLETED

ROAD CLOSURE SIGNS AND DETOUR SIGNS