

|                         |                     |
|-------------------------|---------------------|
| PROJECT REFERENCE NO.   | SHEET NO.           |
| B-5347                  | EC-6/CONST.4        |
| RW SHEET NO.            |                     |
| ROADWAY DESIGN ENGINEER | HYDRAULICS ENGINEER |

**CLEARING AND GRUBBING  
EROSION CONTROL FOR  
CONSTRUCTION SHEET 4**

NOTE:  
PLACE TEMPORARY ROCK SEDIMENT DAMS TYPE - B  
AND TEMPORARY ROCK SILT CHECKS TYPE - A AT  
DRAINAGE OUTLETS.

NOTE:  
PERIMETER EROSION CONTROL MEASURES SHALL BE  
INSTALLED DURING CLEARING AND GRUBBING PHASE.

-L-

|   |   |  |  |
|---|---|--|--|
| PI Sta 10+48.51<br>Δ = 3' 56' 05.7" (RT)<br>D = 4' 03' 25.6"<br>L = 96.99'<br>T = 48.51'<br>R = 1,412.23' | PI Sta 11+99.34<br>Δ = 5' 14' 55.5" (RT)<br>D = 2' 33' 56.7"<br>L = 204.57'<br>T = 102.36'<br>R = 2,233.10' | PI Sta 15+22.82<br>Δ = 2' 00' 55.7" (LT)<br>D = 1' 38' 48.2"<br>L = 122.39'<br>T = 61.20'<br>R = 3,479.38' | PI Sta 16+84.28<br>Δ = 14' 37' 34.7" (LT)<br>D = 7' 20' 01.7"<br>L = 199.44'<br>T = 100.26'<br>R = 781.26' |
|---|---|--|--|

NAD 83/2011

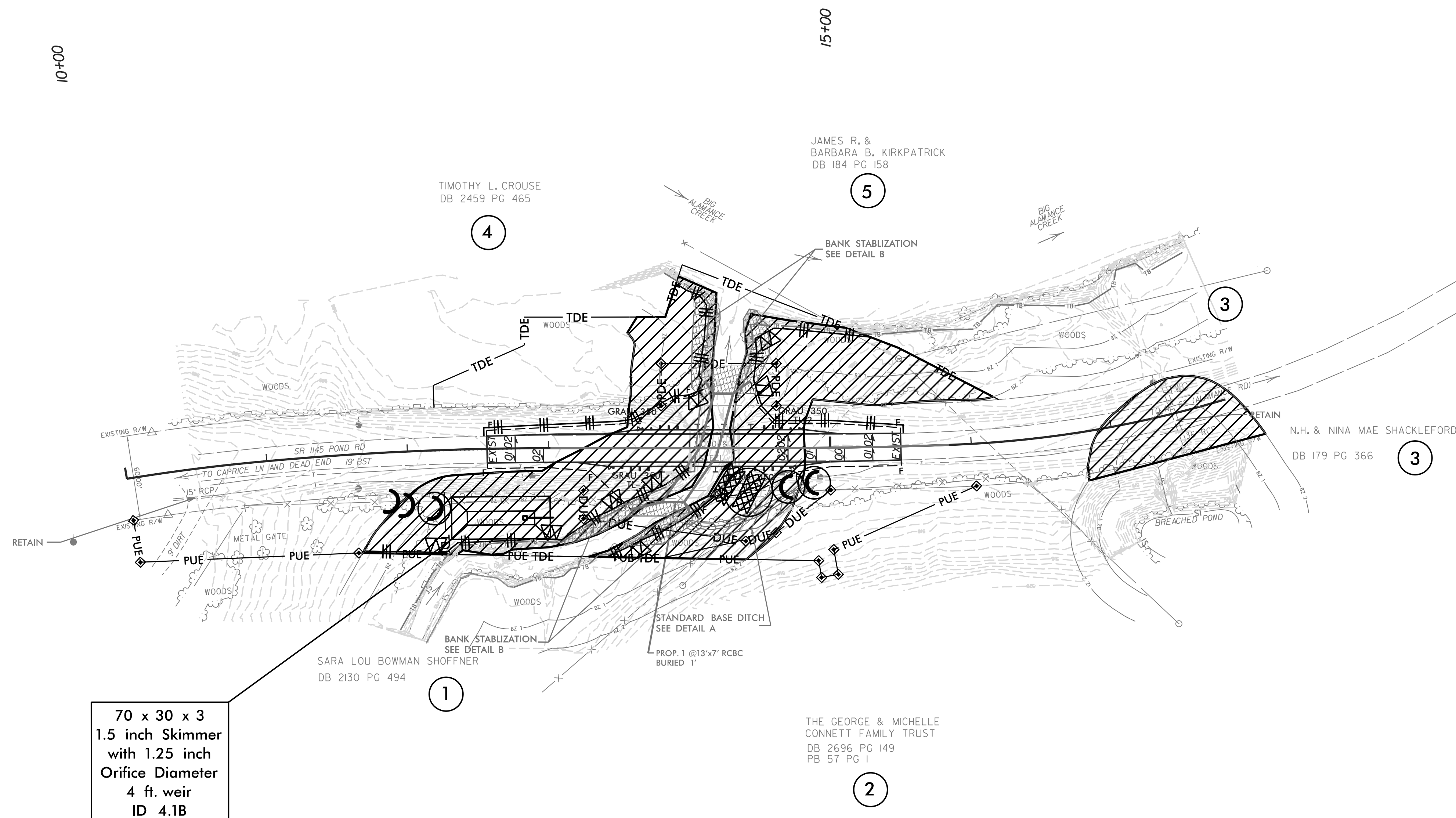

70 x 30 x 3  
1.5 inch Skimmer  
with 1.25 inch  
Orifice Diameter  
4 ft. weir  
ID 4.1B

ENVIRONMENTALLY SENSITIVE AREA  
SEE PROJECT SPECIAL PROVISIONS

**GRASS SWALE DATA**

|                           |                |
|---------------------------|----------------|
| TOTAL DA = 0.940c         | c = 0.22       |
| Imp = 0.020c              | (c=0.9)        |
| Grass = 0.020c            | (c=0.5)        |
| Woods = 0.90c             | (c=0.2)        |
| SLOPE = 0.012             | H/H            |
| S <sub>1</sub> = 2:1 (LT) | 7:1 (RT)       |
| L <sub>REQ</sub> = 92'    |                |
| L <sub>PRO</sub> = 150'   |                |
| Q2 = 0.92cfs              | Q10 = 1.68cfs  |
| V2 = 1.25ft/s             | V10 = 1.45ft/s |
| D2 = 0.43RD10 = 0.54ft    |                |

-L- STA. 14+83 to 16+35 (RT)

