

PROJECT REFERENCE NO.	SHEET NO.
B-5347	EC-5/CONST.2B-1
RW SHEET NO.	
ROADWAY DESIGN ENGINEER	HYDRAULICS ENGINEER

-DET- VDET - 25 MPH			
PI Sta 10+50.74 Δ = 24° 46' 42.9" (LT) D = 24' 48" 12.1" L = 99.90' T = 50.74' R = 231.00' SE = 4% RO = 40'	PI Sta 11+57.21 Δ = 27° 52' 08.7" (RT) D = 24' 48" 12.1" L = 112.36' T = 57.31' R = 231.00' SE = 4% RO = 40'	PI Sta 13+41.33 Δ = 23° 59' 18.3" (RT) D = 24' 48" 12.1" L = 96.71' T = 49.08' R = 231.00' SE = 4% RO = 40'	PI Sta 14+59.66 Δ = 34° 01' 52.7" (LT) D = 24' 48" 12.1" L = 137.20' T = 70.69' R = 231.00' SE = 4% RO = 40'

Place Matting for Erosion Control on Slope as Work Allows.
Sta. 11+80 to Sta. 12+80 -DET- Rt
Sta. 10+70 to Sta. 13+80 -DET- Lt

NAD 83/2011

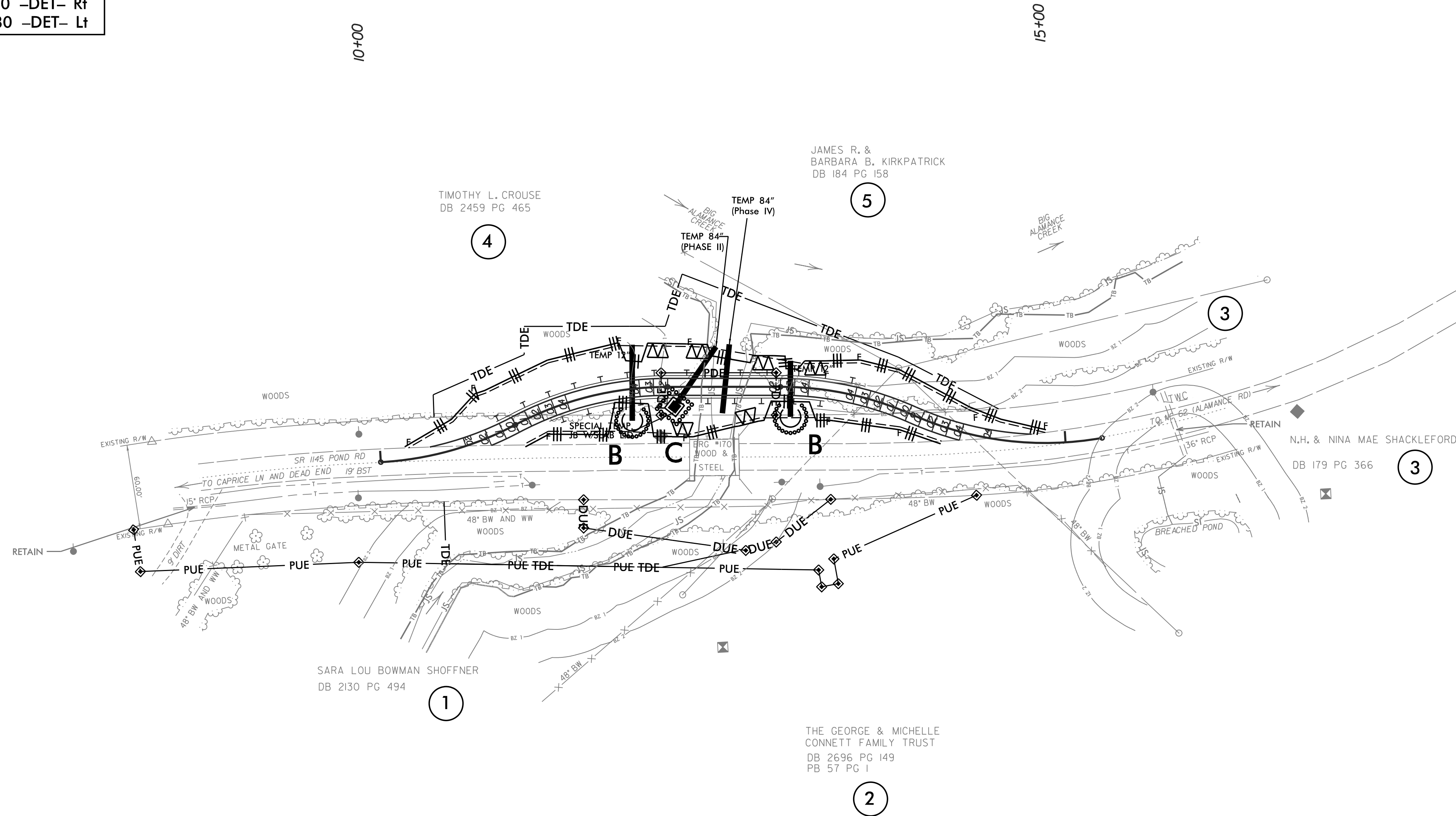

8/17/99

8/16/2017 8:57:57 AM
B:\B\5347_EC_psh_detour.dgn
11/28/17 PM