

PLAN

- GENERAL NOTES:**
- CONSTRUCT THE BASE SLAB BY FORMING.
 - SEE STD. DWG. 840.00 FOR CONSTRUCTION OF BASE SLAB IF PIPE IS SET INTO BASE SLAB.
 - USE CLASS 'B' CONCRETE THROUGHOUT.
 - CONSTRUCTION OPTIONS: MONOLITHIC POUR, 2" KEYWAY, OR #5 BAR DOWELS AT 12" CENTERS AS DIRECTED BY THE ENGINEER.
 - CUT, BEND OR RELOCATE REINFORCING STEEL TO POSITION PIPE AS DIRECTED BY THE ENGINEER.
 - CHAMFER ALL EXPOSED CORNERS 1".
 - CONTRACTOR MAY ADJUST DIMENSIONS OF BOX AS FIELD CONDITIONS DICTATE OR AS DIRECTED BY THE ENGINEER.

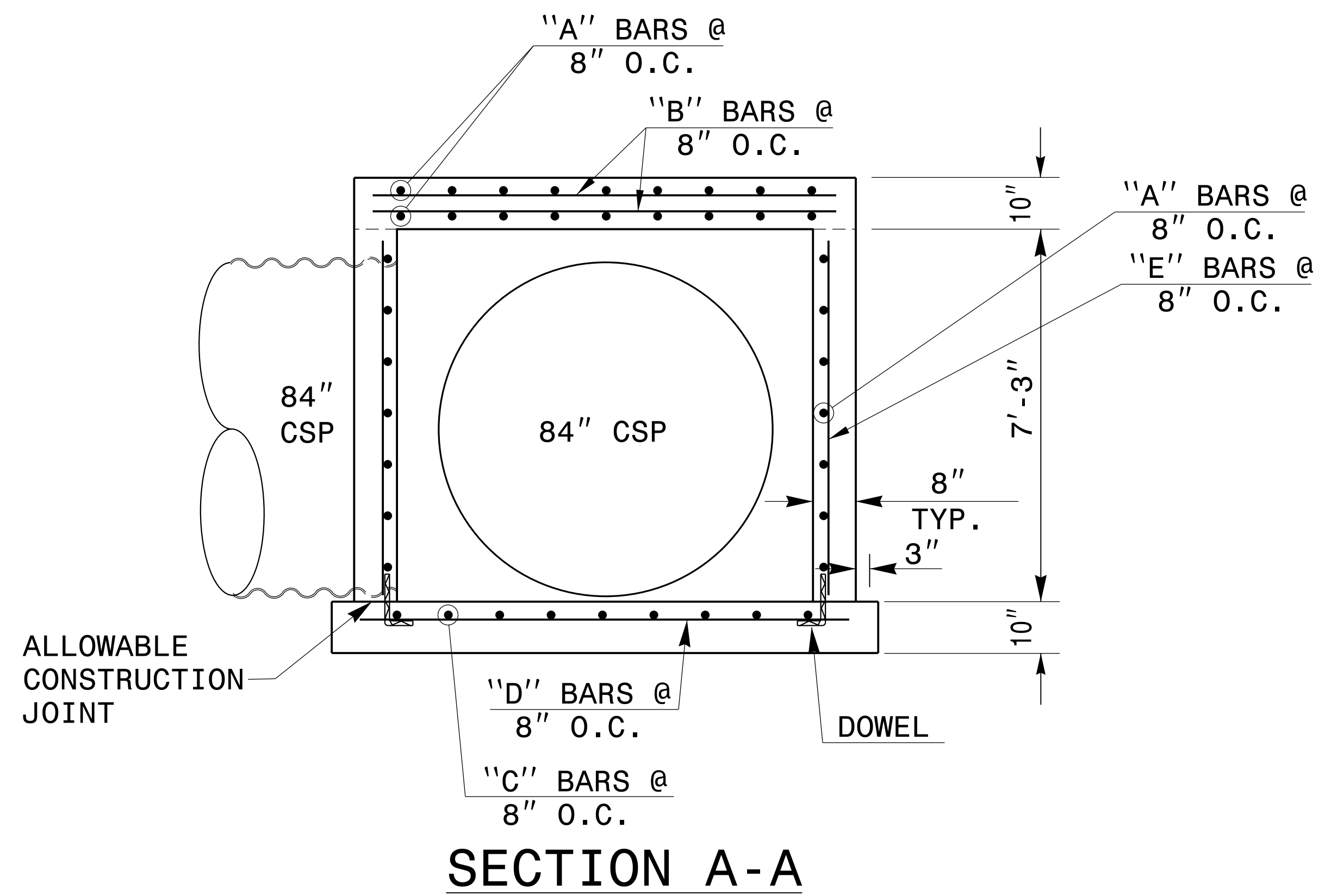

SECTION A-A

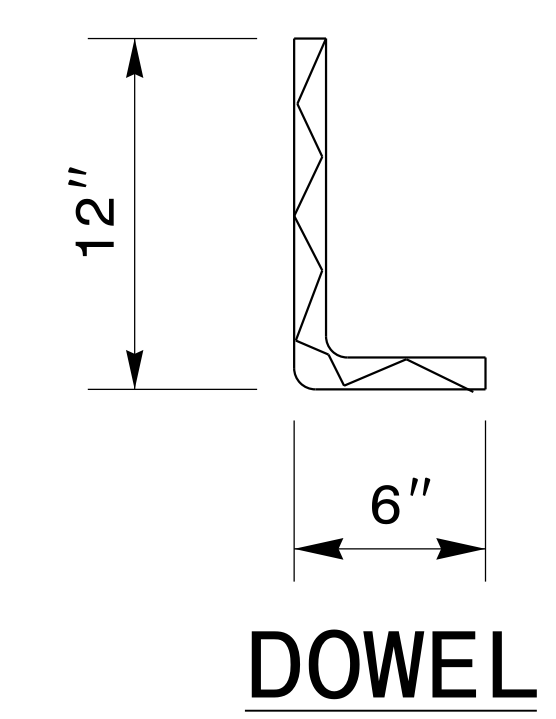

DOWEL

BILL OF MATERIAL				
BAR	NO.	SIZE	LENGTH	WEIGHT
A	36	#4	10'-0"	240.1
B	38	#4	9'-0"	228.1
C	15	#4	10'-6"	105.1
D	17	#4	9'-6"	107.7
E	54	#4	7'-1"	183.1
TOTAL REINF. STEEL (lbs.)				864.1
CLASS "B" CONC. (cu. yds.)				12.8
NO DEDUCTIONS FOR PIPES				

24-MAY-2017 16:32
 S:\Contracts\Special Details\kempf\english\B5347-jb84csp.dgn
 .jhoverton AT_CSD-292595

**DOCUMENT NOT CONSIDERED FINAL
UNLESS ALL SIGNATURES COMPLETED**

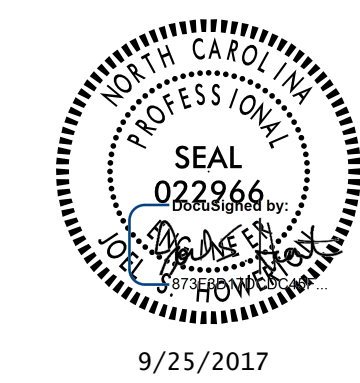

**CONTRACTS STANDARDS
AND DEVELOPMENT UNIT**
Office 919-707-6950 FAX 919-250-4119

**DETAIL OF
SPECIAL JUNCTION BOX**

ORIGINAL BY: K. KEMPF DATE: 10-27-16
 MODIFIED BY: DATE:
 CHECKED BY: DATE:
 FILE SPEC.: special_details\kempf\english\B5347_jb82csp.dgn