

TIP NO. R-5752	SHEET NO. PMP-9
APPROVED: <i>Joseph Kopaskie</i> 9/13/2017	
DATE: 9/13/2017	
SEAL	
DOCUMENT NOT CONSIDERED FINAL UNLESS ALL SIGNATURES COMPLETED	

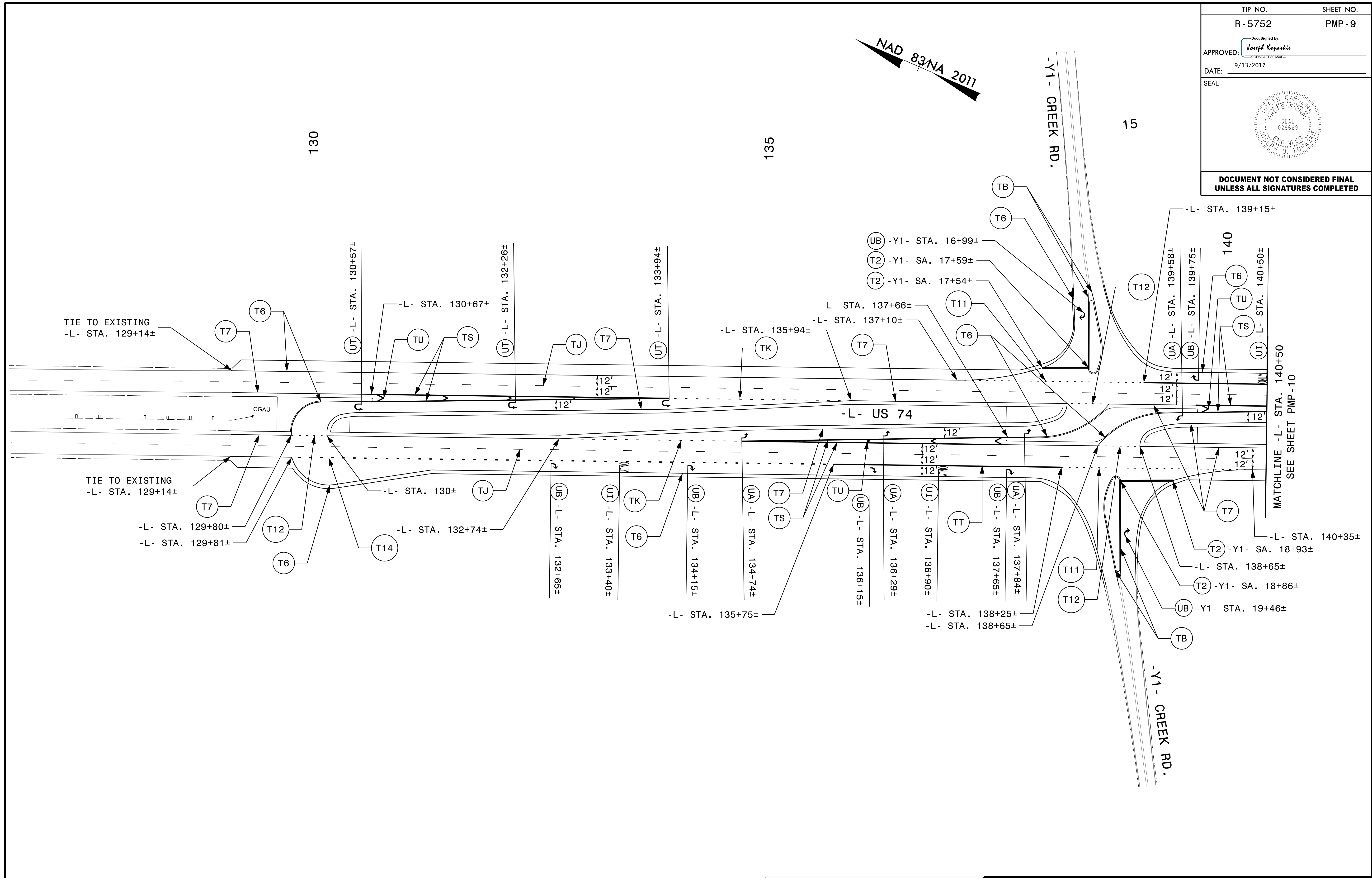

8/7/2017
I:\SEPI\kikopaskie

SEPI
ENGINEERING &
CONSTRUCTION

1025 Wade Avenue
Raleigh, NC 27605
Tel: 919-789-9977
Fax: 919-789-9591
License: C-2197

PAVEMENT MARKING DETAIL