

5/28/99

PROJECT REFERENCE NO. R-5752	SHEET NO. 19
DOCUMENT NOT CONSIDERED FINAL UNLESS ALL SIGNATURES COMPLETED	
ROADWAY DESIGN ENGINEER 	HYDRAULICS ENGINEER

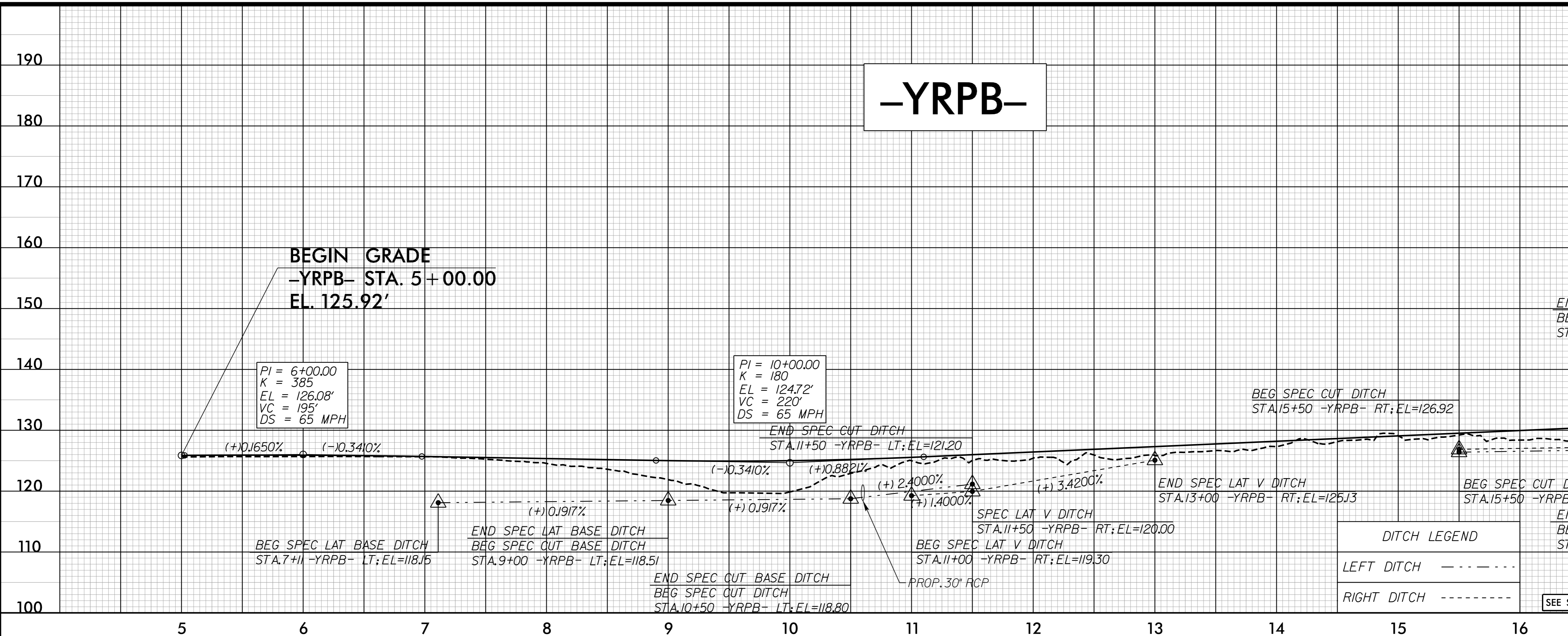

PIPE HYDRAULIC DATA	
Structure No.0532 To 0533 -YRPB- Sta.19+81	
DRAINAGE AREA	= 5.8 AC
DESIGN FREQUENCY	= 50 YRS
DESIGN DISCHARGE	= 18 CFS
DESIGN HW ELEVATION	= 125.4 FT
100 YEAR DISCHARGE	= 20 CFS
100 YEAR HW ELEVATION	= 125.7 FT
OVERTOPPING FREQUENCY	= 500 YRS
OVERTOPPING DISCHARGE	= 55 CFS
OVERTOPPING ELEVATION	= 127.4 FT

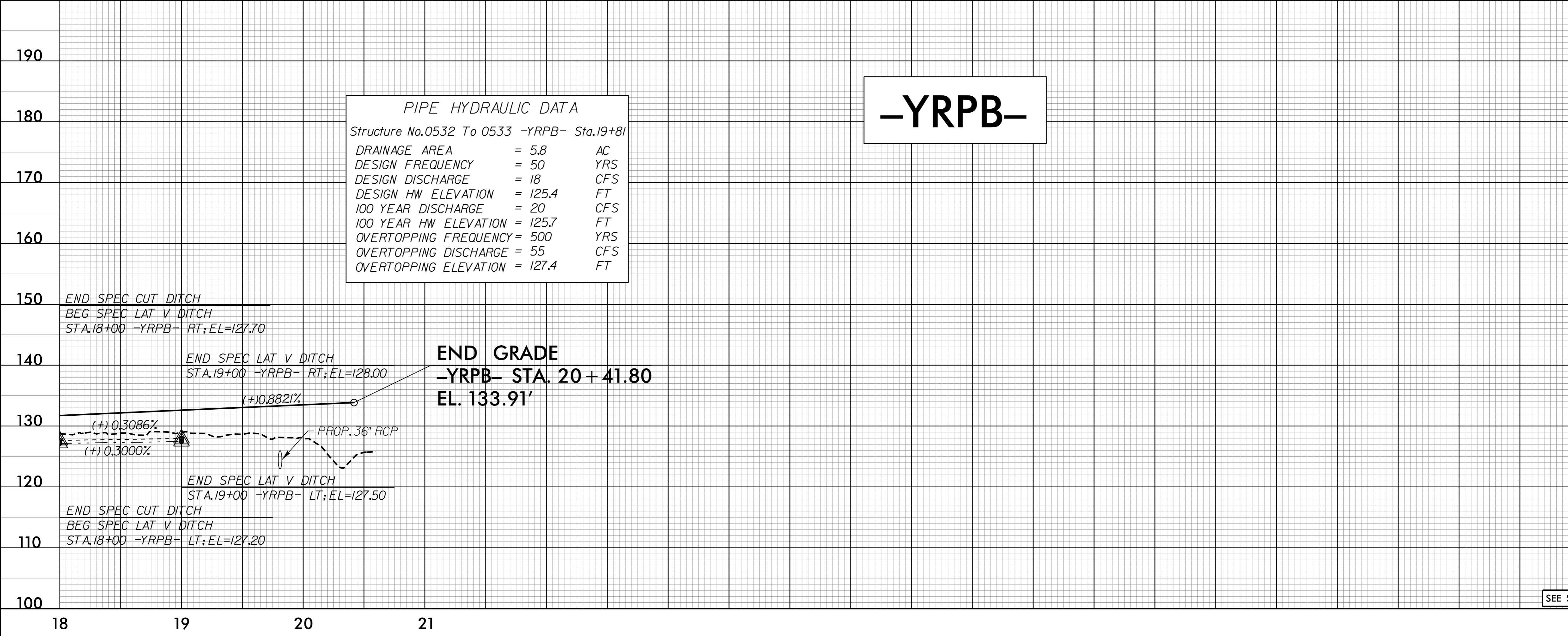

invgrid_expression
11:55:50 AM 5/28/99