

EXIT 328A LOOP A - I-40 / I-95

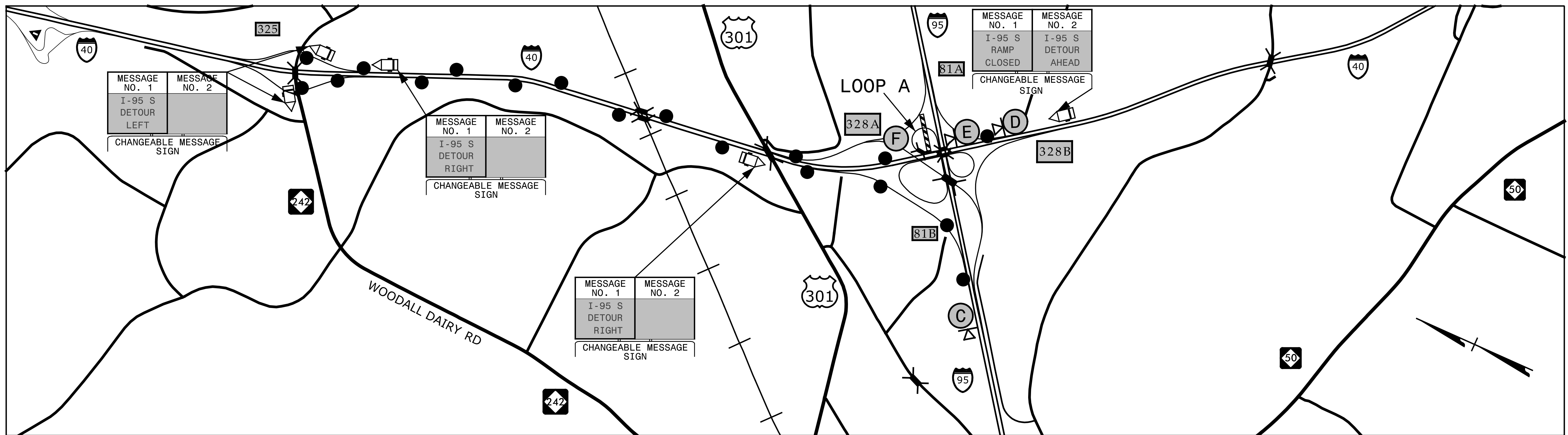
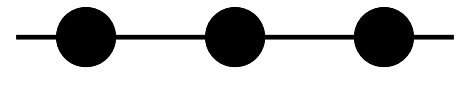

5/24/2017 10:05:00 I-5781\TP\Tr-off\I-5781\TMP-10.dgn
X:\2017\SET\1058.00 I-5781\TP\Tr-off\I-5781\TMP-10.dgn
ibauman

 OFF SITE DETOUR ROUTE
 SEE TMP-2 FOR SIGN LEGEND
 SEE TMP-13 FOR RAMP CLOSURE TYPICAL

SEPI
ENGINEERING & CONSTRUCTION

1025 Wade Avenue
Raleigh, NC 27605
Tel: 919-789-9977
Fax: 919-789-9591
License: C-2197

APPROVED: *Steven D. Miller*
DATE: 7/31/2017

SEAL

**DOCUMENT NOT CONSIDERED FINAL
UNLESS ALL SIGNATURES COMPLETED**



**I-95 S
DETOUR**

