

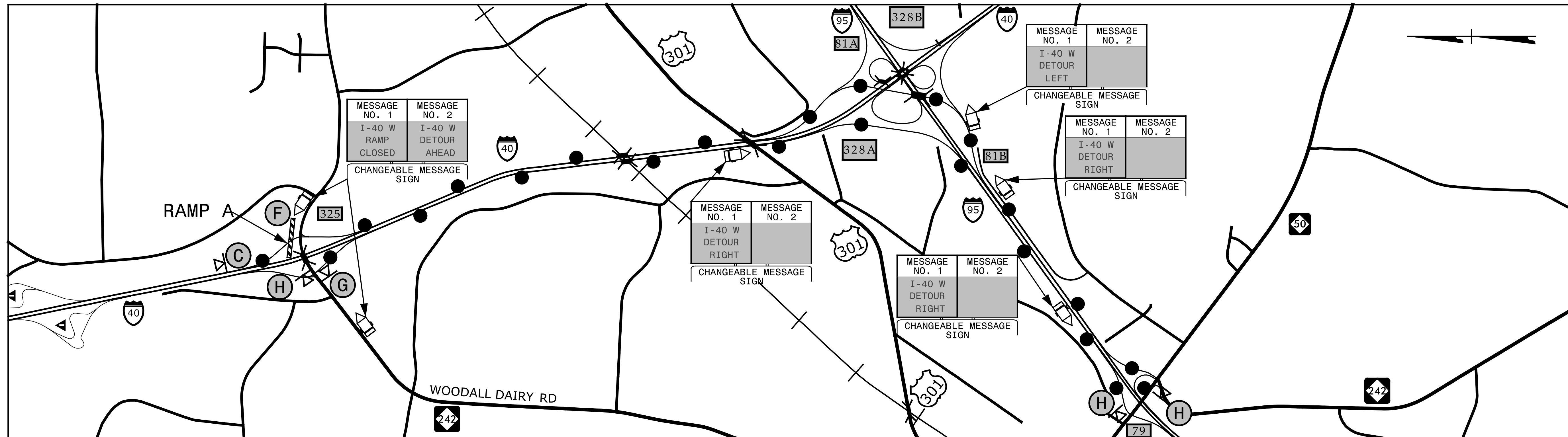

# EXIT 325 RAMP A - I-40 / NC 242

PROJ. REFERENCE NO.	SHEET NO.
I-5781	TMP-6

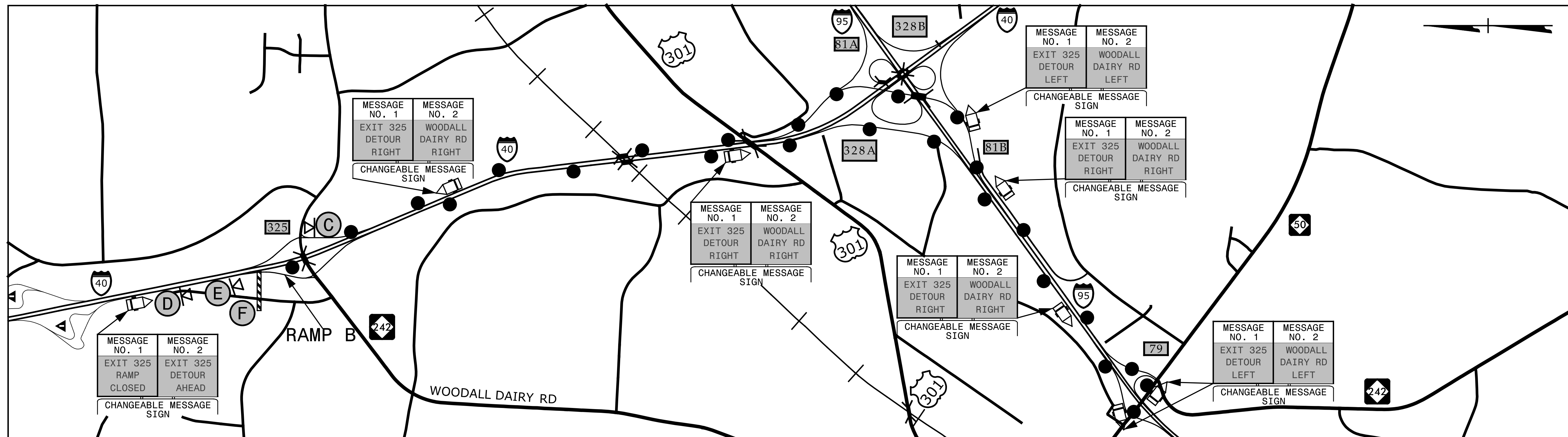

# EXIT 325 RAMP B - I-40 / NC 242



  
 OFF SITE DETOUR ROUTE  
 SEE TMP-2 FOR SIGN LEGEND  
 SEE TMP-13 FOR RAMP CLOSURE TYPICAL

**SEPI**  
 ENGINEERING & CONSTRUCTION  
 1025 Wade Avenue  
 Raleigh, NC 27605  
 Tel: 919-789-9977  
 Fax: 919-789-9591  
 License: C-2197

APPROVED: *Steven D. Miller*  
 DATE: 7/31/2017  
 SEAL  
 DOCUMENT NOT CONSIDERED FINAL  
 UNLESS ALL SIGNATURES COMPLETED

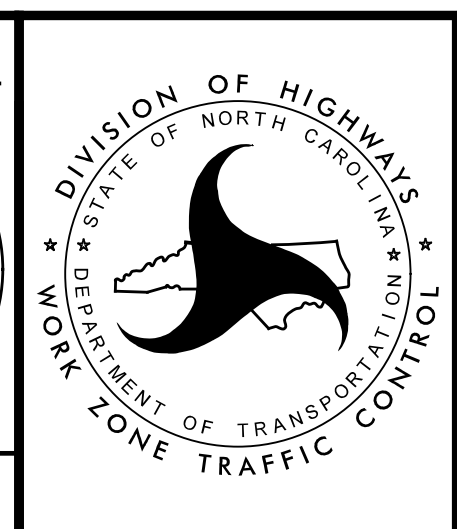

**I-40 & NC 242  
 DETOUR**

5/9/2017  
 X:\2017\SET\1.058.00 I-5781\TP\Tr-off\I-5781-TMP-6.dgn  
 jbauman