

5/14/99

PROJECT REFERENCE NO. U-2579C	SHEET NO. 20
ROADWAY DESIGN ENGINEER	HYDRAULICS ENGINEER

DOCUMENT NOT CONSIDERED FINAL UNLESS ALL SIGNATURES COMPLETED

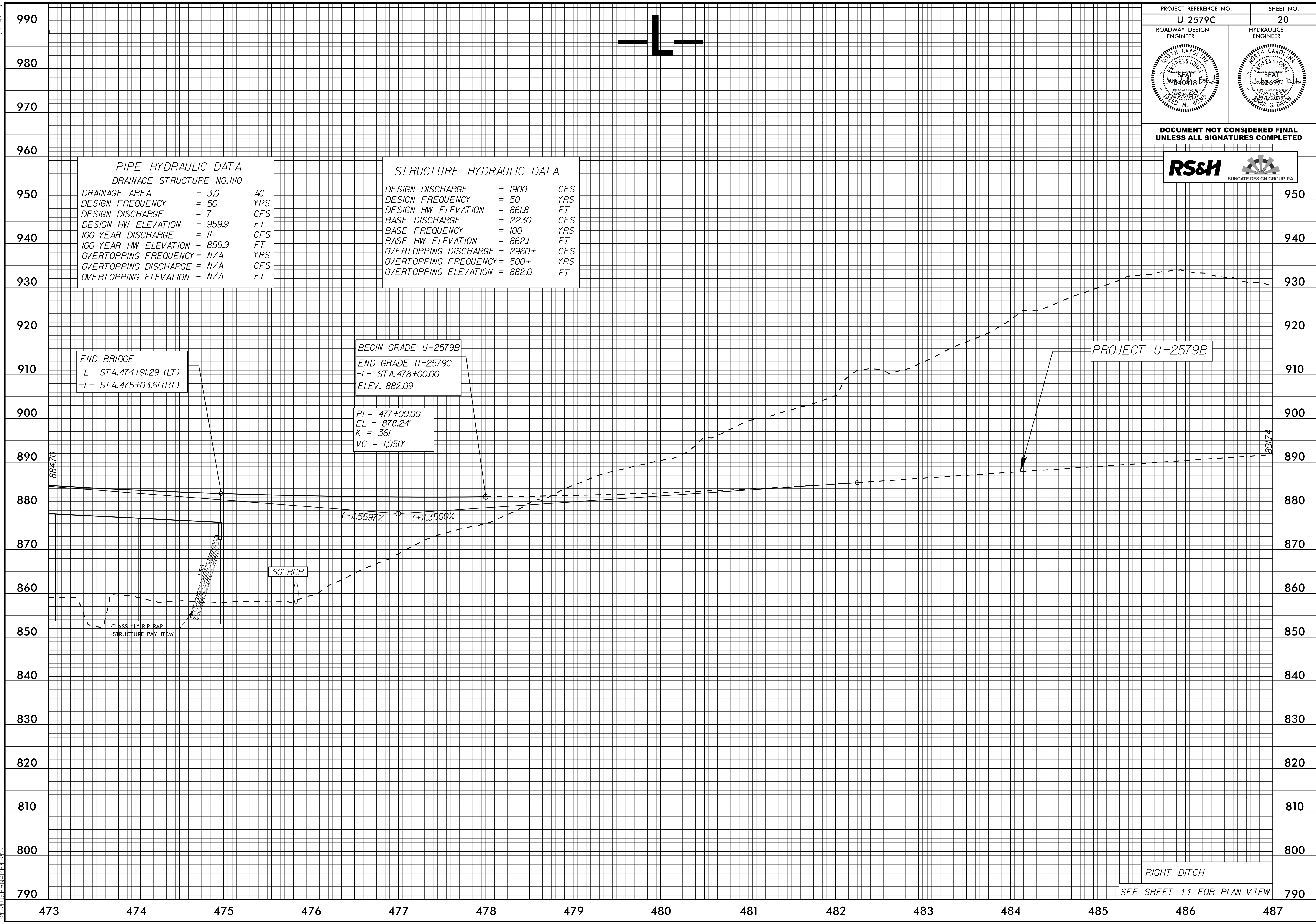
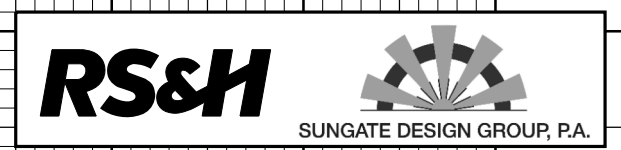

PIPE HYDRAULIC DATA
DRAINAGE STRUCTURE NO. 1110

DRAINAGE AREA	= 3.0	AC
DESIGN FREQUENCY	= 50	YRS
DESIGN DISCHARGE	= 7	CFS
DESIGN HW ELEVATION	= 959.9	FT
100 YEAR DISCHARGE	= 11	CFS
100 YEAR HW ELEVATION	= 859.9	FT
OVERTOPPING FREQUENCY	= N/A	YRS
OVERTOPPING DISCHARGE	= N/A	CFS
OVERTOPPING ELEVATION	= N/A	FT

STRUCTURE HYDRAULIC DATA

DESIGN DISCHARGE	= 1900	CFS
DESIGN FREQUENCY	= 50	YRS
DESIGN HW ELEVATION	= 861.8	FT
BASE DISCHARGE	= 2230	CFS
BASE FREQUENCY	= 100	YRS
BASE HW ELEVATION	= 862.1	FT
OVERTOPPING DISCHARGE	= 2960+	CFS
OVERTOPPING FREQUENCY	= 500+	YRS
OVERTOPPING ELEVATION	= 882.0	FT

END BRIDGE
-L- STA. 474+91.29 (LT)
-L- STA. 475+03.61 (RT)

BEGIN GRADE U-2579B
END GRADE U-2579C
-L- STA. 478+00.00
ELEV. 882.09

PI = 477+00.00
EL = 878.24'
K = 361
VC = 1,050'

PROJECT U-2579B

CLASS "II" RIP RAP
(STRUCTURE PAY ITEM)

60" RCP

RIGHT DITCH

SEE SHEET 11 FOR PLAN VIEW

07 JUL 2017 15:35 U-2579C-pl.L-20.dgn