

8/17/99

APPROXIMATE HISTORIC BOUNDARY FOR THE HAMMOCK FAMILY FARM



MATCHLINE -YI- STA. 39+50.00 SHEET 13

PROJECT REFERENCE NO. U-2579C		SHEET NO. 6	
RW SHEET NO.		HYDRAULICS ENGINEER	
ROADWAY DESIGN ENGINEER		HYDRAULICS ENGINEER	
DOCUMENT NOT CONSIDERED FINAL UNLESS ALL SIGNATURES COMPLETED			



MATCHLINE -L- STA. 390+00.00 SHEET 5

MATCHLINE -L- STA. 418+75.00 SHEET 7

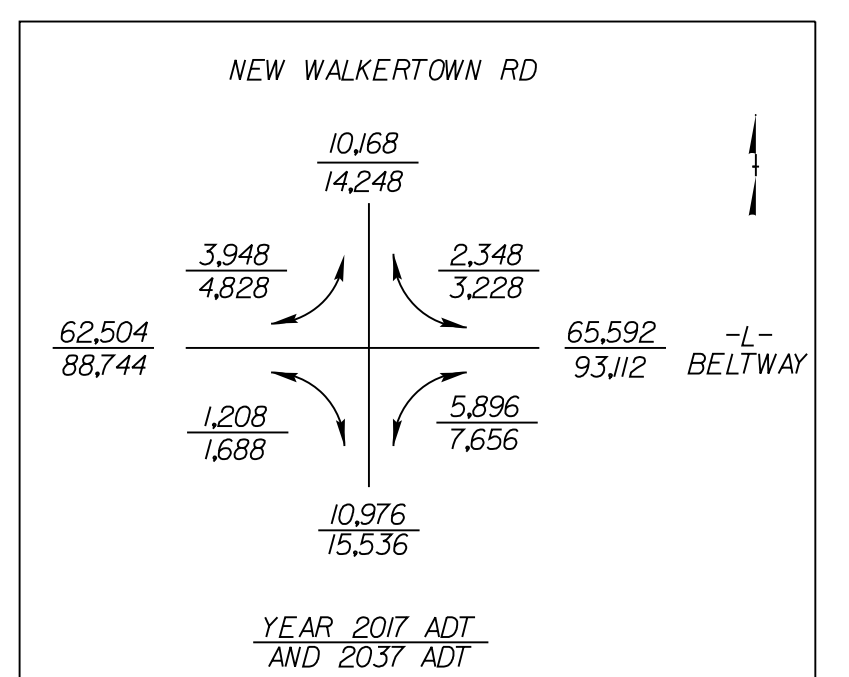
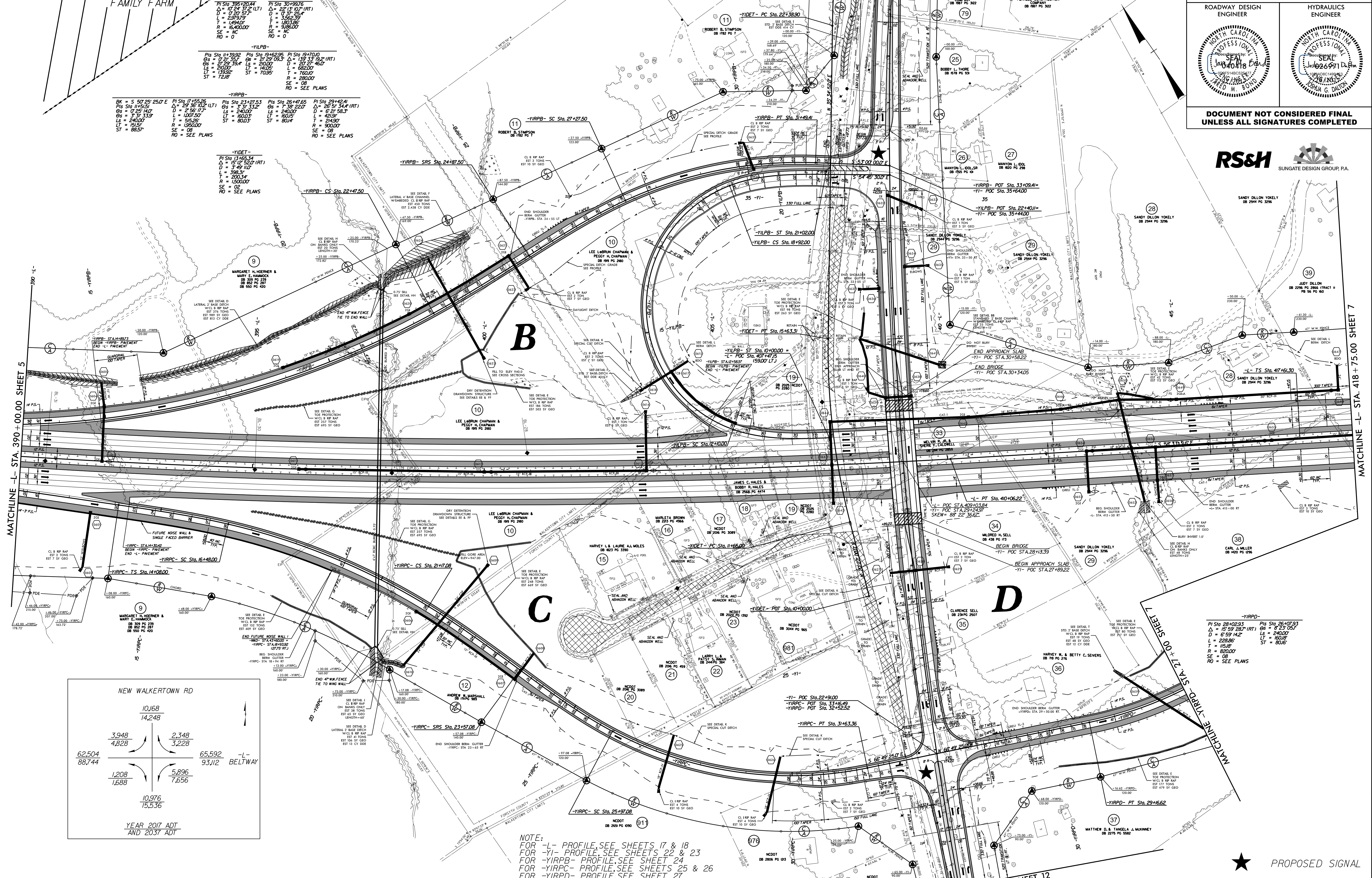

NOTE:
 -L- PROFILE, SEE SHEETS 17 & 18
 -YI- PROFILE, SEE SHEETS 22 & 23
 -YIRPB- PROFILE, SEE SHEET 24
 -YIRPC- PROFILE, SEE SHEETS 25 & 26
 -YIRPD- PROFILE, SEE SHEET 27
 -YILPB- PROFILE, SEE SHEET 28
 -YIDET- PROFILE, SEE SHEET 30
 -YIDET- PLAN, SEE SHEETS 2B-5 & 2B-6
 FOR DRAINAGE DETAILS, SEE SHEETS 2D-1 TO 2D-4
 FOR BRIDGE SKETCH, SEE SHEET 2B-1
 FOR STRUCTURE PLANS, SEE SHEETS S1-1 TO S1-32
 FOR CULVERT PLANS, SEE SHEETS C1-1 TO C1-5

- PROPOSED SIGNAL
- PROP. CONCRETE 5' MONOLITHIC ISLAND
- PAVED SHOULDER

MATCHLINE -YI- STA. 20+00.00 SHEET 12

PI Sta 15+68.06	PI Sta 18+14.60	PI Sta 21+97.13	PI Sta 25+17.26	PI Sta 28+92.04
Δ = 44.302'	Δ = 16.32' 06.7" (RT)	Δ = 44.302'	Δ = 8.23' 05.1"	Δ = 39.34' 05.0" (LT)
L = 240.00'	D = 3.57' 05.2"	L = 240.00'	L = 240.00'	D = 6.59' 14.2"
LT = 160.00'	L = 46.00'	LT = 160.00'	LT = 160.00'	L = 160.00'
ST = 80.00'	T = 2.3600'	ST = 80.00'	ST = 80.00'	T = 2.3600'
R = 1450.00'	R = 1450.00'	R = 1450.00'	R = 1450.00'	R = 1450.00'
SE = 08	SE = 08	SE = 08	SE = 08	SE = 08
RO = SEE PLANS	RO = SEE PLANS	RO = SEE PLANS	RO = SEE PLANS	RO = SEE PLANS

REVISIONS

07-JUL-2017 09:41 U:\2579C_psh_6.dgn