

8/17/99

PROJECT REFERENCE NO.		SHEET NO.	
U-5935		EC-23/CONST.12	
RW SHEET NO.			
ROADWAY DESIGN ENGINEER		HYDRAULICS ENGINEER	
<b>DOCUMENT NOT CONSIDERED FINAL UNLESS ALL SIGNATURES COMPLETED</b>			
Michael Baker Engineering, Inc. Michael Baker International		ECOLOGICAL ENGINEERING	

NOTES: ALTERNATIVE INLET PROTECTION DEVICES ARE ALLOWED PER DIRECTION OF THE ENGINEER.

MATCH LINE -EY17- STA. 48 + 00.00 SEE SHEET 9

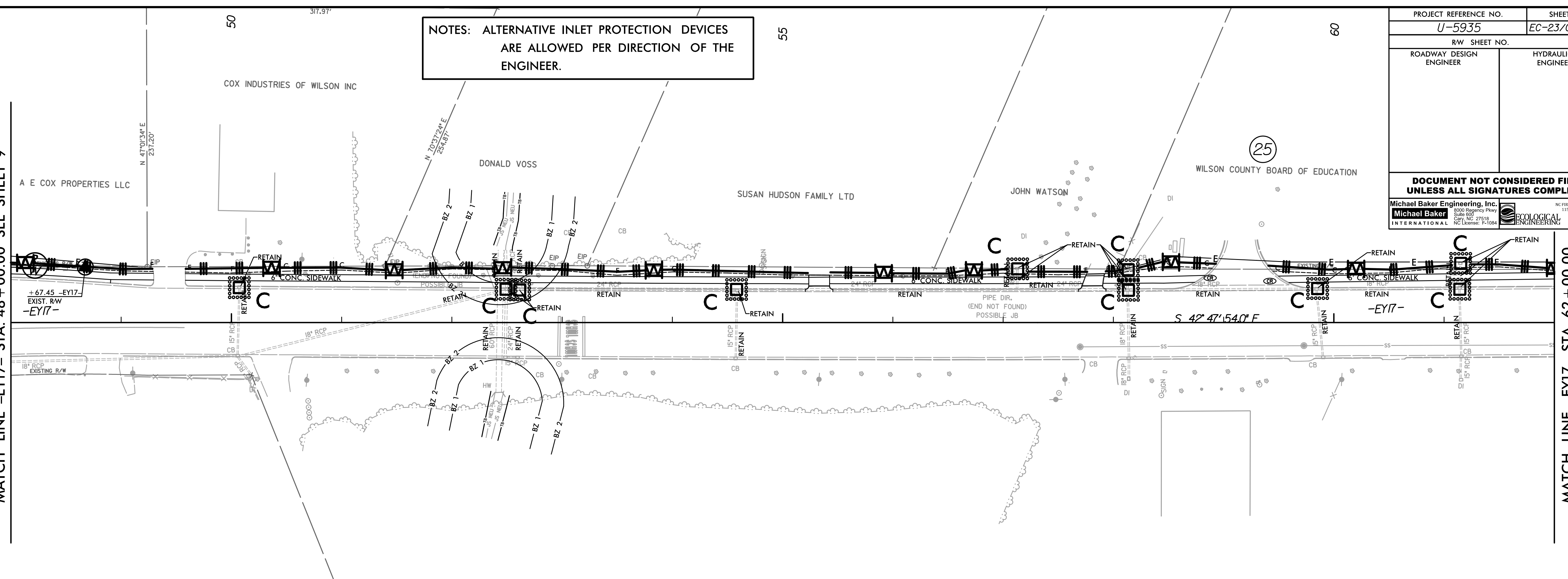

MATCH LINE -EY17- STA. 62 + 00.00 SEE THIS SHEET

MATCH LINE -EY17- STA. 62 + 00.00 SEE THIS SHEET

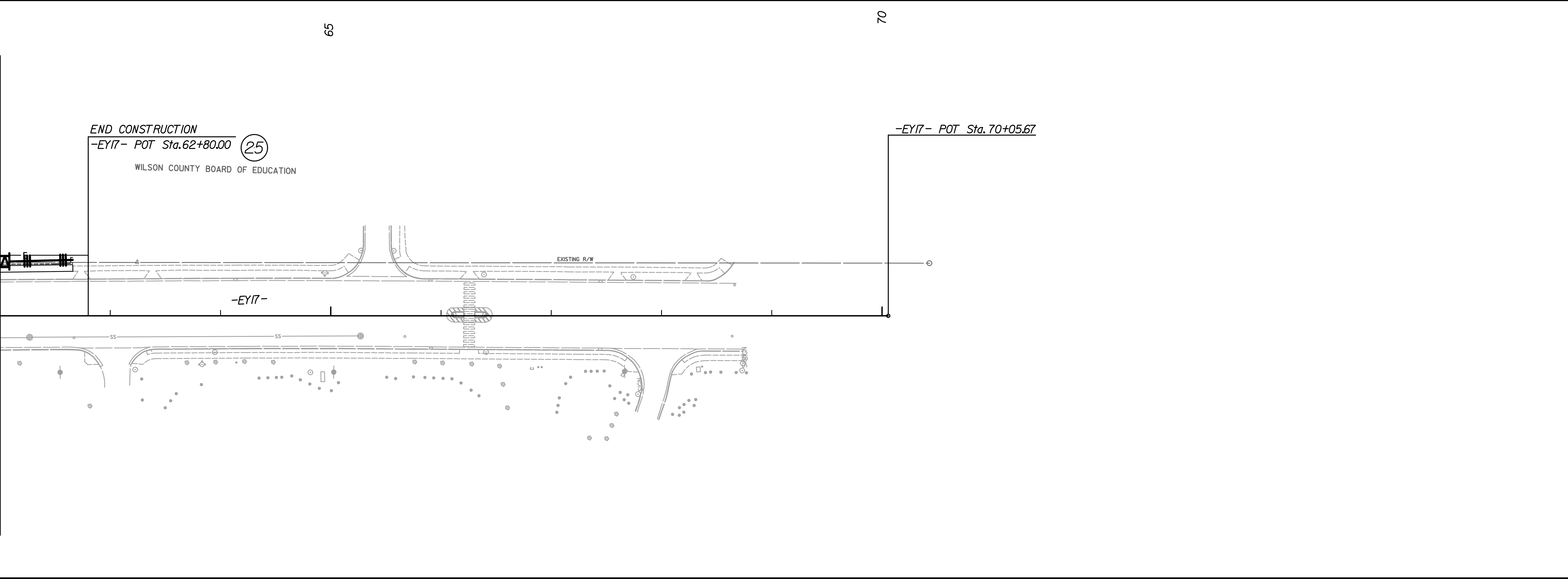

-EY17- POT Sta. 70+05.67

3/20/24 PM  
R:\Environmental\Design\U-5935\_REU\_PSH\_12\_FINAL.dgn  
prandabachan