

PROJECT REFERENCE NO. <i>U-5935</i>		SHEET NO. <i>EC-21/CONST.10</i>	
RW SHEET NO.			
ROADWAY DESIGN ENGINEER		HYDRAULICS ENGINEER	
DOCUMENT NOT CONSIDERED FINAL UNLESS ALL SIGNATURES COMPLETED			
Michael Baker Engineering, Inc. Michael Baker International		ECOLOGICAL ENGINEERING	

MATCH LINE -EY10- STA. 18 + 00.00 SEE SHEET 7

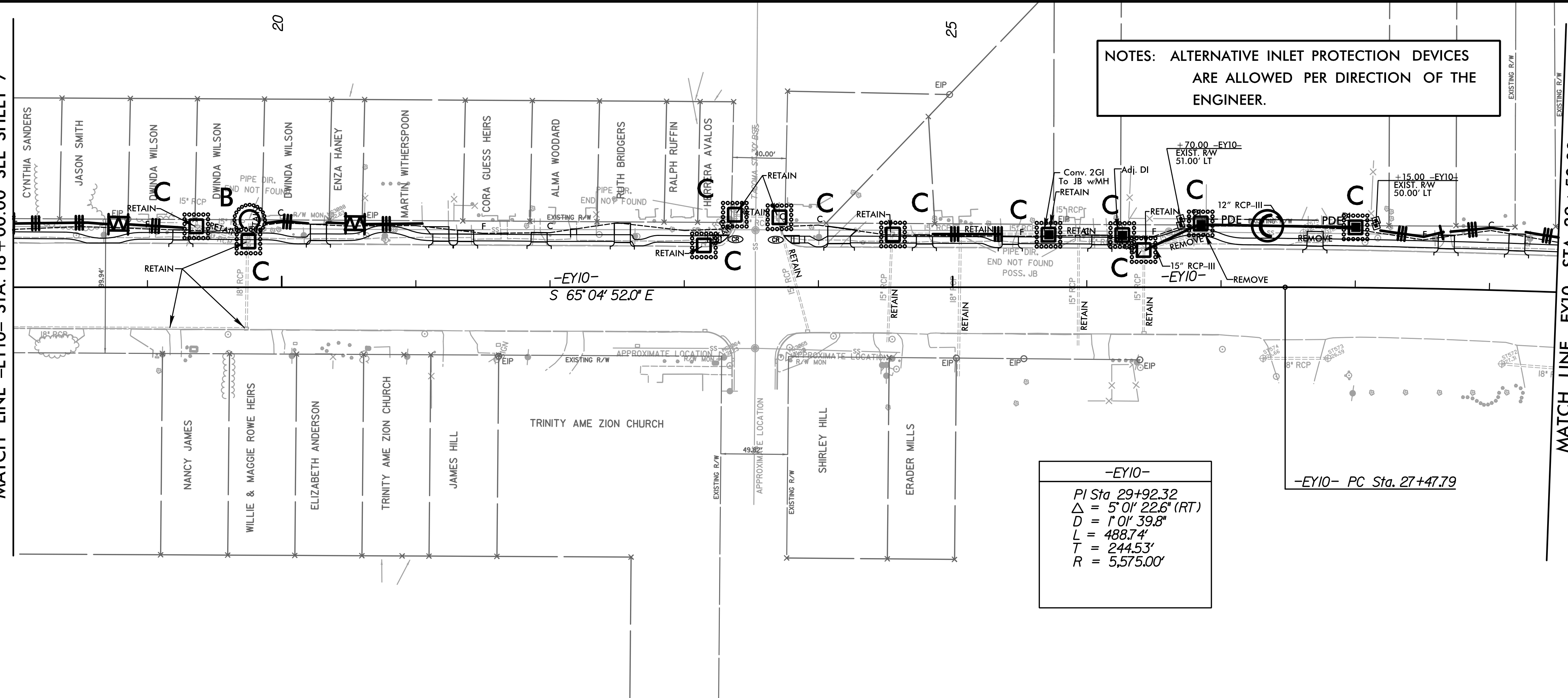

NOTES: ALTERNATIVE INLET PROTECTION DEVICES ARE ALLOWED PER DIRECTION OF THE ENGINEER.

-EY10-
 PI Sta 29+92.32
 $\Delta = 5^{\circ} 0' 22.6''$ (RT)
 $D = 1^{\circ} 0' 39.8''$
 $L = 488.74'$
 $T = 244.53'$
 $R = 5,575.00'$

MATCH LINE -EY10- STA. 29 + 50.00 SEE THIS SHEET

MATCH LINE -EY10- STA. 29 + 50.00 SEE THIS SHEET

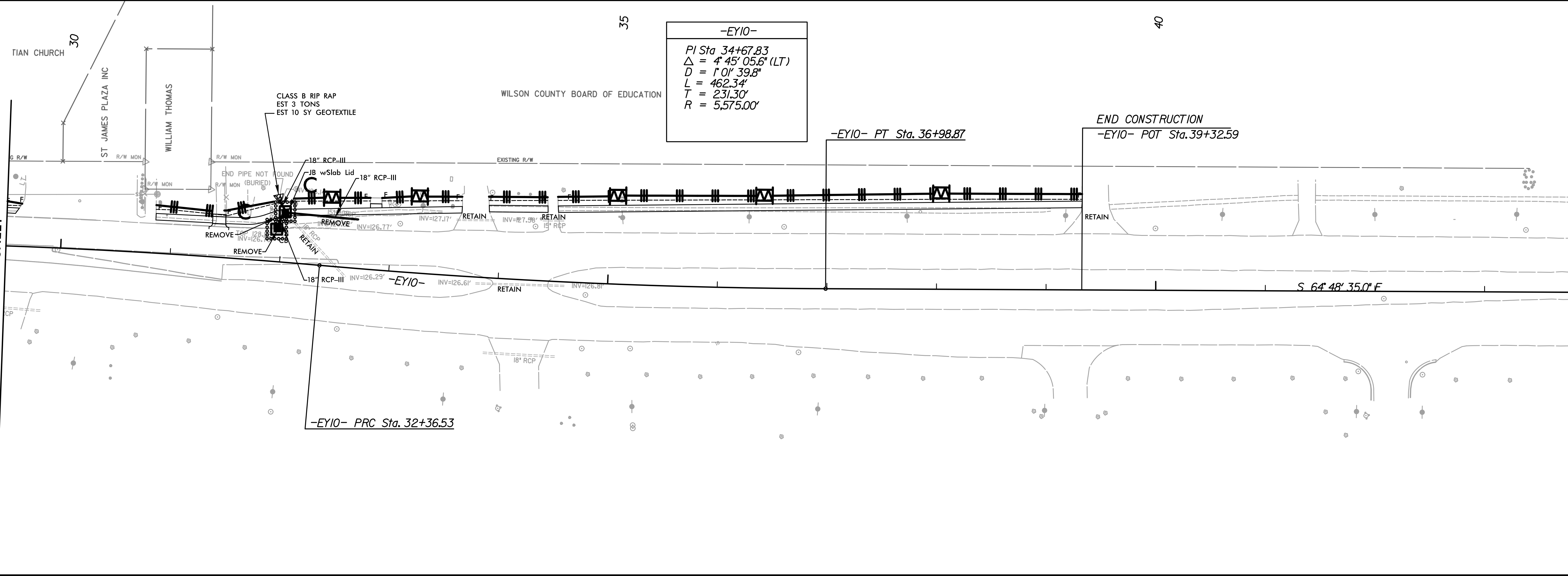

-EY10-
 PI Sta 34+67.83
 $\Delta = 4^{\circ} 45' 05.6''$ (LT)
 $D = 1^{\circ} 0' 39.8''$
 $L = 462.34'$
 $T = 231.30'$
 $R = 5,575.00'$

END CONSTRUCTION
 -EY10- POT Sta. 39+32.59

S 64° 48' 35.0" E