

5/14/99

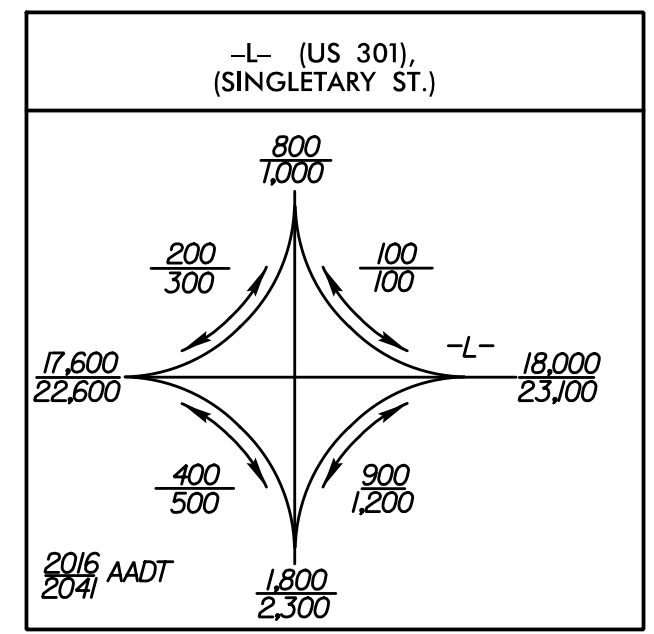
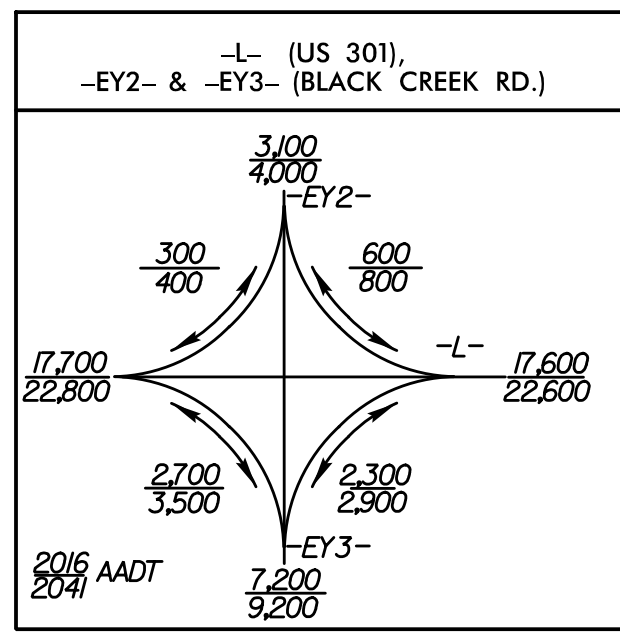

-L-		
Pls Sta 35+66.66	Pl Sta 44+91.24	Pls Sta 53+43.81
$\Theta_s = 1'45''16.9''$	$\Delta = 40'05''11.7''$ (LT)	$\Theta_s = 1'45''16.9''$
$L_s = 147.00'$	$D = 2'23''14.4''$	$L_s = 147.00'$
$LT = 98.00'$	$L = 1679.14'$	$LT = 98.00'$
$ST = 49.00'$	$T = 875.58'$	$ST = 49.00'$
	$R = 2,400.00'$	
	$D_s = 50$ MPH	
	$SE = 0.04$	
	$RUNOFF = 147.00'$	

PROJECT REFERENCE NO. U-5935	SHEET NO. EC-16/CONST.05
ROADWAY DESIGN ENGINEER	HYDRAULICS ENGINEER
DOCUMENT NOT CONSIDERED FINAL UNLESS ALL SIGNATURES COMPLETED	
Michael Baker Engineering, Inc. 1000 Republic Place Suite 100 Cary, NC 27518 Phone: 919.275.1188 Fax: 919.275.1189 NC License: F-1084	ECOLOGICAL ENGINEERING 1153 SE City Parkway Suite 110 Cary, NC 27518 Phone: 919.557-9929 Fax: 919.557-9929 NC License: F-1144

MATCH LINE -L- STA. 22 + 00.00 SEE SHEET 4

MATCH LINE -L- STA. 36 + 00.00 SEE SHEET 6

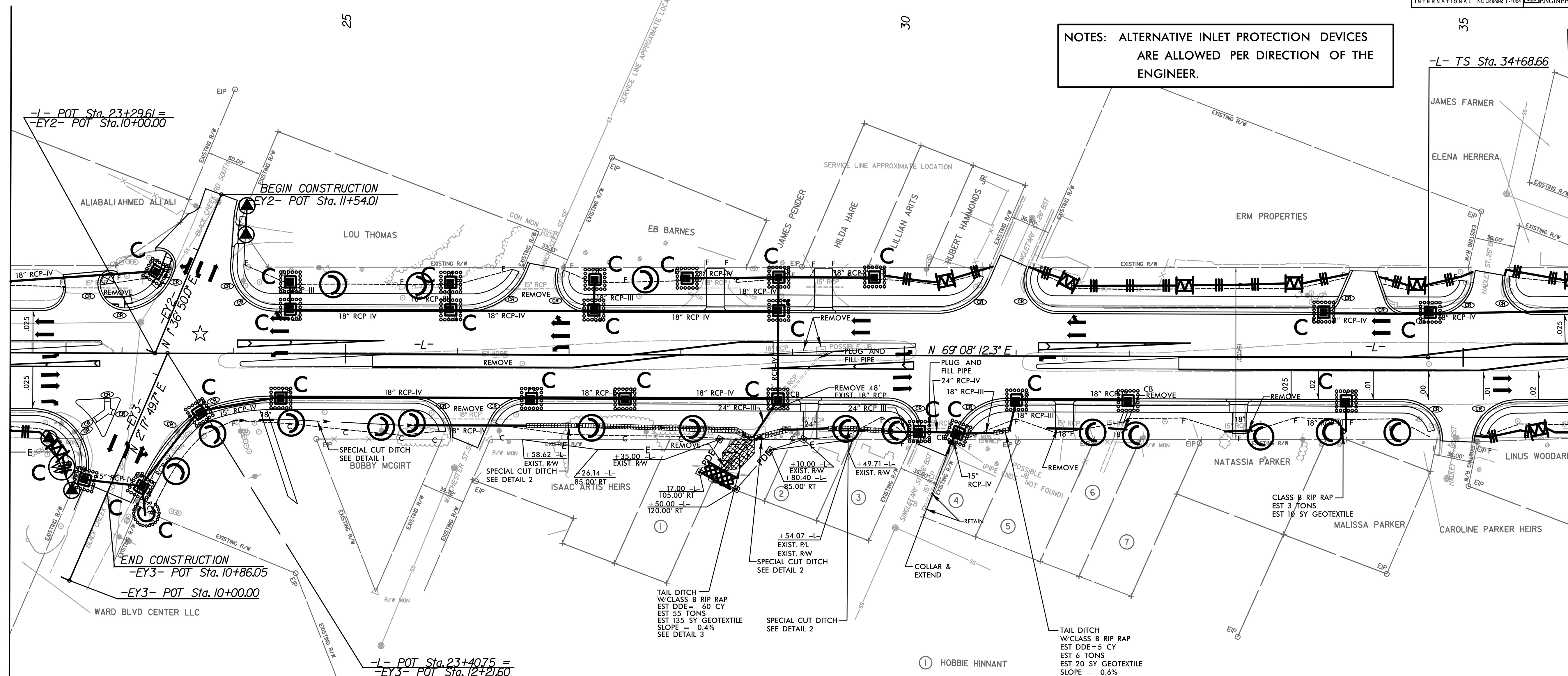

NOTES: ALTERNATIVE INLET PROTECTION DEVICES ARE ALLOWED PER DIRECTION OF THE ENGINEER.

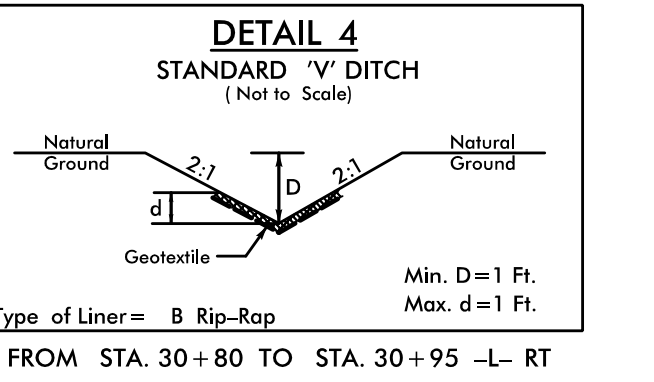
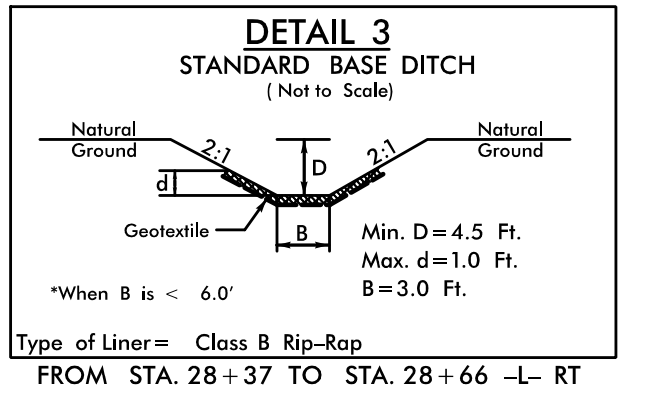
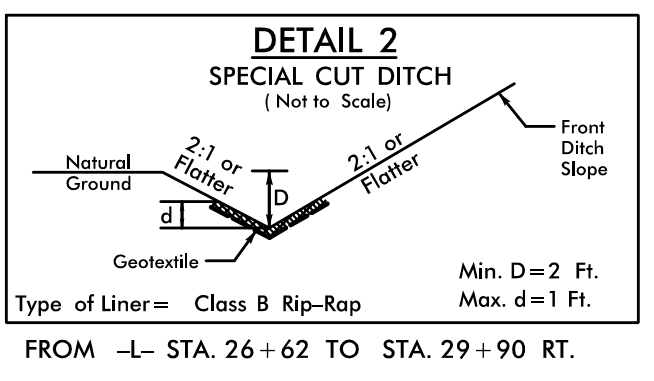
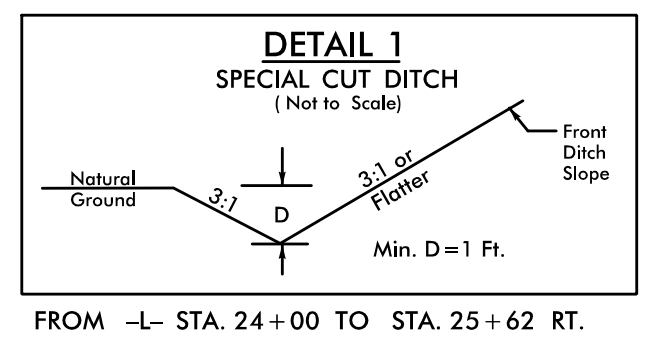

- ① HOBBIE HINNANT
- ② GERALDINE MYLES
- ③ JAMES PENDER
- ④ D&M INVESTMENTS OF ELM CITY LLC
- ⑤ BRENDA SIMMONS
- ⑥ HELEN TUCKER
- ⑦ MILDRED BATTIS

3:20:02 PM
 \\enviro\com\p\m\U-5935_REU_PSH_05_FINAL.dgn
 5/14/99

FOR -L- PROFILE SEE SHEETS 15 & 16