

PROJECT REFERENCE NO.	SHEET NO.
U-5935	PMP-13
Approved by: <i>Kelly M. Cory</i> E2P270FFB1C142E DATE: 7/12/2017	
DOCUMENT NOT CONSIDERED FINAL UNLESS ALL SIGNATURES COMPLETED	
Michael Baker INTERNATIONAL	

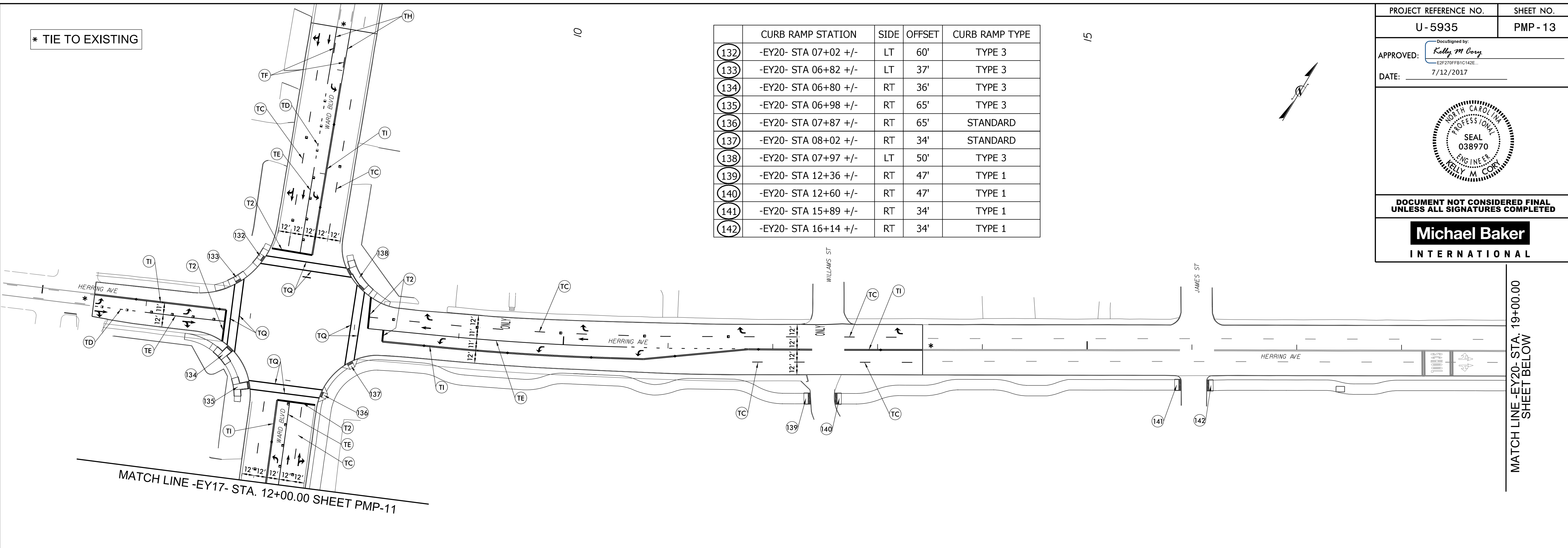

	CURB RAMP STATION	SIDE	OFFSET	CURB RAMP TYPE
132	-EY20- STA 07+02 +/-	LT	60'	TYPE 3
133	-EY20- STA 06+82 +/-	LT	37'	TYPE 3
134	-EY20- STA 06+80 +/-	RT	36'	TYPE 3
135	-EY20- STA 06+98 +/-	RT	65'	TYPE 3
136	-EY20- STA 07+87 +/-	RT	65'	STANDARD
137	-EY20- STA 08+02 +/-	RT	34'	STANDARD
138	-EY20- STA 07+97 +/-	LT	50'	TYPE 3
139	-EY20- STA 12+36 +/-	RT	47'	TYPE 1
140	-EY20- STA 12+60 +/-	RT	47'	TYPE 1
141	-EY20- STA 15+89 +/-	RT	34'	TYPE 1
142	-EY20- STA 16+14 +/-	RT	34'	TYPE 1

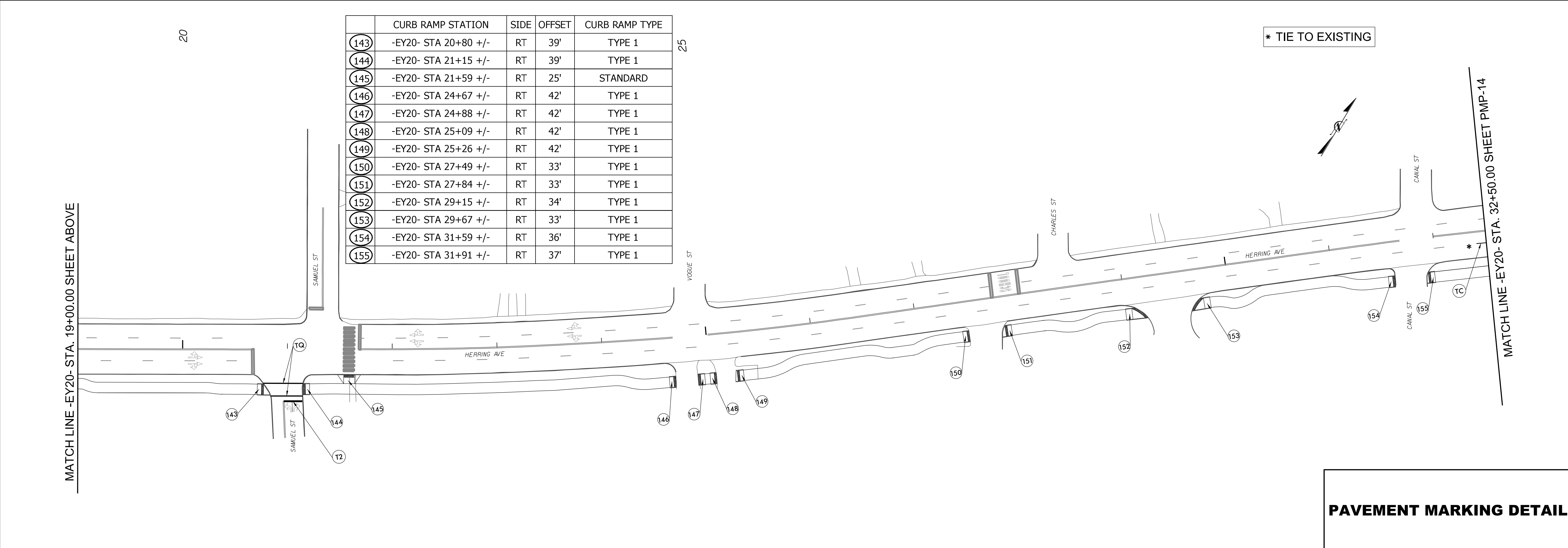

	CURB RAMP STATION	SIDE	OFFSET	CURB RAMP TYPE
143	-EY20- STA 20+80 +/-	RT	39'	TYPE 1
144	-EY20- STA 21+15 +/-	RT	39'	TYPE 1
145	-EY20- STA 21+59 +/-	RT	25'	STANDARD
146	-EY20- STA 24+67 +/-	RT	42'	TYPE 1
147	-EY20- STA 24+88 +/-	RT	42'	TYPE 1
148	-EY20- STA 25+09 +/-	RT	42'	TYPE 1
149	-EY20- STA 25+26 +/-	RT	42'	TYPE 1
150	-EY20- STA 27+49 +/-	RT	33'	TYPE 1
151	-EY20- STA 27+84 +/-	RT	33'	TYPE 1
152	-EY20- STA 29+15 +/-	RT	34'	TYPE 1
153	-EY20- STA 29+67 +/-	RT	33'	TYPE 1
154	-EY20- STA 31+59 +/-	RT	36'	TYPE 1
155	-EY20- STA 31+91 +/-	RT	37'	TYPE 1

PAVEMENT MARKING DETAIL

12-JUL-2017 13:46
 X:\Projects\US_30\Traffic\Pavement Marking Plans\U-5935_PMP_psh_13.dgn
 KMCOR\AT_NORC\CORY