

SURVEY CONTROL SHEET U-5935

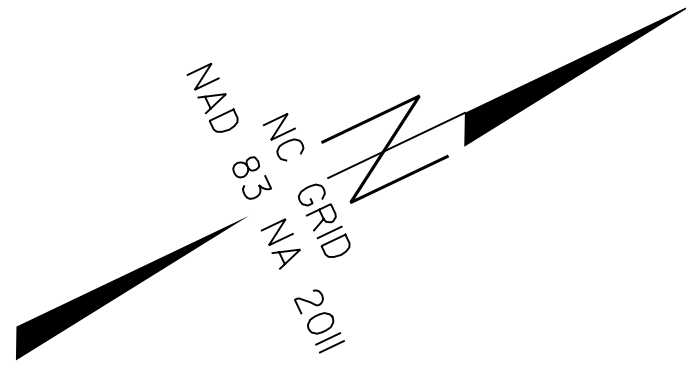

BL POINT	DESC.	NORTH	EAST	ELEVATION	L STATION	OFFSET
WT1	U5935 WT-1	714629.7090	2324192.5670	119.23	13+66.86	46.19 LT
WT2	U5935 WT-2	715058.1720	2325061.0060	132.85	23+25.64	57.70 LT
WT3	U5935 WT-3	715388.8810	2326234.2200	136.35	35+39.35	51.27 RT
WT4	U5935 WT-4	716196.0890	2327317.4340	136.58	48+78.96	53.89 RT
WT5	U5935 WT-5	717133.9200	2327829.3270	134.63	59+38.32	60.20 RT
WT6	U5935 WT-6	718058.8480	2328144.9690	133.71	69+08.95	53.79 LT
WT7	U5935 WT-7	719684.1050	2328902.7550	132.32	87+02.11	70.79 LT

BY1 POINT	DESC.	NORTH	EAST	ELEVATION	EY10 STATION	OFFSET
WT16	U5935 WT-16	717427.0990	2327508.0290	133.36	10+42.57	32.24 LT
WT17	U5935 WT-17	716740.7850	2328989.8840	130.37	26+75.64	34.18 LT
WT18	U5935 WT-18	716233.2620	2329769.8150	130.61	35+99.31	56.11 RT

BY2 POINT	DESC.	NORTH	EAST	ELEVATION	EY17 STATION	OFFSET
WT10	U5935 WT-10	722215.0210	2326931.0260	132.80	10+72.86	107.06 LT
WT9	U5935 WT-9	721418.2290	2327203.9380	115.43	19+15.12	38.55 RT
WT8	U5935 WT-8	720250.2720	2327976.7280	130.39	33+09.71	38.62 RT
70	U5935 WT-7	719684.1050	2328902.7550	132.32	43+83.39	84.20 LT
WT19	U5935 WT-19	718572.6260	2329832.0970	132.06	58+19.29	37.32 RT

BY3 POINT	DESC.	NORTH	EAST	ELEVATION	EY20 STATION	OFFSET
10	U5935 WT-10	722215.0210	2326931.0260	132.80	8+47.33	34.57 RT
WT11	U5935 WT-11	722827.6040	2327962.9550	118.82	20+44.90	27.06 RT
WT12	U5935 WT-12	723576.2990	2328978.9220	96.15	33+06.04	26.22 RT
WT13	U5935 WT-13	724224.5420	2329822.2350	95.55	43+65.69	36.79 LT
WT14	U5935 WT-14	724487.9800	2330392.2430	97.95	49+93.56	46.39 LT
WT15	U5935 WT-15	724722.1890	2331154.1630	110.72	57+78.02	56.96 LT

.....

BM1 ELEVATION = 132.20
N 714786 E 2324789
BL STATION 11+04.00 124 RIGHT
BENCH NAIL IN BASE OF 12' OAK

.....

BM2 ELEVATION = 133.93
N 715335 E 2326690
BL STATION 30+21.00 315 RIGHT
BENCH NAIL IN BASE OF 18' OAK

.....

BM3 ELEVATION = 134.38
N 717655 E 2327927
BL STATION 56+32.00 76 LEFT
BENCH NAIL IN BASE OF 36' OAK

.....

BM4 ELEVATION = 132.42
N 719897 E 2328718
BY2 STATION 35+60.00 85 LEFT
CONCRETE SLAB OF LIGHT POLE

.....

BM5 ELEVATION = 121.80
N 721172 E 2327775
BY2 STATION 18+62.00 341 LEFT
BENCH NAIL IN BASE OF 30" ELM

.....

BM6 ELEVATION = 127.68
N 722586 E 2327436
BY3 STATION 11+23.00 62 LEFT
BENCH NAIL IN BASE OF 15' PINE

.....

BM7 ELEVATION = 90.99
N 723761 E 2329345
BY3 STATION 33+65.00 77 RIGHT
BENCH NAIL IN BASE OF 15' SWEET GUM

.....

BM8 ELEVATION = 106.86
N 724727 E 2330917
BY3 STATION 52+26.00 74 LEFT
BENCH NAIL IN BASE OF 36" OAK

.....

BEGIN TIP U-5935
-L- POT Sta. 16+20.00

END TIP U-5935
-L- POT Sta. 87+55.00

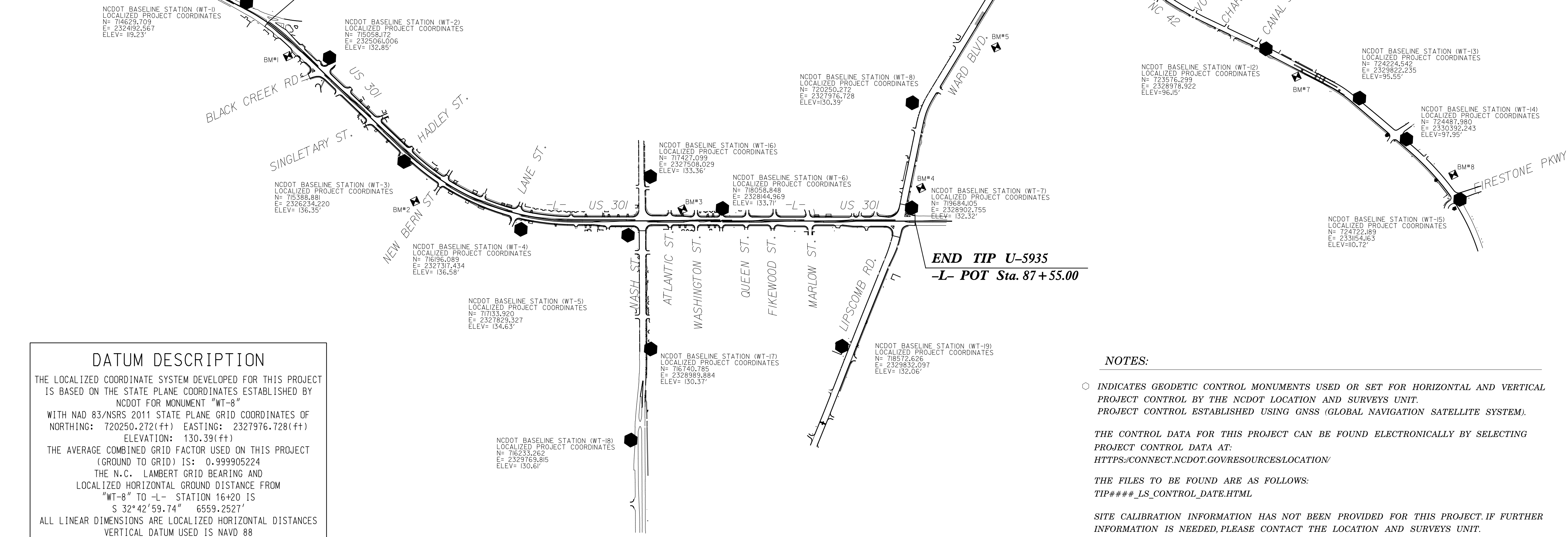

DATUM DESCRIPTION

THE LOCALIZED COORDINATE SYSTEM DEVELOPED FOR THIS PROJECT IS BASED ON THE STATE PLANE COORDINATES ESTABLISHED BY NCDOT FOR MONUMENT "WT-8"

WITH NAD 83/NSRS 2011 STATE PLANE GRID COORDINATES OF
NORTHING: 720250.272(±ft) EASTING: 2327976.728(±ft)
ELEVATION: 130.39(±ft)

THE AVERAGE COMBINED GRID FACTOR USED ON THIS PROJECT (GROUND TO GRID) IS: 0.999905224

THE N.C. LAMBERT GRID BEARING AND LOCALIZED HORIZONTAL GROUND DISTANCE FROM "WT-8" TO -L- STATION 16+20 IS
S 32°42'59.74" 6559.2527'

ALL LINEAR DIMENSIONS ARE LOCALIZED HORIZONTAL DISTANCES
VERTICAL DATUM USED IS NAVD 88

NOTES:

- INDICATES GEODETIC CONTROL MONUMENTS USED OR SET FOR HORIZONTAL AND VERTICAL PROJECT CONTROL BY THE NCDOT LOCATION AND SURVEYS UNIT. PROJECT CONTROL ESTABLISHED USING GNSS (GLOBAL NAVIGATION SATELLITE SYSTEM).

THE CONTROL DATA FOR THIS PROJECT CAN BE FOUND ELECTRONICALLY BY SELECTING PROJECT CONTROL DATA AT:
[HTTPS://CONNECT.NCDOT.GOV/RESOURCES/LOCATION/](https://connect.ncdot.gov/resources/location/)

THE FILES TO BE FOUND ARE AS FOLLOWS:
TIP###_LS_CONTROL_DATE.HTML

SITE CALIBRATION INFORMATION HAS NOT BEEN PROVIDED FOR THIS PROJECT. IF FURTHER INFORMATION IS NEEDED, PLEASE CONTACT THE LOCATION AND SURVEYS UNIT.

NOTE: DRAWING NOT TO SCALE

6/2/99
15 JUL 2017 14:25
\\s01\proj\GIS\NCDOT\U-5935\1c-1.dgn