

i:\Projects\4016617\4016617\_000\50\_Deliverables & Submittals\U-475\Structures\Culverts\CU #3\410\_009\_U475\_SML\_CU\_005\_640003.dgn 3:30:21 PM 7/11/2017 bcurry

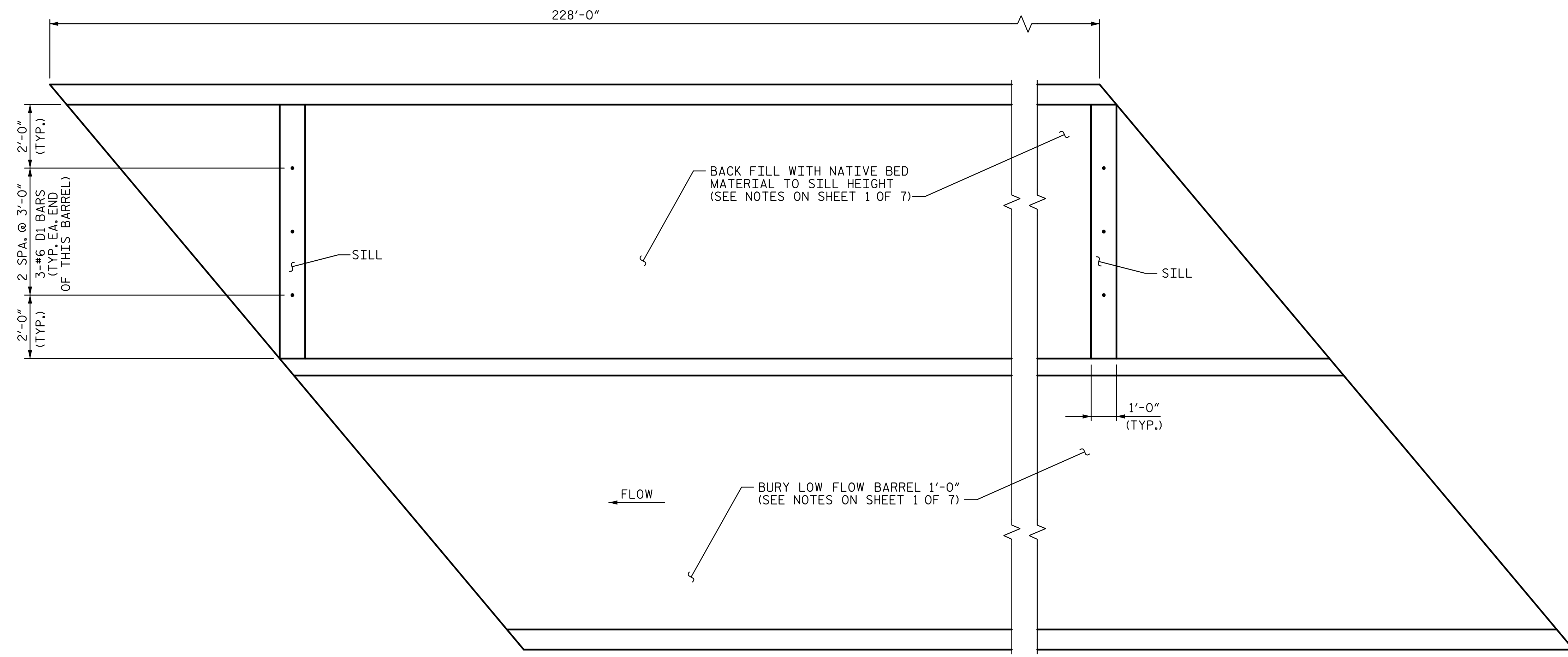

PLAN VIEW - LOCATION OF SILLS

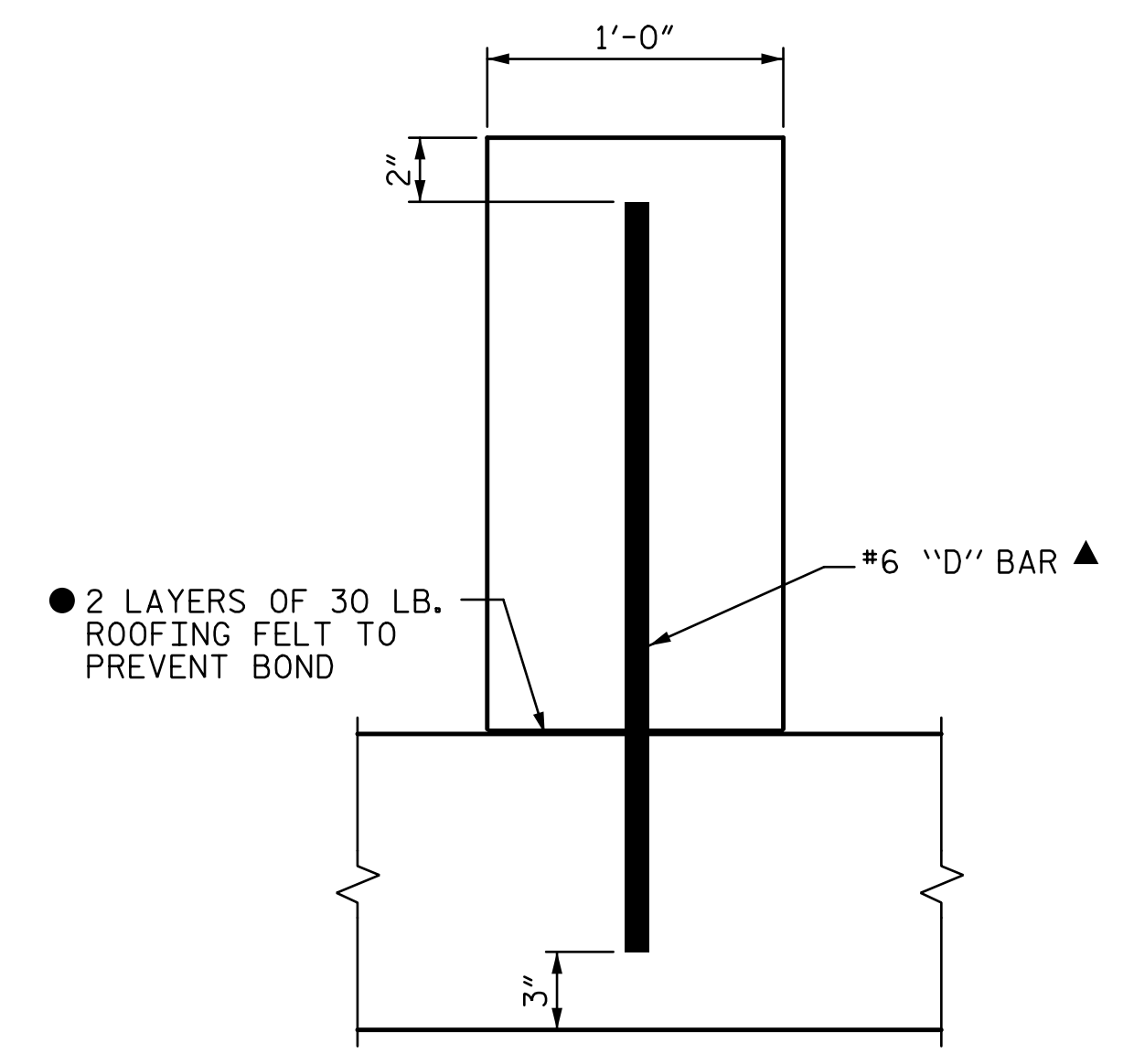

▲ DOWELS MAY BE PUSHED INTO GREEN CONCRETE AFTER SLAB HAS BEEN FLOAT FINISHED.

SECTION THROUGH SILL

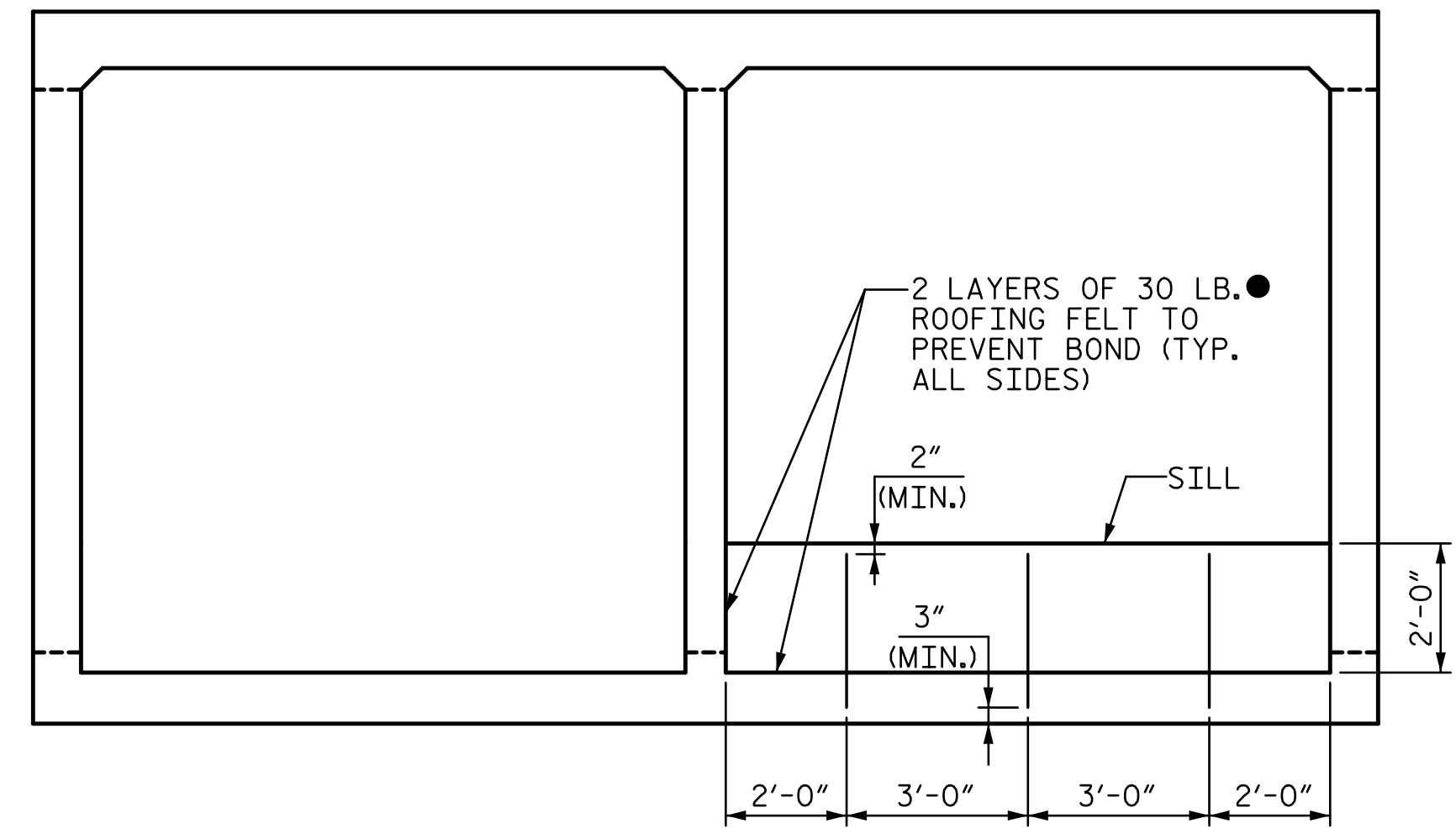

ELEVATION

(INLET VIEW SHOWN)  
● THE COST OF THE ROOFING FELT IS INCIDENTAL AND SHALL BE INCLUDED IN THE VARIOUS PAY ITEMS

PROJECT NO. U-4751  
NEW HANOVER COUNTY  
 STATION: 151+41.00 -L-  
 SHEET 5 OF 7

DOCUMENT NOT CONSIDERED FINAL UNLESS ALL SIGNATURES COMPLETED			STATE OF NORTH CAROLINA DEPARTMENT OF TRANSPORTATION RALEIGH		SHEET NO. C3-5
	<b>SILL DETAILS</b>				TOTAL SHEETS 7
	REVISIONS				
NO.	BY:	DATE:	NO.	BY:	DATE:
1			3		
2			4		

DRAWN BY : <u>BMC</u>	DATE : <u>5-17</u>	DESIGN ENGINEER OF RECORD: <u>B. CURRY</u>	DATE : <u>5-17</u>
CHECKED BY : <u>MLO</u>	DATE : <u>5-17</u>		