

END BENT 1

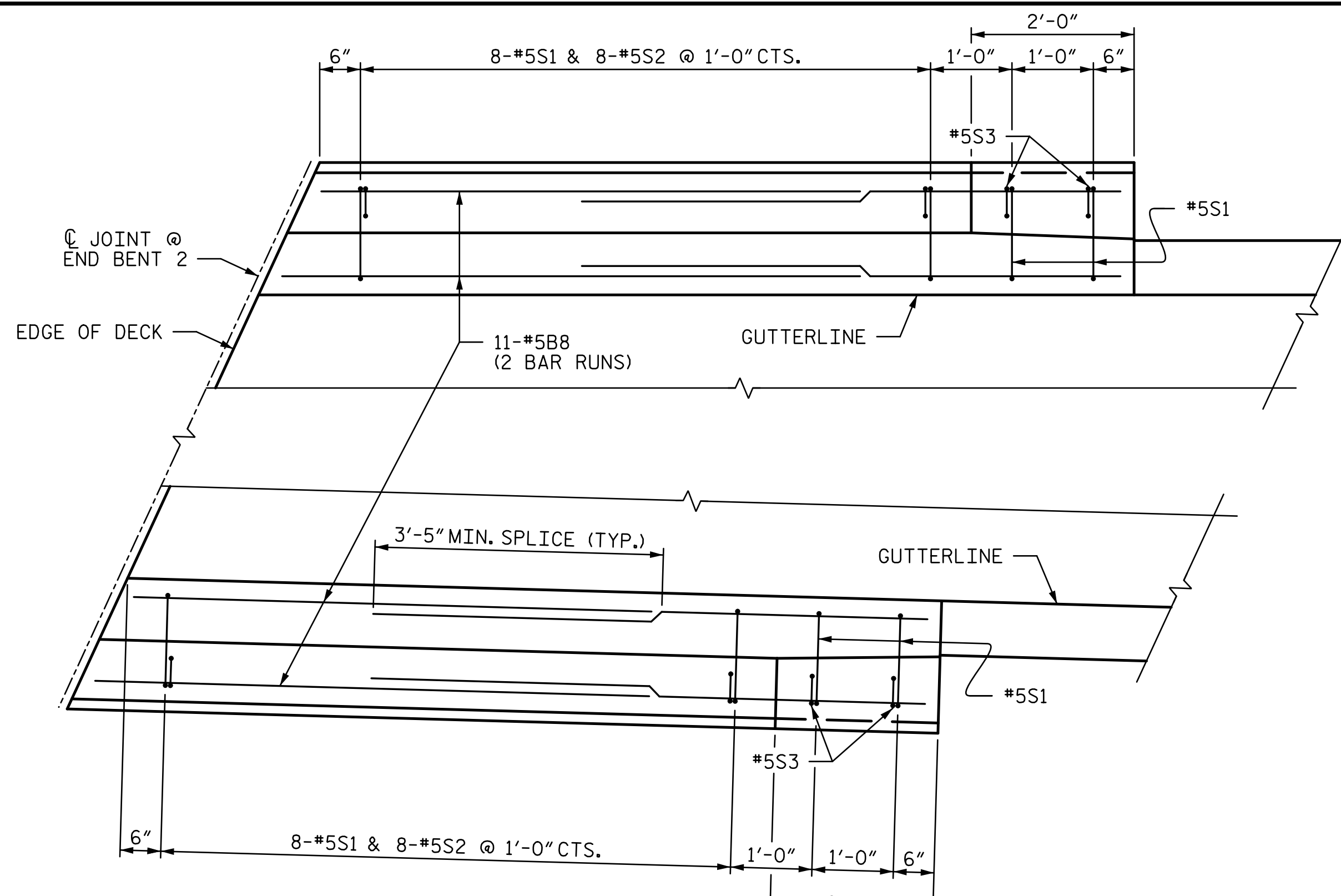

END BENT 2

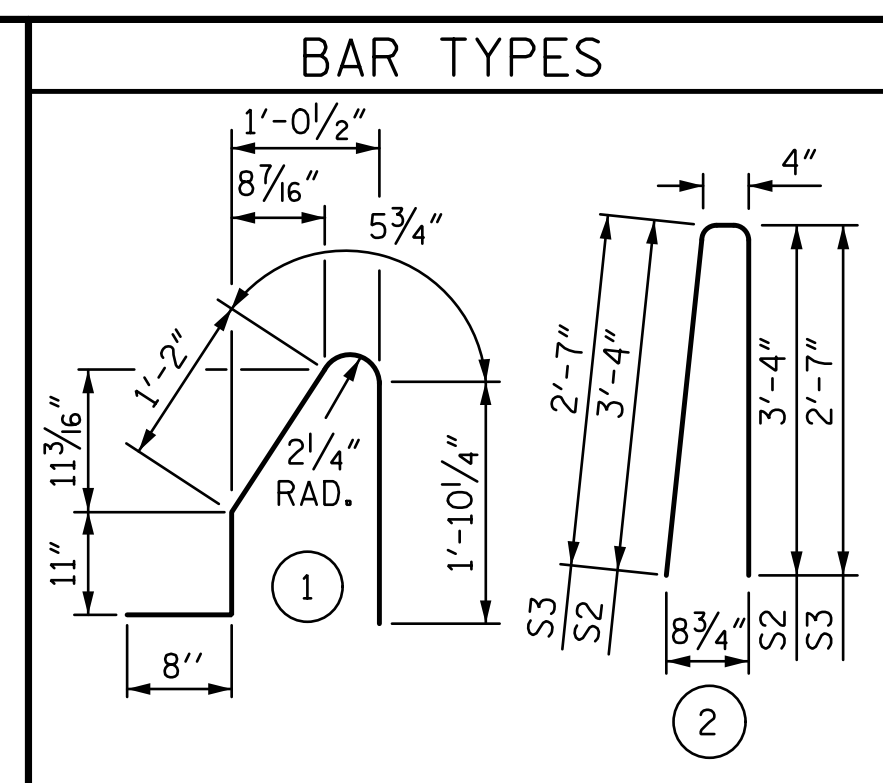

ALL BAR DIMENSIONS ARE OUT TO OUT

BILL OF MATERIAL					
BARRIER RAIL ONLY					
BAR	NO.	SIZE	TYPE	LENGTH	WEIGHT
*B7	44	#5	STR	6'-8"	306
*B8	44	#5	STR	6'-10"	314
*S1	40	#5	1	5'-1"	212
*S2	32	#5	2	7'-0"	234
*S3	8	#5	2	5'-6"	46
* EPOXY COATED REINFORCING STEEL				LBS.	1,112
CLASS AA CONCRETE				C. Y.	5.7

NOTES

THE COST OF THE BARRIER RAIL ON THE APPROACH SLAB SHALL BE INCLUDED IN THE LINEAR FOOT CONTRACT PRICE BID FOR "CONCRETE BARRIER RAIL".

THE BARRIER RAIL ON EACH APPROACH SLAB SHALL NOT BE CAST UNTIL ALL APPROACH SLAB CONCRETE HAS BEEN CAST AND HAS REACHED A MINIMUM COMPRESSIVE STRENGTH OF 3,000 PSI.

ALL REINFORCING STEEL IN BARRIER RAILS SHALL BE EPOXY COATED.

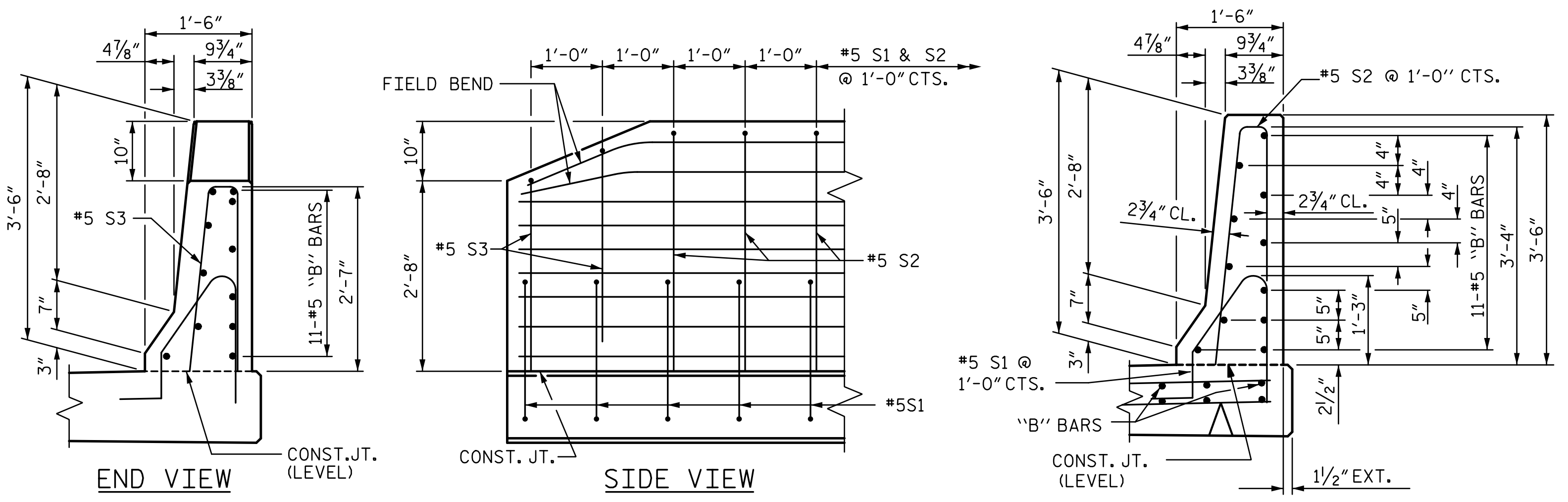

END OF RAIL DETAILS

SECTION THRU RAIL

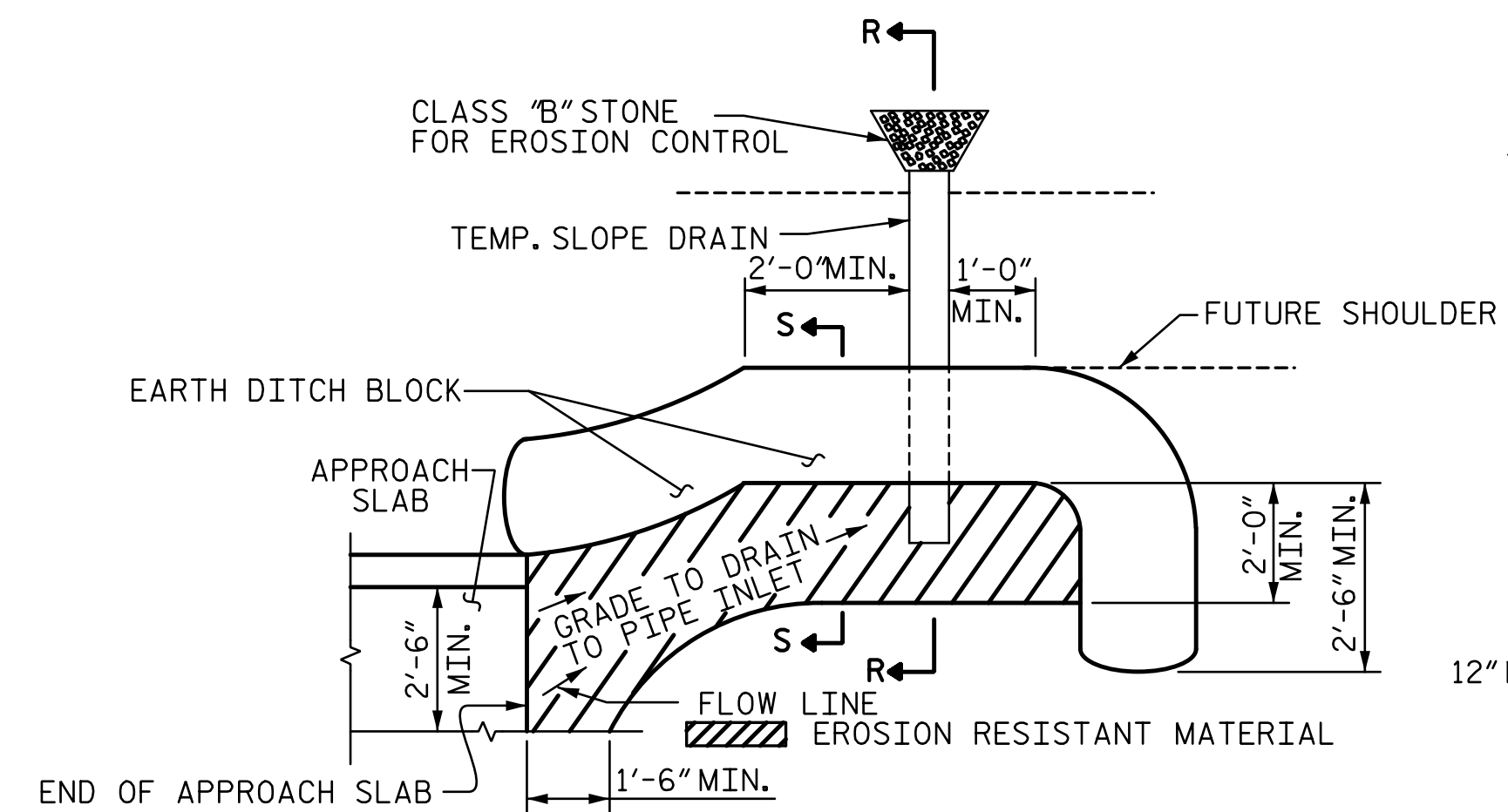

PLAN VIEW

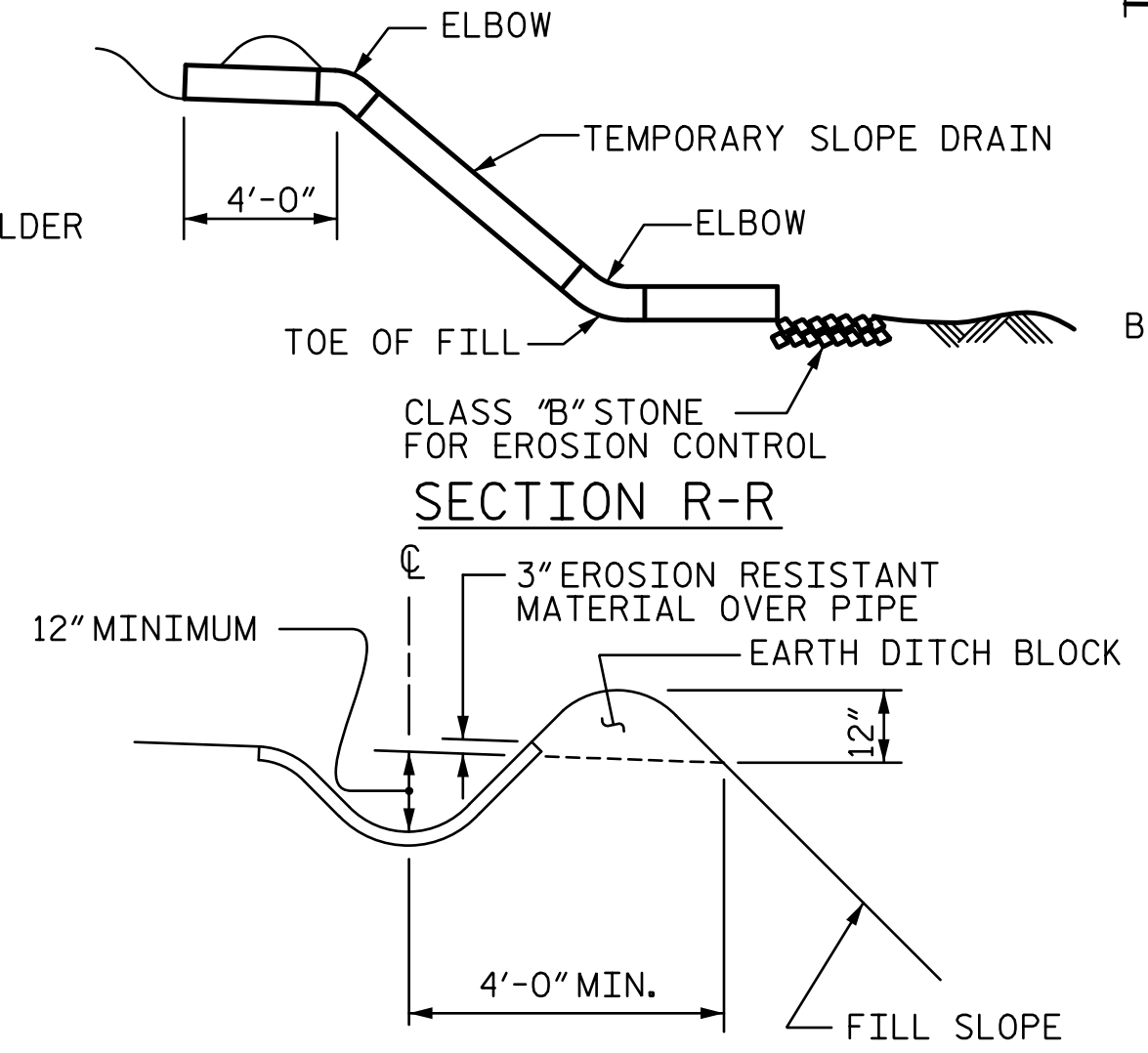

SECTION S-S

TEMPORARY BERM AND SLOPE DRAIN DETAILS

(TO BE USED WHEN SHOULDER BERM GUTTER IS REQUIRED)

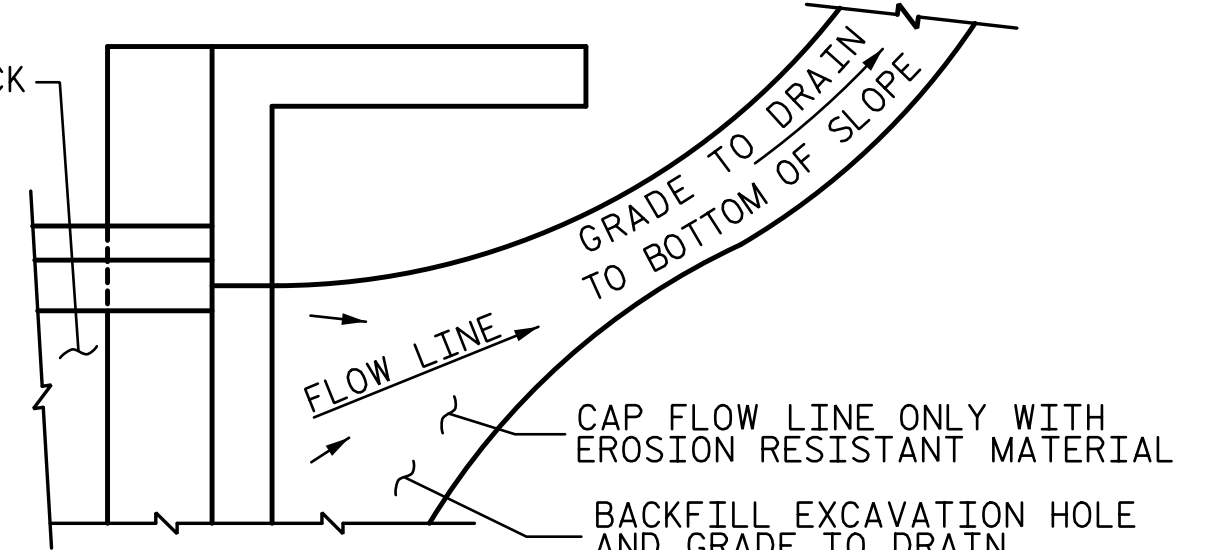

TEMPORARY DRAINAGE DETAIL

PROJECT NO. U-4751  
 NEW HANOVER COUNTY  
 STATION: 35+12.05 -Y8RPDB-  
 SHEET 2 OF 2

STATE OF NORTH CAROLINA  
 DEPARTMENT OF TRANSPORTATION  
 RALEIGH

BRIDGE APPROACH SLAB DETAILS

REVISIONS

NO.	BY:	DATE:	NO.	BY:	DATE:
1			3		
2			4		

SHEET NO. S4-36  
 TOTAL SHEETS 36

r:\404\_071\_U4751\_SMJ\_AS\_036\_640204.dgn  
 12/17/15  
 7/24/2017  
 12:17:56

DRAWN BY: MBC DATE: 3-17  
 CHECKED BY: TRL DATE: 4-17  
 DESIGN ENGINEER OF RECORD: T. LAWS DATE: 5-17