

5/14/99

PROJECT REFERENCE NO. <b>B-5236</b>	SHEET NO. <b>5</b>
ROADWAY DESIGN ENGINEER W. S. HOOD SEAL 014509 N.C. PROFESSIONAL SEAL 8/18/2013 W. S. HOOD	HYDRAULICS ENGINEER MAX S. PRICE SEAL 023993 N.C. PROFESSIONAL SEAL 8/18/2013 MAX S. PRICE
<b>DOCUMENT NOT CONSIDERED FINAL UNLESS ALL SIGNATURES COMPLETED</b>	

BM #1 RR SPIKE SET IN 14" PINE  
 -L- STA. 13+63.00 43.00' LT, ELEV. = 7.98'  
 N 124023 E 2326627

-L-

PI = 15+60.00  
 EL = 10.48'  
 VC = 326'  
 K = 154  
 V = 60 MPH

PI = 12+00.00  
 EL = 6.61'  
 VC = 250'  
 K = 631  
 V > 80 MPH

PI = 19+85.00  
 EL = 6.08'  
 VC = 130'  
 K = 156  
 V = 64 MPH

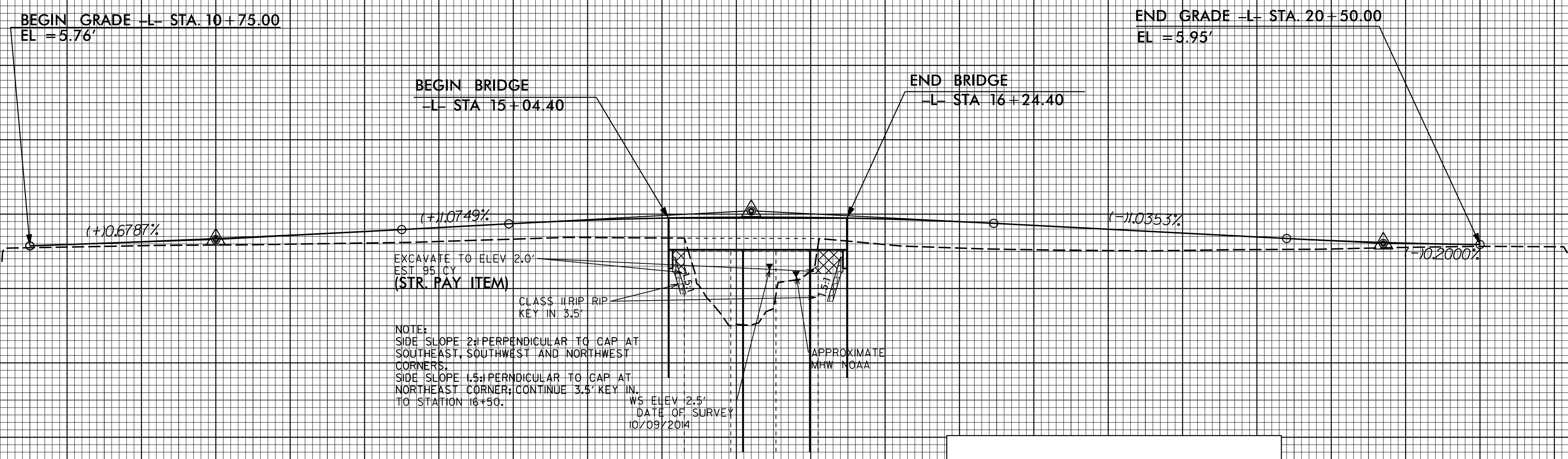

DESIGN DISCHARGE	=	N/A	CFS
DESIGN FREQUENCY	=	N/A	YRS
DESIGN HW ELEVATION	=	N/A	FT
BASE DISCHARGE	=	N/A	CFS
BASE FREQUENCY	=	100	YRS
BASE HW ELEVATION	=	9.0	FT
OVERTOPPING DISCHARGE	=	1,000	CFS
OVERTOPPING FREQUENCY	=	N/A	YRS
OVERTOPPING ELEVATION	=	5.64	FT
DATE OF SURVEY	=	10/9/2014	
W.S. ELEVATION AT DATE OF SURVEY	=	2.5	FT

FOR -L- PLAN, SEE SHEET 4  
 FOR STRUCTURE PLANS, SEE SHEETS S-1 THROUGH S-35

18-AUG-2017 08:24  
 B:\AUGUST\2017\B5236.rdy.pfl.dgn  
 \$\$\$\$B5236\$\$\$\$