

LAYOUT FOR COMPUTING AREA OF REINFORCED CONCRETE DECK SLAB (SQ. FT. 19,189)

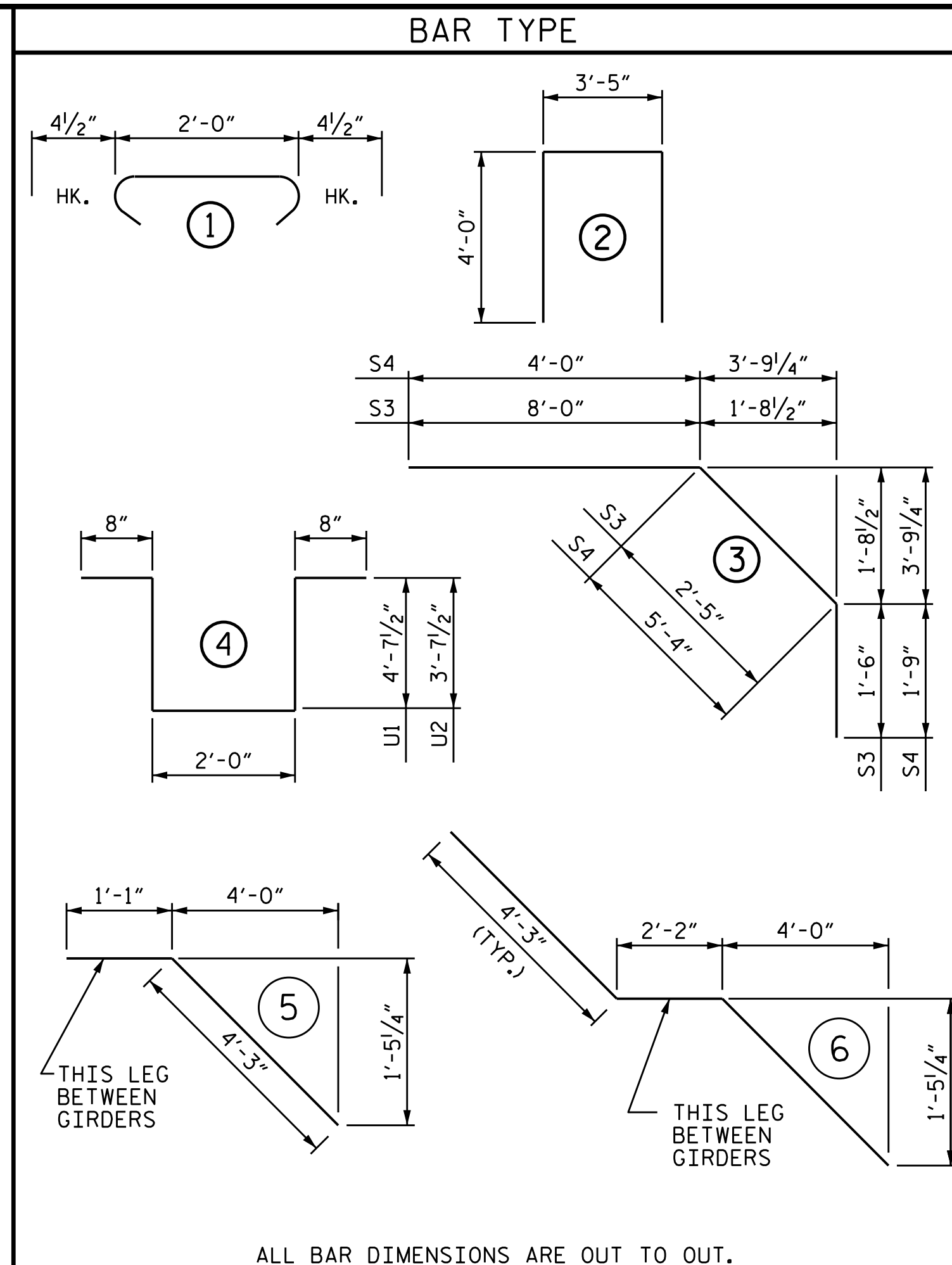

BAR TYPE						BILL OF MATERIAL						
BAR	NO.	SIZE	TYPE	LENGTH	WEIGHT	BAR	NO.	SIZE	TYPE	LENGTH	WEIGHT	
*A1	860	#5	STR	38'-9"	34758	*B1	10	#5	STR	52'-7"	548	
A2	860	#5	STR	38'-7"	34608	*B2	197	#5	STR	13'-0"	2671	
*A101	8	#5	STR	37'-1"	309	*B3	100	#4	STR	16'-6"	1102	
*A102	8	#5	STR	35'-1"	293	*B4	99	#5	STR	58'-0"	5989	
*A103	8	#5	STR	33'-1"	276	*B5	98	#5	STR	24'-0"	2453	
*A104	4	#5	STR	59'-5"	248	*B6	100	#4	STR	17'-0"	1136	
*A105	4	#5	STR	55'-5"	231	*B7	198	#5	STR	34'-9"	7176	
*A106	4	#5	STR	51'-4"	214	*B8	98	#5	STR	28'-6"	2913	
*A107	4	#5	STR	47'-4"	197	*B9	100	#4	STR	23'-9"	1587	
*A108	4	#5	STR	43'-3"	180	*B10	197	#5	STR	19'-0"	3904	
*A109	4	#5	STR	39'-3"	164	B11	400	#5	STR	52'-4"	21833	
*A110	4	#5	STR	35'-2"	147	K1	30	#4	STR	26'-5"	529	
*A111	4	#5	STR	31'-2"	130	K2	16	#4	STR	6'-2"	66	
*A112	4	#5	STR	27'-1"	113	K3	96	#4	STR	6'-8"	428	
*A113	4	#5	STR	23'-1"	96	K4	96	#4	STR	7'-9"	497	
*A114	4	#5	STR	19'-0"	79	K5	32	#4	STR	5'-0"	107	
*A115	4	#5	STR	15'-0"	63	K6	20	#4	5	5'-4"	71	
*A116	4	#5	STR	10'-11"	46	K7	70	#4	6	10'-8"	499	
*A117	4	#5	STR	6'-11"	29	K8	4	#4	STR	2'-3"	6	
*A118	4	#5	STR	2'-10"	12	K9	8	#4	STR	2'-6"	13	
A201	8	#5	STR	36'-11"	308	K10	8	#4	STR	3'-0"	16	
A202	8	#5	STR	34'-11"	291	S1	416	#4	1	2'-9"	764	
A203	8	#5	STR	32'-11"	275	S2	120	#4	2	11'-5"	915	
A204	4	#5	STR	59'-5"	248	*S3	120	#4	3	11'-11"	955	
A205	4	#5	STR	55'-5"	231	*S4	120	#4	3	11'-1"	888	
A206	4	#5	STR	51'-4"	214							
A207	4	#5	STR	47'-4"	197	U1	80	#4	4	12'-7"	672	
A208	4	#5	STR	43'-3"	180	U2	32	#4	4	10'-7"	226	
A209	4	#5	STR	39'-3"	164	REINFORCING STEEL					LBS.	64,073
A210	4	#5	STR	35'-2"	147	* EPOXY COATED						
A211	4	#5	STR	31'-2"	130	REINFORCING STEEL					LBS.	68,907
A212	4	#5	STR	27'-1"	113							
A213	4	#5	STR	23'-1"	96							
A214	4	#5	STR	19'-0"	79							
A215	4	#5	STR	15'-0"	63							
A216	4	#5	STR	10'-11"	46							
A217	4	#5	STR	6'-11"	29							
A218	4	#5	STR	2'-10"	12							

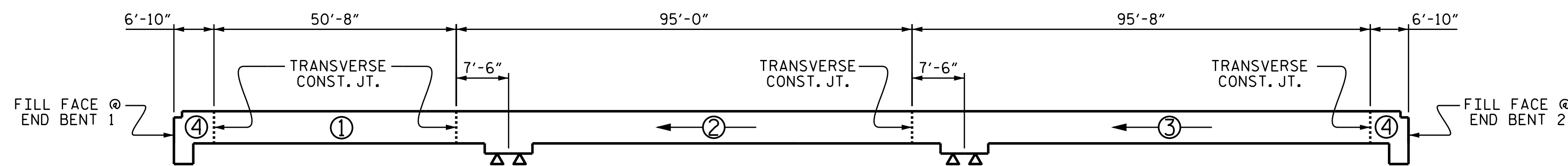

DECK POURING SEQUENCE

⊕ = INDICATES THE NUMBER AND DIRECTION OF POUR.

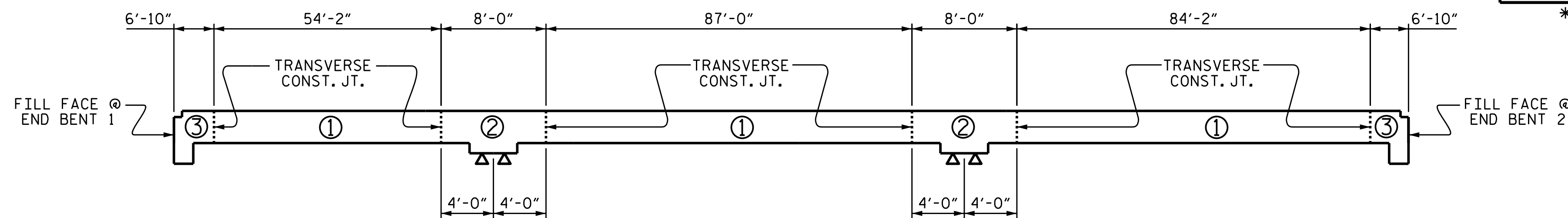

OPTIONAL DECK POURING DETAIL

POURS ② AND ③ SHALL NOT BE STARTED UNTIL BOTH ADJACENT POUR ① REACH A MINIMUM OF 3000 PSI

GROOVING BRIDGE FLOORS

APPROACH SLABS	3,331	SO. FT.
BRIDGE DECK	17,452	SO. FT.
TOTAL	20,783	SO. FT.

SUPERSTRUCTURE BILL OF MATERIAL

	CLASS AA CONCRETE (C.Y.)	REINFORCING STEEL (LBS.)	EPOXY COATED REINFORCING STEEL (LBS.)
POUR #1	118.1		
POUR #2	248.3		
POUR #3	249.5	64,073	68,907
POUR #4	107.1		
TOTAL **	723.0	64,073	68,907

** QUANTITIES FOR CONCRETE BARRIER RAIL ARE NOT INCLUDED

SUPERSTRUCTURE REINFORCING STEEL LENGTHS ARE BASED ON THE FOLLOWING MINIMUM SPLICE LENGTHS

BAR SIZE	SUPERSTRUCTURE EXCEPT APPROACH SLABS, PARAPET, AND BARRIER RAIL		APPROACH SLABS		PARAPET AND BARRIER RAIL
	EPOXY COATED	UNCOATED	EPOXY COATED	UNCOATED	
#4	2'-0"	1'-9"	2'-0"	1'-9"	2'-9"
#5	2'-6"	2'-2"	2'-6"	2'-2"	3'-5"
#6	3'-0"	2'-7"	3'-10"	2'-7"	4'-4"
#7	5'-3"	3'-6"			
#8	6'-10"	4'-7"			

PROJECT NO. U-2579C
 FORSYTH COUNTY
 STATION: 473+70.00 -L-

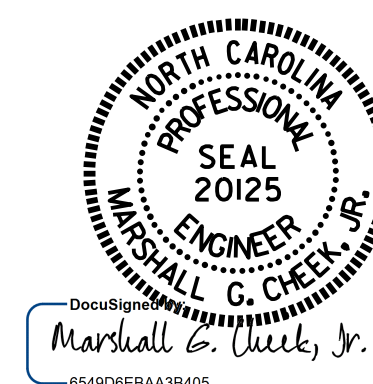

STATE OF NORTH CAROLINA
 DEPARTMENT OF TRANSPORTATION
 RALEIGH
 SUPERSTRUCTURE
 BILL OF MATERIAL
 (LEFT LANE)

REVISIONS				SHEET NO.
NO.	BY:	DATE:	NO.	DATE:
1			3	
2			4	

DOCUMENT NOT CONSIDERED FINAL UNLESS ALL SIGNATURES COMPLETED

DRAWN BY: J. K. BOWLES DATE: 1/29/16
 CHECKED BY: N. D'AIUTO DATE: 3/17/16
 DESIGN ENGINEER OF RECORD: H. A. LOCKLEAR DATE: 3/17/16