

TIP PROJECT: B-4964

CONTRACT: C203945

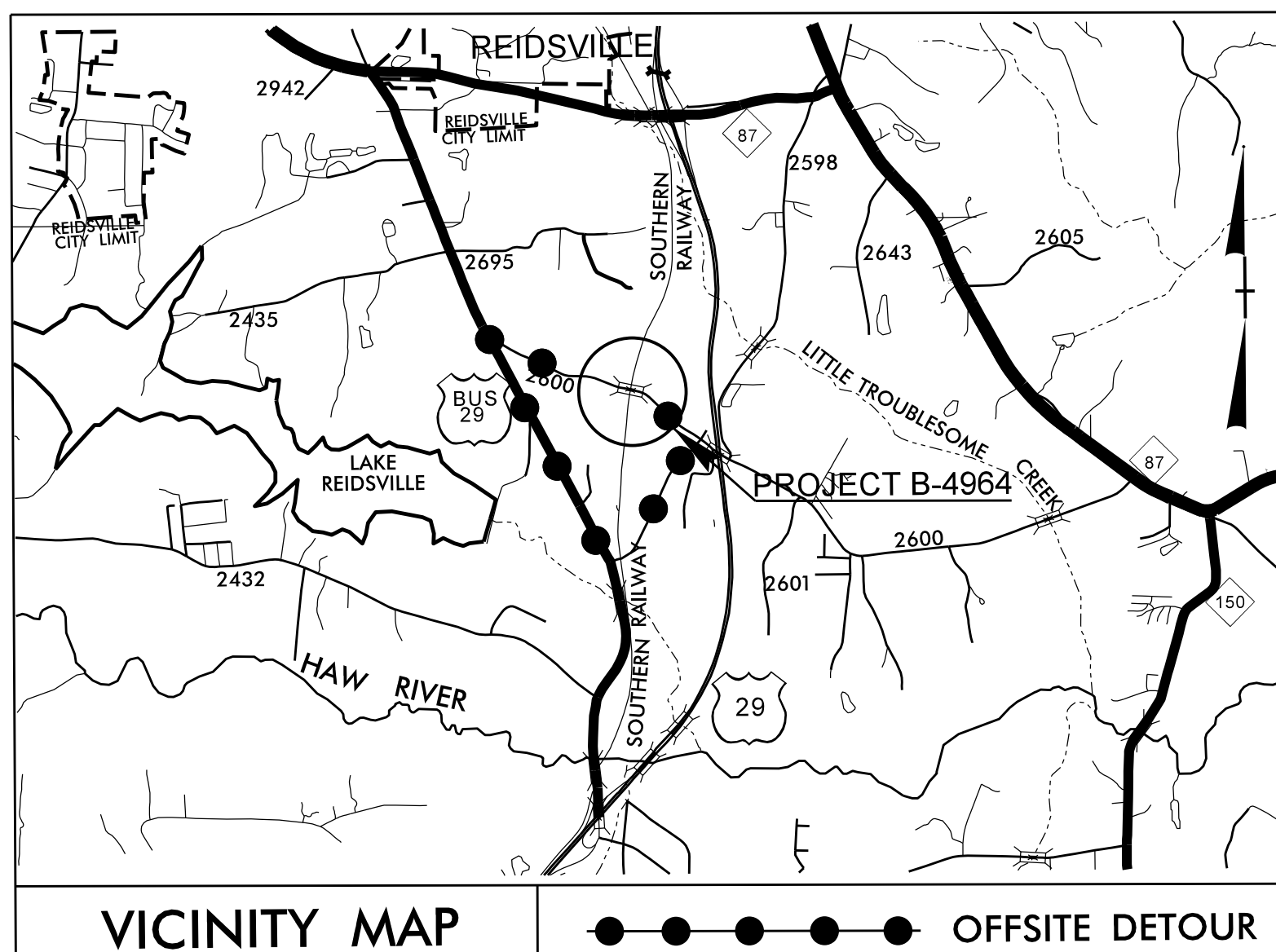

STATE OF NORTH CAROLINA
DIVISION OF HIGHWAYS

ROCKINGHAM COUNTY

**LOCATION: BRIDGE NO. 85 OVER NORFOLK SOUTHERN RAILROAD
ON SR 2600 (MIZPAH CHURCH ROAD)**

TYPE OF WORK: GRADING, PAVING, DRAINAGE, RETAINING WALLS AND STRUCTURE

STATE	STATE PROJECT REFERENCE NO.	SHEET NO.	TOTAL SHEETS
N.C.	B-4964	1	
STATE PROJ. NO.	F.A. PROJ. NO.	DESCRIPTION	
40242.1.1	BRSTP-2600(1)	PE	
40242.2.1	BRSTP-2600(1)	R/W	
40242.3.1	BRSTP-2600(1)	CONST.	

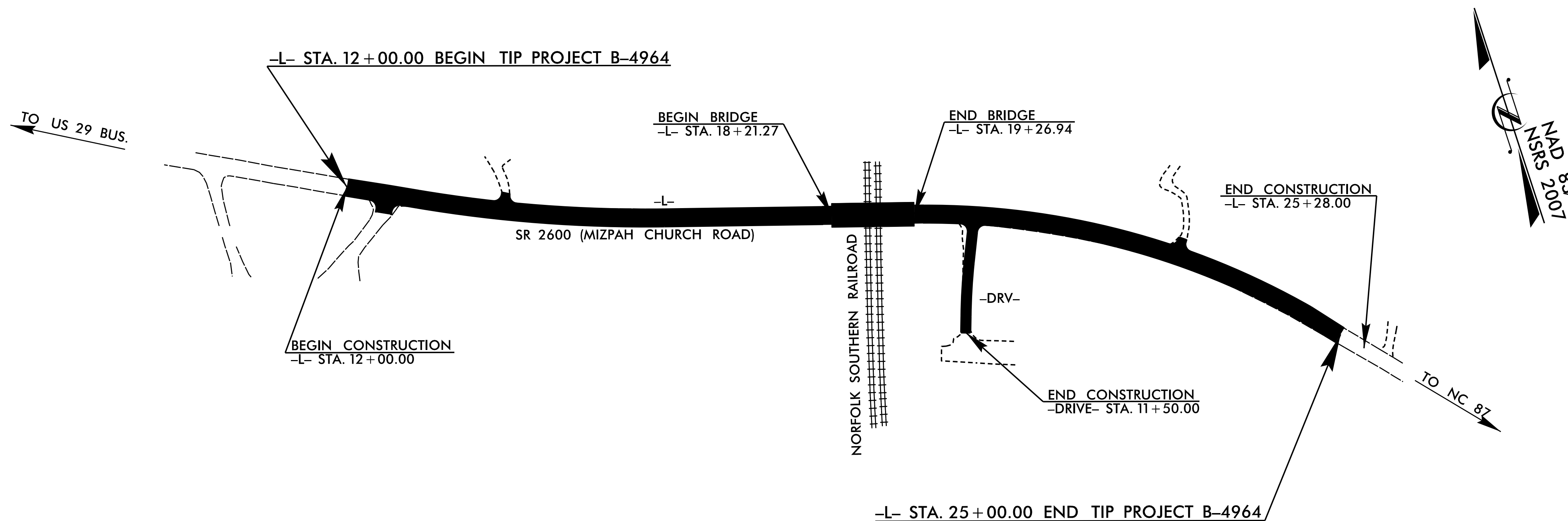

STRUCTURE

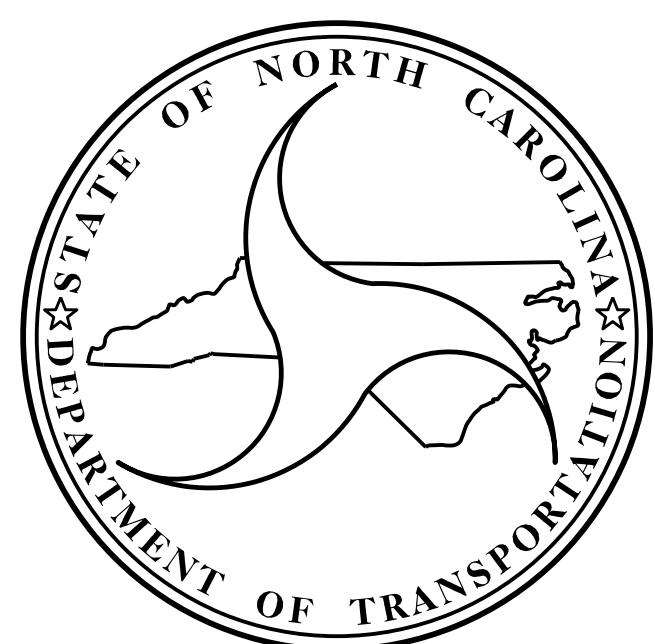

DESIGN DATA
 ADT 2017 = 1300
 ADT 2037 = 1525
 K = 10 %
 D = 55 %
 T = 4 % *
 V = 50 MPH
 * (TTST 1% + DUAL 3%)
 FUNC. CLASS=RURAL LOCAL
 "SUBREGIONAL TIER"

PROJECT LENGTH
 LENGTH ROADWAY TIP PROJECT B-4964 = 0.226 MILES
 LENGTH STRUCTURE TIP PROJECT B-4964 = 0.020 MILES
 TOTAL LENGTH OF TIP PROJECT B-4964 = 0.246 MILES

Prepared In the Office of:
DIVISION OF HIGHWAYS
 STRUCTURES MANAGEMENT UNIT
 1000 BIRCH RIDGE DR.
 RALEIGH, N.C. 27610

2012 STANDARD SPECIFICATIONS

LETTING DATE :

August 15, 2017