

# B-4964 SURVEY CONTROL SHEET

PROJECT REFERENCE NO.	SHEET NO.
B-4964	1C-1
Location and Surveys	

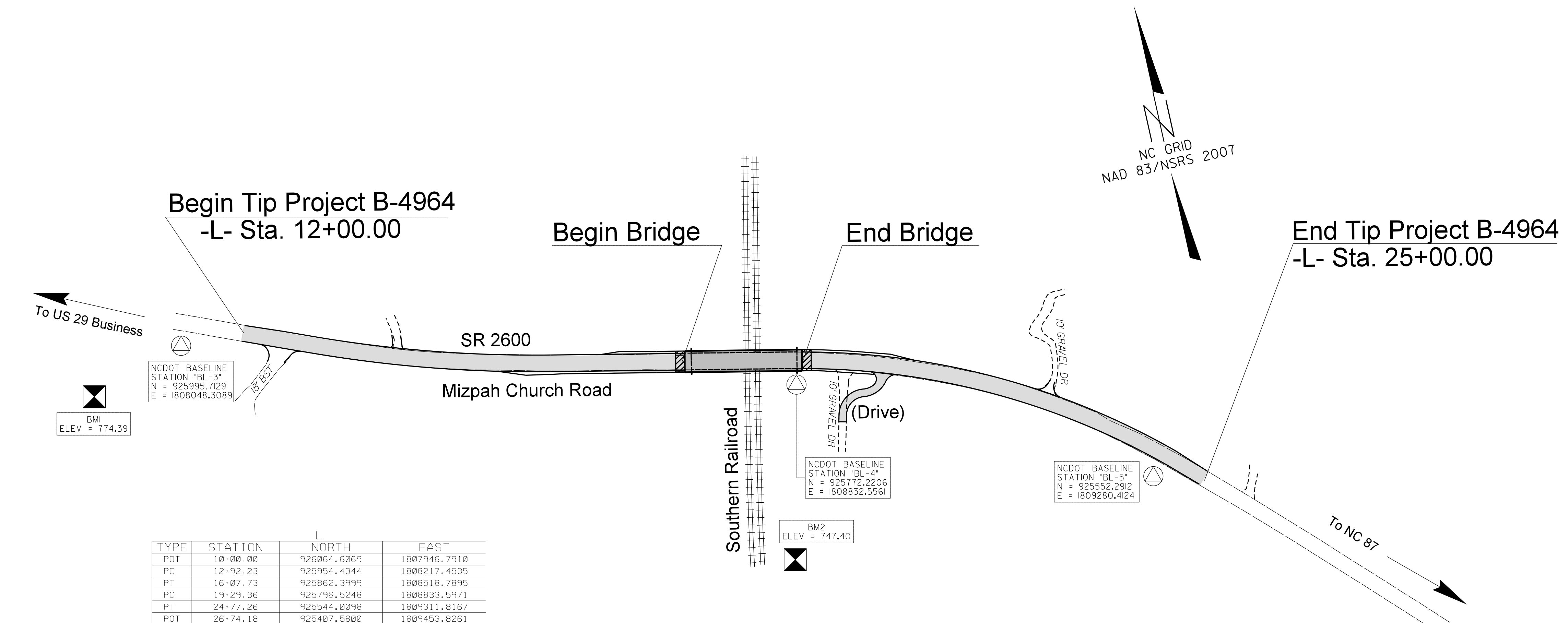

TYPE	STATION	NORTH	EAST
POT	10+00.00	926064.6069	1807946.7910
PC	12+92.23	925954.4344	1808217.4535
PT	16+07.73	925862.3999	1808518.7895
PC	19+29.36	925796.5248	1808833.5971
PT	24+77.26	925544.0098	1809311.8167
POT	26+74.18	925407.5800	1809453.8261

ALIGN	STATION	OFFSET	NORTH	EAST
L	19+65.92	-40.00	925827.1901	1808878.8814
L	21+75.00	-40.00	925752.6581	1809082.8982
L	21+75.00	-30.00	925743.6840	1809078.4862
L	19+66.26	-30.00	925817.3998	1808876.8134
L	19+68.48	30.00	925758.6552	1808864.4047
L	17+67.38	-30.00	925859.0643	1808681.2010
L	17+67.27	30.00	925800.3595	1808668.8008

ALIGN	STATION	OFFSET	NORTH	EAST
L	23+32.00	-30.00	925660.99369	1809217.36594
L	23+79.00	-59.00	925654.84442	1809274.07932
L	23+79.00	-49.00	925646.97586	1809267.90796
L	23+89.00	-59.00	925648.25907	1809282.38808
L	23+89.00	-49.00	925640.45389	1809276.13674
L	25+16.00	30.00	925495.53585	1809318.97047
L	25+18.00	50.00	925479.72762	1809306.55677
L	25+20.00	-30.00	925536.03255	1809363.42288
L	25+20.00	-36.00	925540.35934	1809367.57967
L	25+26.00	30.00	925488.60787	1809326.18178
L	25+28.00	50.00	925472.79964	1809313.76808

ALIGN	STATION	OFFSET	NORTH	EAST
L	12+00.00	30.00	925961.41842	1808120.72239
L	13+29.00	48.00	925896.10068	1808234.49843
L	13+29.00	56.00	925888.62927	1808231.63870
L	13+41.00	57.00	925883.30574	1808242.86847
L	13+41.00	49.00	925890.79658	1808245.67690
L	15+75.00	50.00	925820.66312	1808475.66280
L	17+67.24	53.00	925777.85204	1808664.06649
L	19+69.47	54.00	925735.15008	1808859.46426
L	22+00.00	30.00	925678.87088	1809073.62389

ALIGN	STATION	OFFSET	NORTH	EAST
L	17+45.00	-30.00	925863.6486	1808659.2932
L	17+45.00	-50.00	925883.2246	1808663.3896
L	17+67.42	-50.00	925878.6325	1808685.3343

### BASELINE DATA

BL	POINT	DESC.	NORTH	EAST	ELEVATION	L STATION	OFFSET
3	BL-3		925995.7129	1808048.3089	767.50	11+20.00	25.54 RT
4	BL-4		925772.2206	1808832.5561	758.56	19+33.42	23.99 RT
5	BL-5		925552.2912	1809280.4124	762.60	24+48.42	15.37 RT
6	BL-6		925154.5263	1809685.7921	764.01		OUTSIDE PROJECT LIMITS
1	B4964-1		924780.8910	1810184.4560	769.79		OUTSIDE PROJECT LIMITS
2	B4964-2		924294.9950	1810815.5150	767.35		OUTSIDE PROJECT LIMITS

### NOTES

- THE CONTROL DATA FOR THIS PROJECT CAN BE FOUND ELECTRONICALLY BY SELECTING PROJECT CONTROL DATA AT:  
[HTTP://WWW.DOH.DOT.STATE.NC.US/PRECONSTRUCT/HIGHWAY/LOCATION/PROJECT/](http://www.doh.dot.state.nc.us/preconstruct/highway/location/project/)  
 THE FILES TO BE FOUND ARE AS FOLLOWS:  
*b4964\_ls\_control.txt*  
 SITE CALIBRATION INFORMATION HAS NOT BEEN PROVIDED FOR THIS PROJECT. IF FURTHER INFORMATION IS NEEDED, PLEASE CONTACT THE LOCATION AND SURVEYS UNIT.
- ⊙ INDICATES GEODETIC CONTROL MONUMENTS USED OR SET FOR HORIZONTAL PROJECT CONTROL BY THE NCDOT LOCATION AND SURVEYS UNIT.  
 PROJECT CONTROL ESTABLISHED USING GLOBAL POSITIONING SYSTEM.

### DATUM DESCRIPTION

THE LOCALIZED COORDINATE SYSTEM DEVELOPED FOR THIS PROJECT IS BASED ON THE STATE PLANE COORDINATES ESTABLISHED BY NCDOT FOR MONUMENT "B4964-1" WITH NAD 83/NSRS 2007 STATE PLANE GRID COORDINATES OF NORTHING: 924780.8910(±ft) EASTING: 1810184.4560(±ft) ELEVATION: 769.79'(±ft)

THE AVERAGE COMBINED GRID FACTOR USED ON THIS PROJECT (GROUND TO GRID) IS: 1.0000046770

THE N.C. LAMBERT GRID BEARING AND LOCALIZED HORIZONTAL GROUND DISTANCE FROM "B4964-1" TO -L- STATION 12+00.00 IS  
 S 59°30'49" E 2,381.69'

ALL LINEAR DIMENSIONS ARE LOCALIZED HORIZONTAL DISTANCES  
 VERTICAL DATUM USED IS NAVD 88

### BENCHMARK DATA

.....  
 BM1 ELEVATION = 774.39  
 N 925950 E 1807921  
 L STATION 10+19.00 116 RIGHT  
 RR SPIKE IN ROOT OF 12" PINE  
 .....  
 BM2 ELEVATION = 747.40  
 N 925539 E 1808778  
 L STATION 19+28.00 263 RIGHT  
 RR SPIKE IN ROOT OF 18" OAK  
 .....