

PROJECT REFERENCE NO.	SHEET NO.
B-5327	EC-3/CONST.4
RW SHEET NO.	
ROADWAY DESIGN ENGINEER	HYDRAULICS ENGINEER

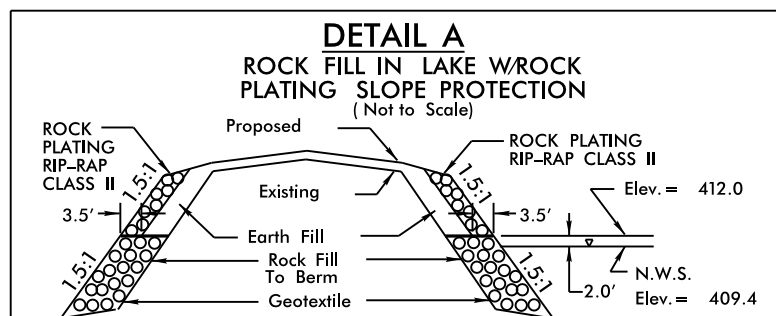

FROM STA. 11+75 TO STA. 12+65 LT AND FROM STA. 14+54 TO STA. 16+25 LT
 FROM STA. 11+75 TO STA. 12+65 RT AND FROM STA. 14+54 TO STA. 16+25 RT

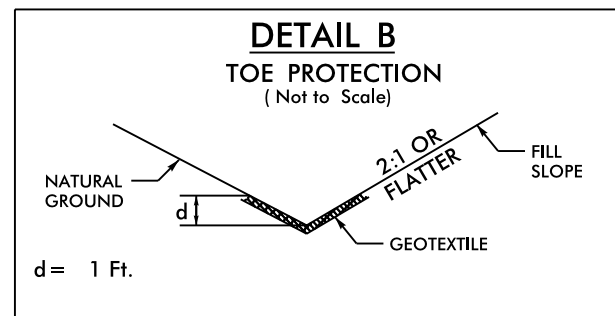

Type of Liner = CLASS I RIP-RAP
 FROM STA. 16+25 TO STA. 17+00 RT.
 FROM STA. 16+25 TO STA. 17+00 LT.

CLEARING AND GRUBBING
 EROSION CONTROL FOR
 CONSTRUCTION SHEET 4

NOTE:
 PLACE TEMPORARY ROCK SEDIMENT DAMS TYPE - B
 AND TEMPORARY ROCK SILT CHECKS TYPE - A AT
 DRAINAGE OUTLETS.

NOTE:
 UTILIZE SPECIAL STILLING BASIN(S)
 AS STILLING BASIN WHERE APPLICABLE.

MAD 83 NSRS 2007

BEGIN TIP PROJECT B-5327
-L- POT STA 10+00.00

END TIP PROJECT B-5327
-L- POT STA 17+87.50

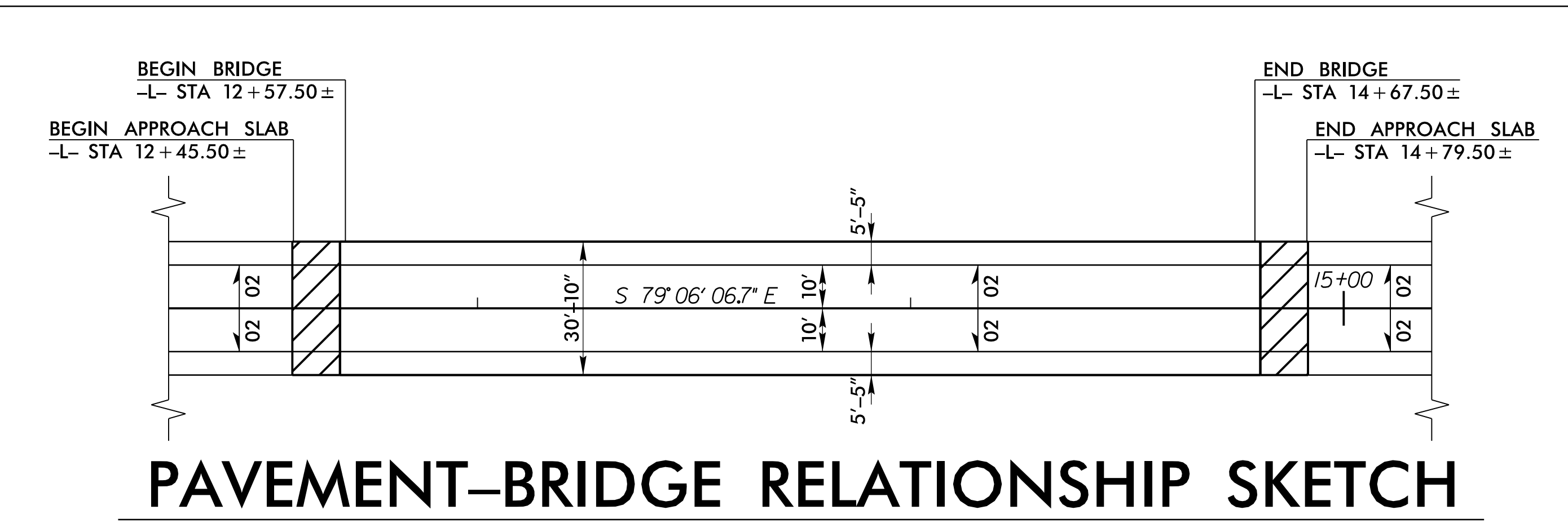
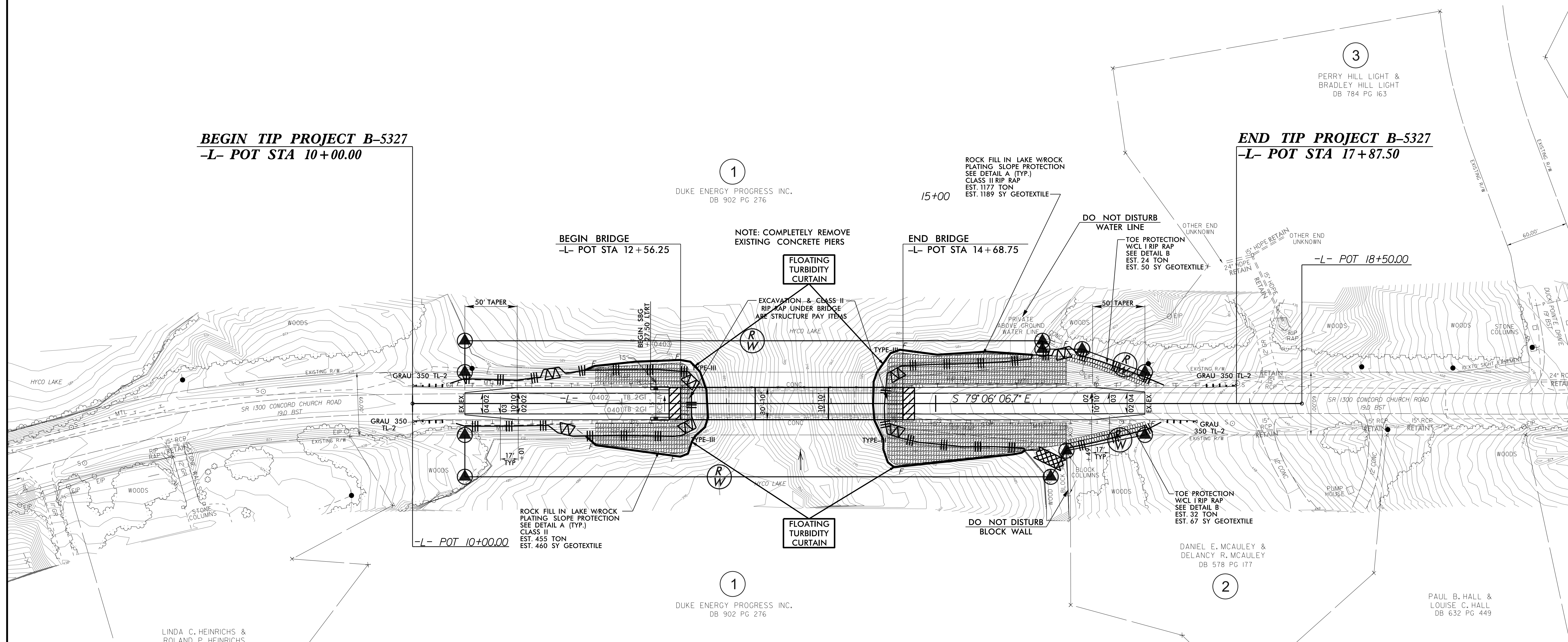

PAVEMENT-BRIDGE RELATIONSHIP SKETCH

FOR -L- PROFILE, SEE SHEET 5

8/17/99
 06-APR-2017 11:50
 C:\Users\jcm\Documents\Projects\B-5327-EC.psh04.dgn