

5/14/19

-Y6RPB-
 PIs Sta 11+44.04 PI Sta 15+11.86 PIs Sta 18+71.55
 $\Theta_s = 4' 19' 12.0''$ $\Delta = 23' 20' 26.2''$ (LT) $\Theta_s = 4' 19' 12.0''$
 $L_s = 216.00'$ $D = 4' 00' 00.0''$ $L_s = 216.00'$
 $LT = 144.04'$ $L = 583.52'$ $LT = 144.04'$
 $ST = 72.04'$ $T = 295.86'$ $ST = 72.04'$
 $R = 1,432.39'$

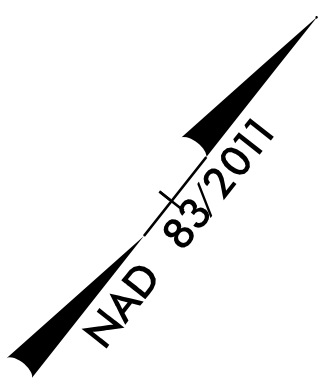
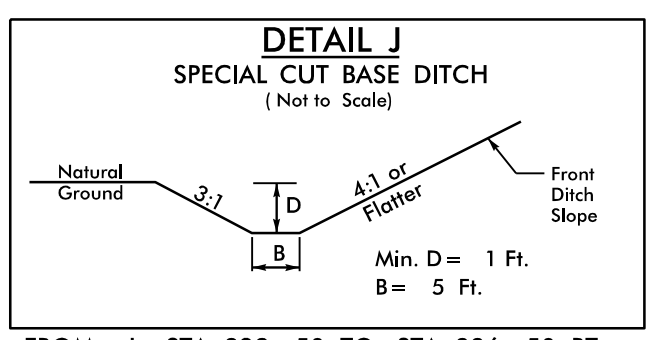
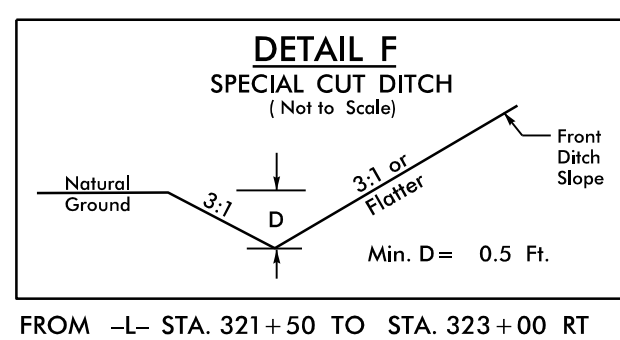

WETHERILL ENGINEERING
 1223 Jones Franklin Rd.
 Raleigh, N.C. 27606
 License No. F-0377
 Bus: 919 851 8077
 Fax: 919 851 8107

TRANSPORTATION PLANNING/DESIGN - BRIDGE/STRUCTURE DESIGN
 CIVIL/SITE DESIGN - GIS/GPS - CONSTRUCTION OBSERVATION

PROJECT REFERENCE NO. 1-5786	SHEET NO. 28
RW SHEET NO.	
ROADWAY DESIGN ENGINEER 6/6/2017 SEAL 21116 ENGINEER BOB A. MARY	HYDRAULICS ENGINEER 6/6/2017 SEAL 31977 ENGINEER KEVIN B. ALFORD
<p>Bob A. Mary</p> <p>KEVIN B. ALFORD</p> <p>DOCUMENT NOT CONSIDERED FINAL UNLESS ALL SIGNATURES COMPLETED</p>	

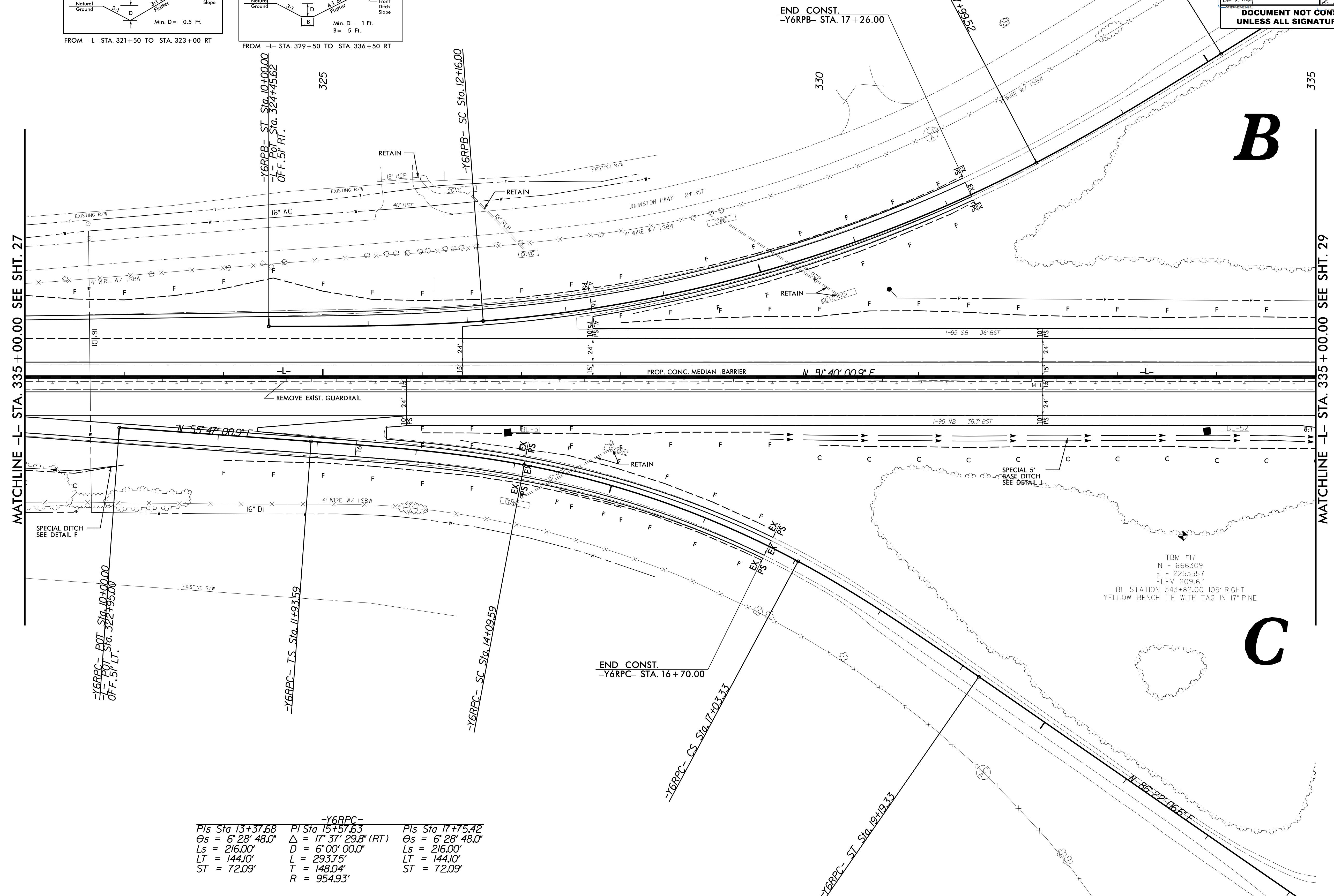

MATCHLINE -L- STA. 335+00.00 SEE SHT. 27

MATCHLINE -L- STA. 335+00.00 SEE SHT. 29

-Y6RPC- POL Sta. 10+00.00
-L- POL Sta. 322+95.00
OFF-F. 51' LT.

-Y6RPC- IS Sta. 11+93.59

-Y6RPC- SC Sta. 14+09.59

-Y6RPC- CS Sta. 17+20.33

-Y6RPC- ST Sta. 19+19.33

-Y6RPC-
 PIs Sta 13+37.68 PI Sta 15+57.63 PIs Sta 17+75.42
 $\Theta_s = 6' 28' 48.0''$ $\Delta = 17' 37' 29.8''$ (RT) $\Theta_s = 6' 28' 48.0''$
 $L_s = 216.00'$ $D = 6' 00' 00.0''$ $L_s = 216.00'$
 $LT = 144.10'$ $L = 293.75'$ $LT = 144.10'$
 $ST = 72.09'$ $T = 148.04'$ $ST = 72.09'$
 $R = 954.93'$

TBM #17
 N - 666309
 E - 2253557
 ELEV 209.61'
 BL STATION 343+82.00 105' RIGHT
 YELLOW BENCH TIE WITH TAG IN 17' PINE

6/5/2017 1-5786-Rdy_psh28.dgn
 11:58:11 PM