

5/14/19

-L-  
 PI Sta 129+61.61  
 $\Delta = 3^{\circ}15'55.5" (RT)$   
 $D = 0^{\circ}30'00.0"$   
 $L = 653.08'$   
 $T = 326.63'$   
 $R = 11,459.16'$

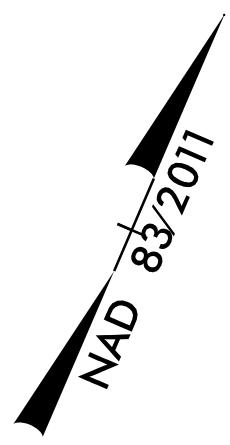

**WETHERILL ENGINEERING**  
 1223 Jones Franklin Rd.  
 Raleigh, N.C. 27606  
 License No. F-0377  
 Bus: 919 851 8077  
 Fax: 919 851 8107

TRANSPORTATION PLANNING/DESIGN - BRIDGE/STRUCTURE DESIGN  
 CIVIL/SITE DESIGN - GIS/GPS - CONSTRUCTION OBSERVATION

PROJECT REFERENCE NO. <b>1-5786</b>	SHEET NO. <b>13</b>
RW SHEET NO.	
ROADWAY DESIGN ENGINEER 6/6/2017 SEAL 21116 ENGINEER BOB B. REAY	HYDRAULICS ENGINEER 6/6/2017 SEAL 31977 ENGINEER KEVIN B. ALFORD
DOCUMENT NOT CONSIDERED FINAL UNLESS ALL SIGNATURES COMPLETED	

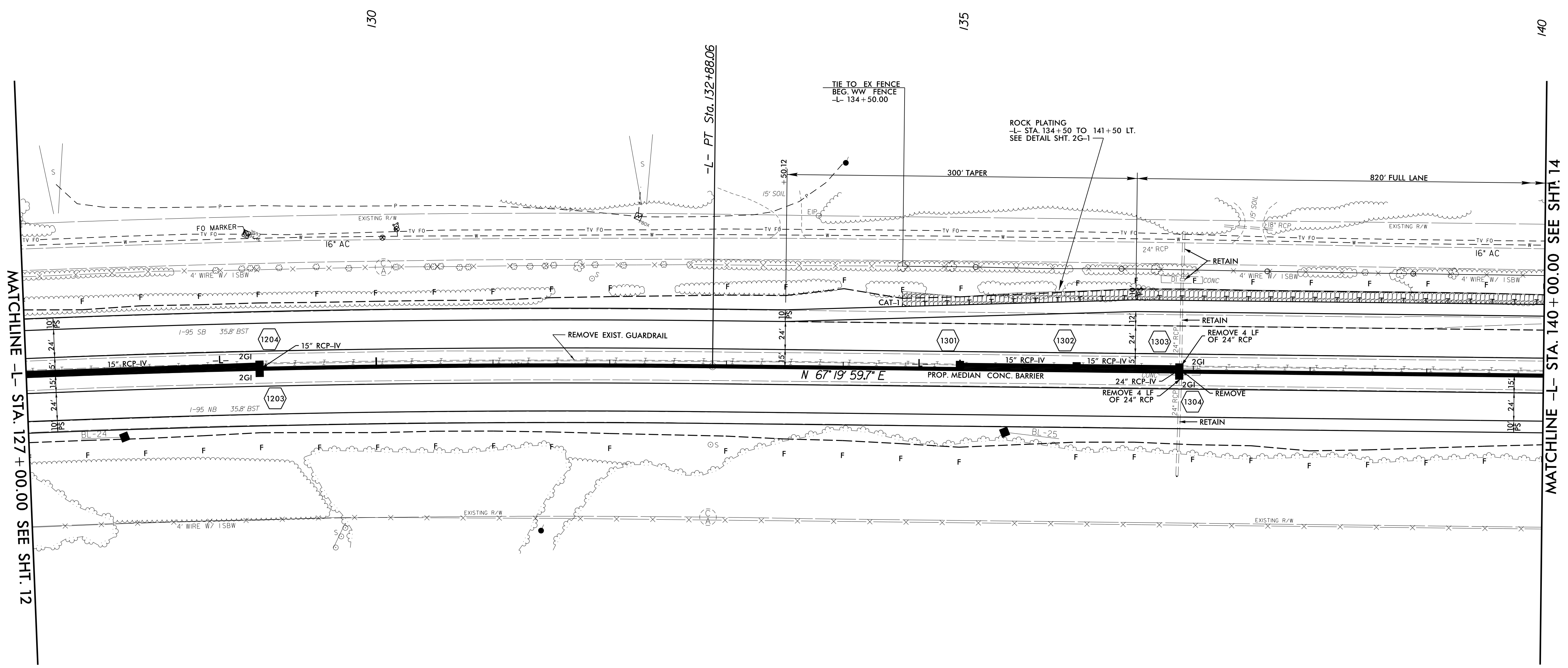

TBM #7  
 N - 657192  
 E - 2235442  
 ELEV 193.16'  
 BL STATION 126+69.00 215' RIGHT  
 60d NAIL IN POWER POLE

6/5/2017 1-5786\_Rd4\_esh13.dgn