

06-JUN-2017 12:29 S:\Contracts\Projects\Special Details\Joverton\854d02 and 854d05 Special Type T Concrete Barrier.dgn Joverton AT\_CSD-292595

STATE OF NORTH CAROLINA DEPT. OF TRANSPORTATION DIVISION OF HIGHWAYS RALEIGH, N.C.

ROADWAY DETAIL DRAWING FOR CONCRETE MEDIAN TRANSITION BARRIER SPECIAL TYPE T

SHEET 4 OF 4 **854D05**

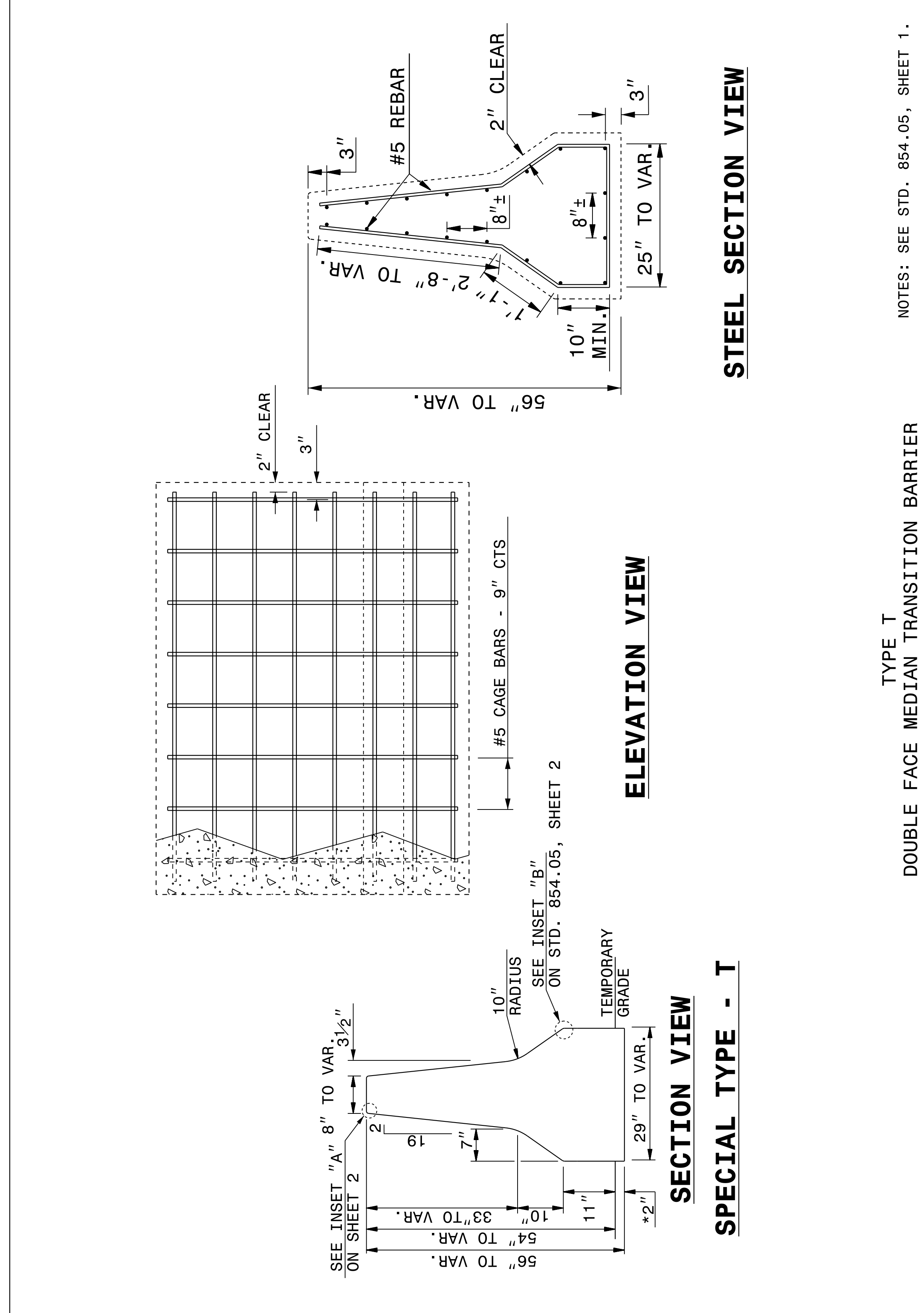

STATE OF NORTH CAROLINA DEPT. OF TRANSPORTATION DIVISION OF HIGHWAYS RALEIGH, N.C.

ROADWAY DETAIL DRAWING FOR CONCRETE MEDIAN TRANSITION BARRIER SPECIAL TYPE T

SHEET 4 OF 4 **854D05**

STATE OF NORTH CAROLINA DEPT. OF TRANSPORTATION DIVISION OF HIGHWAYS RALEIGH, N.C.

ROADWAY DETAIL DRAWING FOR DOUBLE FACED CONCRETE BARRIER SPECIAL TYPE T

SHEET 1 OF 4 **854D02**

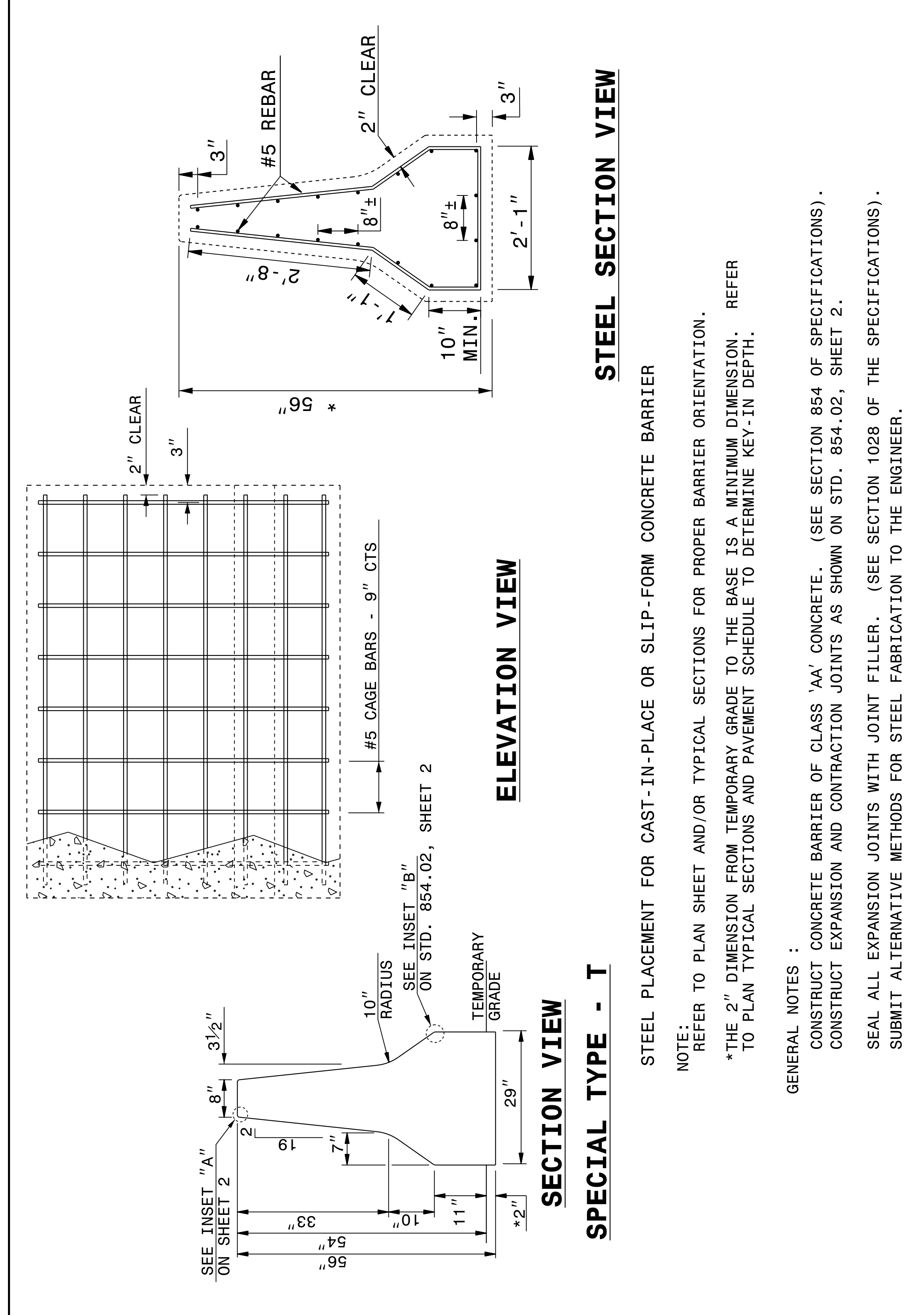

STATE OF NORTH CAROLINA DEPT. OF TRANSPORTATION DIVISION OF HIGHWAYS RALEIGH, N.C.

ROADWAY DETAIL DRAWING FOR DOUBLE FACED CONCRETE BARRIER SPECIAL TYPE T

SHEET 1 OF 4 **854D02**

STEEL PLACEMENT FOR CAST-IN-PLACE OR SLIP-FORM CONCRETE BARRIER

NOTE: REFER TO PLAN SHEET AND/OR TYPICAL SECTIONS FOR PROPER BARRIER ORIENTATION.

\*THE 2" DIMENSION FROM TEMPORARY GRADE TO THE BASE IS A MINIMUM DIMENSION. REFER TO PLAN TYPICAL SECTIONS AND PAVEMENT SCHEDULE TO DETERMINE KEY-IN DEPTH.

GENERAL NOTES :

CONSTRUCT CONCRETE BARRIER OF CLASS 'AA' CONCRETE. (SEE SECTION 854 OF SPECIFICATIONS).

CONSTRUCT EXPANSION AND CONTRACTION JOINTS AS SHOWN ON STD. 854.02, SHEET 2.

SEAL ALL EXPANSION JOINTS WITH JOINT FILLER. (SEE SECTION 1028 OF THE SPECIFICATIONS).

SUBMIT ALTERNATIVE METHODS FOR STEEL FABRICATION TO THE ENGINEER.



DOCUMENT NOT CONSIDERED FINAL UNLESS ALL SIGNATURES COMPLETED

**CONTRACT STANDARDS AND DEVELOPMENT UNIT**  
Office 919-707-6950 FAX 919-250-4119

**SEE PLATE FOR TITLE**

ORIGINAL BY: K. KEMPF DATE: 03-03-2015  
 MODIFIED BY: DATE:  
 CHECKED BY: DATE:  
 FILE SPEC.: kkempfvenglish\85121-85317\_840d35\_54\_TB261.dgn