

PROJECT REFERENCE NO. U-5796		SHEET NO. 14
RAW SHEET NO. 14		
ROADWAY DESIGN ENGINEER 4/6/2017 SEAL 18537 JERRY P. FAGI	HYDRAULICS ENGINEER 4/7/2017 SEAL 18462 JAMES C. DAVIS	

DOCUMENT NOT CONSIDERED FINAL UNLESS ALL SIGNATURES COMPLETED

-RAMPA-
PI = 12+44.09
EL = 189.31'

-RAMPA-
PI = 12+00.00
EL = 188.61'
VC = 85.00'
K = 48

-RAMPA-
PI = 12+66.87
EL = 189.67'
END GRADE

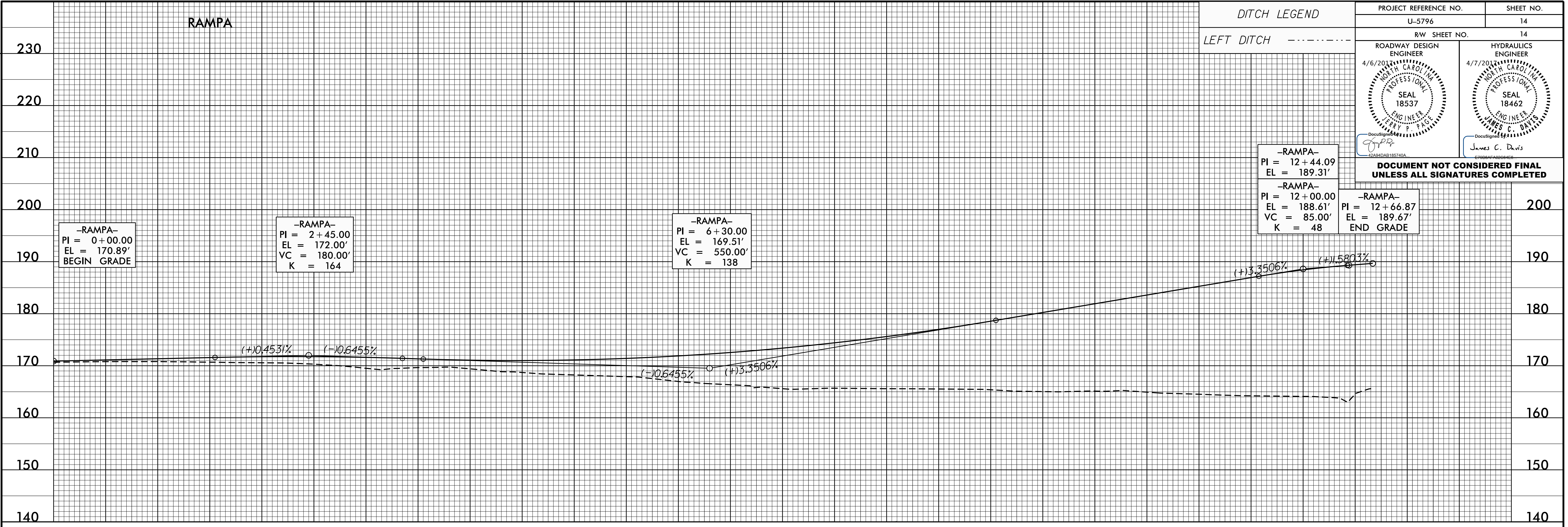

REVISIONS

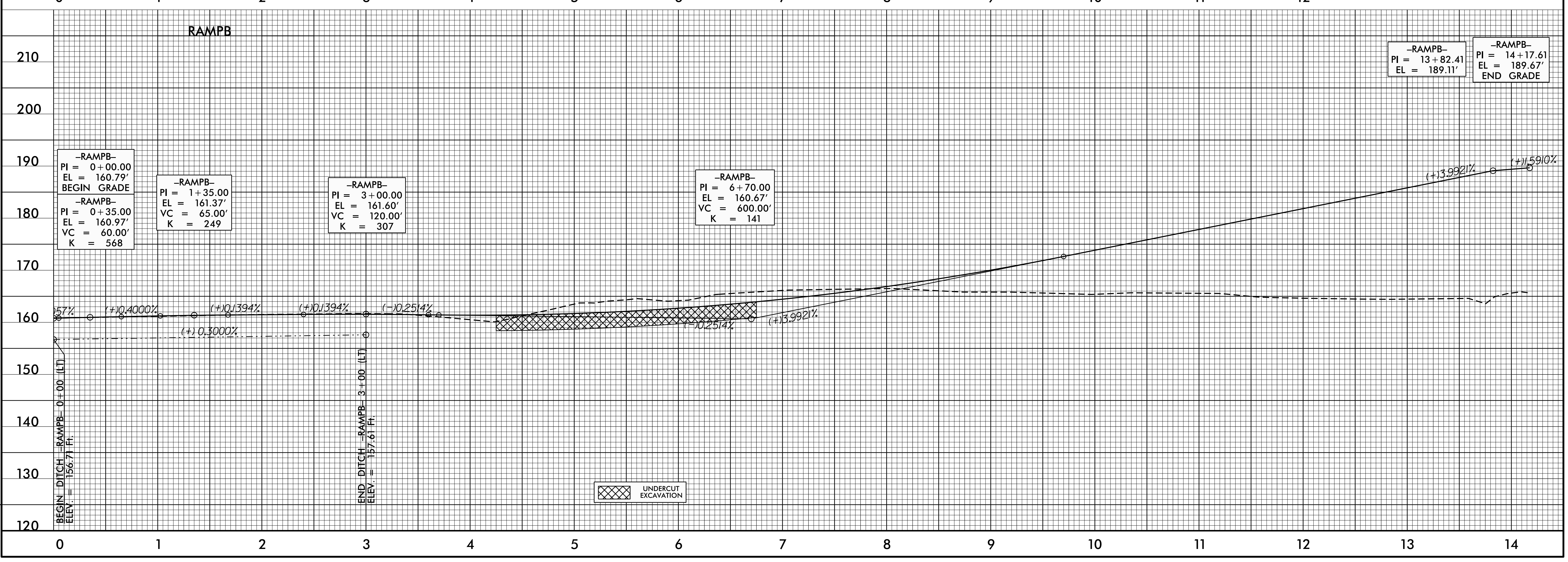

UNDERCUT EXCAVATION

06-APR-2017 14:49
R:\PROJECTS\14-49
U-5796_ditch4_PSH_pro.dgn
\$\$\$\$\$USER\$\$\$\$\$