

PROJECT REFERENCE NO. U-5796		SHEET NO. 05
RW SHEET NO. 05		
ROADWAY DESIGN ENGINEER 4/6/2017 SEAL 18537 JERRY P. FAGG	HYDRAULICS ENGINEER 4/7/2017 SEAL 18462 JAMES C. DAVIS	

NOTE:  
SEE SHEET 10 FOR -L- LT PROFILE  
SEE SHEET 11 FOR -L- RT PROFILE  
SEE SHEET 14 FOR RAMP B PROFILE  
SEE SHEET 15 FOR RAMP C PROFILE

NAD 83/NSRS 2007

**RAMPB**

PIs Sta 1+33.35 θs = 2° 51' 53.2" Ls = 200.00' LT = 133.35' ST = 66.68'	PI Sta 4+48.58 Δ = 14° 10' 12.2" (LT) D = 2° 51' 53.2" L = 4946.3' T = 248.58' R = 2,000.00'	PIs Sta 7+61.31 θs = 2° 51' 53.2" Ls = 200.00' LT = 133.35' ST = 66.68'
---	---	---

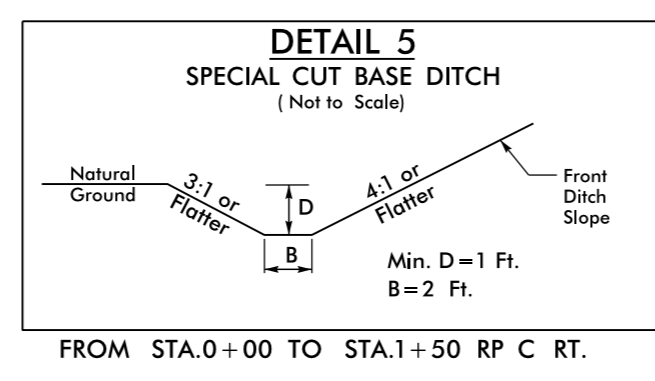
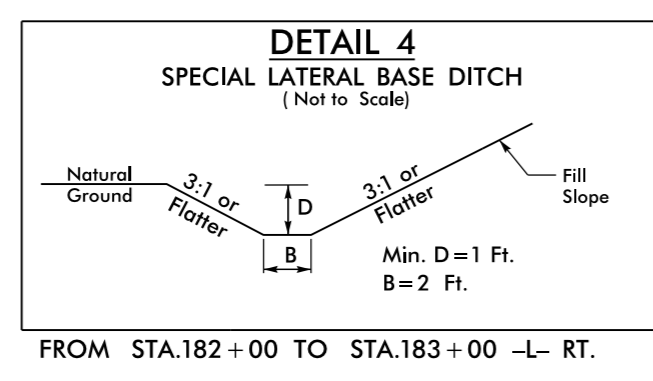
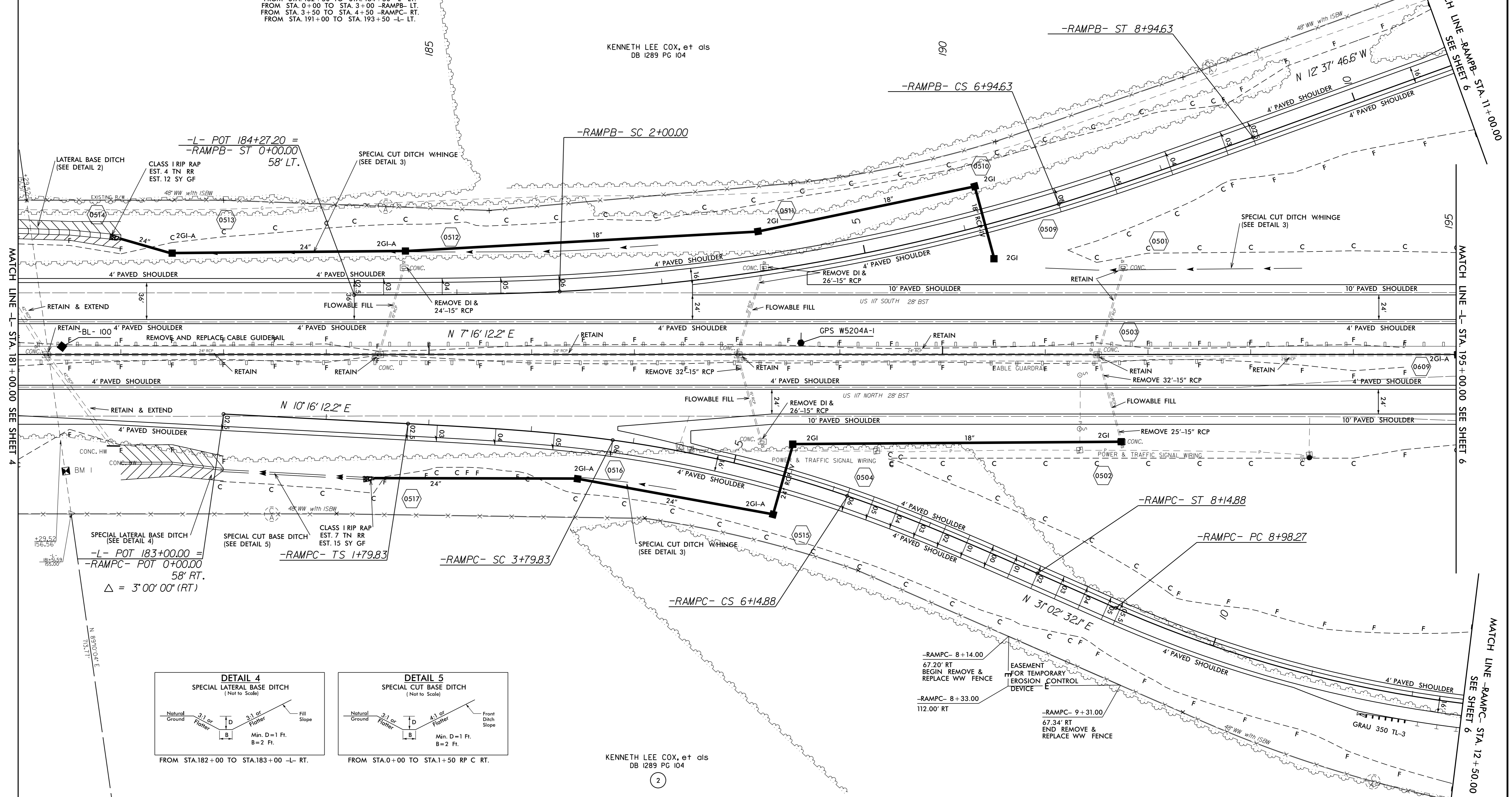
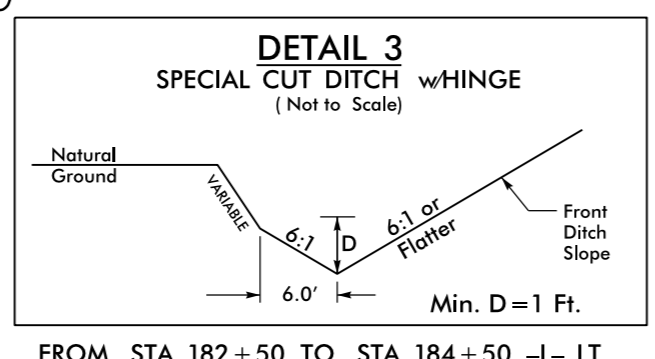
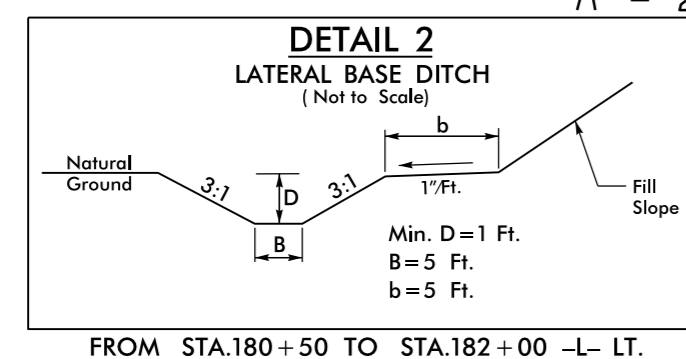

**RAMPC**

PIs Sta 3+13.21 θs = 4° 46' 28.7" Ls = 200.00' LT = 133.38' ST = 66.71'	PI Sta 4+97.73 Δ = 11° 13' 22.5" (RT) D = 4° 46' 28.7" L = 235.05' T = 117.90' R = 1,200.00'	PIs Sta 6+81.59 θs = 4° 46' 28.7" Ls = 200.00' LT = 133.38' ST = 66.71'	PI Sta 12+24.63 Δ = 30° 25' 42.7" (LT) D = 4° 46' 28.7" L = 637.29' T = 326.35' R = 1,200.00'
---	---	---	--

KENNETH LEE COX, et als  
DB 1289 PG 104

REVISIONS

06-APR-2017 14:48  
S:\5796\5796\_ddec4\_pnh05.dgn  
S:\5796\5796.dwg