

PROJECT REFERENCE NO.	SHEET NO.
R-5719	EC-16/CONST.09
RW SHEET NO.	09
ROADWAY DESIGN ENGINEER	HYDRAULICS ENGINEER

8/17/99

REVISIONS

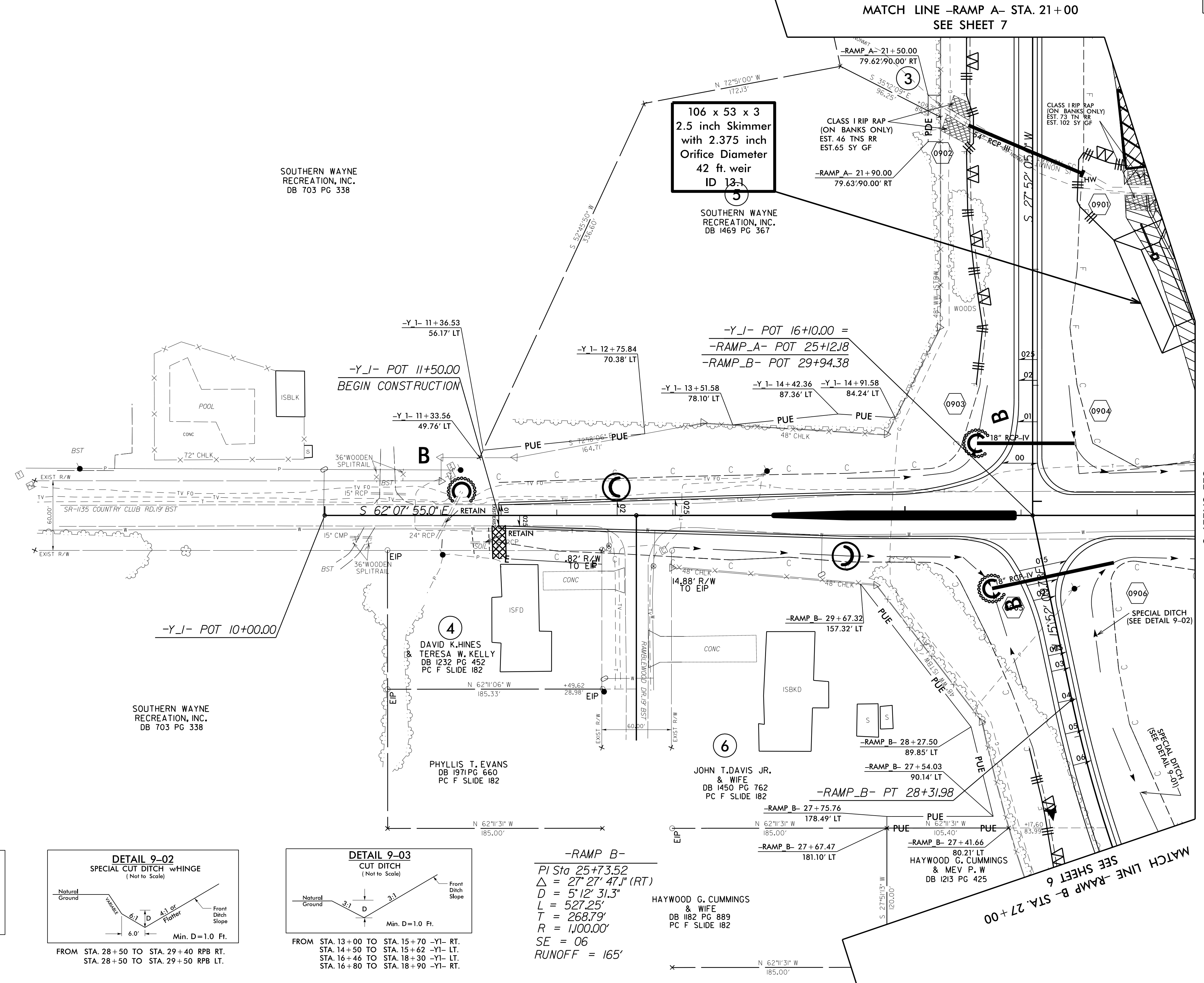
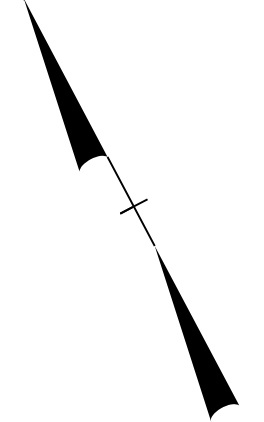

106 x 53 x 3
2.5 inch Skimmer
with 2.375 inch
Orifice Diameter
42 ft. weir
ID 13-1

-Y-1- POT 11+50.00
BEGIN CONSTRUCTION

-Y-1- POT 16+10.00 =
-RAMP_A- POT 25+12.18
-RAMP_B- POT 29+94.38

-Y-1- POT 10+00.00

-RAMP B-
PI Sta 25+73.52
 $\Delta = 27^{\circ} 27' 47.1''$ (RT)
 $D = 5' 12' 31.3''$
 $L = 527.25'$
 $T = 268.79'$
 $R = 1,100.00'$
SE = 06
RUNOFF = 165'

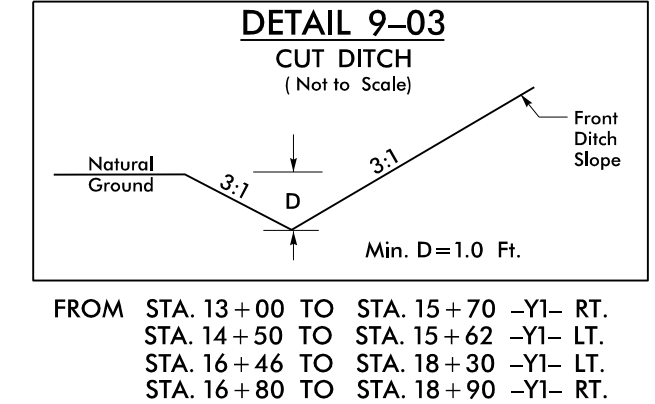
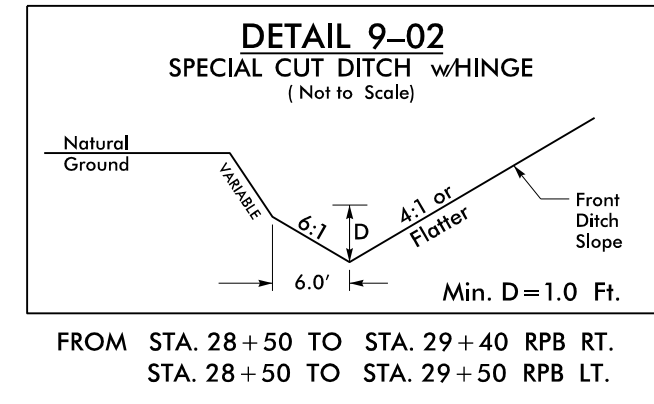
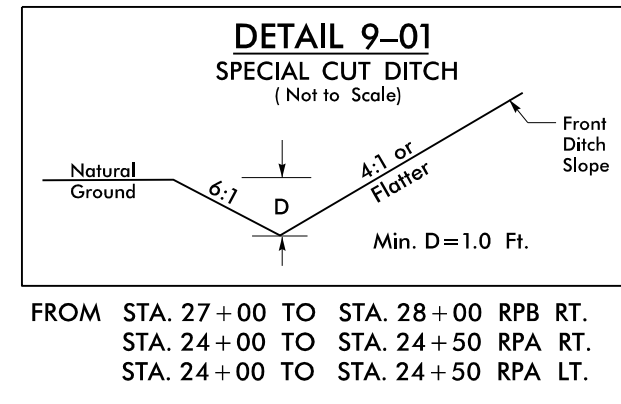

8/17/2017 8:04:43 AM
P:\2015\16-5719\Location_Central\PlanSheets\165719_EC_PSH16.dwg