

5/28/99

DITCH LEGEND LEFT DITCH - - - - - MEDIAN DITCH - - - - - RIGHT DITCH - - - - -	PROJECT REFERENCE NO. R-5719	SHEET NO. 13
	ROADWAY DESIGN ENGINEER 4/6/2007 SEAL 18537 JERRY P. FIG	HYDRAULICS ENGINEER 4/7/2007 SEAL 18462 JAMES C. DAVIS

-L- PI = 67+00.00 EL = 137.06' VC = 50.00' K = 385	-L- PI = 68+00.00 EL = 138.07' END GRADE
--	---



DITCH LEGEND LEFT DITCH - - - - - MEDIAN DITCH - - - - - RIGHT DITCH - - - - -	PROJECT REFERENCE NO. R-5719	SHEET NO. 13
	ROADWAY DESIGN ENGINEER 4/6/2007 SEAL 18537 JERRY P. FIG	HYDRAULICS ENGINEER 4/7/2007 SEAL 18462 JAMES C. DAVIS
	DOCUMENT NOT CONSIDERED FINAL UNLESS ALL SIGNATURES COMPLETED	

-L- PI = 10+00.00 EL = 151.61' BEGIN GRADE	-L- PI = 11+00.00 EL = 151.43' VC = 120.00' K = 529
---	---

-L- PI = 14+00.00 EL = 150.21' VC = 20.00' K = 522
--

-L- PI = 18+00.00 EL = 148.43' VC = 30.00' K = 240
--

-L- PI = 20+00.00 EL = 147.79' VC = 40.00' K = 401
--

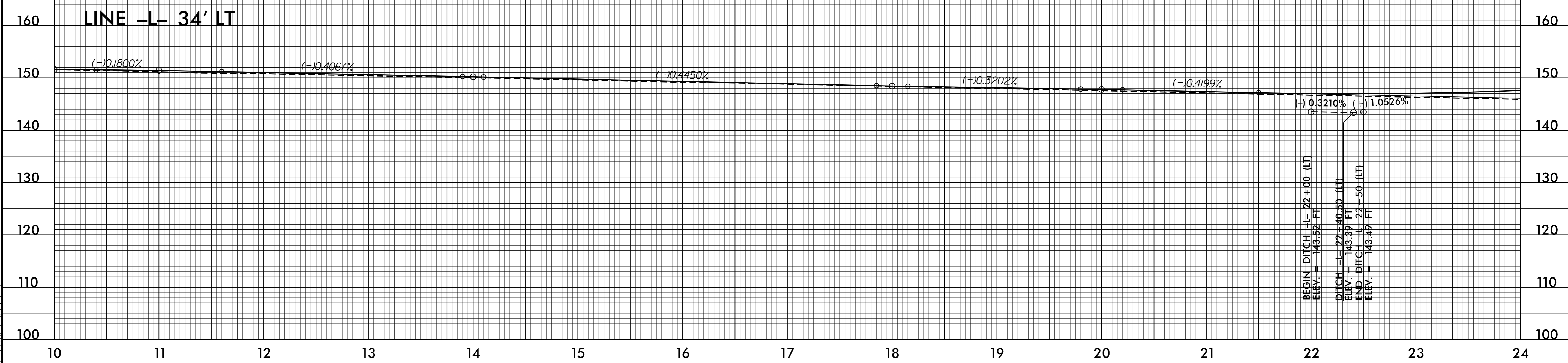

06-APR-2017 13:37  
R:\Roadway\PCo\R5719\_DDC4\_PSH\_PRO.dgn