

BM #1
110' RT OF -L- 17+37
EL = 150.06'

-L-
PI = 10+00.00
EL = 151.68'
BEGIN GRADE

-L-
PI = 11+00.00
EL = 151.46'
VC = 75.00'
K = 421

-L-
PI = 16+00.00
EL = 149.47'
VC = 40.00'
K = 488

-L-
PI = 17+00.00
EL = 148.99'
VC = 50.00'
K = 371

-L-
PI = 20+00.00
EL = 147.95'
VC = 40.00'
K = 660

| DITCH LEGEND | |
|--------------|-------|
| LEFT DITCH | ----- |
| MEDIAN DITCH | ----- |
| RIGHT DITCH | ----- |

| | |
|--|------------------------------------|
| PROJECT REFERENCE NO. R-5719 | SHEET NO. 11 |
| ROADWAY DESIGN ENGINEER 4/6/2017 | HYDRAULICS ENGINEER 4/7/2017 |
| | |
| SEAL 18537 JERRY P. FIG | SEAL 18462 JAMES C. DAVIS |

DOCUMENT NOT CONSIDERED FINAL
UNLESS ALL SIGNATURES COMPLETED

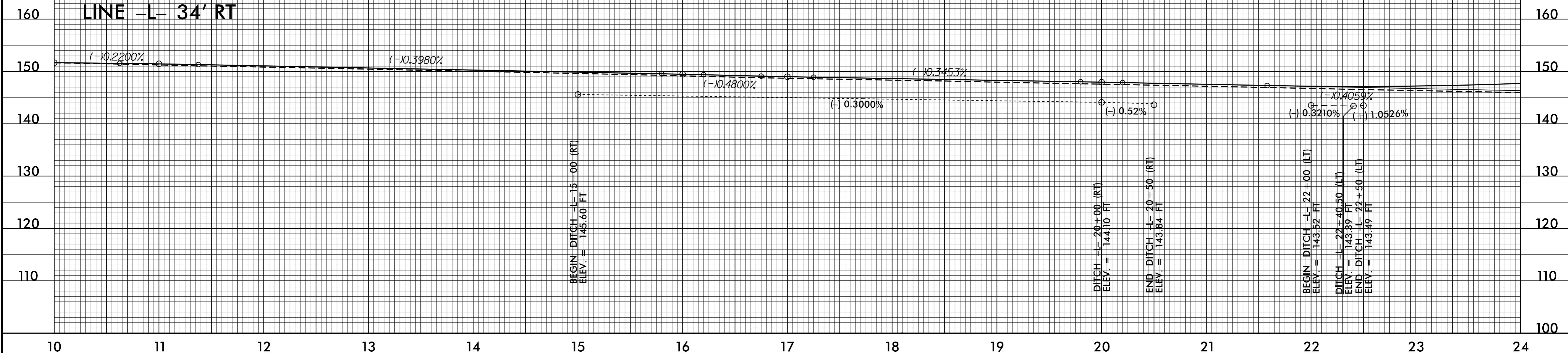

-L-
PI = 24+58.00
EL = 146.09'
VC = 600.00'
K = 211

-L-
PI = 33+00.00
EL = 166.60'
VC = 990.00'
K = 337

| DITCH LEGEND | |
|--------------|-------|
| LEFT DITCH | ----- |
| MEDIAN DITCH | ----- |
| RIGHT DITCH | ----- |

