

8/17/99

REVISIONS

06-APR-2017 14:57
R:\Roadway\PC\15719\DDC4_PSH-10.dgn
\$\$\$\$\$

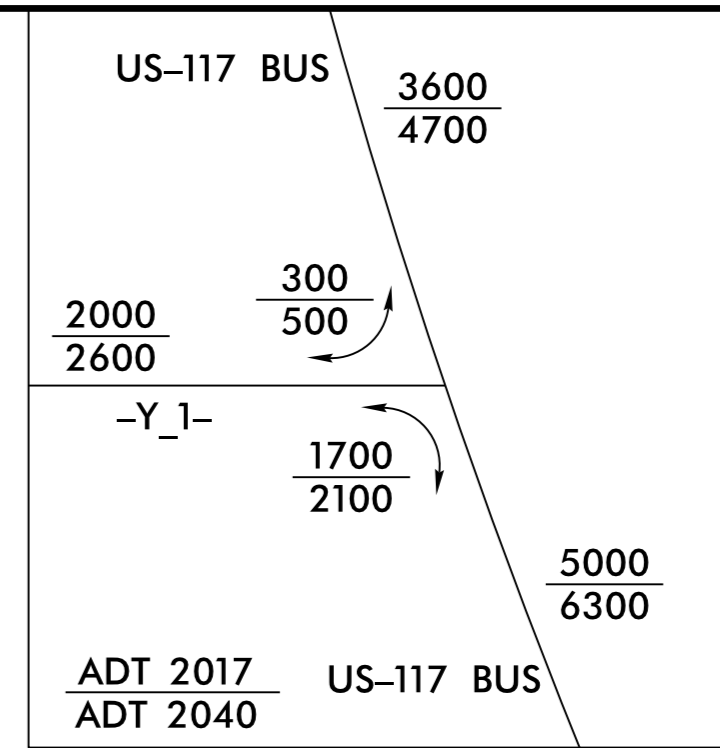
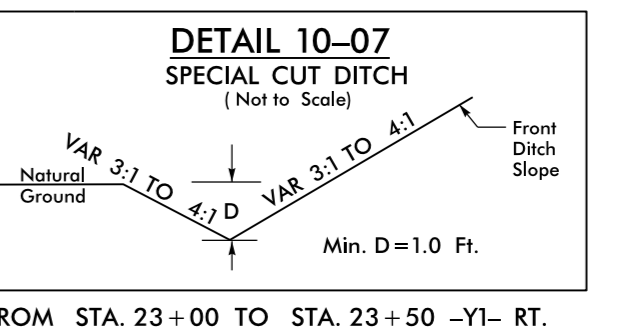
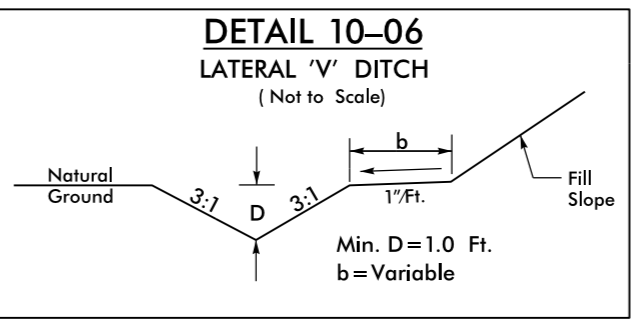
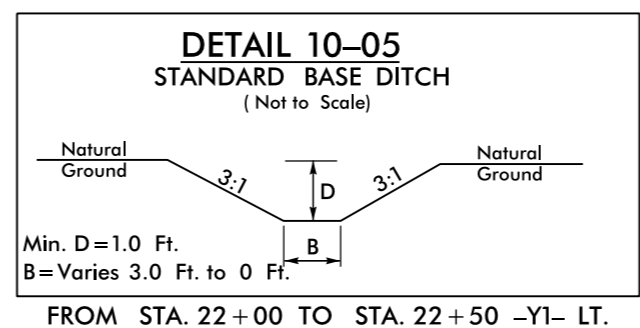
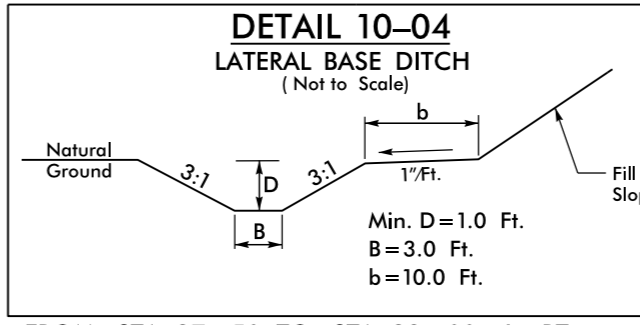
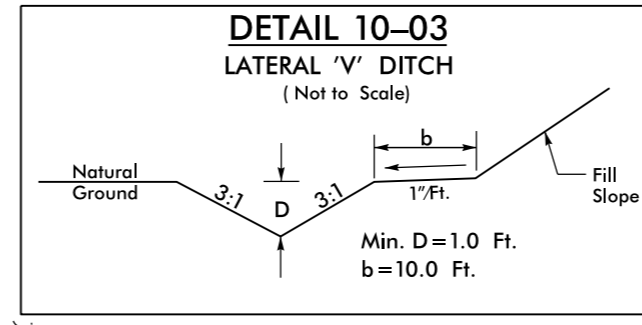
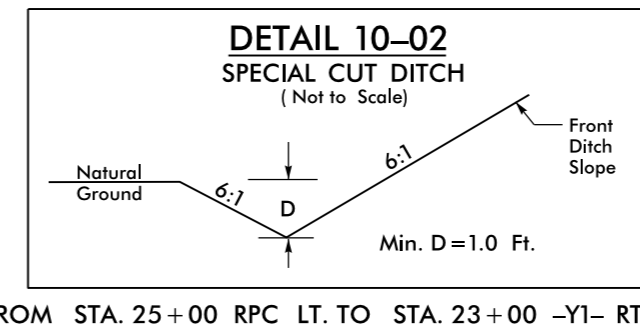
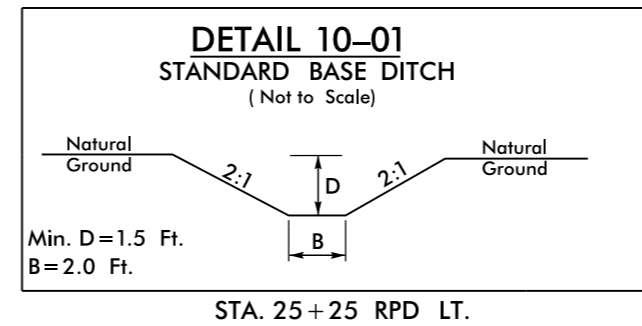
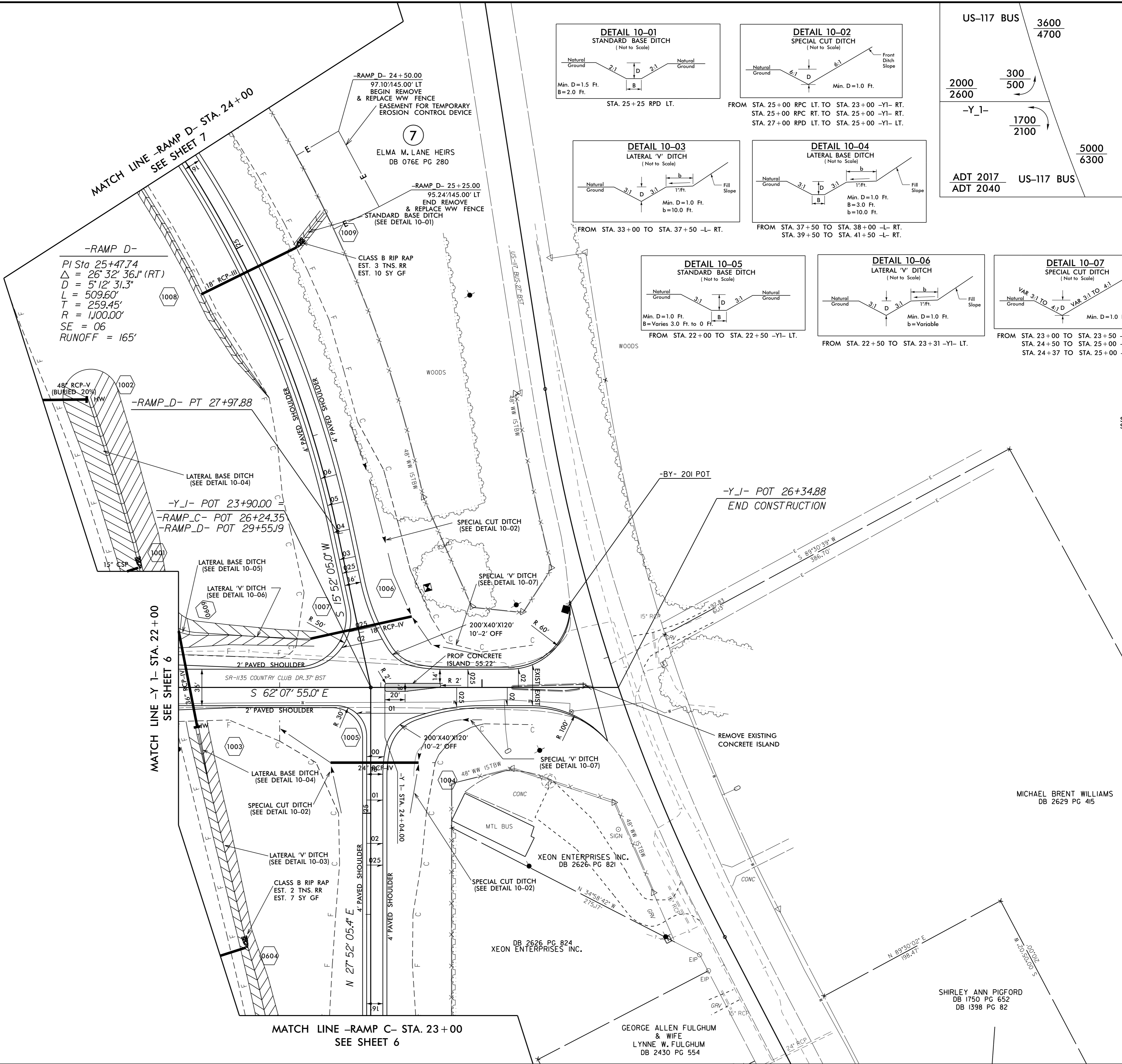

PROJECT REFERENCE NO.	SHEET NO.
R-5719	10
RDW SHEET NO.	10
ROADWAY DESIGN ENGINEER	HYDRAULICS ENGINEER
4/6/2017	4/7/2017
SEAL 18537	SEAL 18462
James G. Davis	James C. Davis
DOCUMENT NOT CONSIDERED FINAL UNLESS ALL SIGNATURES COMPLETED	

ELMA M. LANE HEIRS
DB 076E PG 280

MICHAEL BRENT WILLIAMS
DB 2629 PG 415

XEON ENTERPRISES INC.
DB 2626 PG 824

SHIRLEY ANN PIGFORD
DB 1750 PG 652
DB 1398 PG 82

GEORGE ALLEN FULGHUM & WIFE
LYNNE W. FULGHUM
DB 2430 PG 554

NOTE:
SEE SHEET 20 FOR -Y1- PROFILE
SEE SHEET 18 FOR -RAMP C- PROFILE
SEE SHEET 19 FOR -RAMP D- PROFILE

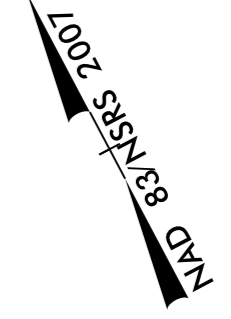

MATCH LINE -RAMP D- STA. 24+00
SEE SHEET 7

-RAMP D-
PI Sta 25+47.74
Δ = 26° 32' 36.1" (RT)
D = 5' 12' 31.3"
L = 509.60'
T = 259.45'
R = 1,100.00'
SE = 06
RUNOFF = 165'

MATCH LINE -Y1- STA. 22+00
SEE SHEET 6

MATCH LINE -RAMP C- STA. 23+00
SEE SHEET 6