

09/08/19

See Sheet 1-A For Index of Sheets

STATE OF NORTH CAROLINA  
DIVISION OF HIGHWAYS

**WAYNE COUNTY**

**LOCATION: CONSTRUCT INTERCHANGE AT US-117 AND  
SR-1135 (COUNTRY CLUB ROAD)**

**TYPE OF WORK: GRADING, DRAINAGE, PAVING, AND STRUCTURES**

STATE	STATE PROJECT REFERENCE NO.	SHEET NO.	TOTAL SHEETS
N.C.	R-5719	1	
STATE PROJ. NO.	F.A. PROJ. NO.	DESCRIPTION	
50473.1.FD1	NHP-0117(31)	PE	
50473.2.1		RW & UTIL.	
50473.3.1		CONST.	

**TIP PROJECT: R-5719**

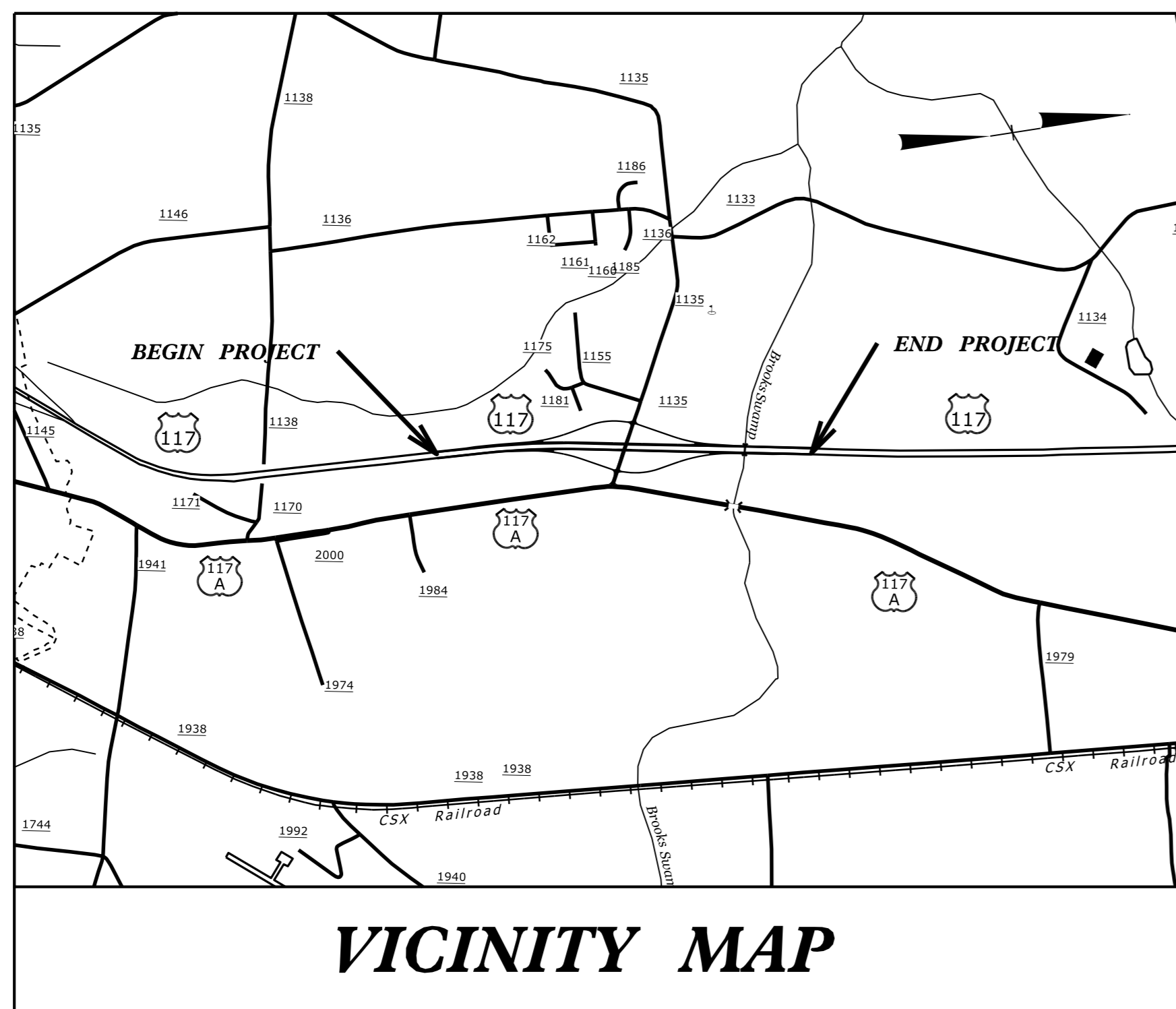

**NAD 83/  
NSRS 2007**

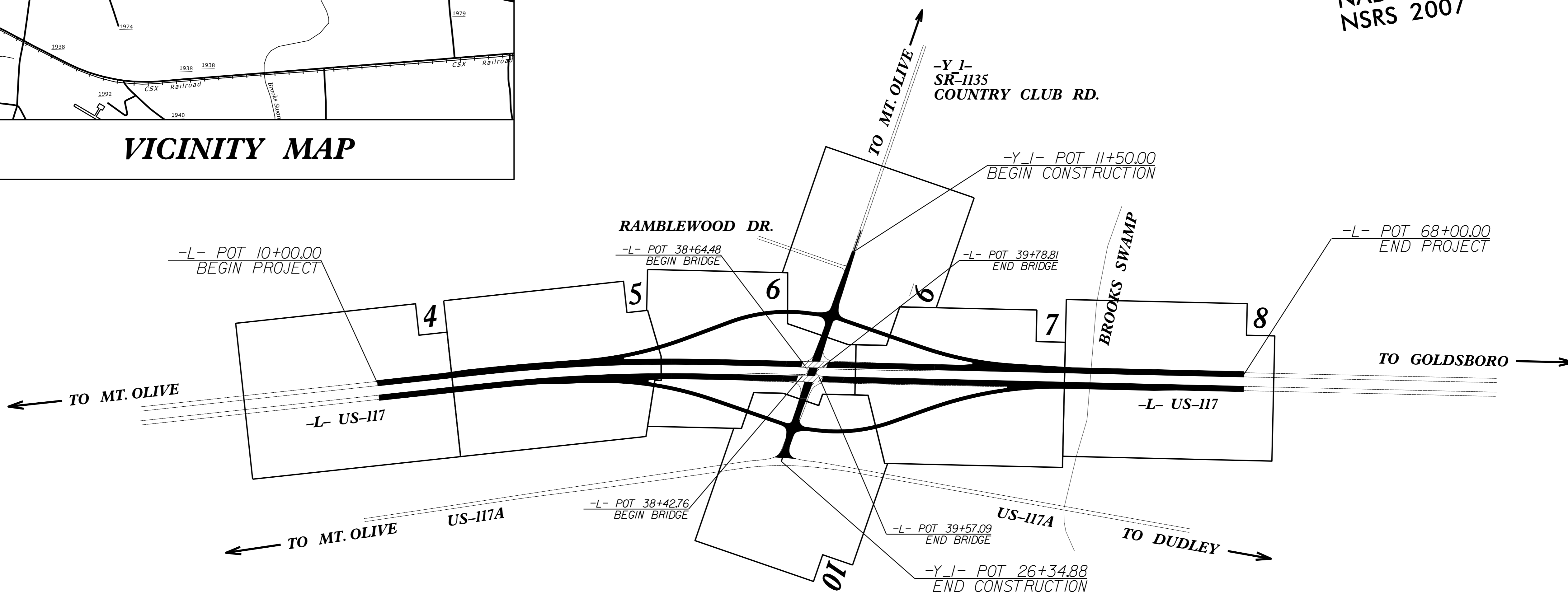

THIS IS A CONTROLLED ACCESS PROJECT WITH ACCESS BEING LIMITED TO INTERCHANGES.

**DOCUMENT NOT CONSIDERED FINAL  
UNLESS ALL SIGNATURES COMPLETED**

**GRAPHIC SCALES**



**DESIGN DATA**

ADT 2017 = 15500  
 ADT 2040 = 27700  
 K = 9 %  
 D = 55 %  
 T = 11 % \*  
 V = 70 MPH

\*TTST=8% DUAL=3%  
 PRINCIPAL ARTERIAL  
 STATEWIDE TIER

**PROJECT LENGTH**

LENGTH ROADWAY TIP PROJECT R-5719 = 1.076 MI  
 LENGTH STRUCTURE TIP PROJECT R-5719 = 0.022 MI  
 TOTAL LENGTH TIP PROJECT R-5719 = 1.098 MI

Prepared in the Office of:  
**DIVISION OF HIGHWAYS**  
 1000 Birch Ridge Dr., Raleigh NC, 27610

2012 STANDARD SPECIFICATIONS

RIGHT OF WAY DATE:  
 AUGUST 01, 2016

LETTING DATE:  
 JUNE 20, 2017

**T.M. LITTLE, PE**  
 PROJECT ENGINEER

**D.R. ETHRIDGE**  
 PROJECT DESIGN ENGINEER

**HYDRAULICS ENGINEER**

4/7/2017

DocuSigned by:  
 James C. Davis  
 E79B9AFAD20C4E8  
 SIGNATURE:

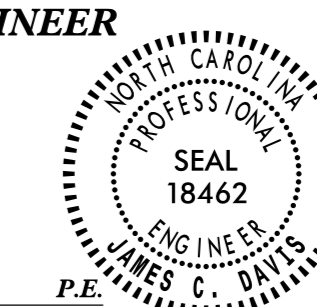

**ROADWAY DESIGN  
ENGINEER**

4/6/2017

DocuSigned by:  
 D.R. Ethridge  
 E0A9D8A9185740A  
 SIGNATURE:

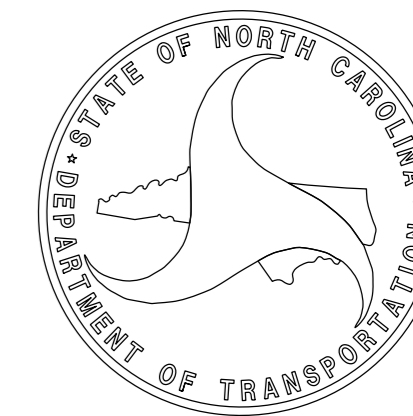
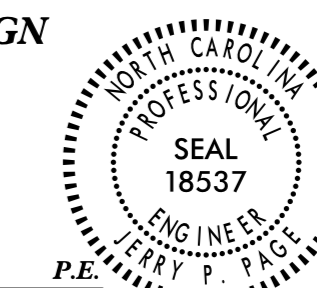

06-APP-2017\_13+35  
 R:\Roadway\Proj\NR5719\_DDC4\_TSH.dgn  
 \$\$\$USERNAME\$\$\$