

TIP PROJECT: W-5313
CONTRACT: C203672

STATE OF NORTH CAROLINA
 DIVISION OF HIGHWAYS

ROWAN COUNTY

**LOCATION: SR 1221 (OLD BEATTY FORD ROAD)
 FROM SR 1337 (LENTZ ROAD) TO
 SR 2335 (LOWER STONE CHURCH ROAD)**

**TYPE OF WORK: WIDENING, RESURFACING, DRAINAGE, SIGNING
 AND CULVERTS**

STATE	STATE PROJECT REFERENCE NO.	SHEET NO.	TOTAL SHEETS
N.C.	W-5313		
STATE PROJ. NO.	F.A. PROJ. NO.	DESCRIPTION	
46136.1.1	STP-1221(15)	P.E.	
46136.1.FD1	STP-1221(15)	RW	
46136.1.FDU1	STP-1221(15)	UTIL	
46136.3.FD1	STP-1221(15)	CONST.	

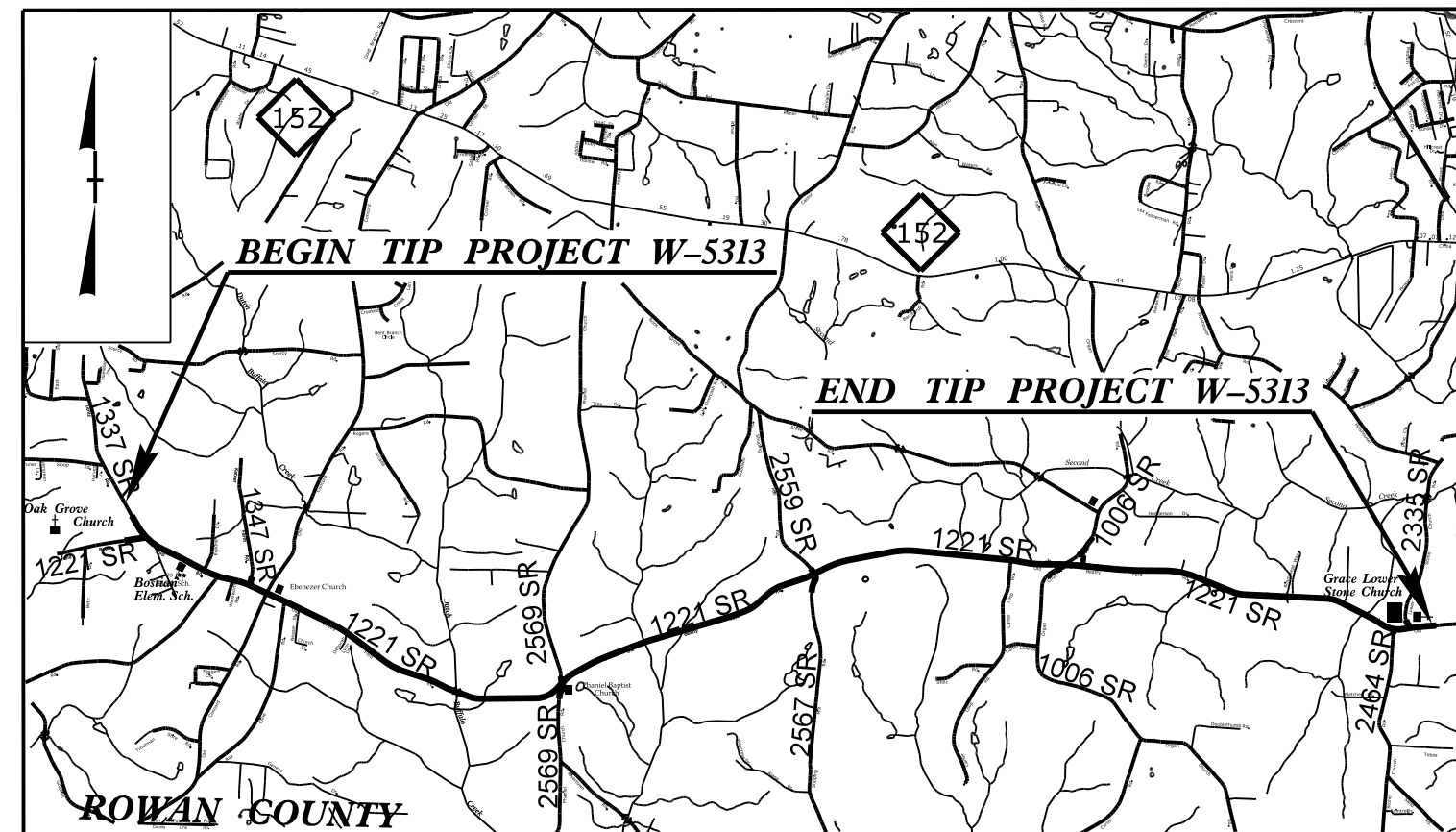

VICINITY MAP SHOWING LOCATION OF PROJECT W-5313

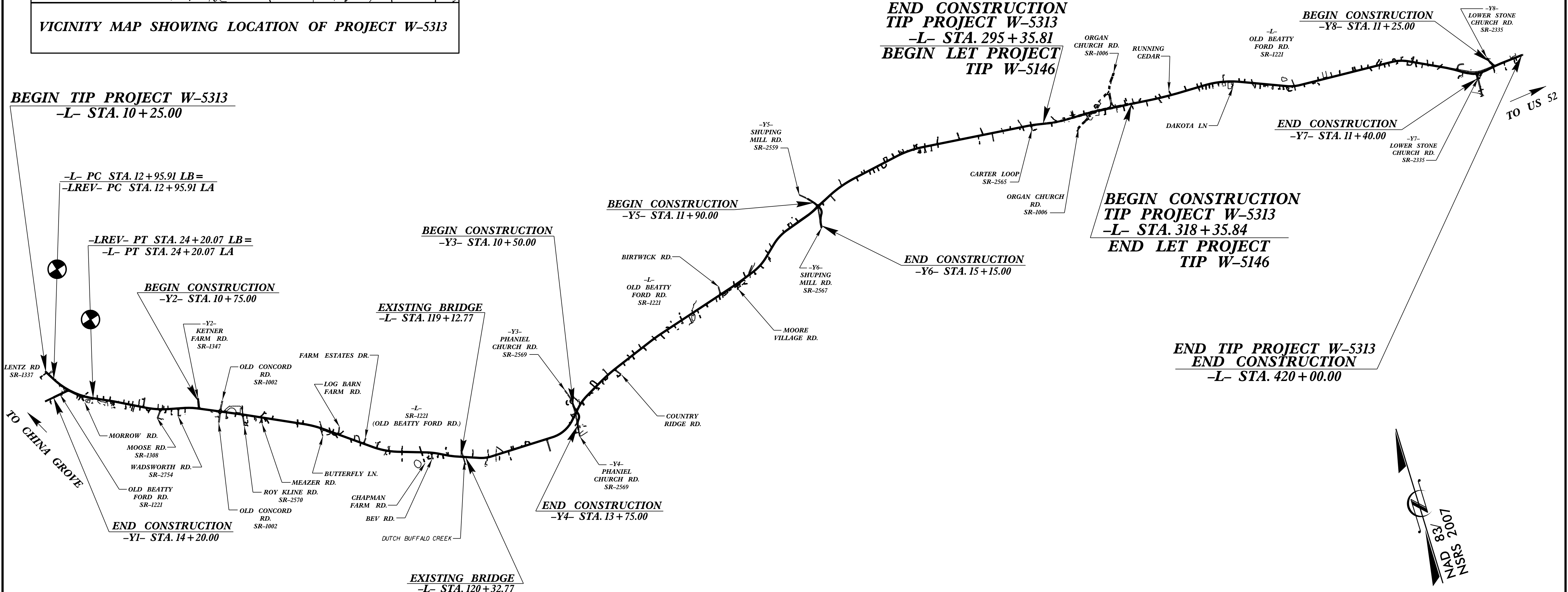

CULVERTS

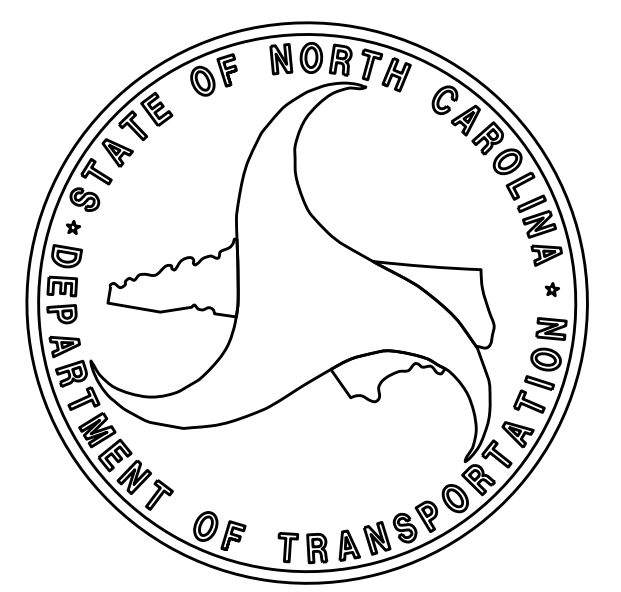

DESIGN DATA

ADT 2016	=	4432
ADT 2036	=	5872
DHV	=	10 %
D	=	65 %
T	=	8 % *
V	=	50 MPH
* TTST	=	3 DUAL = 5
FUNC CLASS	=	RUAL COLLECTOR
SUB REGIONAL TIER	=	

PROJECT LENGTH

LENGTH OF ROADWAY TIP PROJECT W-5313	=	7.33 MILES
LENGTH OF STRUCTURE TIP PROJECT W-5313	=	0.00 MILES
TOTAL LENGTH OF TIP PROJECT W-5313	=	7.33 MILES

Prepared in the Office of:
DIVISION OF HIGHWAYS
 STRUCTURES MANAGEMENT UNIT
 1000 Birch Ridge Dr., Raleigh NC, 27610

2012 STANDARD SPECIFICATIONS

LETTING DATE:
 JUNE 20, 2017

E.E. MURRAY, PE
 PROJECT ENGINEER

V.A. PATEL, PE
 PROJECT DESIGN ENGINEER

