

PROJECT REFERENCE NO.	SHEET NO.
W-5313	EC-47/CONST.16
RW SHEET NO.	
ROADWAY DESIGN ENGINEER	HYDRAULICS ENGINEER

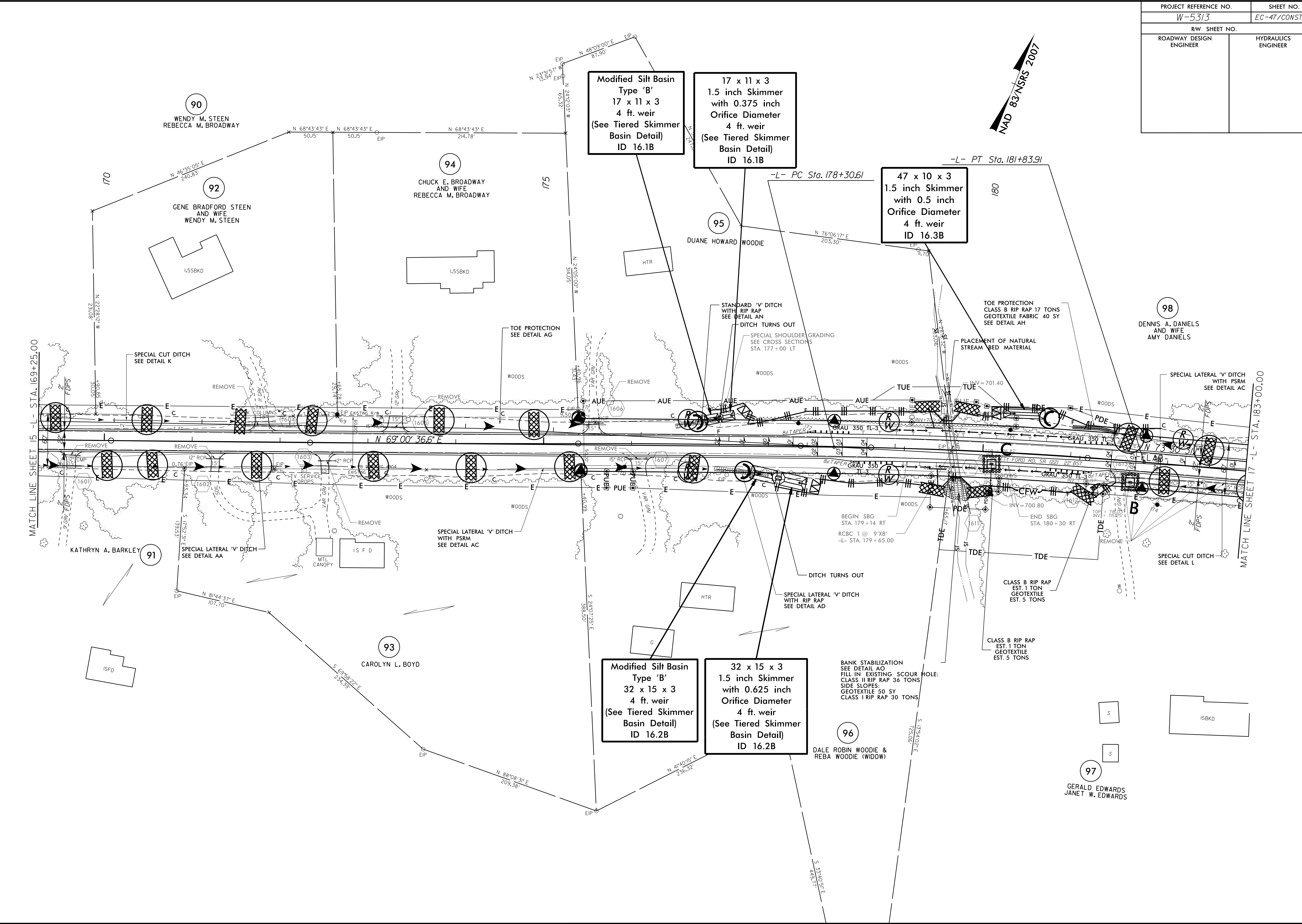

Modified Silt Basin Type 'B'
 17 x 11 x 3
 1.5 inch Skimmer
 with 0.375 inch
 Orifice Diameter
 4 ft. weir
 (See Tiered Skimmer
 Basin Detail)
 ID 16.1B

17 x 11 x 3
 1.5 inch Skimmer
 with 0.375 inch
 Orifice Diameter
 4 ft. weir
 (See Tiered Skimmer
 Basin Detail)
 ID 16.1B

47 x 10 x 3
 1.5 inch Skimmer
 with 0.5 inch
 Orifice Diameter
 4 ft. weir
 ID 16.3B

Modified Silt Basin Type 'B'
 32 x 15 x 3
 1.5 inch Skimmer
 with 0.625 inch
 Orifice Diameter
 4 ft. weir
 (See Tiered Skimmer
 Basin Detail)
 ID 16.2B

32 x 15 x 3
 1.5 inch Skimmer
 with 0.625 inch
 Orifice Diameter
 4 ft. weir
 (See Tiered Skimmer
 Basin Detail)
 ID 16.2B

BANK STABILIZATION
 SEE DETAIL AO
 FILL IN EXISTING SCOUR HOLE:
 CLASS II RIP RAP 36 TONS
 SIDE SLOPES:
 GEOTEXTILE 50 SY
 CLASS I RIP RAP 30 TONS

23-APR-2016 15:34 I:\projects\1971\W-5313-EC-psht-sh16.dgn
 C:\Users\alr\Documents\ALR\1971\W-5313-EC-psht-sh16.dgn